

AXA

AXA UNO RIMLESS BACK TO WALL PAN

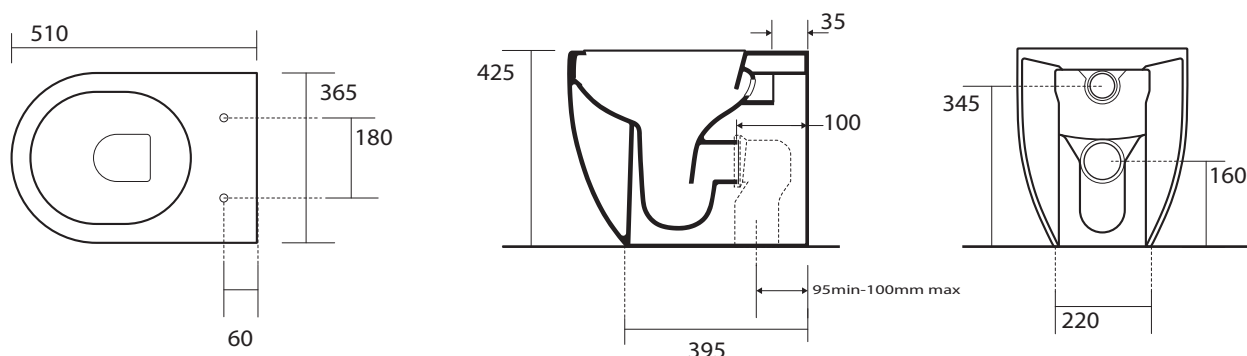

SPECIFICATIONS

Recommended use	Domestic, hotel and commercial
Colour availability	White
Rim configuration	No Rim
Set out	S Trap: 95min - 100mm max. P Trap: 160mm fixed
Pan fixing	Screwed to floor using brackets supplied and bedded with sealant.
Seat	Matching top fix seat supplied with pan (soft close quick release)
Material	Vitreous china
Weight	Pan: 27 kg
Flushing	4.5/3 litre dual flush
Warranty	15 years (refer to warranty)



To see the complete AXA range go to www.reece.com.au/bathrooms

CLEANING RECOMMENDATIONS

We recommend the use of soapy water or approved bathroom cleaners.

This bathroom product should not be cleaned with abrasive materials.

Damage caused by any improper treatment is not covered by the product warranty - refer to Warranty Conditions

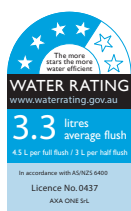

Disclaimer: Products in this specification manual must by regulation be installed by licensed and registered trade people. The manufacturer/distributor reserves the right to vary specifications or delete models from their range without prior notification. Dimensions are nominal measurements only. Dimensions and set-outs listed are correct at the time of publication however the manufacturer/distributor takes no responsibility for printing errors.

Tech Page Version 1

