

# MILLI

## EXO TOILET ROLL HOLDER

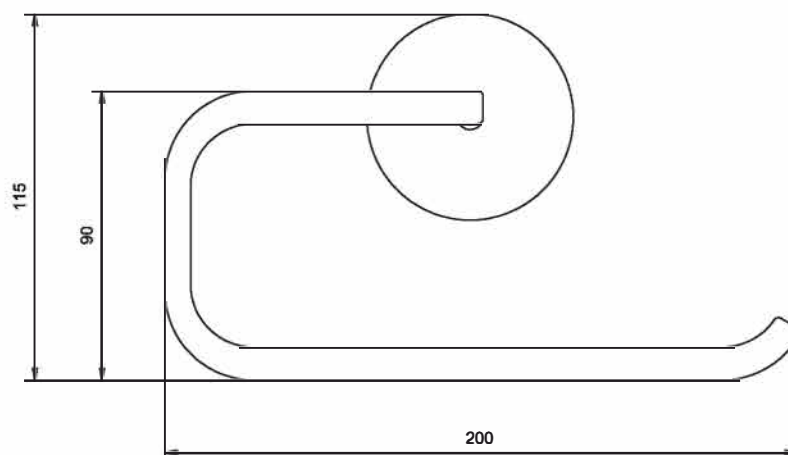
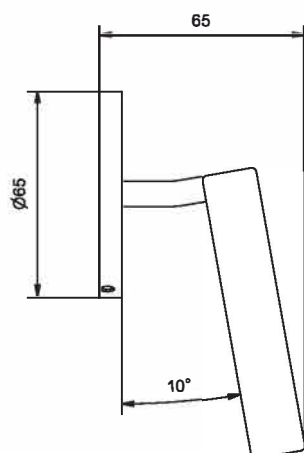

### SPECIFICATIONS

<b>Recommended use</b>	Domestic, hotel and commercial
<b>Colour availability</b>	Chrome, Matt Black, Gunmetal, Brushed Nickel
<b>Standards</b>	AS/NZS 3718

### CLEANING RECOMMENDATIONS

We recommend the use of soapy water or approved cleaners.

This product should not be cleaned with abrasive materials.

Damage caused by any improper treatment is not covered by the product warranty - refer to Warranty Conditions on the last page.



To see the complete MILLI range go to  
[www.reece.com.au/bathrooms](http://www.reece.com.au/bathrooms)

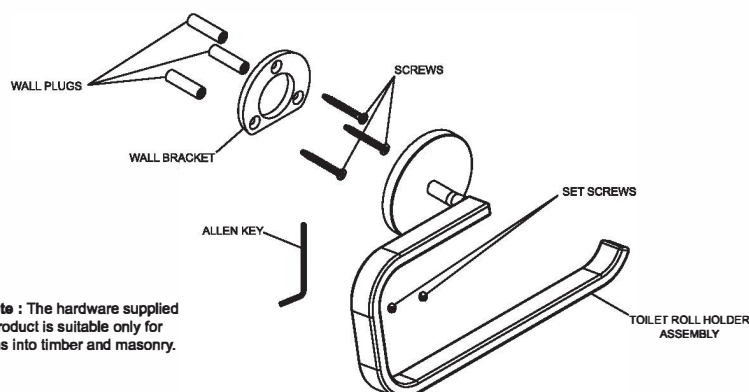

**Please note :** The hardware supplied with this product is suitable only for installations into timber and masonry.

# MILLI

## EXO TOILET ROLL HOLDER

### Important Note

Tap must be installed to the requirements of AS/NZS 3500 by a qualified plumber. The tap seat should have a uniform surface to allow a positive seal between the cartridge and the seat. Tap seats in poor condition must be re-seated.

### INSTALLATION INSTRUCTIONS

In the desired location for the toilet roll holder, mark the three drill hole positions as shown in the illustration below, ensuring the flat section of the wall bracket is horizontal and the three mounting holes are in the orientation displayed.

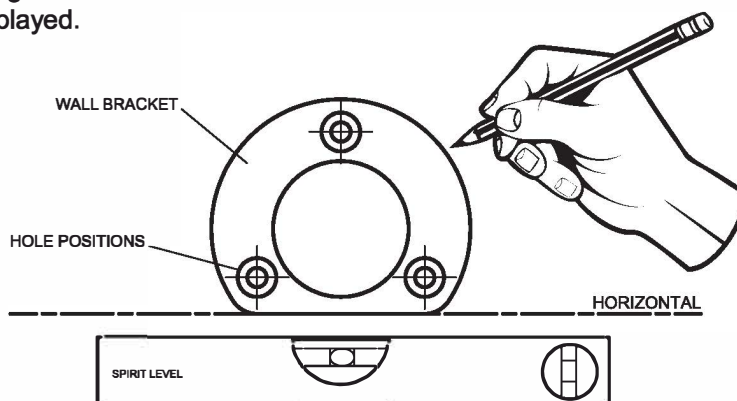

Carefully drill 7mm holes in the previously marked positions and insert the wall plugs until flush with the wall. (To ensure accuracy, we recommend to use the wall bracket as a guide and drill pilot holes using a 4mm drill bit prior to drilling the 7mm finished hole size required.)

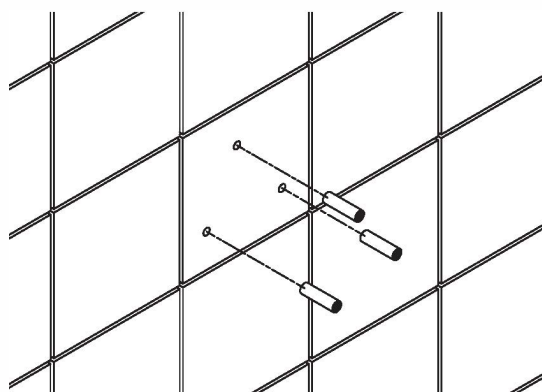
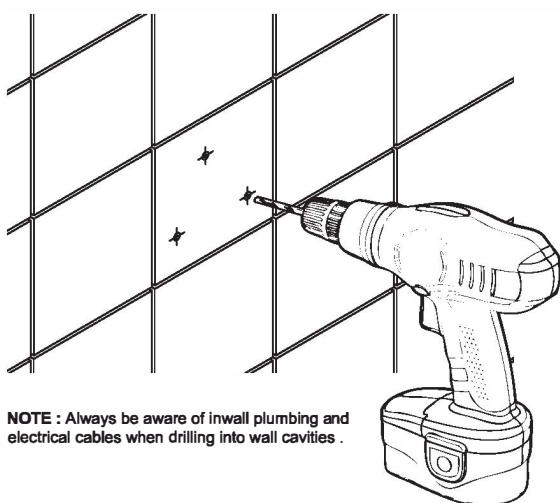

Fix the mounting bracket firmly in place using the screws supplied ensuring it is flush and firmly against the wall.

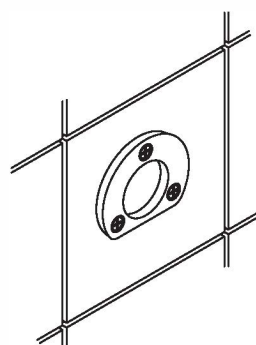
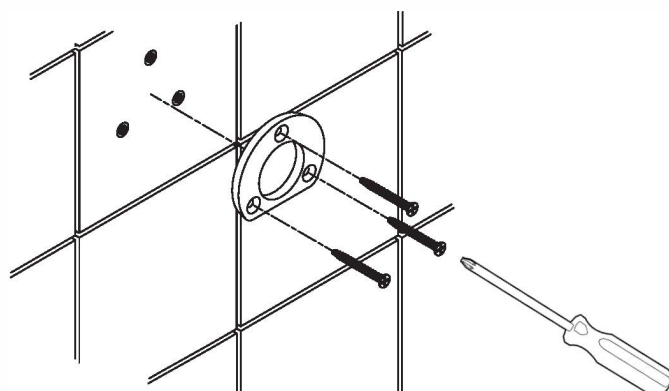

## MILLI EXO TOILET ROLL HOLDER

Place the toilet roll assembly onto the mounting bracket and against the wall.

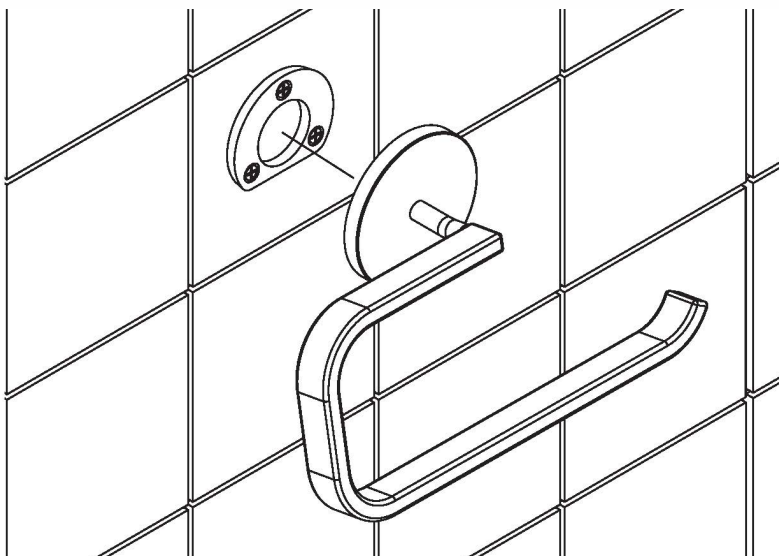

Hold the assembly in place while you **evenly** do up the two securing set screws to complete the installation.

