



**Roca**

---

# IN-TANK

89330300R

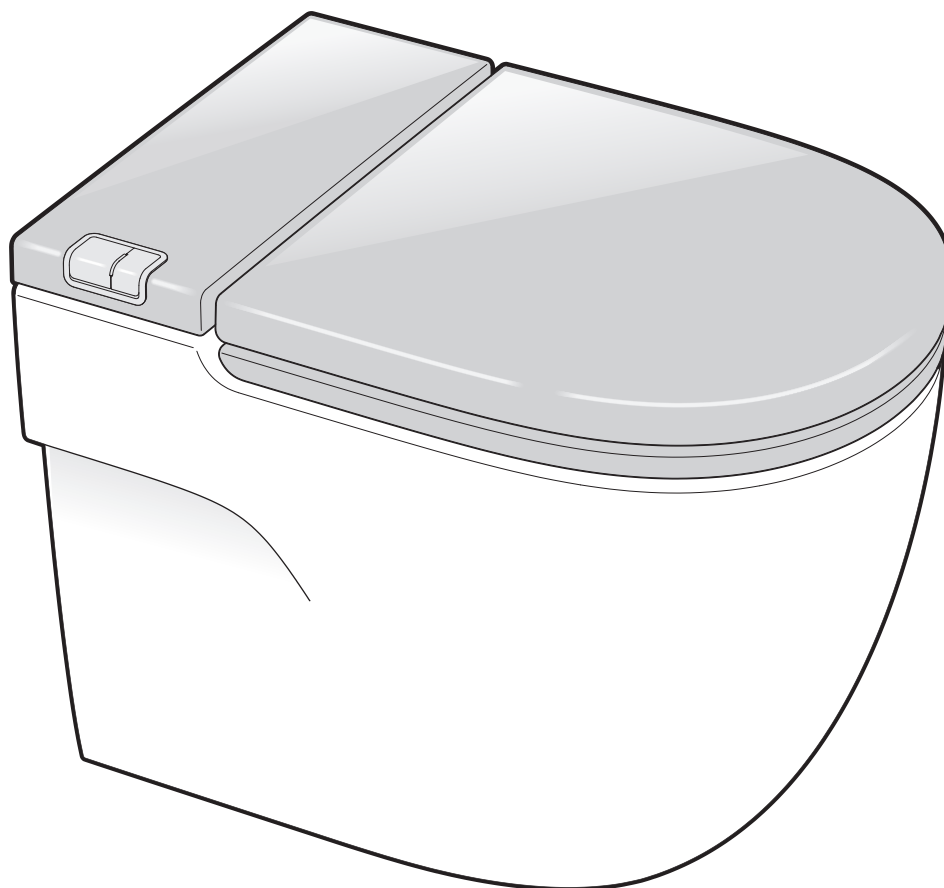



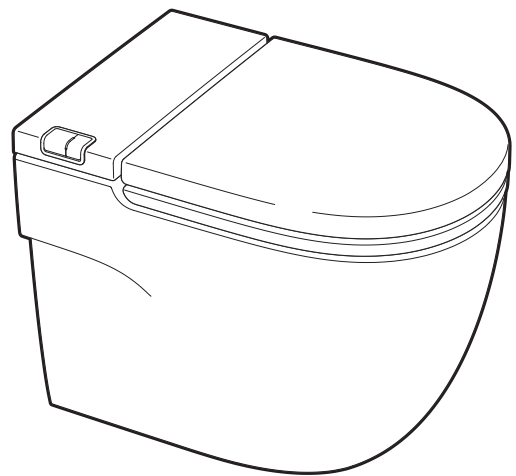
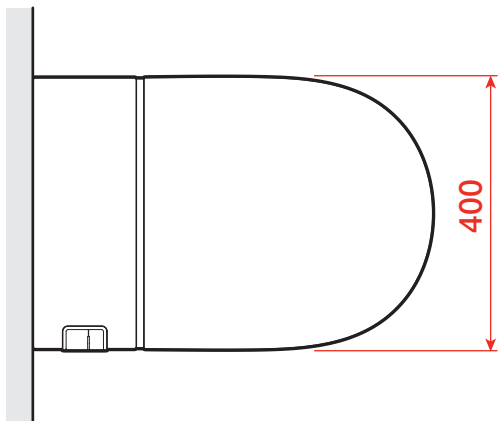
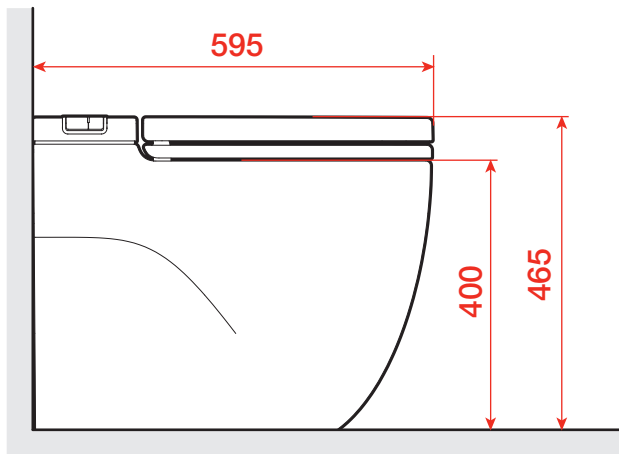

45 Kg.

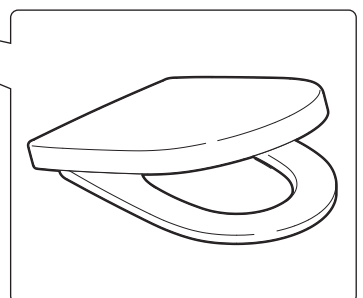
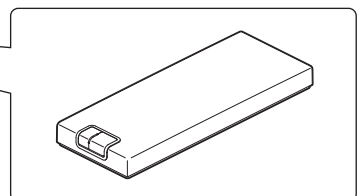
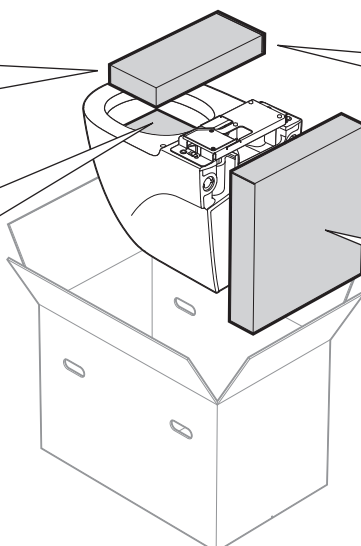
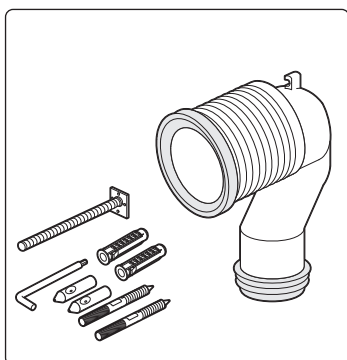
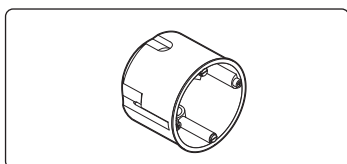
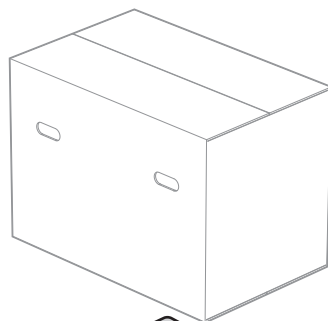

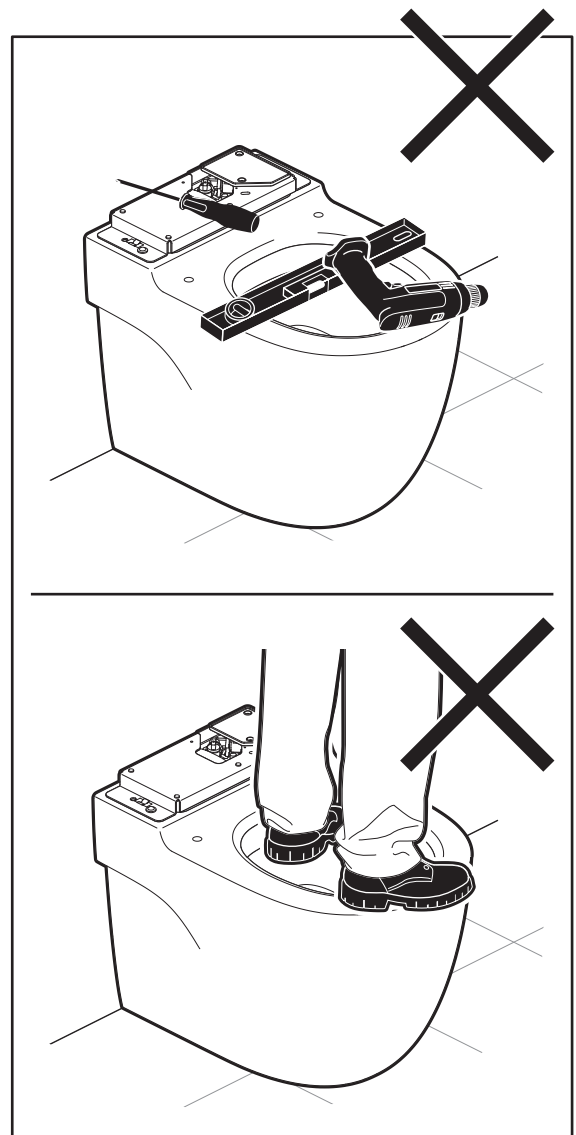
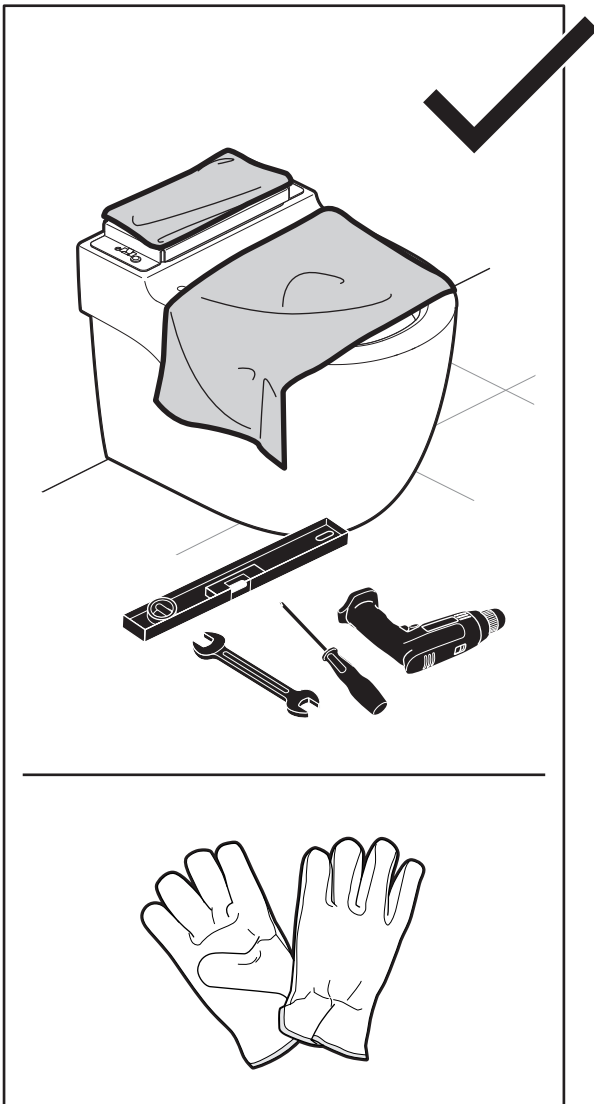
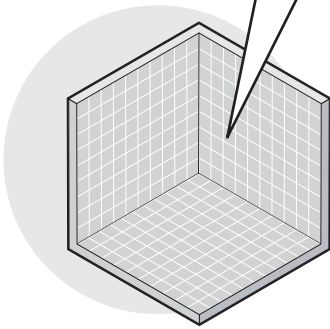
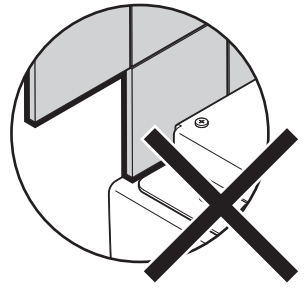
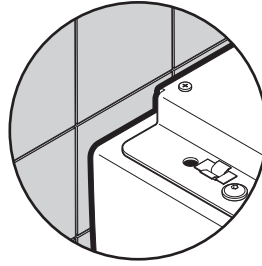
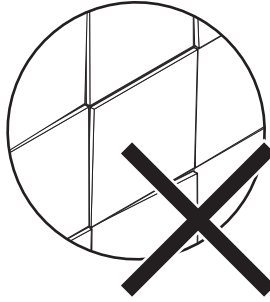
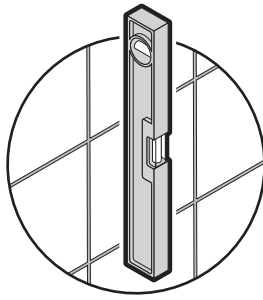



● Fixation

○ Pipes

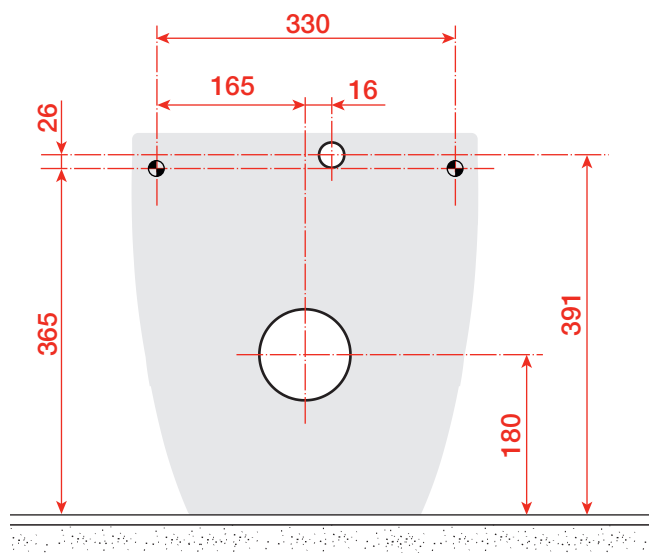

⚡ Electrical

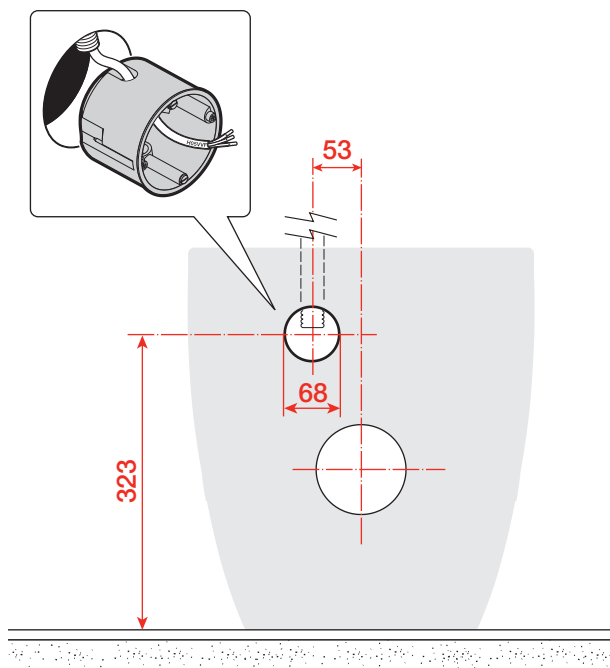

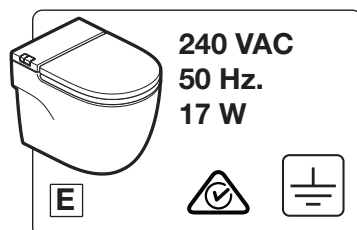
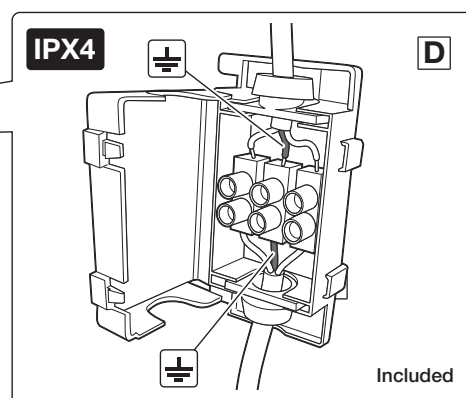
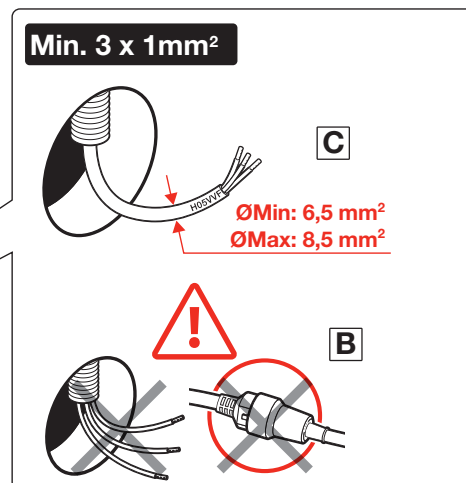
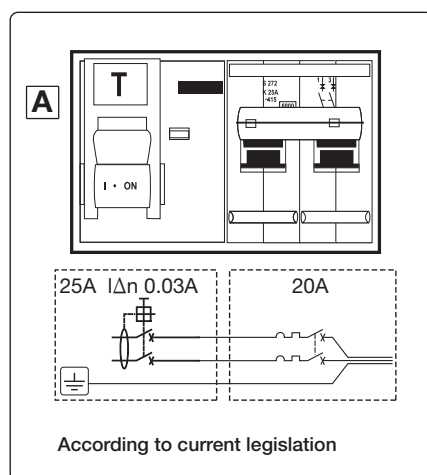
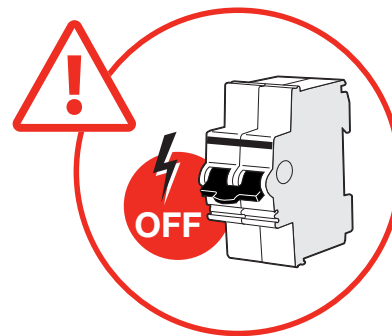

- A** The electrical installation must be protected by means of a IDn 0,03A and 25A differential switch and a magnetothermal switch of 10 or 15A. Both switches must be placed outside the bathroom.
- B** The power connection if this product must be permanently connected to a fixed electricity line. Placement of a plug is not acceptable.
- C** The electrical line to be installed must be a flexible cable consisting of three wires (active, neutral, earth) of at least 1mm<sup>2</sup> of section exclusively dedicated to the WC. In the event that, due to failure, it is necessary to handle or replace the power cable, this must only be done by Technical Service staff.
- D** The power connection must only be done inside the included IPX4 electrical box. In case of making a junction of the electrical line must be also used a box of this type.
- E** The range of function of the WC is 240V, 50Hz.

**- Any electrical work conducted on this product must be installed only by qualified personnel, in accordance with AS/NZS 3000 Wiring Rules.**

- Note**
- Please consult with a qualified electrician to confirm an appropriate installation location.
  - No additional electrical equipment should be fitted inside the toilet.
  - This product (IPX4) shall not be exposed to water jets for cleaning purposes.

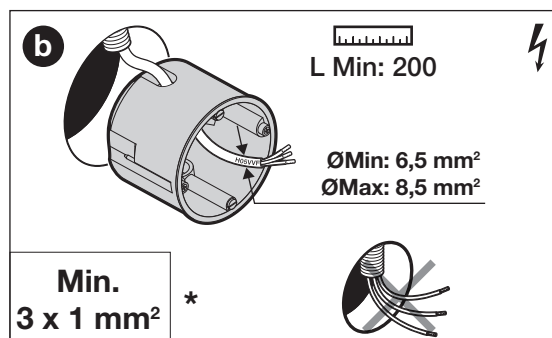
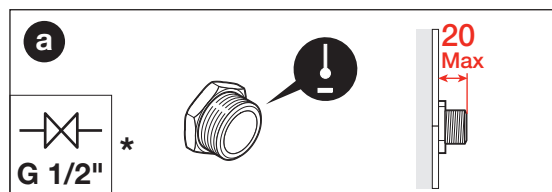
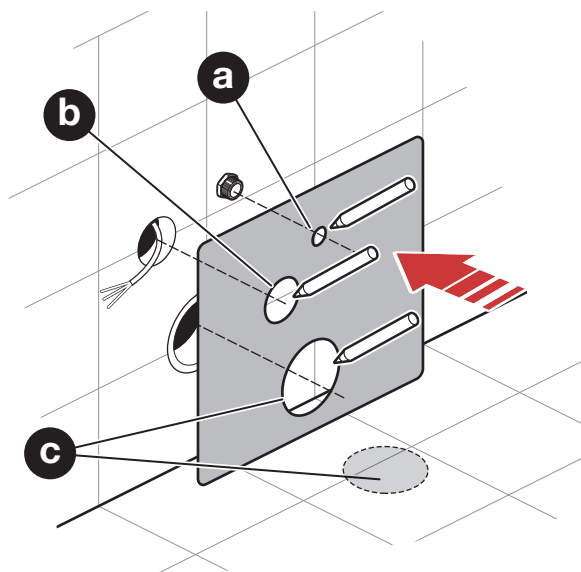

\* Not included

<p><b>c</b></p> <p>WC</p>	<p>Optional connection</p>
<p>AV000700R</p> <p>Min: 95 Max: 150</p>	<p>180 150</p>
<p>Min. 95 Max. 150</p> <p>DN 110 Ø ext.</p>	<p>180</p> <p>DN 110 Ø ext.*</p>

2

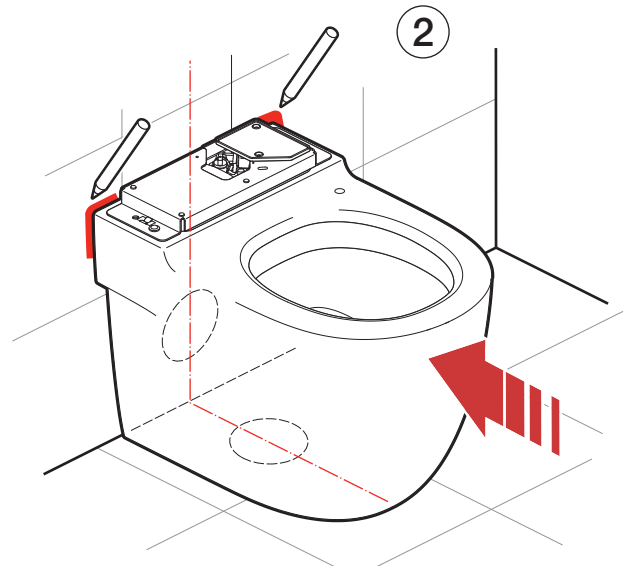
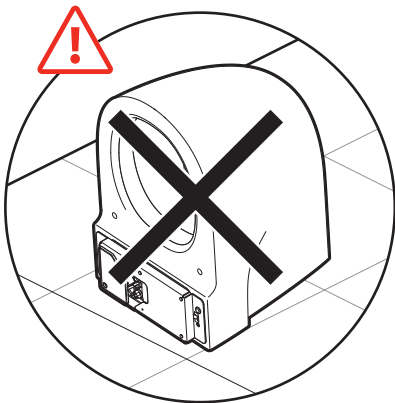
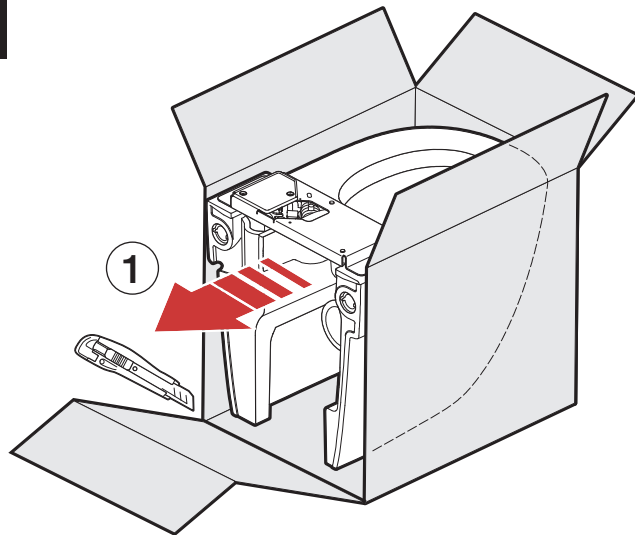

3

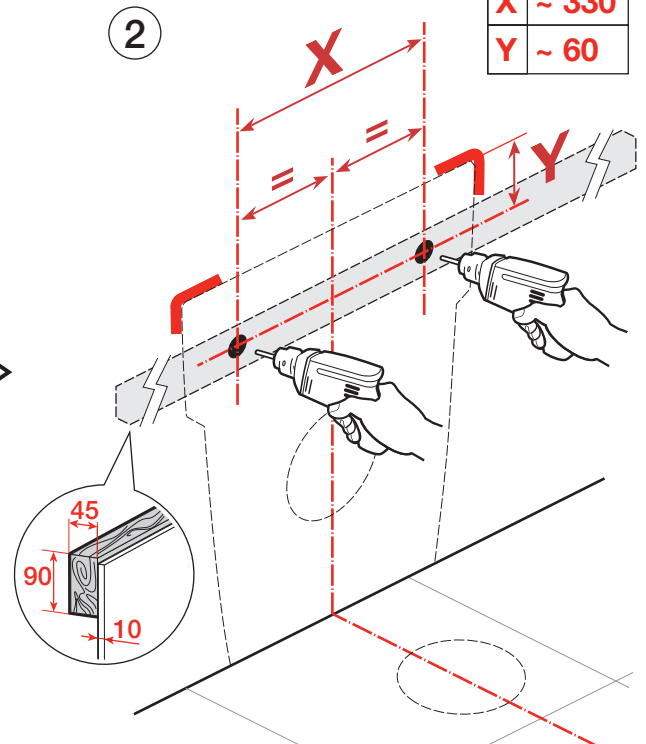
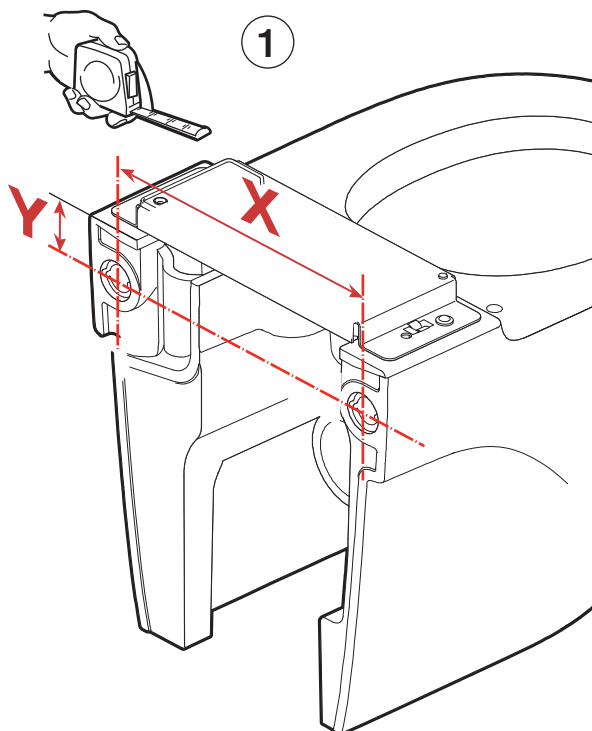

X	~ 330
Y	~ 60

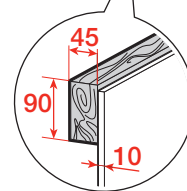



4

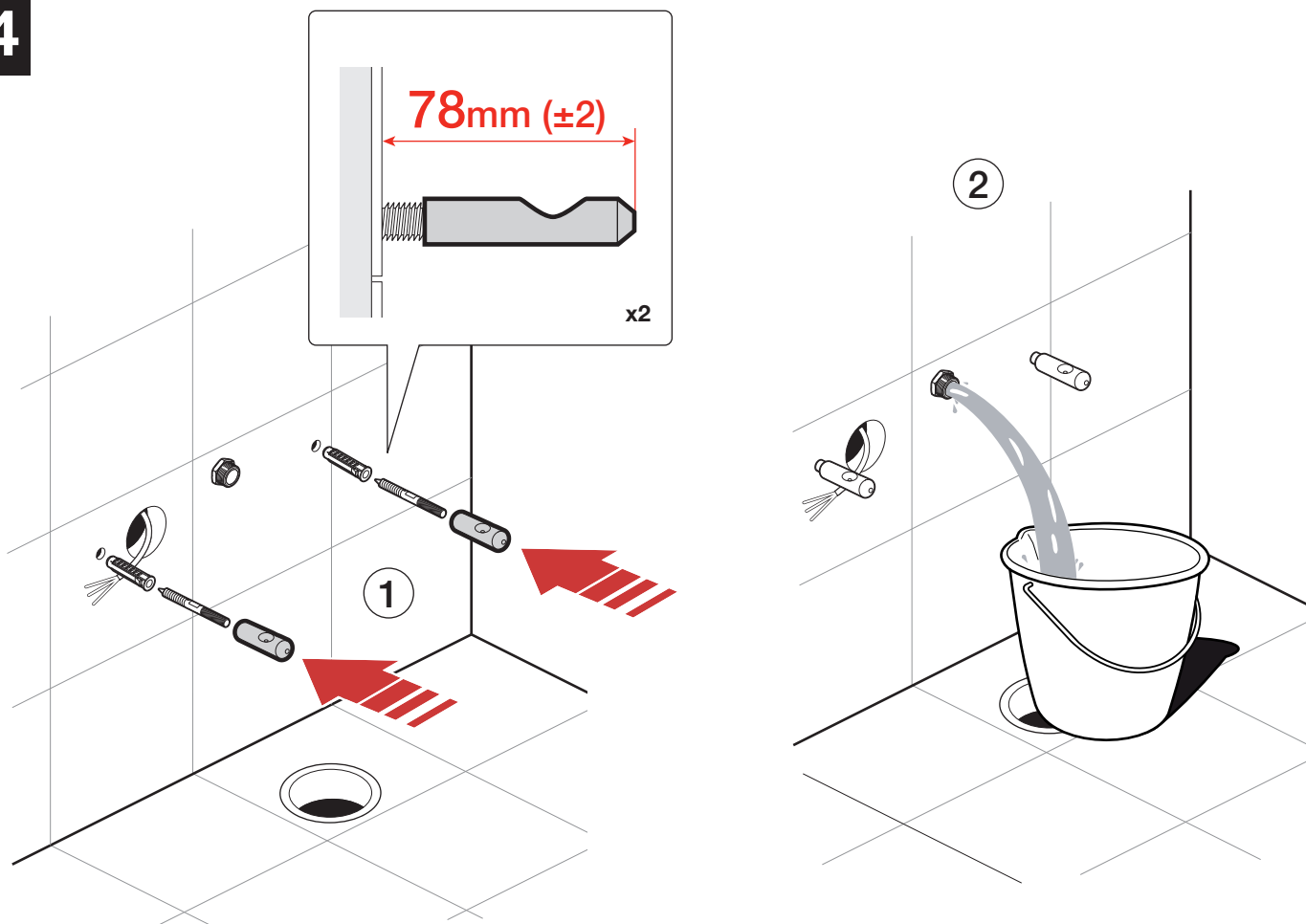

5

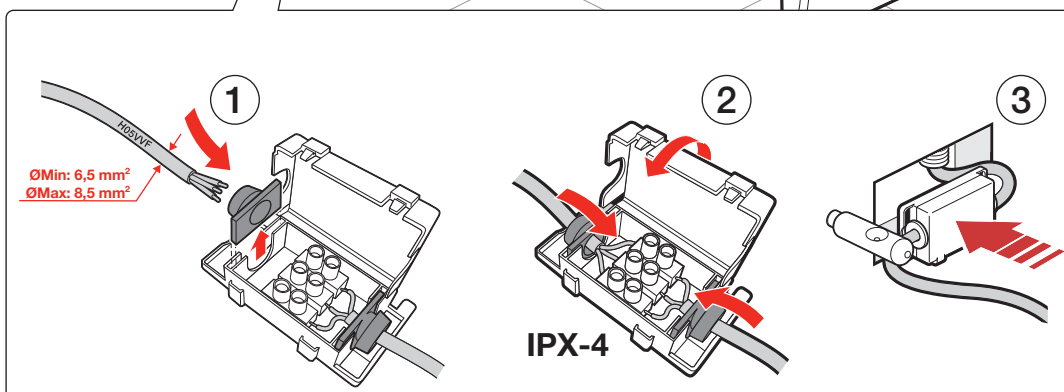
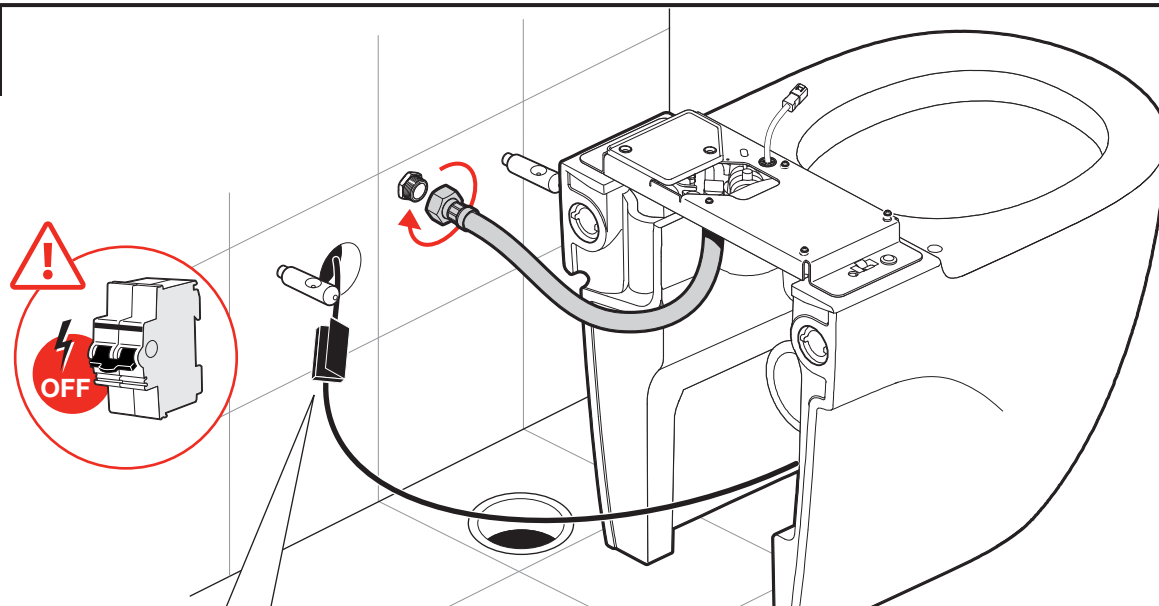

6

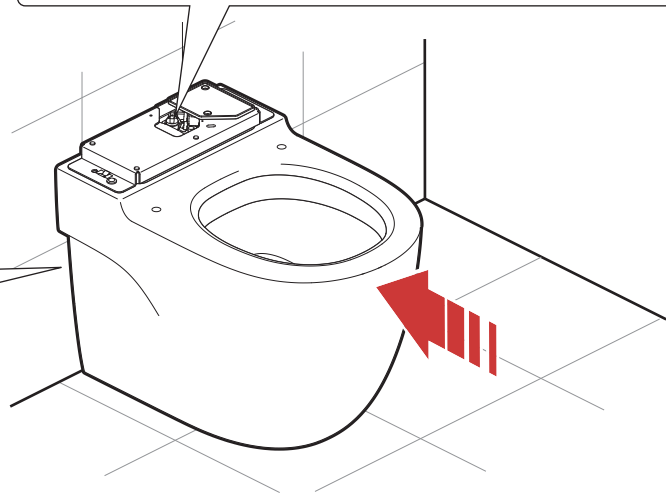
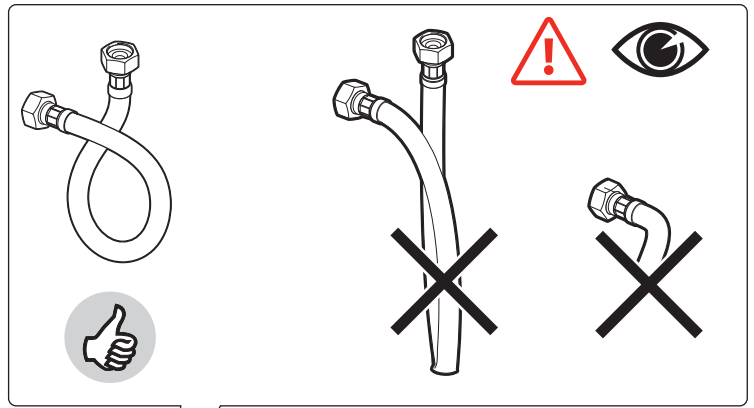

7

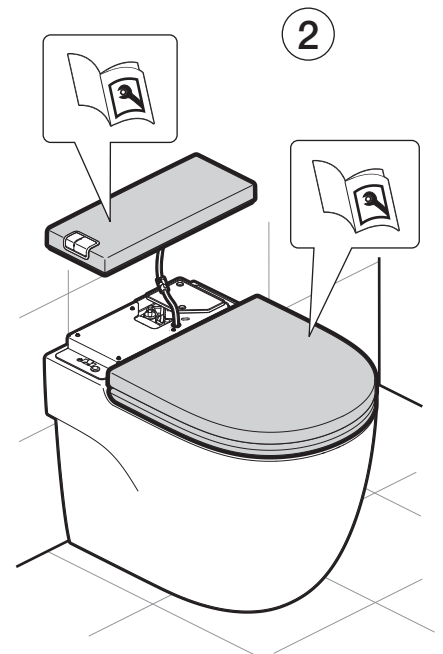
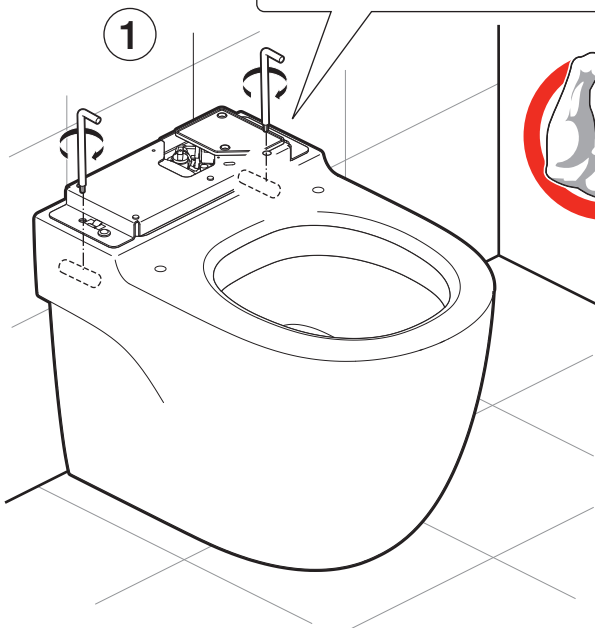
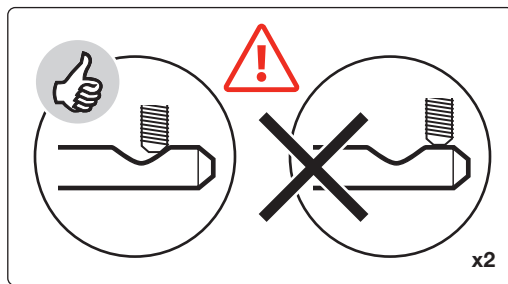



**Roca Sanitario, S.A.**

Avda. Diagonal, 513  
08029 Barcelona  
SPAIN  
[www.roca.com.au](http://www.roca.com.au)

