

KADO

LUX SHOWER SYSTEM

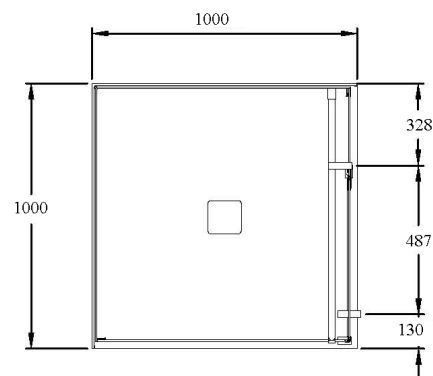

1000mm x 1000mm

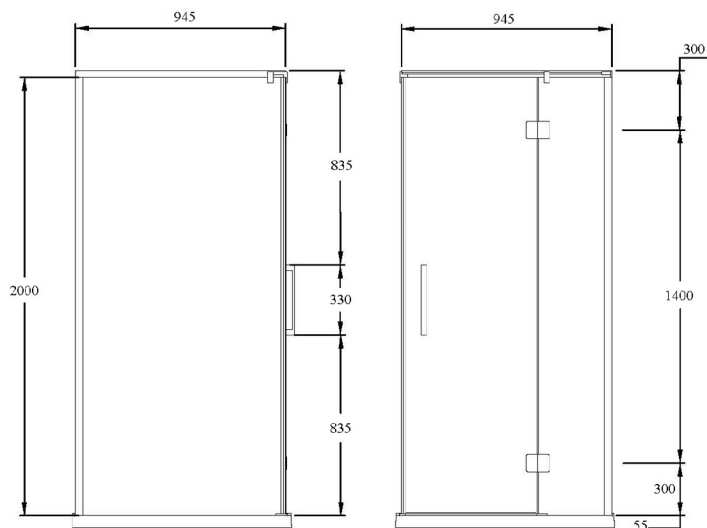

Centre Outlet

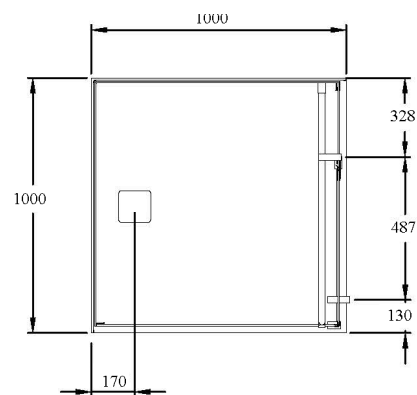

Rear Outlet



1200mm x 900mm

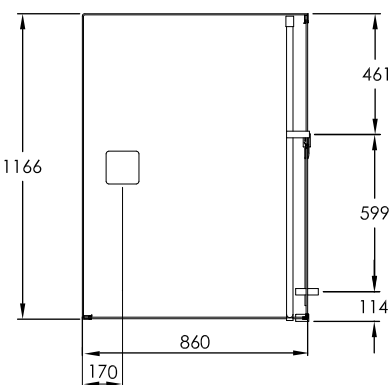
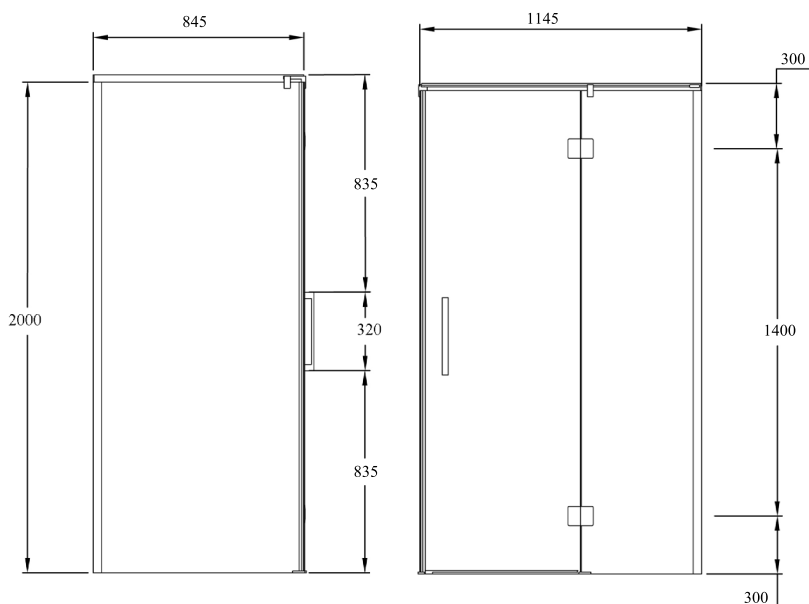

Dimensions are nominal measurements only.

To see the complete KADO range go to
www.reece.com.au/bathrooms

Disclaimer: Products in this specification manual must by regulation be installed by licensed and registered trade people. The manufacturer/distributor reserves the right to vary specifications or delete models from their range without prior notification. Dimensions are nominal measurements only. Dimensions and set-outs listed are correct at time of publication however the manufacturer/distributor takes no responsibility for printing errors.

Tech Page Version 1

KADO

LUX SHOWER SYSTEM

SPECIFICATIONS

Recommended Use	Domestic, hotel and commercial
Material	Semi Frameless Shower screen, white acrylic shower base and white acrylic walls, chrome square handles
Screen Height	2000mm
Outlet	1000mm x 1000mm Centre or Rear 1200mm x 900mm Rear
Waste	Chrome waste
Frame & Support rail colour	Chrome
Door Opening	Right or Left
Glass Thickness	8mm Toughened Glass

CLEANING RECOMMENDATIONS

We recommend the use of soapy water or approved cleaners.

This product should not be cleaned with abrasive materials.

Damage caused by any improper treatment is not covered by the product warranty- refer to Warranty Conditions.

KADO

LUX SHOWER SYSTEM

INSTALLATION INSTRUCTIONS - SHOWER BASE AND WALL LINER

Important Note

The Kado Lux Shower Base can not be used with a Plumbdinger or Flexidinger

1. CONTENTS SUPPLIED

Kado Lux Shower Base / Pack contains

- 1 x Shower Base
- 1 x Shower Waste

Shower Wall Liner / Pack contains

- 1 x Shower Wall Liner
- 3 x Sika® Showerbond Adhesive
- 1 x Clear Anti-Fungal Silicon

IMPORTANT NOTE:

Only use adhesive or silicon supplied by Decina and follow the instructions on each product.

Ensure the "use-by" date is current. Warranty may be void if these points are not adhered to.

2. TOOLS REQUIRED (Not Supplied)

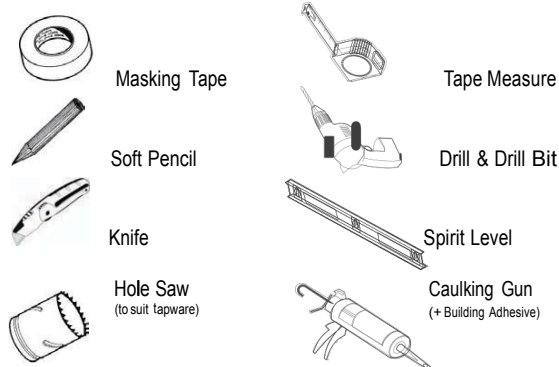

3. PERSONAL PROTECTIVE EQUIPMENT (PPE)

For the safety of the installer, the following items should be used during the installation of Decina products.



a) Protective Clothing



b) Protective Eyewear



c) Protective Gloves



d) Protective Footwear



e) Protective Earwear - whilst using power tools

f) Any other items listed by the manufacturer of the adhesives or sealants used during this installation

4. WARNINGS



- a) Installation of Products MUST be carried out by a QUALIFIED TRADESPERSON.
- b) Inspect the product and all components (listed) PRIOR TO INSTALLATION.
- c) Installation of damaged goods will VOID your Warranty
- d) Acrylic products shall not be used directly adjacent to any direct heat source above 70 degrees Celsius, as this may cause distortion of the product.
- e) Acrylic products will expand and contract with temperature changes, so it is important to allow expansion gaps where shown in this instruction.
- f) Acrylic products may have sharp edges, so always wear appropriate protective clothing and footwear during the installation process.

5. COMPLIANCE REQUIREMENTS

Any wet area installation or renovation must comply with the following:-

BUILDING CODE OF AUSTRALIA

Volume One - Class 2 - 9 Buildings

Volume Two - Class 1 and Class 10 buildings - Housing Provisions

- BCA 2006 Volume One references AS 3740 - 'Waterproofing of wet areas in residential buildings' as meeting the minimum performance requirements for construction of wet areas in Class 2, 3 and 4 buildings.
- BCA 2006 Volume Two gives detailed waterproofing requirements for various applications. These requirements are for all intents and purposes the same as those provided in AS 3740.

AUSTRALIAN STANDARD AS 3740 - 2010

Waterproofing of Domestic Wet Areas

This standard specifies the requirements for the physical elements of construction including floors, walls, junctions and penetration and the specific areas where these criteria apply including showers.

KADO

LUX SHOWER SYSTEM

6. AREA PREPARATION

- To ensure correct installation of Kado Shower products, it is important to have the site floor and walls; level; square and plumb to within 5mm overall.

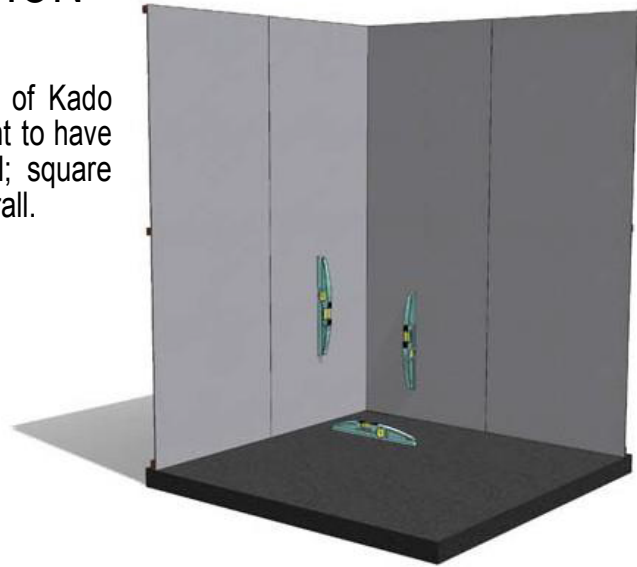

To not do so may prevent correct fitment of a glass shower screen system onto the Kado Shower Base or tiles and may affect water drainage of the shower base.

- To ensure proper bond of the Kado Shower products, the floor and wall area must be smooth, clean, dry, unpainted and **UNSEALED**.
- For **Acrylic Shower Wall Liner** applications, installation shall only be on **NEW** wall lining **WETBOARD**, to ensure and effective bond of the adhesives and sealants.
- All floor and wall surface joints and fixings must be flush to prevent unevenness on the Kado shower products, potentially causing stress points or unsightly bulges.
- Kado Shower Base and Acrylic Shower Wall Lining products must be fitted to a structurally sound solid surface that does not flex under load. This will prevent unevenness in the product or potential weak spots.

KADO

LUX SHOWER SYSTEM

7. SHOWER BASE SITE PREPARATION

- Kado Shower Bases DO NOT require installation on a cement slurry mortar base, as they are fitted with SELF-SUPPORTING FEET.
- To ensure proper drainage of water to the waste and also for correct installation of an optional Kado Glass Shower Screen, the floor area under the Luna Base must be flat and level to within 2mm over the width of the proposed base installation area.
- For concrete floor installations, if the floor installation area is uneven or unlevel, the floor should be relevelled using a cement based self levelling compound (eg. ARDEX L292 or similar as per manufacturer's instructions).
- For timber or panel floor installations, it is necessary to first lay a suitable fibre cement floor underlay sheet (eg. James Hardie Ceramic Tile Underlay or similar as per manufacturer's instructions). The underlay must be laid level and all fixings set flush with the surface to avoid unevenness.
- Ensure the waste trap hole in the floor is no greater than 200 x200mm and does not encroach on the position of the Kado Shower Base self supporting feet.
- For timber or panel floor installations, ensure the waste trap hole does not result in the weakening of the floor, as the Kado Shower base does not form part of the building integrity. If weakened, the opening should be suitably reinforced to provide a structurally sound and flex resistant floor once complete.

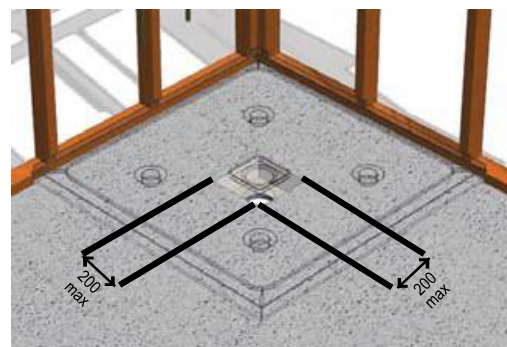
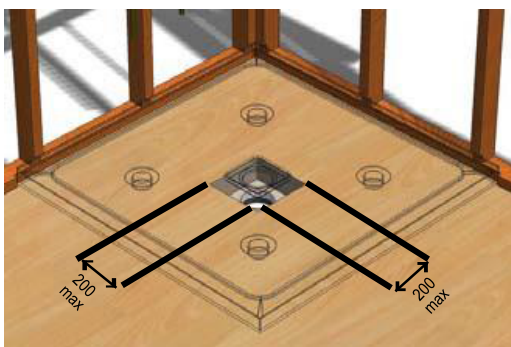
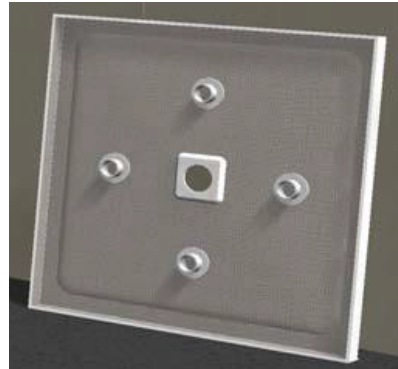

- Before the shower base can be installed, the choice of wall construction and wall lining method must be determined. The choice will determine which of the following methods should be followed:

KADO

LUX SHOWER SYSTEM

8. SHOWER BASE INSTALLATION FOR ACRYLIC SHOWER WALL APPLICATIONS

- A** For Acrylic Shower Wall Liner applications the Kado Shower Base does not need checking into the stud wall, but can be simply pushed against the stud frame. The shower base can be installed before the Wetboard sheeting is applied.
- B** If the Shower Base is to be installed after the Wetboard is installed, the wetboard sheet will need to be cut away to allow the base to sit against the stud wall, allowing a 6mm gap all around the shower base.
- C** All Kado Shower Bases are manufactured with a protective film to prevent damage to the surface of the product.
- D** Prior to installation, pull the protective film back from the edges of the shower base (approx 25mm) and completely from the waste area.



DO NOT COMPLETELY REMOVE THE PROTECTIVE FILM AT THIS STAGE

- E** Qualified tradesperson should assemble the waste and adjoining plumbing. The waste assembly should be checked to ensure it's located centrally in the shower base waste hole for best appearance. The locking nut should be kept loose until the Chrome top cover is located and sits centrally in the hole, with equal spacing around all sides. Once satisfied, tighten the lock ring on the waste assembly back and then remove the chrome waste cover until the end of the installation for protection.



Important Note

Image of waste cover is purely indicative only

KADO

LUX SHOWER SYSTEM

- F** Ensure the floor surface is clean and dry. Apply a generous amount of building adhesive to the Shower Base self supporting feet - suitable for concrete bond (adhesive not supplied – eg. Liquid Nails or similar).
- G** Position the Shower Base against the wall studs and push the Shower Base down firmly to bed the feet against the floor. Recheck the Shower Base level and conduct a water test to ensure full drainage to the waste. Relevel the base as required whilst adhesive is still uncured.
- H** Allow the Shower Base to cure for at least 24 hrs as per the adhesive manufacturer's instructions before installing the wall sheeting. This ensures the level will not change by standing on it.
- I** Once the Shower Base bond is fully cured, the Wet area sheeting can be applied over the Shower Base tile bead as per the relevant Wet Board manufacturer's instructions. The Wetboard should sit over the top edge of the tile bead. Ensure the Wetboard is installed at least 6mm above the shower base tile bead for expansion.

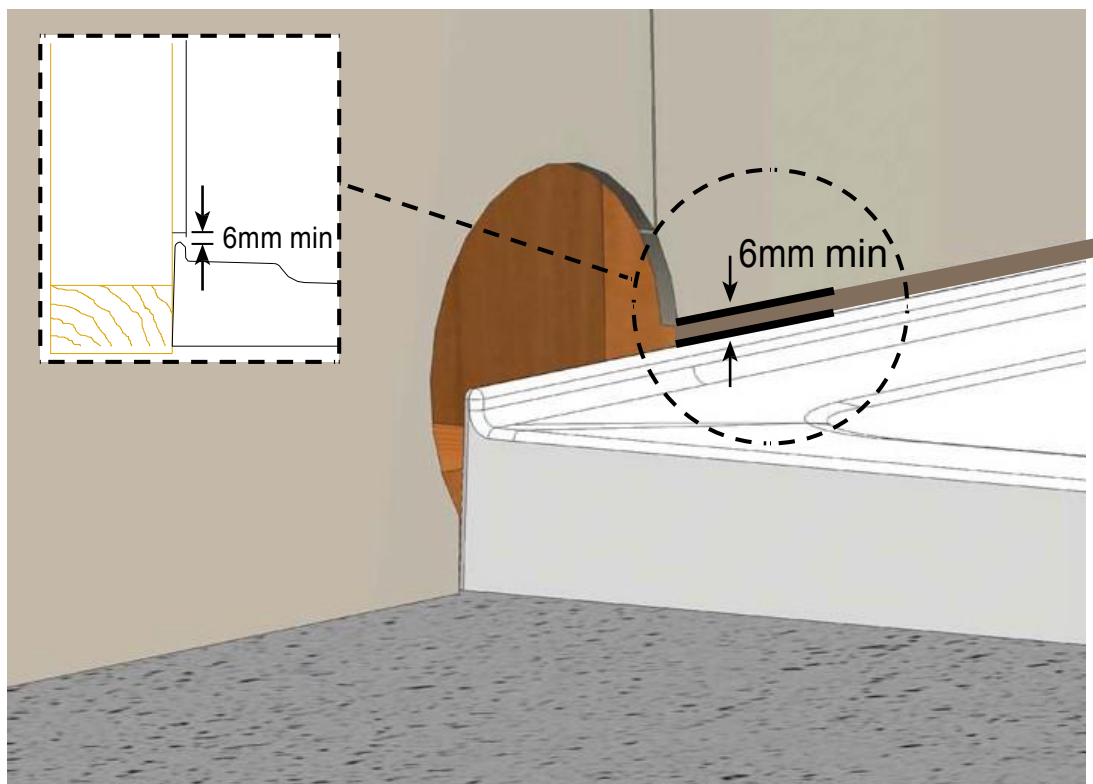

KADO

LUX SHOWER SYSTEM

- Once sheeting is completed, use a flexible waterproof sealant (not supplied) to seal the gap between the Shower Base tile bead and the Wetboard.

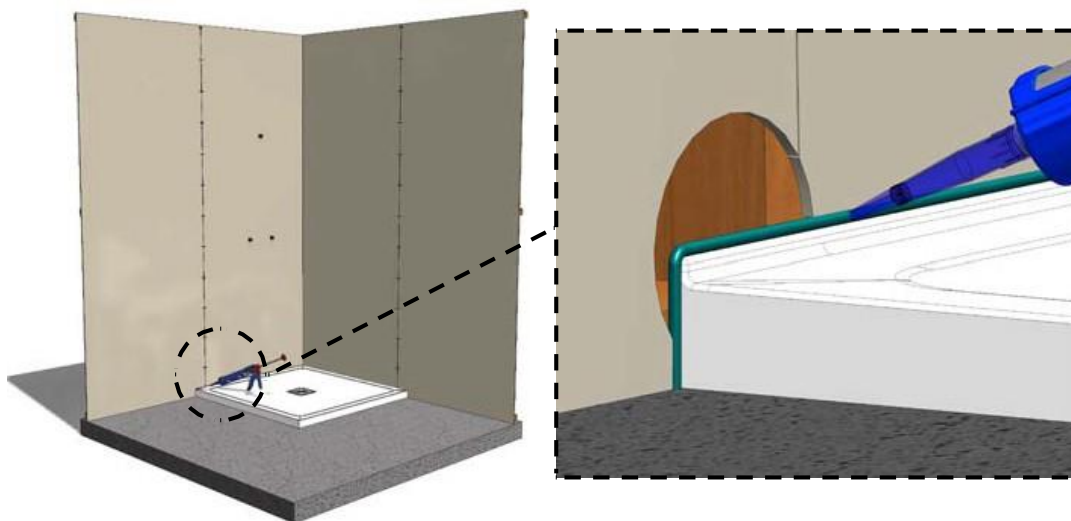

FOR STEEL STUD WALL FRAMES WITH ACRYLIC SHOWER WALL LINING APPLICATIONS - SEE BELOW

- NOTE: As a steel wall stud should not be cut, it is necessary to build out the wall level to clear the Shower Base tile bead thickness.
- A suitable WETBOARD product of no less than 12mm thickness is required to achieve the desired level. Use of either a 13mm Wet Area Plasterboard or 12mm Wet Area Fibre Cement sheet is advised.
- Install the chosen 12 or 13mm WETBOARD product bottom edge at least 6mm above the tile bead (as per relevant manufacturer's instructions).
- Once sheeting is completed, use a flexible waterproof sealant (not supplied) to seal the gap between the Shower Base tile bead and the WETBOARD.

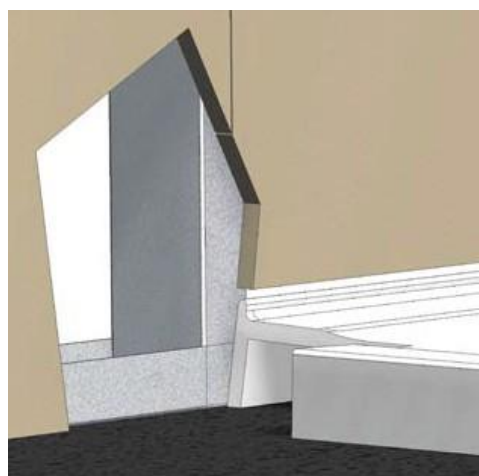

KADO

LUX SHOWER SYSTEM

9. ACRYLIC SHOWER WALL LINER INSTALLATION

DRILLING TAP HOLES IN ACRYLIC LINER

- Have a qualified tradesperson install the shower fittings. Mark the position of the holes for the fittings on acrylic shower wall liner.



- Large holes must be drilled with a FINE tooth hole saw.
- Holes should be drilled from the outside show face only

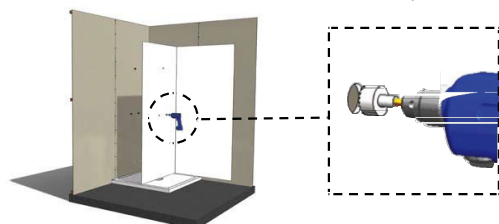

- Ensure all final hole sizes have at least a 2mm clearance around tap fittings for expansion.

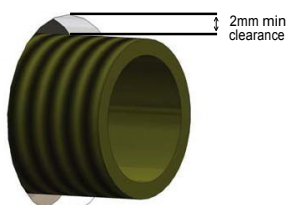

ATTACHING THE ACRYLIC SHOWER WALL LINER

Positioning Shower Wall Liner

- Trial position the shower wall liner against the shower recess, ensuring it fits squarely into the recess corner and shower base.
- Tape the corners with masking tape to hold the liner in position.
- Use a soft pencil to mark around the edges of the shower wall liner before removing.

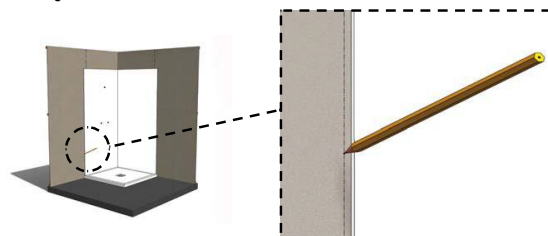

Adhering Shower Wall Liner

- Prepare area by wiping down the shower wall, base and wetboard ensuring it is clean and dry.
- The shower liner is adhered to the wetboard using Sika Showerbond adhesive supplied. ONLY this adhesive should be used on the wall liner, as other brands may fail over time. Please read the manufacturer's instructions on the back of the Showerbond cartridge before use.
- Using the marked pencil lines as your guide and starting from the outside, apply the adhesive as per diagram below. Apply a continuous 5mm bead of adhesive onto the Wetboard, 15mm minimum from the side and bottom edges. DO NOT PUT ANY ADHESIVE ALONG THE TOP EDGE, as this will seal the wall liner and not allow expansion of air to escape during use – causing buckling of the liner.
- Apply a bead of adhesive around the tap fittings, with 15mm clearance on all sides.

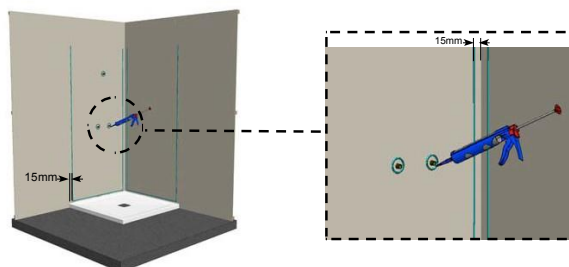

- Apply vertical lines of Showerbond adhesive on the wetboard, 100mm apart to cover the remainder of the wall liner area.

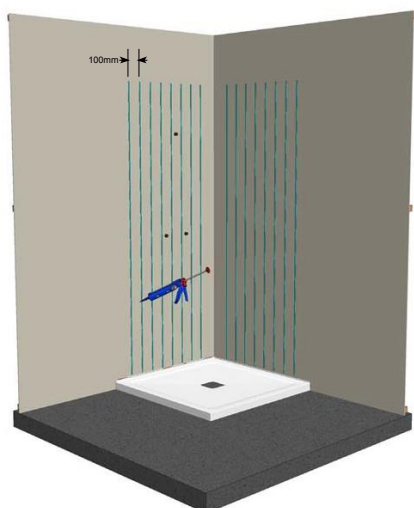

- Before fitting the shower wall liner, apply a bead of silicone sealant supplied along the inside face of the tile bead upstand of the shower base as shown below.

NOTE:
THE SILICON SHOULD NOT BE VISIBLE ONCE THE WALL IS FITTED

NOTE:
Store silicon for use the following day.

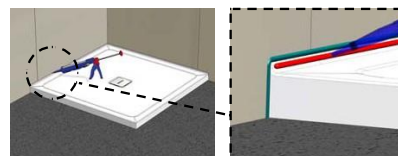

FIXING SHOWER WALL LINER



YOU WILL ONLY HAVE 20 MINUTES TO COMPLETE THE GLUEING PROCESS

- Place the wall lining into position ensuring that the corner area is pressed into place first. Note the bottom edge of the shower wall liner should be sitting hard on the shower base, in front of the tile bead.
- Remove the shower wall liner from position for approximately 5 seconds to allow the adhesive to aerate.
- Reposition the shower wall liner. Use a damp cloth and press towards the edges to ensure full contact has been made over the entire shower liner area.
- Ensure site is left for 20 minutes to cure and then brace as required to hold in position.
- Bracing should remain in position for not less than 18 hours for complete curing.

AFTER INSTALLATION

Once wall lining adhesion is fully cured, remove the protective film on the shower wall liner completely.

- The protective film on the remainder of the Shower Base can also be removed and the Chrome Waste Cover fitted.
- Apply silicone sealant provided around the tap hole penetrations to waterproof the gaps. A qualified tradesperson can now fit the tap sets over the wall liner.
- DO NOT USE THE SHOWER FOR AT LEAST 24 HOURS AFTER FINAL INSTALLATION TO ALLOW FOR FULL CURE.
- Refer to Section 13 for Cleaning and Maintenance Instructions.

KADO

LUX SHOWER SYSTEM

10. SHOWER BASE INSTALLATION FOR TILE WALL APPLICATIONS

For tile wall applications it is important that the bottom edge of the wetboard sheet sits in front of the shower base tile bead - the following steps are required to prepare the wall

WALL PREPARATION FOR TIMBER STUD WALL FRAMES ON TILE LINING INSTALLATIONS

- Locate the shower base against the timber stud wall and mark the position of the base along the studs and down the shower base sides at a distance of 10mm greater with a pencil.

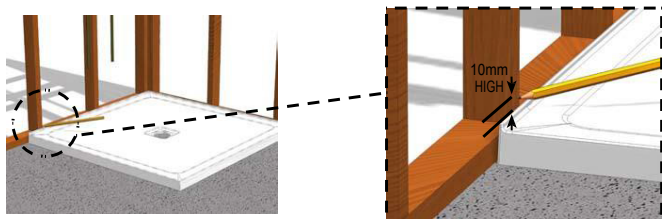

- With a chisel, check out the timber frame to a depth of between 10-15mm. This allows the shower base tile bead to sit behind the final wet board sheeting for waterproofing.

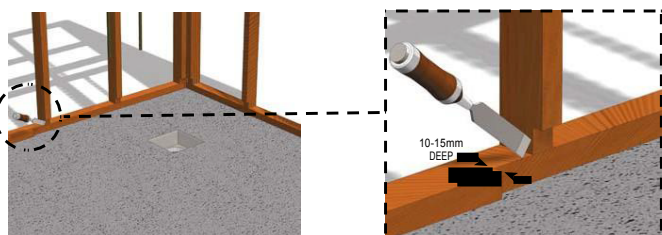

TRAY INSTALLATION FOR TILE WALL APPLICATIONS -

- Refer Steps A - G Section 10
- Allow the Shower Base to cure for at least 24 hrs as per the adhesive manufacturer's instructions before installing the wall sheeting. This ensures the shower base level will not change by standing on it.
- Once the Shower Base bond is fully cured, the Wet area sheeting can be applied over the Shower Base tile bead as per the relevant Wet Board manufacturer's instructions. The Wetboard should sit over the front of the tile bead. Ensure the Wetboard is installed at least 6mm above the shower base floor level for expansion.

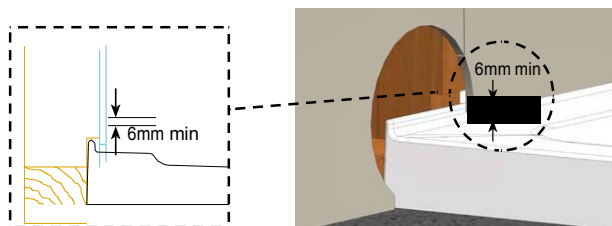

- Once sheeting is completed, use a flexible waterproof sealant (not supplied) to seal the gap between the Shower Base and the Wetboard.

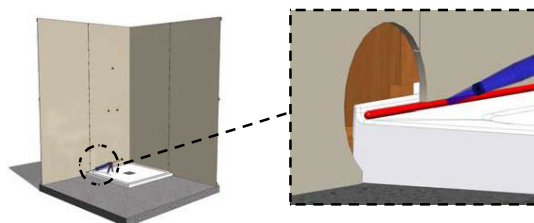

WALL PREPARATION FOR STEEL STUD WALL FRAMES ON TILE WALL INSTALLATIONS - SEE BELOW

- NOTE: As a steel wall stud should not be cut, it is necessary to build out the wall level to clear the Shower Base tile bead thickness. On top of this a thinner 6mm wetboard is installed down inside the tile bead, this will provide support behind the bottom row of tiles. (See instructions below)
- A suitable WETBOARD product of no less than 12mm thickness is required to achieve the desired level. Use of either a 13mm Wet Area Plasterboard or 12mm Wet Area Fibre Cement sheet is advised.
- Install the chosen 12 or 13mm WETBOARD product bottom edge at least 6mm above the tile bead (as per relevant manufacturer's instructions).
- Once completed the final 6mm WETBOARD sheet can be installed onto the 12 or 13mm WETBOARD. Ensure the 6mm WETBOARD is installed at least 5-6mm above the shower base for expansion.
- Once sheeting is completed, use a flexible waterproof sealant (not supplied) to seal the gap between the Shower Base and the 6mm WETBOARD.

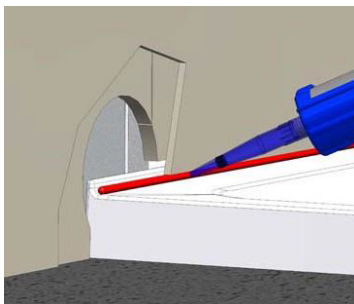

- The Shower recess is now ready for tiling. Once tiling is completed, the protective film can be further removed to allow for the shower screen installation. Once the screen installation is complete, the remainder of the protective film can be removed and the Chrome Waste Cover fitted.
- Refer to Section 13 for Cleaning and Maintenance Instructions

11. CLEANING & MAINTENANCE

If your Kado Shower Base or Shower wall are given the proper care, the lustrous surface of the Lucite sheet will retain its appearance for many years.

It is very easy to clean using clear water with a small amount of detergent or mild soap. Chamois, soft cloth or sponge is suitable for cleaning but cloths must never be used dry.



Do not use window cleaner, benzene, toluene, acetone, methyl ethyl ketone or strong concentrated acids, etc

Do not use abrasive substances and abrasive cleaners.

To remove paint, grease or tar use a good grade of Isopropyl alcohol.

Fine hairline scratches may be minimized by the use of a mild polish such as Brasso, which has a mild abrasive action and tends to fill small scratches to make them less visible.

KADO

LUX SHOWER SYSTEM

INSTALLATION INSTRUCTIONS - SHOWER SCREEN

Important Note

The Kado Lux Shower Base can not be used with a Plumbdinger or Flexidinger

INSTRUCTION MANUAL- RECTANGULAR AND SQUARE KADO WITH EZICLEAN

Important Pre-Installation Information

- Please read this entire instruction booklet before commencing installation.
- A licenced tradesman must be used for the installation.
- Ensure there is a gasket between all glass and metal components.
- Leave the plastic protectors on the glass corners until the last possible moment.
- Instructions to install the shower tray are included with the shower tray.
- In cold climates, warming the gaskets and seals with hot water or a hairdryer will assist installation.
- On the symmetrical panes of glass (fixed panels fitted in step 2), the EziClean coating is only on one face. This face will have a sticker on it to identify it. This side must be installed on the wet side of the shower.

Maintenance

- The use of harsh or abrasive cleaners will cause deterioration of the EziClean coating. If water alone is not enough to clean the glass, Decina recommends the use of mild detergent solutions only.

Tools Required

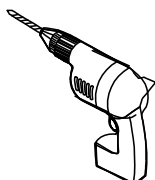

DRILL

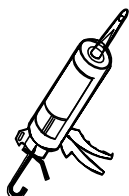

SILICONE



SCREWDRIVERS



MALLET



PENCIL

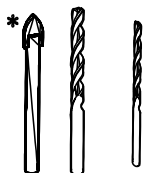

1/4" & 1/8" DRILL BITS

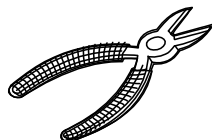

CUTTING PLIER

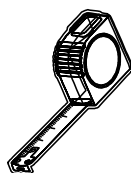

TAPE MEASURE

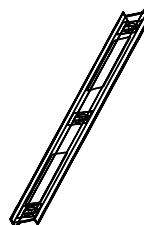

LEVEL



UTILITY KNIFE

* Use the correct type of drill bit for the material being drilled, with 6mm used for anchor fixing and 3mm used for screwing directly into the wall studs.

KADO

LUX SHOWER SYSTEM

INSTRUCTION MANUAL-RECTANGULAR AND SQUARE KADO WITH EZICLEAN

Parts List

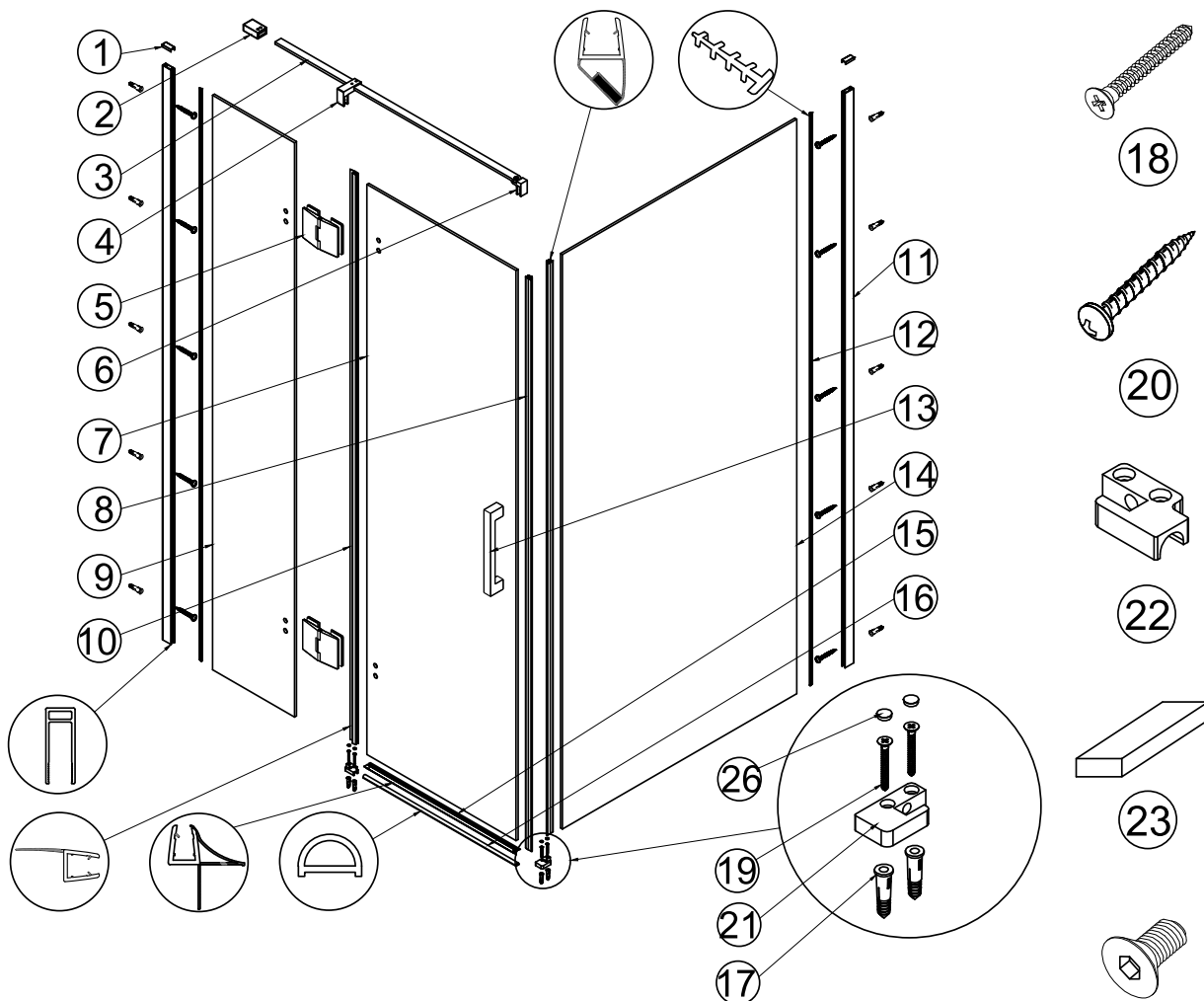

No.	Description	Quantity
1	Channel Cap	2
2	Brace Anchor	1
3	Brace	1
4	Brace Middle Bracket	1
5	Hinge Assembly	2
6	Brace End Bracket	1
7	Door Glass	1
8	Magnetic Door Seal	2
9	Front Panel Glass	1
10	Hinge Side Door Gasket	1
11	Wall Channel	2
12	Wall Channel Gasket	2
13	Handle	1
14	Side Panel Glass	1

No.	Description	Quantity
15	Door Drip Strip	1
16	Doorway Rail	1
17	Wall Anchor	16
18	Countersunk ST4x40mm Screw	2
19	Countersunk ST4x20mm Screw	4
20	Phillips Head Screw ST4x40mm	10
21	Side Rail Retainer	2
22	Front Rail Retainer	2
23	Door Glass Support Block	1
24	M6x12 Countersunk Socket Screw	1
25	Gasket Insertion Tool	1
26	Rail Retainer Cover	4
27	Hinge Screw Cover	8

KADO

LUX SHOWER SYSTEM

INSTRUCTION MANUAL-RECTANGULAR AND SQUARE KADO WITH EZICLEAN

Determining Wall Channel Location

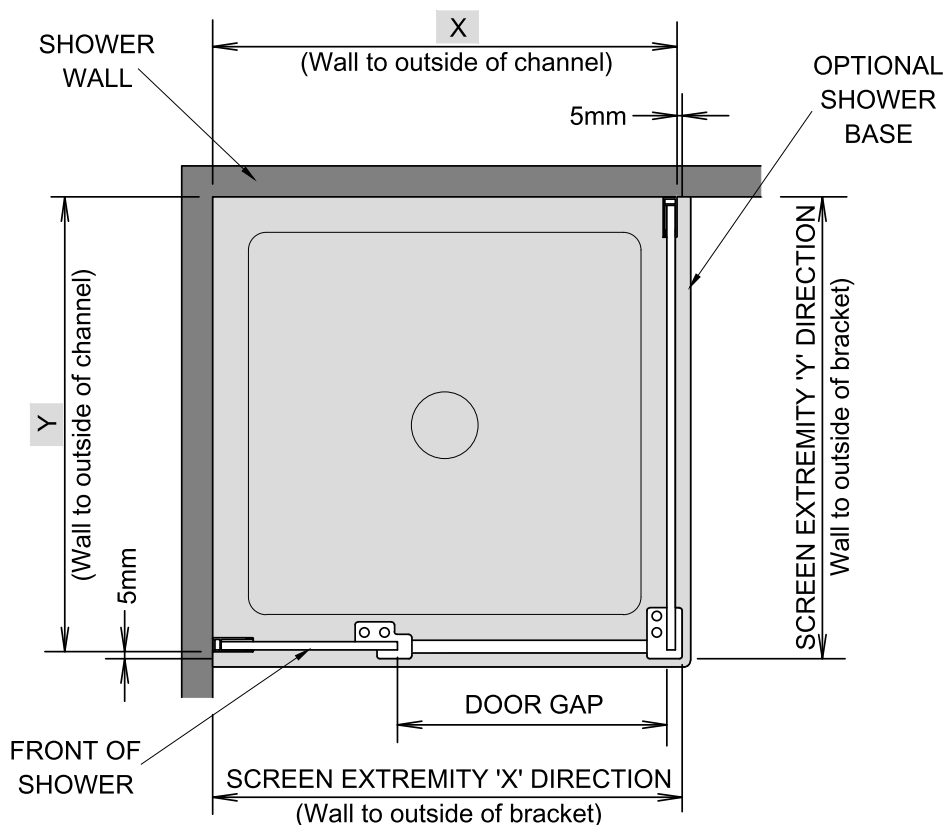

Screen Size	X (mm)	SCREEN EXTREMITY IN 'X' DIRECTION (mm)	Y (mm)	SCREEN EXTREMITY IN 'Y' DIRECTION (mm)	DOOR GAP
1000 x 1000	950±5	X+5(i.e.955±5)	950±5	X+5(i.e.955±5)	620±1mm
1200 x 900	1150±5	X+5(i.e.1155±5)	850±5	X+5(i.e.865±5)	655±1mm

- Locate the size of your shower screen in column 1 and use the value for X and Y on the same line to find the distance from the shower wall to the outside edge of the wall channels. If a shower base is fitted, do not measure from the edge of the shower base to determine the position of the wall channel.
- If your wall and shower base are not at right angles, the glass will not push fully into the wall channel at either the top or bottom. This misalignment is acceptable if not exceeding 15mm, however the overall shower size will then increase by the amount of this misalignment.
- If the screen footprint does not turn out to be square, the glass can be pulled out from the full depth of the wall channel by up to 15mm to assist squaring.
- The dimension given for the door gap is required to achieve the best closure of the door. If the figure cannot be achieved by manipulation of the glass and the gap is larger than required, the magnetic door seal may be pulled off the glass by up to 4mm to assist in achieving satisfactory closing.

KADO

LUX SHOWER SYSTEM

INSTRUCTION MANUAL-RECTANGULAR AND SQUARE KADO WITH EZICLEAN

1

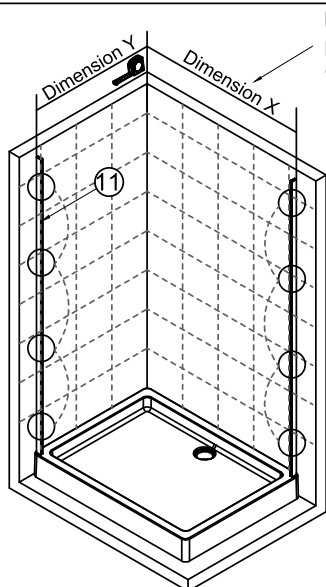

Important - See page 3 for the dimensions.

Install the wall channel.

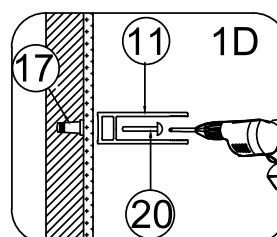
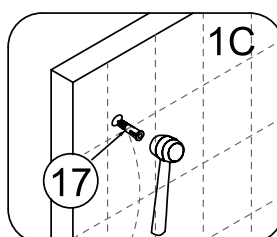
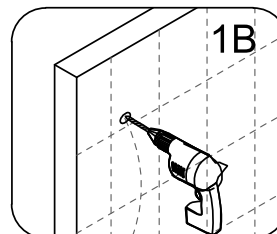
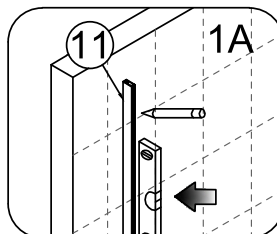

2

Important Warning: Leave the glass corner protectors on until the last moment.

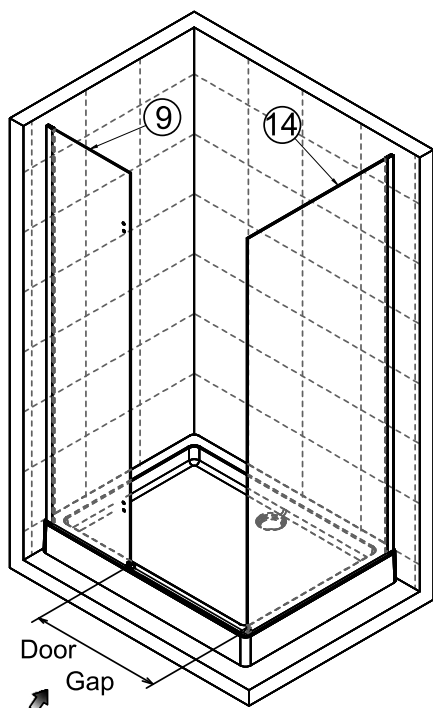

Installation Tip: Refer to the drawing on page 3 which shows the size of the gap between the glass panels that is required for door installation.

Trial fit the fixed glass panels to determine the location of the rail retainers.

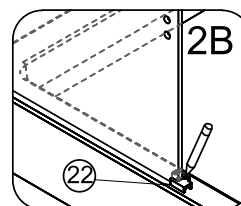
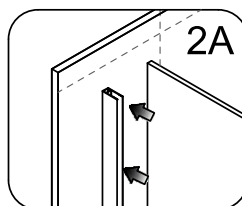

For installation on tile floors, screw down the retaining brackets (21, 22), and seal under them and the doorway rail (16) with silicone as shown following. For acrylic trays, do not screw down, only use silicone.

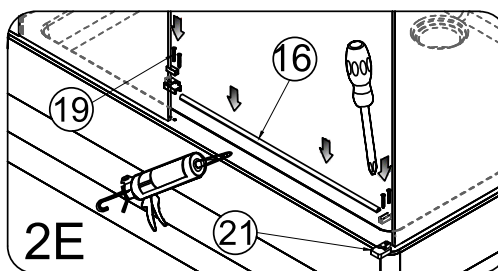
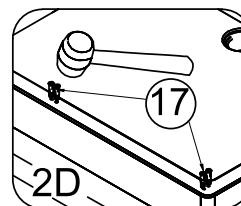
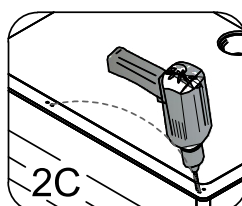

KADO

LUX SHOWER SYSTEM

INSTRUCTION MANUAL-RECTANGULAR AND SQUARE KADO WITH EZICLEAN

3

Install the wall channel gasket.

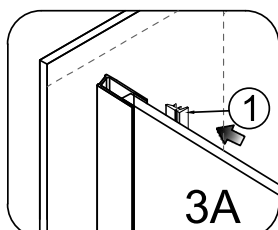

Start at the bottom and work up with the supplied insertion tool.

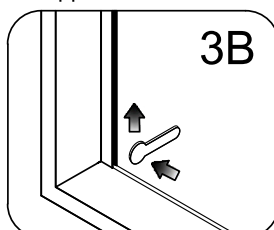

Important: Seal must be fully inserted.

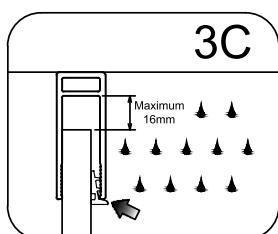

Install both hinges to the fixed glass, ensuring the gasket is used against the glass.

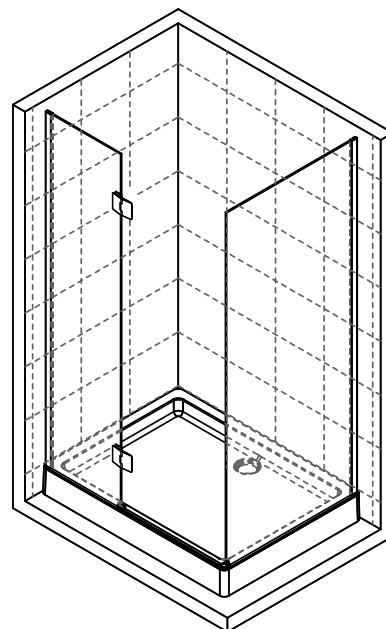
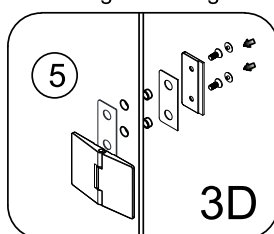

4

Refer to the diagram to the right for brace assembly. Make sure there is a plastic protector between the glass and brackets.

- 4A - Trial fit the brace in a level position.
- 4B - Mark mounting holes.
- 4C - Drill mounting holes.
- 4D - Insert wall anchors.
- 4E - Screw brace anchor to wall.
- 4F - Complete final assembly of the brace, ensuring the clear gasket is against the glass.

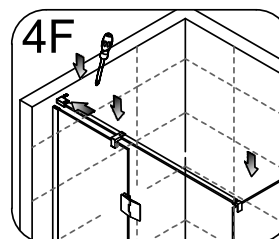
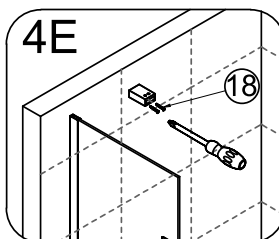
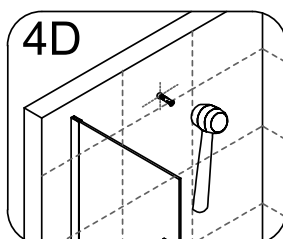
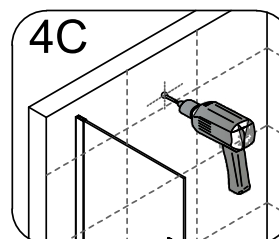
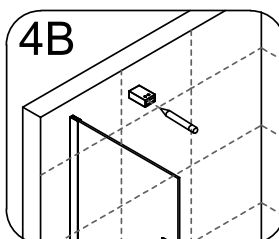
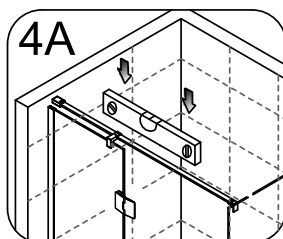
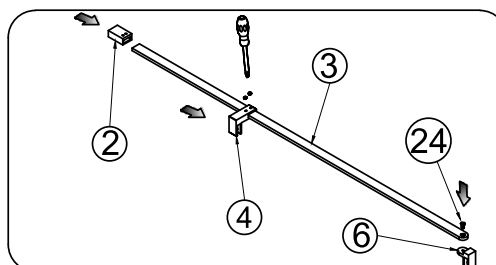

KADO

LUX SHOWER SYSTEM

INSTRUCTION MANUAL-RECTANGULAR AND SQUARE KADO WITH EZICLEAN

5

Fit the drip seal to the door:

1. **Important:** Leave the plastic corner protectors on until the last possible moment.
2. Measure the length required, allowing space for the vertical seals to be installed all the way to the bottom of the door.
3. Cut the seal to length.
4. **Important:** The door is not symmetrical. Determine which way up the door will be for the hinges to attach correctly.
5. Push on the drip seal, with the side wing on the shower (wet) side of the door, as shown.

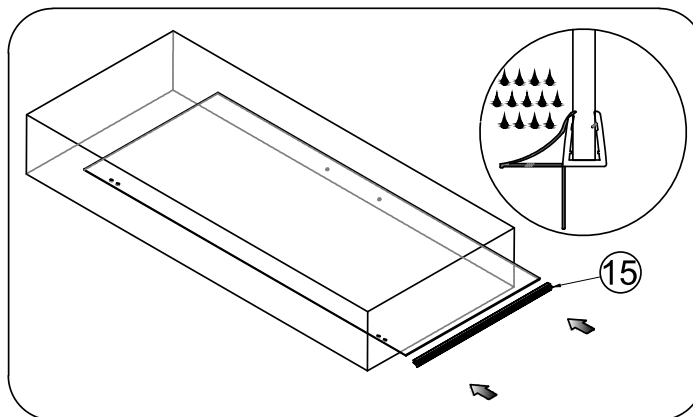

6

Use the block supplied to help support the weight of the door.

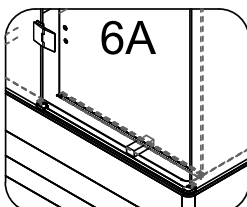

Secure the hinges to the door, ensuring that the clear gasket is installed between the glass and hinge.

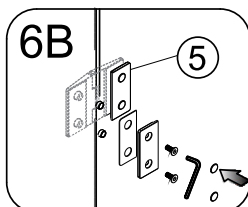

Fit the caps to the wall channels.

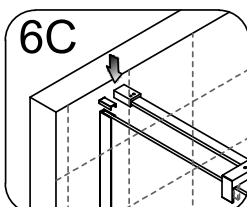

Fit the screw covers to the rail retainers.

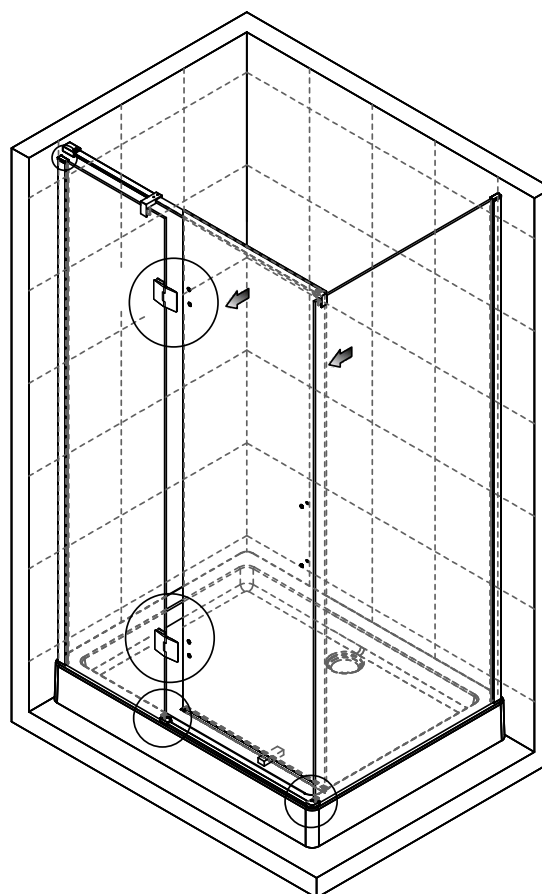
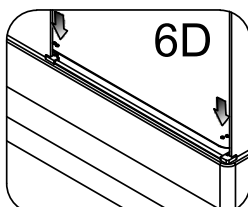

KADO

LUX SHOWER SYSTEM

INSTRUCTION MANUAL-RECTANGULAR AND SQUARE KADO WITH EZICLEAN

7

Trim the magnetic door seals to the correct length and fit to both the door and the side panel glass.

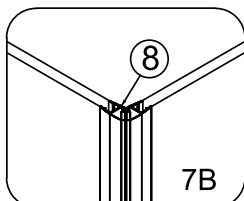
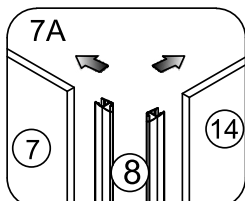

Trim the hinge side door gasket and push onto the door between the door and the side panel.

Install the handle on the door, ensuring that the clear gaskets are between the metal and glass.

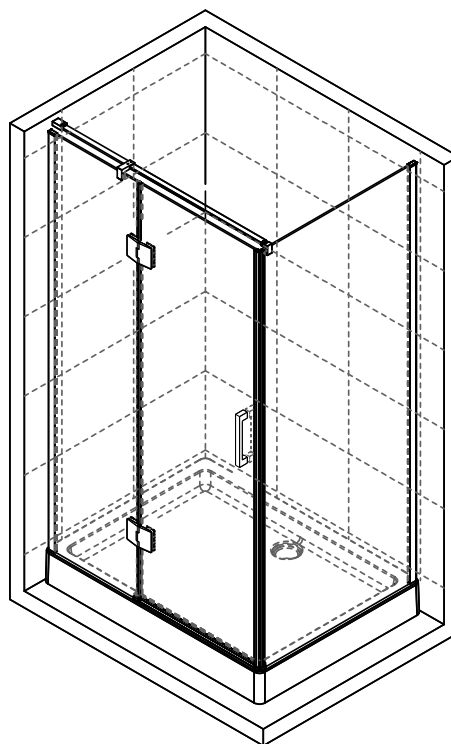
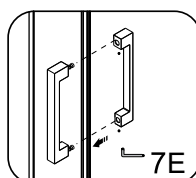
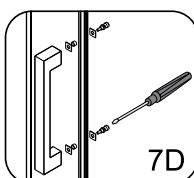
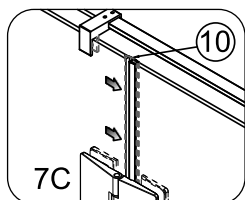

8

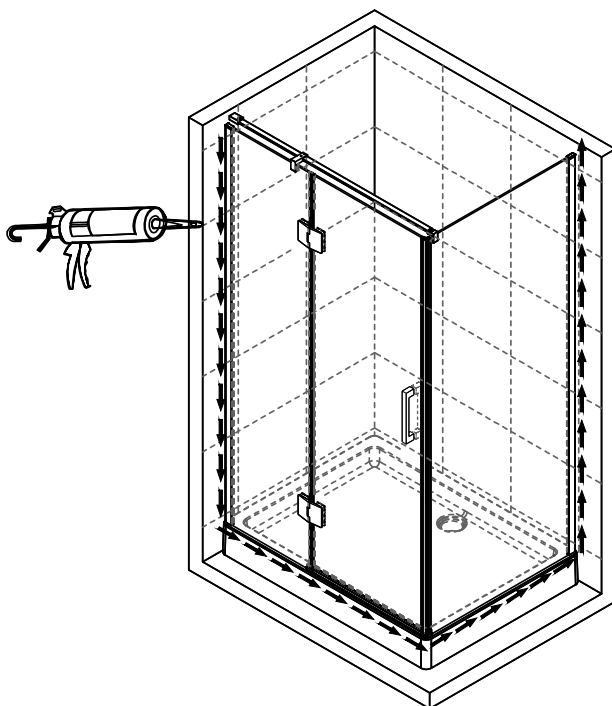

Silicone the inside and outside of the shower, and allow 24 hours before use.

KADO

LUX SHOWER SYSTEM



REECE PRODUCT QUALITY GUARANTEE

You have purchased a quality product from Reece Pty Ltd ABN 84 004 097 090 ("Reece"). This product is covered by a 7 year replacement product warranty and a 12 month warranty over spare parts and labour.

7 YEAR WARRANTY – DOMESTIC USE

This warranty covers faults in the product construction, material and assembly. Products which are within 7 years from the date of purchase, found upon inspection by an authorised Reece representative, to be defective in construction, material or assembly, will be repaired or exchanged with an equivalent product free of charge. Replaced items become Reece's property.

All replacement products will be available for collection without charge to the customer at the nearest Reece branch to the customer's location, or elsewhere as agreed between the customer and Reece.

Labour and Spare Parts

The labour for the replacement of products and spare parts to which this warranty applies will be supplied by Reece or relevant supplier using licensed plumbers engaged by Reece or relevant supplier within 1 year from the date of purchase.

Labour will not be covered for removable items such as door drip seal. This item is removable for cleaning purposes.

Spare parts which are within 1 year from the date of purchase found upon inspection by an authorised Reece representative to be defective in construction, material or assembly, will be replaced free of charge.

Warranty Conditions

This warranty will apply only under all of the following conditions:

- The item has been installed by a licensed plumber
- The item has been installed for and subjected to domestic residential use only
- Failure is due to a fault in the manufacture of the product
- Proof of purchase (including the date of purchase) is provided
- The installation of the product is in accordance with the instructions provided
- This warranty does not cover products purchased as an ex-display without being fully checked and tested for sale by the manufacturer.
- This warranty does not include faults caused by:
- Unsuitable or improper use
- Incorrect installation or installation not in accordance with the instructions provided

- Installation or part installation by the purchaser or any person other than a LICENSED PLUMBER
- Normal wear and tear
- Inadequate or complete lack of maintenance
- Chemical, electrochemical or electrical influences
- Harsh detergents or abrasive cleaners used on product finishes

1 YEAR WARRANTY – COMMERCIAL USE

'Commercial' use is all use other than for normal domestic residential purposes, including use in non-business places as in public buildings, schools, sports centres and in establishments that contain private bathrooms with high frequency of use by many individuals, such as hotels, motels, retirement villages and hospitals.

The Commercial warranty covers this product against manufacturing faults in the construction, material and assembly of both the finished products and any spare parts for a period of 1 year from the date of purchase. Products and spare parts which are found upon inspection by an authorised Reece representative to be defective in construction, material or assembly will be repaired or exchanged free of charge. Replaced items become Reece's property. The labour for the replacement of products and spare parts to which this warranty applies will be supplied by Reece or relevant supplier using licensed plumbers engaged by Reece or relevant supplier. The Warranty Conditions and exclusions which apply to the domestic use warranty also apply to this commercial warranty.

EXCLUSIONS

To the fullest extent permitted by law, Reece excludes all liability for damage or injury to any person, damage to any property, and any indirect consequential or other loss or damage.

CLAIM PROCEDURE

For all warranty queries customers are to contact the branch where the product was purchased. These details can be found on your purchase invoice.

Our goods come with guarantees that cannot be excluded under the Australian Consumer Law. You are entitled to a replacement or refund for a major failure and for compensation for any other reasonably foreseeable loss or damage. You are also entitled to have the goods repaired or replaced if the goods fail to be of acceptable quality and the failure does not amount to a major failure.