

AXA

QUATTRO CC BTW TOILET SUITE

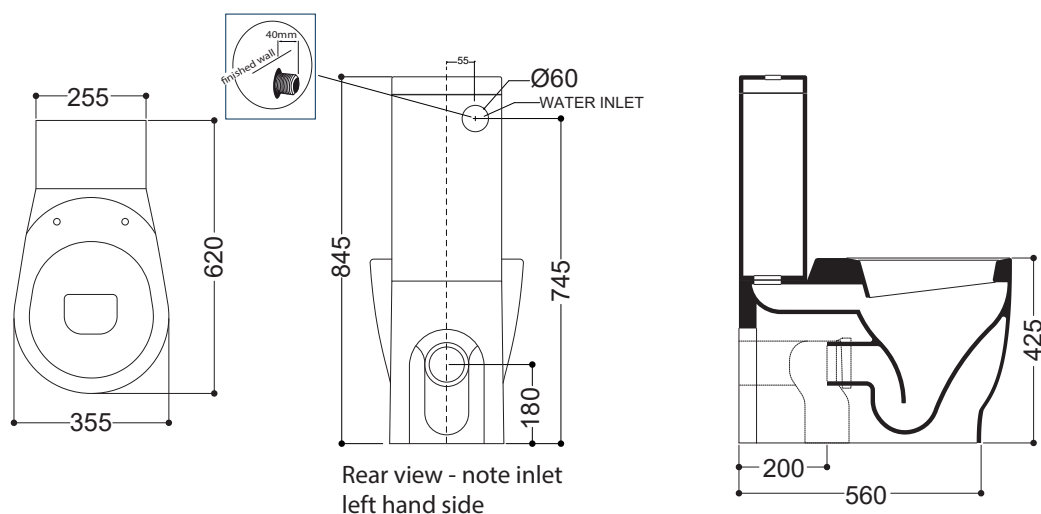

SPECIFICATIONS

Recommended use	Domestic, hotel and commercial
Colour availability	White
Rim configuration	Open rim
Bowl configuration	P Trap (converts to S using plastic S-bend provided)
Set out	S Trap: 200mm P Trap: 180mm fixed
Pan fixing	Screwed to floor using brackets supplied and bedded with sealant
Cistern fixing	Bolted directly to pan
Seat	Matching top fix seat supplied with suite (soft close)
Material	Vitreous china
Weight	Pan: 29.5kg Cistern: 12kg
Standards	AS 1172.1 and AS 1172.2
Water inlet	Back inlet, left hand side
Cistern	4.5/3 litre dual flush
Inlet valve	Rec. max working pressure 1000kPa
Warranty	15 years (refer to warranty)



To see the complete Axa range go to www.reece.com.au/bathrooms

CLEANING RECOMMENDATIONS

We recommend the use of soapy water or approved bathroom cleaners. This bathroom product should not be cleaned with abrasive materials. Damage caused by any improper treatment is not covered by the product warranty - refer to Warranty Conditions on the last page.

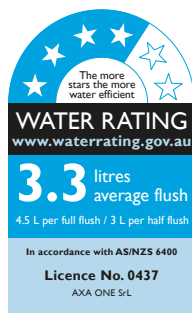

Disclaimer: Products in this specification manual must by regulation be installed by licensed and registered trade people. The manufacturer/distributor reserves the right to vary specifications or delete models from their range without prior notification. Dimensions are nominal measurements only. Dimensions and set-outs listed are correct at time of publication however the manufacturer/distributor takes no responsibility for printing errors.

Tech Page Version 1

AXA

reece

AXA

QUATTRO CC BTW TOILET SUITE

INSTALLATION INSTRUCTIONS

Note

All measurements for roughing in should be taken from finished wall/floor. Dimensions shown are nominal measurements only.

1. Rough in positions of water inlet and waste outlet (fig 1). Ensure Inlet connection extends 40mm from finished wall.
2. Mark out and drill floor fixing brackets into position (150mm apart, 275mm from the finished wall). Mark out and prepare plate, rod and plastic bend if installing the waste through the floor (fig 3).
3. Fit foam seal to cistern and fit onto the pan. Use the fixings screws to secure it into position.
4. For S trap - insert 'S' bend into pan collar, fix the pan bend connector back to the wall using the rod and bracket (fig 3).
5. P Trap installation - Set up waste pipe and cut to length. Align and push pan back to wall, connecting pan spigot into pan waste bend. Install cistern to pan.
6. Ensure that pan is level and that cistern aligns with wall. Make minor adjustments if necessary.
7. Bucket flush and check for leaks.
8. Connect rear water inlet valve and flexible hose with elbow (supplied). Fill the cistern and ensure correct water level. For adjustment refer separate instructions for inlet valve.
9. Fix pan to floor using screws and caps provided.
10. Seal around base of pan with flexible sealant.

Installation of Toilet Seat and Cleaning (separate instructions enclosed)

It is recommended that toilet seat and cover be installed after all trades are finished. The high quality vitreous china finish on this sanitary ware can be maintained by simply using mild soapy water and wiping over. No abrasive cleaners or chemicals should be used on vitreous china surface or toilet seats as this may lead to surface damage.

Do not use any toilet cleaners in the cistern. As the chemical compound may effect the internal mechanisms.

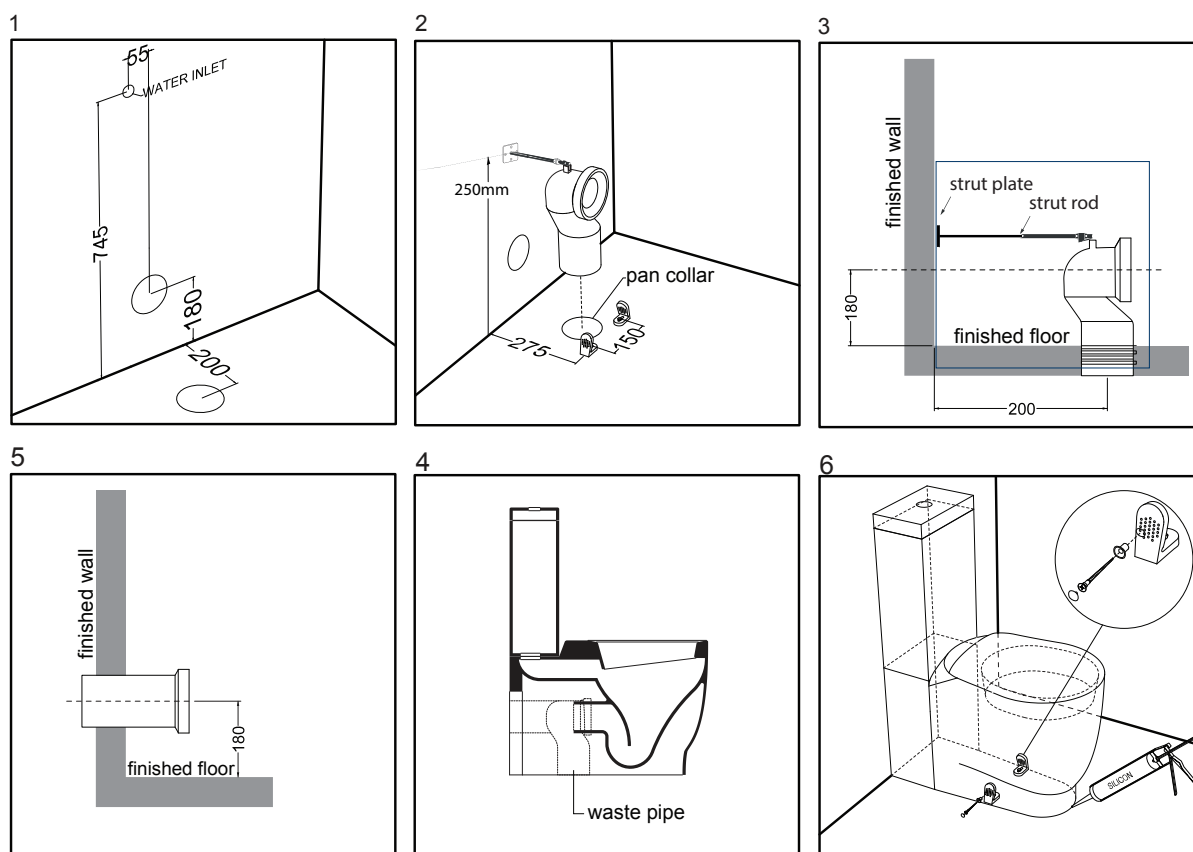

AXA

QUATTRO CC BTW TOILET SUITE



REECE PRODUCT QUALITY GUARANTEE

You have purchased a quality product from Reece Pty Ltd ABN 84 004 097 090 ("Reece"). This product is covered by a 15 year replacement product warranty and a 12 month warranty over spare parts and labour.

15 YEAR WARRANTY – DOMESTIC USE

This warranty covers faults in the product construction, material and assembly. Products which are within 15 years from the date of purchase, found upon inspection by an authorised Reece representative, to be defective in construction, material or assembly, will be repaired or exchanged with an equivalent product free of charge. Replaced items become Reece's property.

All replacement products will be available for collection without charge to the customer at the nearest Reece branch to the customer's location, or elsewhere as agreed between the customer and Reece.

Labour and Spare Parts

The labour for the replacement of products and spare parts to which this warranty applies will be supplied by Reece or relevant supplier using licensed plumbers engaged by Reece or relevant supplier within 1 year from the date of purchase.

Spare parts (includes the toilet seat) which are within 1 year from the date of purchase found upon inspection by an authorised Reece representative to be defective in construction, material or assembly, will be replaced free of charge..

Warranty Conditions

This warranty will apply only under all of the following conditions:

- The item has been installed by a licensed plumber
- The item has been installed for and subjected to domestic residential use only
- Failure is due to a fault in the manufacture of the product
- Proof of purchase (including the date of purchase) is provided
- The installation of the product is in accordance with the instructions provided

This warranty does not cover products purchased as an ex-display without being fully checked and tested for sale by the manufacturer.

This warranty does not include faults caused by:

- Unsuitable or improper use
- Incorrect installation or installation not in accordance with the instructions provided
- Installation or part installation by the purchaser or any person other than a LICENSED PLUMBER
- Normal wear and tear
- Inadequate or complete lack of maintenance
- Chemical, electrochemical or electrical influences
- Harsh detergents or abrasive cleaners used on product finishes

1 YEAR WARRANTY – COMMERCIAL USE

'Commercial' use is all use other than for normal domestic residential purposes, including use in non-business places as in public buildings, schools, sports centres and in establishments that contain private bathrooms with high frequency of use by many individuals, such as hotels, motels, retirement villages and hospitals.

The Commercial warranty covers this product against manufacturing faults in the construction, material and assembly of both the finished products and any spare parts for a period of 1 year from the date of purchase. Products and spare parts which are found upon inspection by an authorised Reece representative to be defective in construction, material or assembly will be repaired or exchanged free of charge. Replaced items become Reece's property. The labour for the replacement of products and spare parts to which this warranty applies will be supplied by Reece or relevant supplier using licensed plumbers engaged by Reece or relevant supplier. The Warranty Conditions and exclusions which apply to the domestic use warranty also apply to this commercial warranty.

EXCLUSIONS

To the fullest extent permitted by law, Reece excludes all liability for damage or injury to any person, damage to any property, and any indirect consequential or other loss or damage.

CLAIM PROCEDURE

For all warranty queries customers are to contact the branch where the product was purchased. These details can be found on your purchase invoice.

Our goods come with guarantees that cannot be excluded under the Australian Consumer Law. You are entitled to a replacement or refund for a major failure and for compensation for any other reasonably foreseeable loss or damage. You are also entitled to have the goods repaired or replaced if the goods fail to be of acceptable quality and the failure does not amount to a major failure.

TOILET. T2.15YR