



Materials & Features

Suitable for commercial and residential applications, the seat is closed front with lid designed to fit standard, elongated and bariatric toilet pans. The extra wide base allows more even weight distribution increasing comfort for the user. Unit incorporates Stainless Steel hinges and non-slip bumpers to prevent wobbling and increase stability.

Technical Detail

Seat: Injection moulded high impact ABS
Hinges: Type 304 Stainless Steel
SWL: 540kg

Compliance

ANSI Z124.5-2013

Available Model

RBA8186-853

'Big John' Bariatric Toilet Seat, Stainless Steel hinges

Related Products

RBA8851-137

Bariatric Stainless Steel Toilet, Enviro-Glaze® White

RBA4007-112

Bariatric Drop Down Grab Rail, LH

Note: Due to the size of this injection moulded seat and lid, from time to time there may be formlines evident.

Important: Installation instructions and current rough-in details should be furnished with each fixture. Do not rough in without certified dimensions. Dimensions are subject to manufacturer's tolerance of +/-10mm.

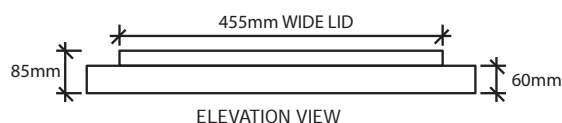
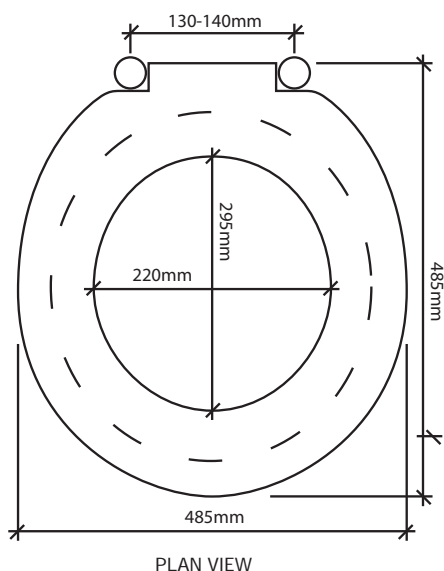

* All dimensions in mm

