

FRANKE

DESIGNER UPRIGHT COOKER 90CM

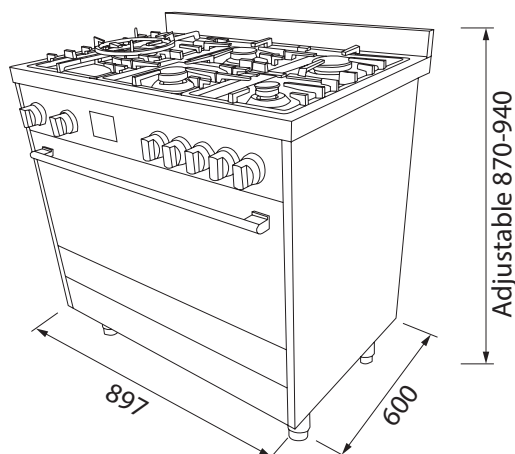

Dimensions are nominal measurements only.

SPECIFICATIONS

Recommended use	Domestic
Material	Stainless Steel
Colour availability	Stainless Steel
Weight	70kg
Dimensions	897 x 600 x 870-940mm
Voltage	220-240V / 50Hz
Burners	5 includes side 5kw WOK burner
Gas type	Natural and LPG
Oven type	Electric
Timer	Digital
Oven functions	11
Flame failure	Yes
Cast iron pan support	Yes
Automatic ignition	Yes
Power cord length	1900mm



To see the complete FRANKE range go to
www.reece.com.au/bathrooms

CLEANING RECOMMENDATIONS

We recommend the use of soapy water or approved cleaners.

This product should not be cleaned with abrasive materials.

Damage caused by any improper treatment is not covered by the product warranty. Refer to Warranty Conditions.

FRANKE

DESIGNER UPRIGHT COOKER 90CM

INSTALLATION INSTRUCTIONS

IMPORTANT INFORMATION FOR INSTALLING AND SERVICING THE APPLIANCE

The cooker can be installed separately, as a freestanding unit, or between kitchen units or between a kitchen unit and the wall.

This appliance is not connected to devices which exhaust combustion products.

Special attention must be focused on the prescriptions described below regarding room aeration and ventilation.

The dimensions of the appliance are listed below:

LENGTH	DEPTH	HEIGHT with worktop stamped	HEIGHT with worktop welded
897mm	600mm a	djustable 870-940mm a	djustable 890-960mm

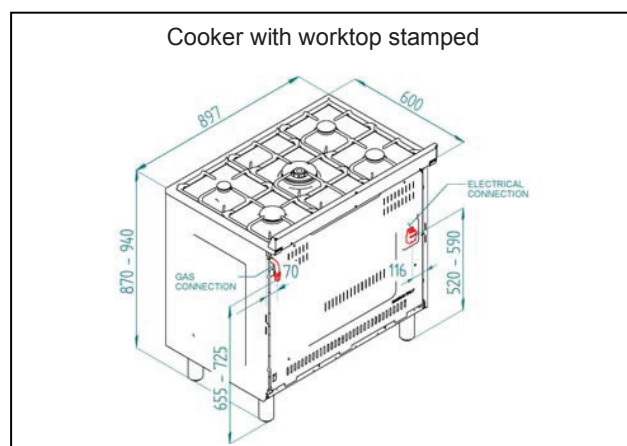

Fig.2

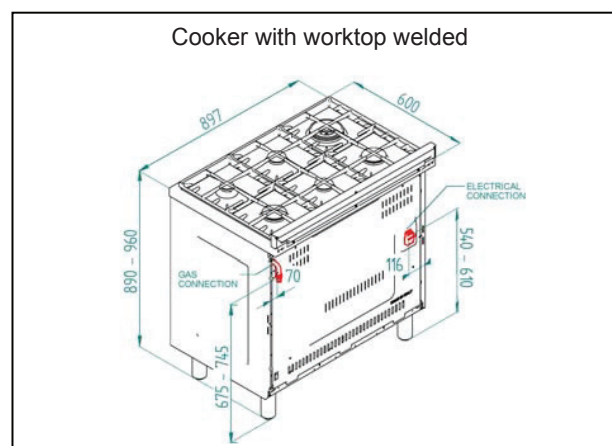

Fig.3

APPLIANCE GAS CONNECTION

IMPORTANT: This appliance must be installed by an authorised person.

WARNING: DO NOT MODIFY THIS APPLIANCE

If the appliance cannot be adjusted to perform correctly, contact the service department.

This appliance utilises a threaded 1/2" gas male fitting.

To connect the appliance to the gas network with a flexible hose, a supplemental hose nipple fitting is needed which is supplied with the appliance. (Fig. 07)

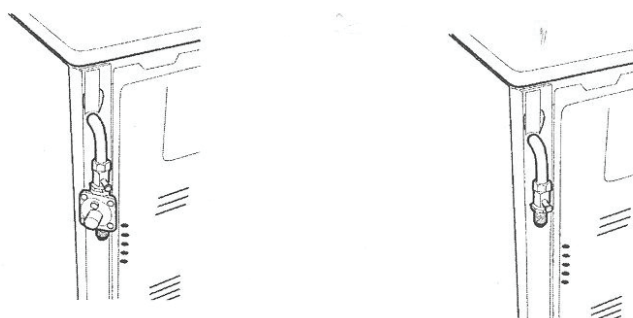

FIG. 07

Gas inlet positions with different leg heights – mm

Gas inlet (mm) - Nat gas

From RH rear side: 70 mm

Up from floor cooker with worktop stamped: 655 - 725mm

Up from floor cooker with worktop welded: 675 - 745mm

Gas inlet (mm) – ULPG

From RH rear side: 70mm

Up from floor cooker with worktop stamped: 570 - 640mm

Up from floor cooker with worktop welded: 590 - 660mm

Gas Regulator

The gas connection is via 1/2" tapered thread. Connect the cooker to the gas supply and test for leaks. NEVER use a naked flame to check for gas leaks.

Natural Gas: Gas regulator supplied with the appliance must be installed.

ULPG: Test point adaptor to be fitted and checked at time of installation.

Plumbers, please ensure a copy of the installation instructions is left with the end user for future reference

FRANKE

DESIGNER UPRIGHT COOKER 90CM

INSTALLATION INSTRUCTIONS

SUPPORT LEGS AND BACKGUARD INSTALLATION

The cookers are supplied with four transit supports (one for each corner).

Four support legs are supplied separately and are fitted on location to the four corners of the lower support frame. Each support leg is pushed over the relevant transit support until flush with the support frame.

Each leg is adjusted by screwing the lower section in or out as required for fitting to a 900mm bench height. For lower bench tops adjust the height of the legs to 180mm so the hob is located 10mm above the horizontal combustible surface, ref. AS/NZS 5601.

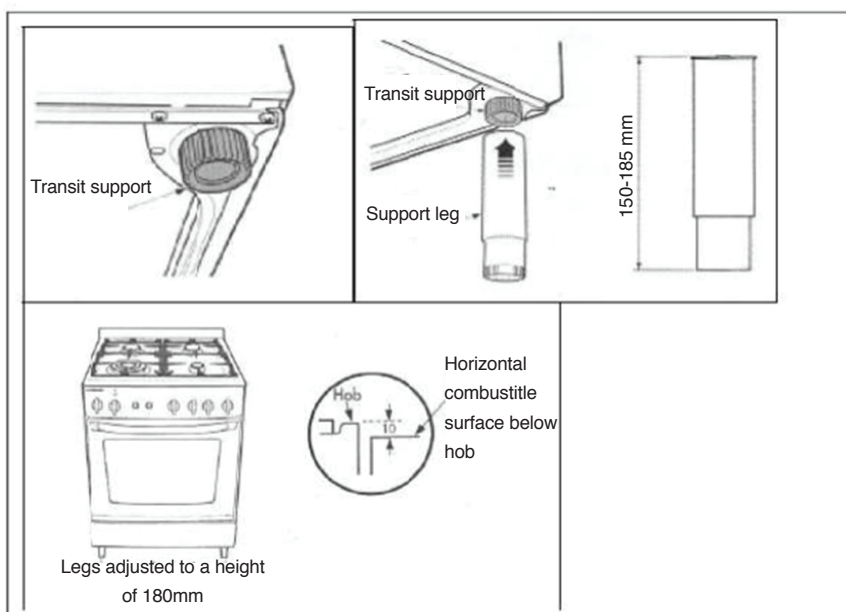

Fig. 08

- Legs should be installed with the appliance close to its final destination, as the legs are not designed for excessive force and will snap off if too much side force is exerted on them (dragging along or angled too much). When fitting, try to keep the appliance as close to a horizontal position as possible. Use of a pallet jack is recommended.
- If the legs are not used and the cooker is mounted onto a plinth, four transit supports allow for clearance.
- With the legs fitted, the backguard supplied with the appliance can be fitted.
- Follow the instructions shown in Fig. 09.

ATTENTION: TAKE CARE DO NOT OBSTRUCT THE OUTLET OPENING ON THE BACKGUARD; THEY MUST BE UNOBSTRUCTED FOR PROPER OPERATION.

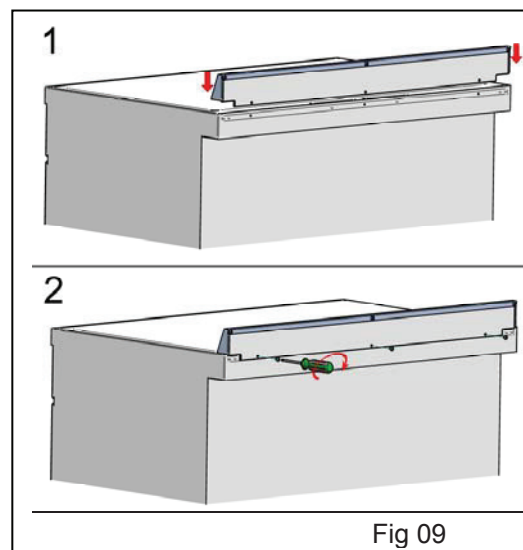
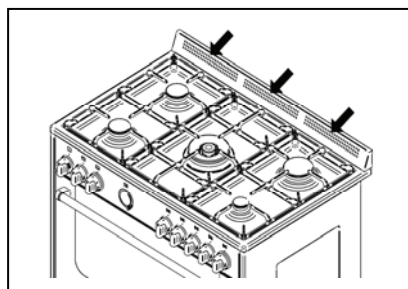

Fig 09

FRANKE

DESIGNER UPRIGHT COOKER 90CM

INSTALLATION INSTRUCTIONS

CONVERSION TO DIFFERENT TYPES OF GAS

Before performing any maintenance operation, disconnect the appliance from the gas supply and electricity network.

REPLACING THE NOZZLES TO OPERATE WITH ANOTHER TYPE OF GAS

When converting to ULPG remove the NG gas regulator (if fitted) and fit ULPG test point adaptor.

If converting to Natural Gas, fit gas regulator

Follow the instructions below to change the burner nozzles on the work surface:

- 1) Pull out the plug from the electric outlet to avoid any type of electric contact.
- 2) Remove the grids from the work surface (Fig. 11).
- 3) Remove the burners (Fig. 11).
- 4) Unscrew the nozzles using a 7 mm spanner, and replace them (Fig.12) with those needed for the new type of gas according to what is indicated in the Energy Consumption Table.
- 5) Burner "MINIMUM" adjustment:

Work surface burner adjustment: follow the instructions below to adjust the work surface burner minimum:

- Light the burner and set the knob to the MINIMUM position (small flame).
- Remove the knob of the valve that is press fit on the rod of that valve.
- For all burners except for the wok burner, insert a small slotted screwdriver into the hole on the valve rod (Fig. 13) and turn the choke screw to the right or left until the burner flame is adjusted to minimum.
- The wok burner has 2 adjustment screws on either side of the body of the valve (Fig. 14). Screw A is for the outer ring and screw B is for the inner ring. Turn the choke screw to the right or left until the burner flame is adjusted to minimum.
- Ensure sure that the flame does not go out when switching quickly from the MAXIMUM to the MINIMUM position. **Oven**

burner adjustment: follow the instructions below to adjust the minimum:

- Light the burner setting the knob to the MAXIMUM position.
- Close the oven door and operate the oven for at least 10 minutes.
- Set the knob to the MINIMUM position (corresponding to 120°) and then remove it.
- With a slotted screwdriver turn the choking screw (see figure 15) and, while observing the flame at the same time through the cooker porthole, evaluate the consistency of the flame so it remains on when switching quickly from the MINIMUM to the MAXIMUM position.

WARNING: The above-mentioned adjustment should be made only with natural gas burners, while for those operating with liquid gas the screw must be locked at the end in a clockwise direction.

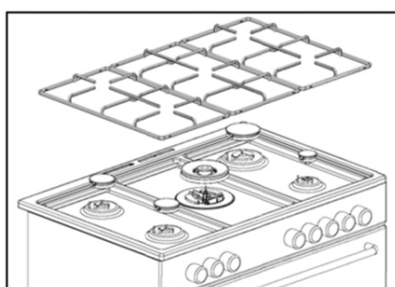

Fig. 11 (representation only)

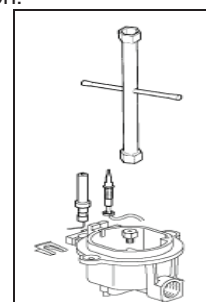

Fig.12

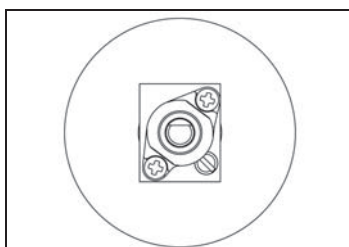

Fig. 13

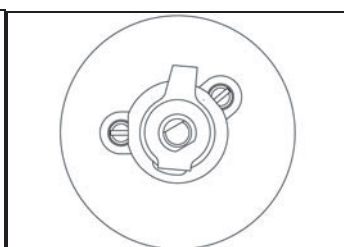

Fig.14

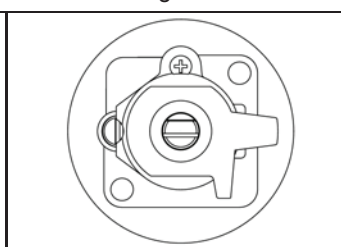

Fig.15

Plumbers, please ensure a copy of the installation instructions is left with the end user for future reference

FRANKE

DESIGNER UPRIGHT COOKER 90CM

INSTALLATION INSTRUCTIONS

APPLIANCE ELECTRICAL CONNECTION

The electric connection must comply with the current legal standards and regulations.

Before making the connection, check that:

- The system electrical rating and the current outlet are adequate for the maximum power output of the appliance (see the label applied to the bottom of the casing).
- The outlet or the system is equipped with an efficient ground connection in accordance with the current legal standards and regulations. The manufacturer will not be responsible for the noncompliance with these instructions.
- The power cord is supplied with a 15A plug, suitable for the load indicated on the label and a standard 15A GPO.

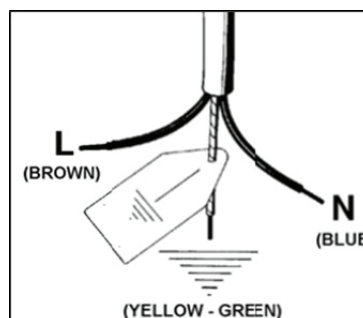
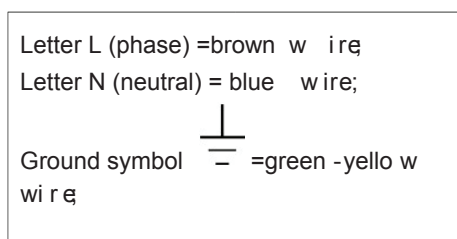

Fig. 16

- The power cord must be positioned so that a temperature of 75°C will not be reached at any point.
- Do not use reductions, adapters or splitters since they might cause false contacts and lead to dangerous overheating.

When the connection is made directly to the electric network:

- Use a device that ensures disconnection from the mains in which the contacts are opened to a distance that permits complete disconnection according to the conditions for over-voltage category III.
- The disconnection must be incorporated in the fixed wiring in accordance with the wiring rules.
- The ground wire must not be interrupted by the circuit-breaker.
- As an alternative, the electric connection can also be protected by a high-sensitivity residual current circuit-breaker but this may be subject to nuisance tripping due to residual humidity in heating elements.
- It is highly recommended to attach the special green-yellow ground wire to an efficient ground system.

WARNING: If the power cord is replaced, the ground wire (yellow-green) connected to the terminal, should be longer than the other wires by about 2 cm.

WARNING: if the supply cord is damaged, it must be replaced by the manufacturer or its service agent or similarly qualified person in order to avoid a hazard.

TABLE N°3: TYPES OF POWER CORDS

Work surface operation	Oven operation	Cross section
		230V ~
Only gas burner	Multifunction Electric oven	3x1,5mm ²
	Gas oven/Electric grill	3x1mm ²

The appliance conforms to the regulation AS4551 regarding gas appliance for domestic use and AS/NZS60335.26 regarding safety and CEM 14 regarding electromagnetic compatibility.

FRANKE

DESIGNER UPRIGHT COOKER 90CM

INSTALLATION INSTRUCTIONS

INSTALLATION CHECKLIST

1. Is the range mounted on its legs?
2. Is the backguard securely connected?
3. Has the anti-tip device been properly installed?
4. Does the clearance from the side cabinets comply with the manufacturers directions?
5. Is the electricity properly grounded?
6. Is the gas service line connected following the directions of the manufacturer?
7. Have all the proper valves, stoppers and gasket been installed between the range and the service line?
8. Has the gas connection been checked for leaks?
9. Has the range been set for the type of gas available in the household?
10. Is the ignition of all oven burners functioning properly?
11. Does the flame appear sharp blue, with no yellow tipping, sooting or flame lifting?
12. Has the minimum setting for all burners been adjusted?
13. Is the oven ignition working properly?
14. Does the oven light work properly?