

ZURN WILKINS BACKFLOW Backflow Cabinets

LWG-CABFS

SURFACE MOUNTED DOUBLE BACKFLOW CABINET

Dimensional Data (mm) are Subject to Manufacturing Tolerances and Change Without Notice

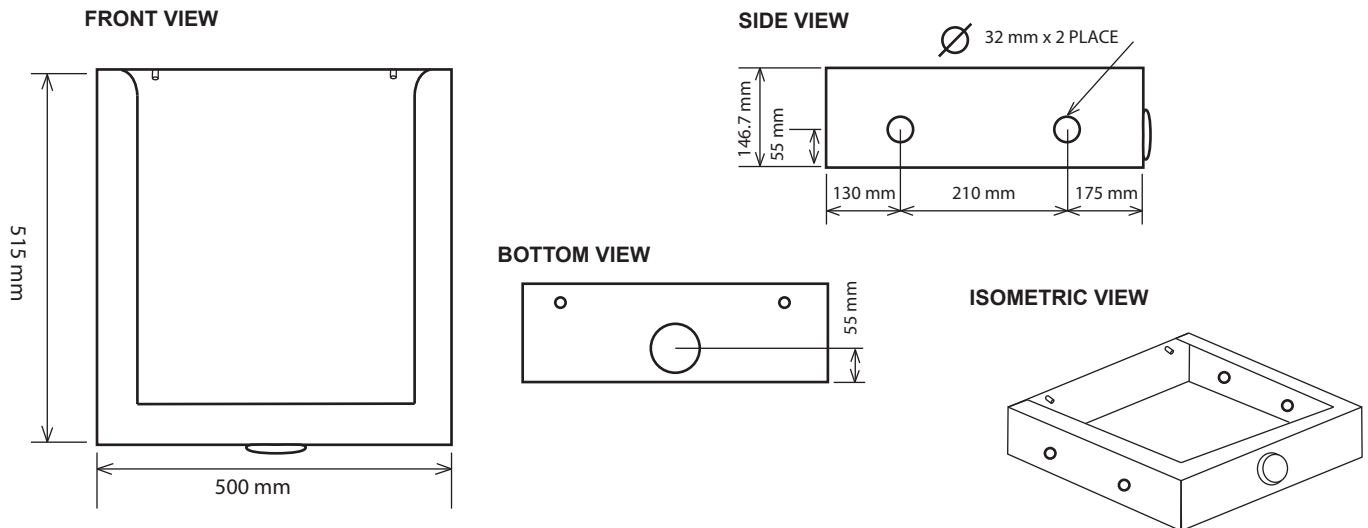

ENGINEERING SPECIFICATION - LWG-CABFS

- Suitable for 2x 20 or 25mm Wilkins Double Check Valves or 2x 15, 20 or 25mm Reduced Pressure Zone Devices (Refer to individual valve specification sheets for product details)
- Manufactured from #304 grade stainless steel
- 40mm waste connection standard
- Suits many applications
- Unique design benefits
- Stainless steel slide-in front panel

CABINET SOLD w/2x VALVES

LWG-CABFS w/ 2x Model 375 - RPZD

15-975CAB2S - Cabinet w/2x 15mm RPZD

20-375CAB2S - Cabinet w/2x 20mm RPZD

25-375CAB2S - Cabinet w/2x 25mm RPZD

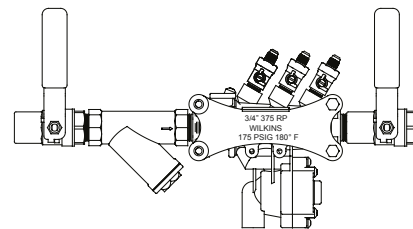

LWG-CABFS w/ 2x Model 350 - DCV

20-350CAB2S - Cabinet w/2x 20mm DCV

25-350CAB2S - Cabinet w/2x 25mm DCV

