

DURA EAGLE BALL VALVE - WATER

15mm – 50mm

SPECIFICATIONS

Recommended use	Suitable for line assembly in pipeline with the principle aim to open and close flow in distribution systems.
Features	Quarter Turn Operation Real Full Bore Hard Chromed Solid Ball PTFE Seats Both Ends
Working Pressure	2100 kPa
Temperature Range	-20oC to +100oC
Warranty	12 Months
Standards	Internal threaded ends to AS1722.1
Watermark	WMKA00683 ATS 5200.012-2005
Installation	In accordance to AS1628

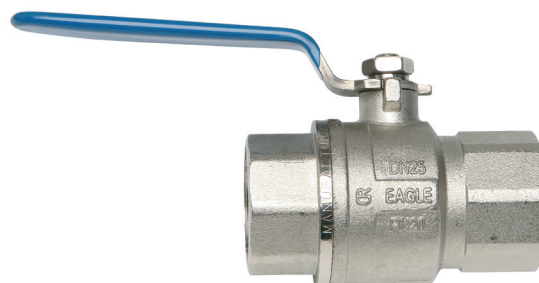

PHYSICAL SPECIFICATIONS

Handle	Stainless Steel
Body	DR Brass
Seal	NBR
Seat	PTFE
Ball	DR Brass
Stem	DR Brass

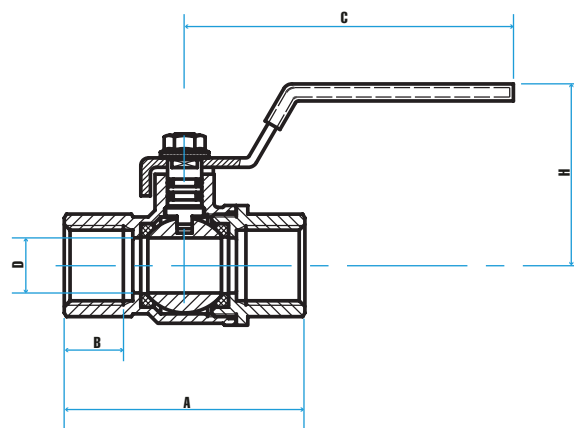

SPECIFICATIONS

Product Code	Product Description	Size	A	B	C	D	H
		DN	mm	mm	mm	mm	mm
1003880	DURA EAGLE BALL VALVE F&F WATER 15MM	15	60	15	85	14.5	47
1003881	DURA EAGLE BALL VALVE F&F WATER 20MM	20	68	15	110	19	48
1003882	DURA EAGLE BALL VALVE F&F WATER 25MM	25	83	20	110	24.5	55
1003883	DURA EAGLE BALL VALVE F&F WATER 32MM	32	98	23	125	32	70
1003884	DURA EAGLE BALL VALVE F&F WATER 40MM	40	108	23	150	40	77
1003885	DURA EAGLE BALL VALVE F&F WATER 50MM	50	127	27	150	49	88