

COOL-FIT 4.0 Flange adaptor ANSI

Model:

- PE100 SDR11, ANSI
- Suitable for flange connections to ANSI/ASME B16.5
- Gasket: Profile flange gasket NBR No. 45 44 05, EPDM No. 48 44 05
- Type 1 without chamfer, Type 2 with chamfer
- Separate Fittings type A needed for joining

Note:

Backing ring and gasket not included

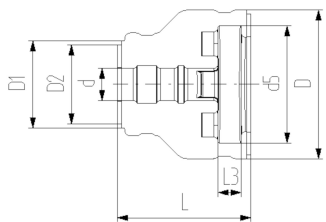
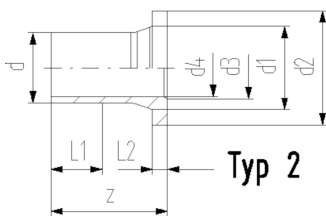
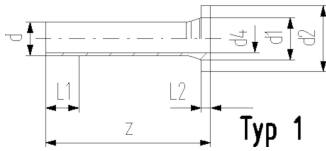

d (mm)	DN (mm)	PN	Code	Weight (kg)
32	25	16	738 710 108	0.051
40	32	16	738 710 109	0.075
50	40	16	738 710 110	0.110
63	50	16	738 710 011	0.173
75	65	16	738 710 012	1.210
90	80	16	738 710 113	0.439
110	100	16	738 710 014	1.574
140	125	16	738 710 016	2.412
160	150	16	738 710 017	1.748
225	200	16	738 710 020	10.440

d (mm)	DN (mm)	D (mm)	D1 (mm)	D2 (mm)	L (mm)	L1 (mm)	L2 (mm)	L3 (mm)	z (mm)	d1 (mm)	d2 (mm)	d3 (mm)	d4 (mm)	d5 (mm)	Type
32	25	135	90	63	162	36	10	26	190	40	63		26	121	1
40	32	170	110	73	165	40	11	28	197	50	73		32	146	1
50	40	180	110	82	178	44	12	30	214	61	82		40	156	1
63	50	200	125	102	230	48	14	32	270	75	102		51	171	1
75	65	220	140	122	232	55	16	34	279	89	122		61	191	2
90	80	240	160	133	245	62	17	35	299	105	133	78	73	206	2
110	100	270	180	158	254	72	18	36	320	125	158	100	90	235	2
140	125	300	225	200	299	84	25	38	383	155	188	127	127	256	2
160	150	358	259	213	332	90	25	34	412	174	213	151	131	295	2
225	200	423	325	268	383	110	32	37	483	233	268	209	184	354	2

The technical data are not binding. They neither constitute expressly warranted characteristics nor guaranteed properties nor a guaranteed durability. They are subject to modification. Our General Terms of Sale apply.

Georg Fischer Piping Systems Ltd, Postfach, CH-8201 Schaffhausen/Switzerland

Phone +41 -(0)52-631 1111

e-mail: info.ps@georgfischer.com

Internet: <http://www.gfps.com>