

Posh Bristol MK2 Vanity with Kickboard 900mm

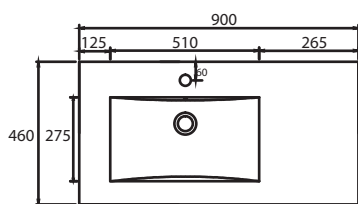

Vanity 900mm (Left Hand Bowl) - Top View

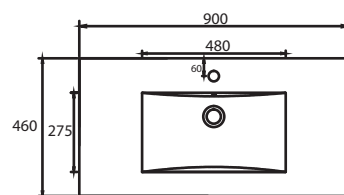

Vanity 900mm (Centre Bowl) - Top View

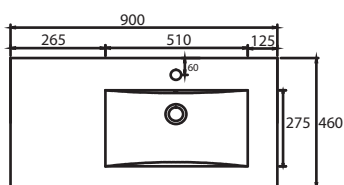

Vanity 900mm (Right Hand Bowl) - Top View

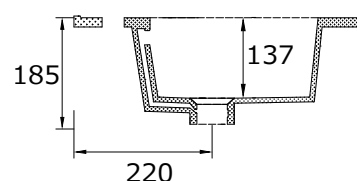

Vanity 900mm - Side View

SPECIFICATIONS

Recommended use	Domestic, hotel, and commercial
Basin material	Vitreous china
Cabinet material	MDF (2 Pac polyurethane)
Colour availability	White
Taphole option	1 or 3 Taphole
Capacity	6 Litres
Integrated overflow	Yes
Plug and waste	32x40mm with overflow (not supplied)
Fixing	Top siliconed to cabinet, cabinet screwed back to wall



To see the complete Posh range go to www.reece.com.au/bathrooms

CLEANING RECOMMENDATIONS

We recommend the use of soapy water or approved cleaners.

This product should not be cleaned with abrasive materials.

Damage caused by any improper treatment is not covered by the product warranty- refer to Warranty Conditions.

Posh Bristol MK2 Vanity with Kickboard 900mm

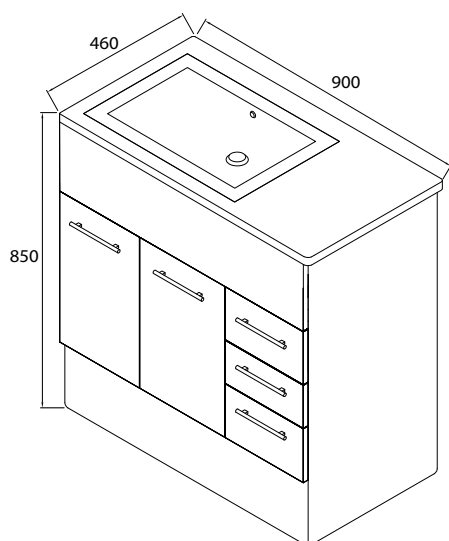

Freestanding Vanity 900mm (Left Hand Bowl)

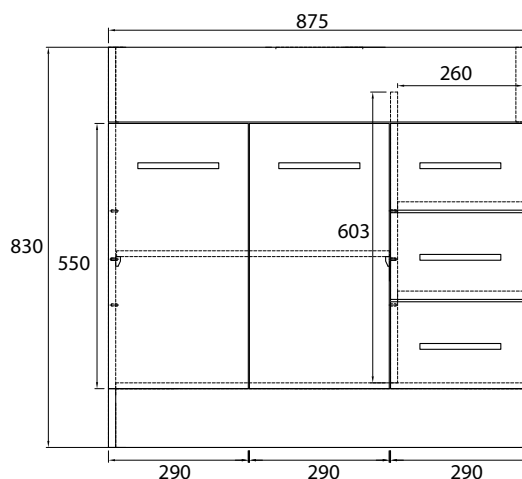

Cabinet Only - Front View

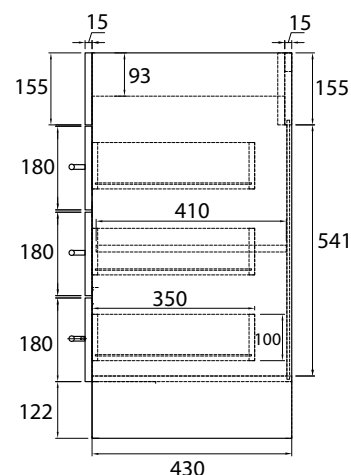

Cabinet Only - Side View

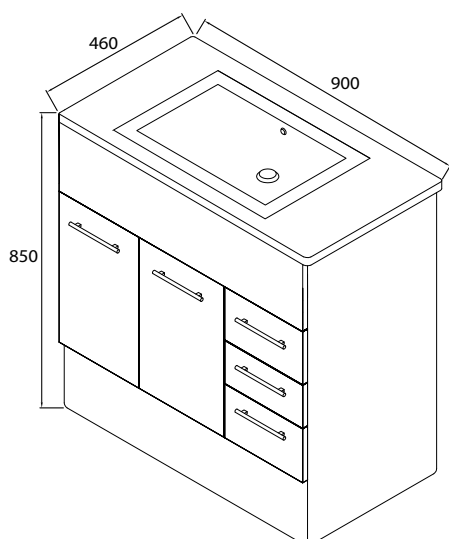

Freestanding Vanity 900mm (Centre Bowl)

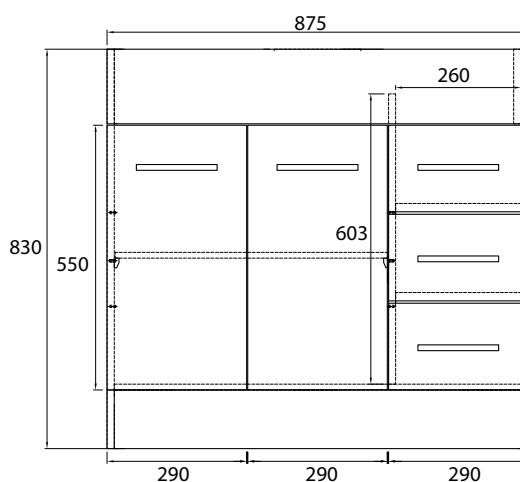

Cabinet Only - Front View

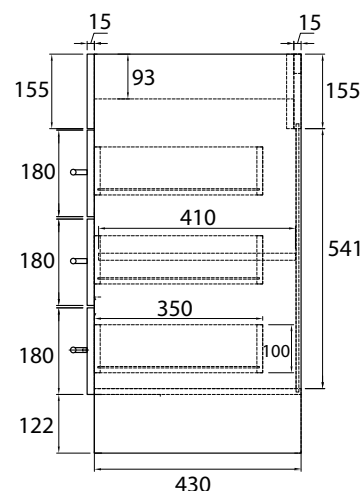

Cabinet Only - Side View

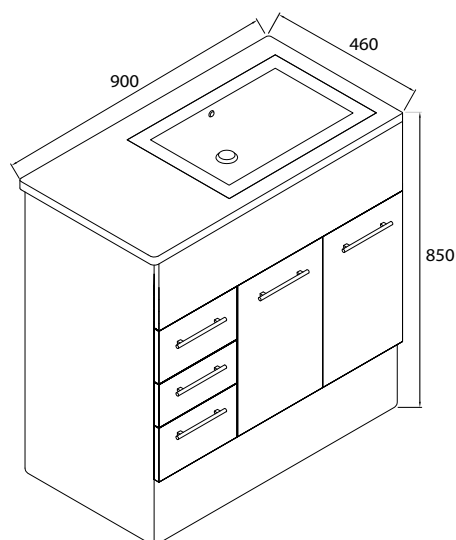

Freestanding Vanity 900mm (Right Hand Bowl)

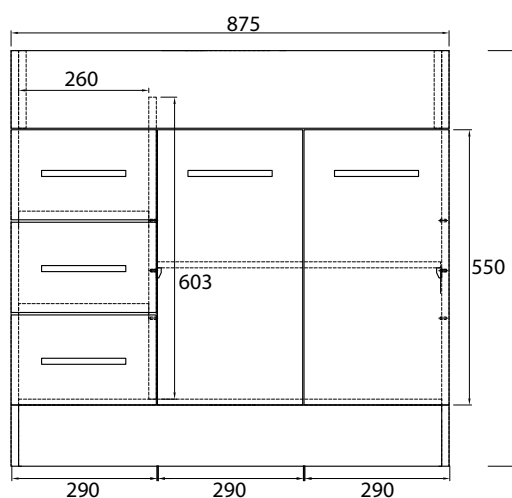

Cabinet Only - Front View

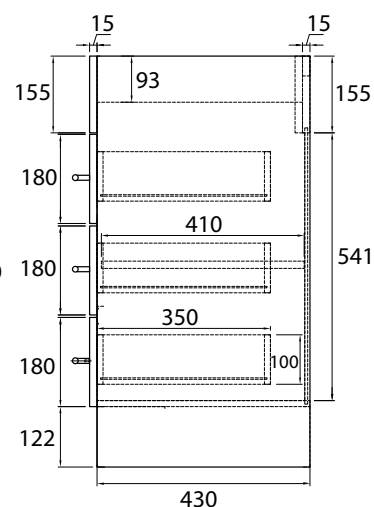

Cabinet Only - Side View

Dimensions are nominal measurements only.

Disclaimer: Products in this specification manual must be installed by licensed and registered trade people. The manufacturer/distributor reserves the right to vary specifications or delete models from their range without prior notification. Dimensions are nominal measurements only. Dimensions and set-outs listed are correct at time of publication however the manufacturer distributor takes no responsibility for printing errors.

Posh Bristol MK2 Vanity with Kickboard 900mm

NOTE

Vanity unit must be installed by a qualified tradesman.

IMPORTANT

If fixing to timber framed walls or partitioning, care should be taken to properly reinforce wall.

Please check vanity unit for damage before installing. If there is damage, please notify Reece branch where the product was purchased to organise a replacement product. Installation of the vanity unit is deemed as accepting the condition of the vanity unit.

Freestanding Vanity Installation Procedure

1. Ensure that wall is plumb and floor is level.
2. Set up water inlet point and waste.
3. Place vanity unit into position and secure to wall. Make minor adjustments to hanging clips and then fully tighten coach screws.
4. External edges where the unit meets the wall should be sealed using flexible sealant.

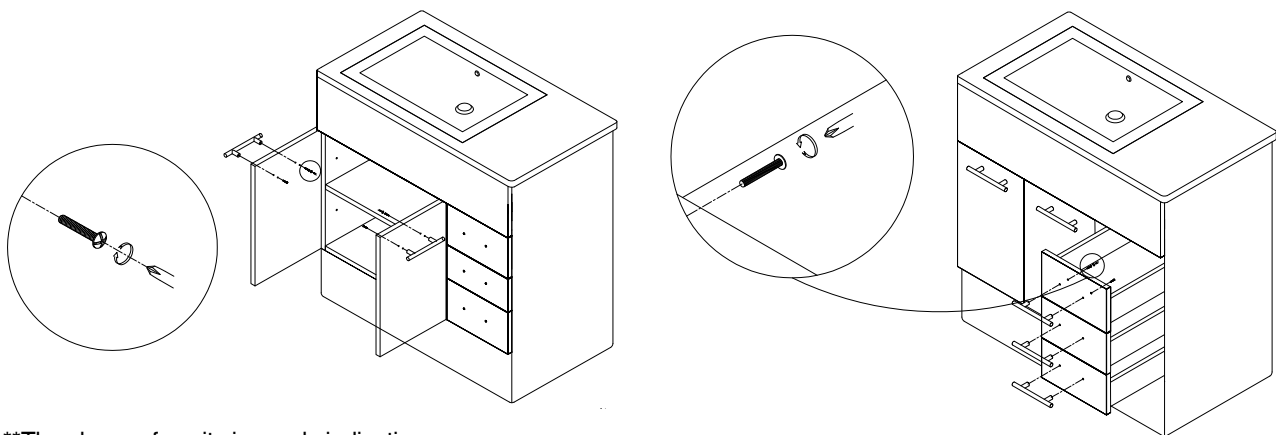

**The shape of vanity is purely indicative.

Posh Bristol MK2 Vanity with Kickboard 900mm

SPARE PARTS

Picture	Reece Code	Product Description
<p>LEFT & RIGHT HAND DOOR</p>	9506173	BRISTOL MK2 VANITY DOORS - SUIT 900MM VANITY UNIT WITH KICK
	9506175	BRISTOL MK2 VANITY DOORS - SUIT 900MM WALL HUNG VANITY UNIT
	9506177	BRISTOL MK2 VANITY DOORS - SUIT 900MM SEMI RECESSED VANITY UNIT WITH KICK
	9506178	BRISTOL MK2 VANITY DOORS - SUIT 900MM SEMI RECESSED WALL HUNG VANITY
<p>LEFT HAND DOOR ONLY</p>	9506174	BRISTOL MK2 VANITY DOOR - SUIT 750MM VANITY UNIT WITH KICK
	9506176	BRISTOL MK2 VANITY DOOR - SUIT 750MM WALL HUNG VANITY UNIT
	9506179	BRISTOL MK2 VANITY DOOR - SUIT 750MM SEMI RECESSED VANITY WITH KICK
	9506180	BRISTOL MK2 VANITY DOOR - SUIT 750MM SEMI RECESSED WALL HUNG VANITY
	9506181	BRISTOL MK2 VANITY DRAWER FRONT ONLY
	9506182	BRISTOL MK2 VANITY DRAWER / DOOR HANDLE & BOLTS
<p>2 x HINGES</p>	9506183	BRISTOL MK2 VANITY - CURVED DOOR HINGE (INNER)
<p>2 x HINGES</p>	9506184	BRISTOL MK2 VANITY - STRAIGHT DOOR HINGE (OUTER)
	9506185	BRISTOL MK2 VANITY METAL DRAWER RUNNERS
	9506186	BRISTOL MK2 SEMI RECESSED VANITY METAL DRAWER RUNNERS