

DURA EAGLE GAS COCK

SPECIFICATIONS

Recommended use	Suitable for natural gas, simulated gas, town gas, tempered liquified petroleum gas, and liquified petroleum gas applications.
Features	Quarter turn operation Flare end Reducing bore 100% tested Chrome plated DR brass ball
Working Pressure	PN5 / 500kPa
Temperature Range	-20°C to +70°C
Warranty	12 months
Approvals	AGA 6920



PHYSICAL SPECIFICATIONS

Handle	Aluminium alloy
Body	Brass
Seal	PTFE
O-Ring	NBR
Ball	Brass
Stem	Brass

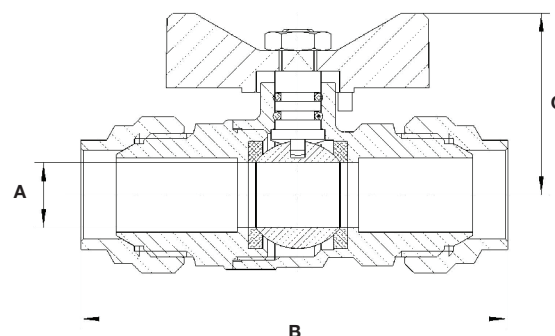

PHYSICAL SPECIFICATIONS

Product Code	Product Description	Size	A	B	C
		DN	mm	mm	mm
107580	DURA EAGLE GAS COCK (CXC) 15MM	15	10	80	37
107581	DURA EAGLE GAS COCK (CXC) 20MM	20	14	91	40

DURA EAGLE GAS COCK



REECE PRODUCT QUALITY GUARANTEE

You have purchased a quality product from Reece Pty Ltd ABN 84 004 097 090 ("Reece"). This product is covered by a 12 month product warranty.

12 MONTH WARRANTY

This warranty covers faults in the product construction, material and assembly. Products which are within 12 months from the date of purchase, found upon inspection by an authorised Reece representative, to be defective in construction, material or assembly, will be repaired or exchanged with an equivalent product free of charge. Replaced items become Reece's property.

All replacement products will be available for collection without charge to the customer at the nearest Reece branch to the customer's location, or elsewhere as agreed between the customer and Reece.

Warranty Conditions

This warranty will apply only under all of the following conditions:

- The item has been installed by a licensed plumber
- Failure is due to a fault in the manufacture of the product
- Proof of purchase (including the date of purchase) is provided
- The installation of the product is in accordance with the instructions provided

This warranty does not cover products purchased as an ex-display without being fully checked and tested for sale by the manufacturer.

This warranty does not include faults caused by:

- Unsuitable or improper use
- Incorrect installation or installation not in accordance with the instructions provided
- Installation or part installation by the purchaser or any person other than a LICENSED PLUMBER or tradesperson licensed to install this product.
- Normal wear and tear
- Inadequate or complete lack of maintenance
- Chemical, electrochemical or electrical influences
- Harsh detergents or abrasive cleaners used on product finishes

EXCLUSIONS

To the fullest extent permitted by law, Reece excludes all liability for damage or injury to any person, damage to any property, and any indirect consequential or other loss or damage.

CLAIM PROCEDURE

For all warranty queries customers are to contact the branch where the product was purchased. These details can be found on your purchase invoice.

Our goods come with guarantees that cannot be excluded under the Australian Consumer Law. You are entitled to a replacement or refund for a major failure and for compensation for any other reasonably foreseeable loss or damage. You are also entitled to have the goods repaired or replaced if the goods fail to be of acceptable quality and the failure does not amount to a major failure.

Plumbers/Contractors, please ensure a copy of the installation instructions is left with the end user for future reference.

Don't risk it, use a licensed plumber.™

