

Chrome Hand Held Shower and Smooth Hose with Centre Inverted T Stainless Steel Grab Rail

Water efficient handheld shower set with chrome shower head and holder, smooth hose and stainless steel grab rail.

Suitable for commercial amenities, hospitals, hotels, sporting facilities and public areas.

SGR027CT

FEATURES

- Chrome plated shower head
- Single spray pattern
- Single-hand adjustable shower head holder
- 1.5m smooth hose in chrome finish
- Chrome plated wall elbow complete with spring loaded dual check valve
- Polished stainless steel heavy duty grab rail 1100mm x 700mm
- Concealed wall flange fixings
- Manufactured to withstand a load rating of 1100N force applied in any direction

Product Codes

SGR027CT Centre T grab rail, wall elbow, chrome hand held shower, smooth chrome hose, and chrome plated adjustable shower head holder

OPTIONS

- White finish **SGR027T**
- Centre T grab rail only **SGR017T**
- Without grab rail **SP274CSL**
- Handheld shower, hose & wall elbow only **SP274C**

Technical Information

Inlet Connection	1/2" BSP (15mm)
Working Pressure Range	150 - 500 kPa
Flow Rate	8.5 l/m
Maximum Water Temperature	70 °C

Enware products are to be installed in accordance with the Plumbing Code of Australia and AS/NZS3500. Reference should also be made to the Australasian Health facility Guidelines (AHFG), ABCB and Local Government regulations when considering the choice of, and the installation of these products.

Enware Australia advises: 1. Due to ongoing Research and Development, specifications may change without notice. 2. Component specifications may change on some export models. 3. Refer to Warranty Statement for warranty details - www.enware.com.au/warranty

Fixing screws are not supplied with product. Ensure grab rail is installed on a solid wall surface with firm wall backing using appropriate fixing method. Structural engineers or licensed tradespersons should be consulted for appropriate advice on suitability of the fasteners and wall structure before affixing or installing any Enware products. Enware does not provide any warranty in relation to bolts, screws or other fasteners used with Enware products.

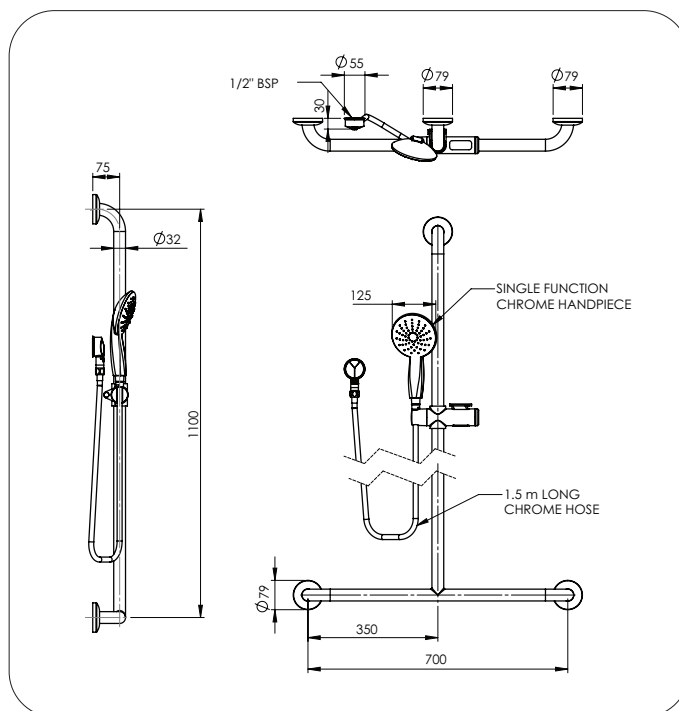
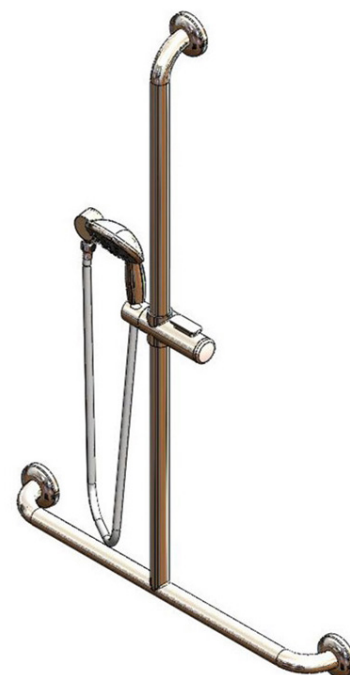

Version: Oct 20

Call 1300 369 273
www.enware.com.au

Enware Australia Pty Limited
9 Endeavour Rd Caringbah NSW 2229 Australia
Ph: 02 8536 4000 info@enware.com.au

