

ISSY

Blossom Mirror

Specification Sheet



SPECIFICATIONS

Recommended Use	Domestic, Hotel & Commercial
Mirror Trim Material	19mm American Oak veneer
Mirror Frame Material	2 Pack Polyurethane on High Moisture Resistant MDF
Mirror Material	4mm Australian made safety mirror
Colour Variations	Please refer to the Colour, Finish and Material Variations Document on the Website for more information.
Fixing	Bolted / Screwed to Wall by a Licensed Trades Person (not included)
Mounting	19mm Split Bracket System (Supplied)



To see the complete Issy range go to www.reece.com.au/bathrooms

STANDARD SIZES	BL-MIRR800	BL-MIRR900	BL-MIRR1000
Width (mm)	325	380	500
Overall depth (mm)	38	38	38
Height (mm)	800	900	1000

CUSTOM SIZES	BL-MIRR300-400	BL-MIRR801-1000	BL-MIRR1001-1200
Width (mm)	300-400	350-400	401-600
Overall depth (mm)	38	38	38
Height (mm)	600-800	801-1000	1001-1200

Disclaimer: Products in this specification manual must by regulation be installed by licensed and registered trade people. The manufacturer/distributor reserves the right to vary specifications or delete models from their range without prior notification. Dimensions are nominal measurements only. Dimensions and set-outs listed are correct at time of publication however the manufacturer/distributor takes no responsibility for printing errors.

Published 24/03/2022



Blossom Mirror

STANDARD SIZES

325W x 38D x 800H

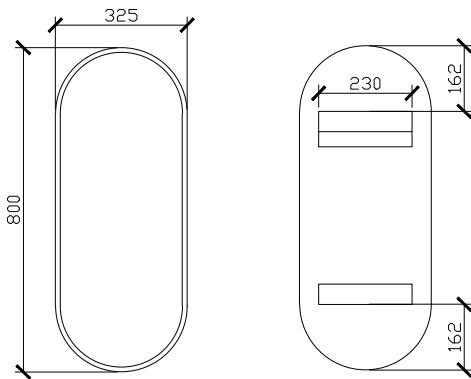

SIDE VIEW for all sizes

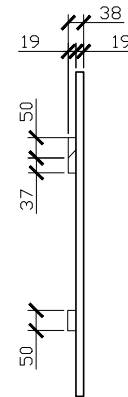

380W x 38D x 900H

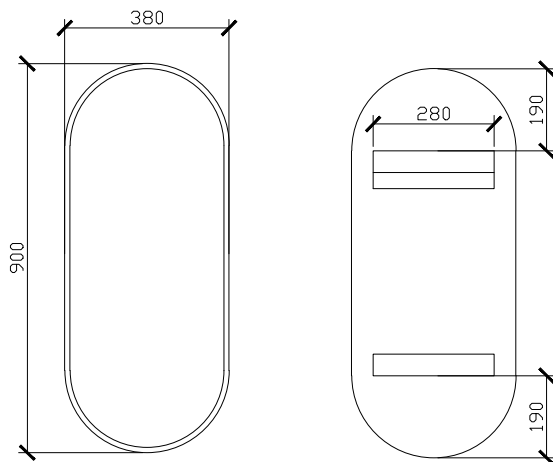

500W x 38D x 1000H

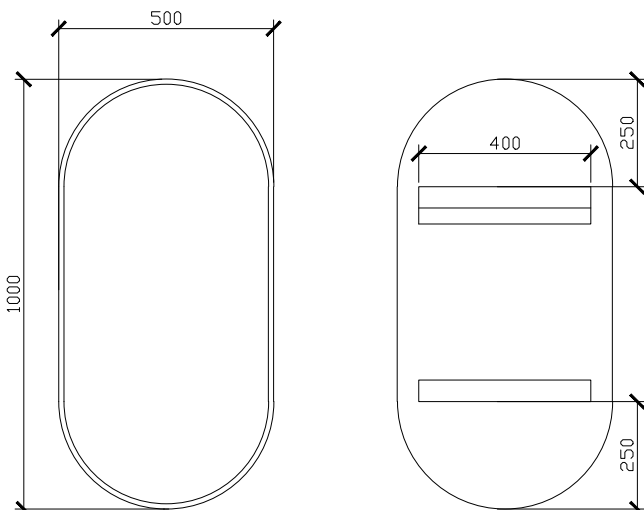

Blossom Mirror

300-400W x 38D x 600-800H

CUSTOM SIZES

SIDE VIEW for all sizes

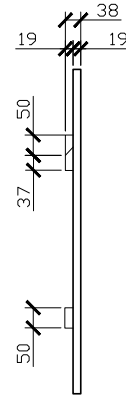
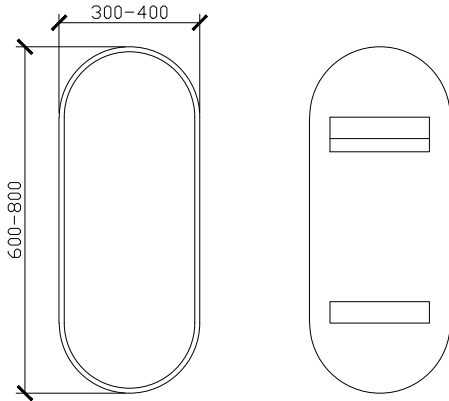

350-400W x 38D x 801-1000H

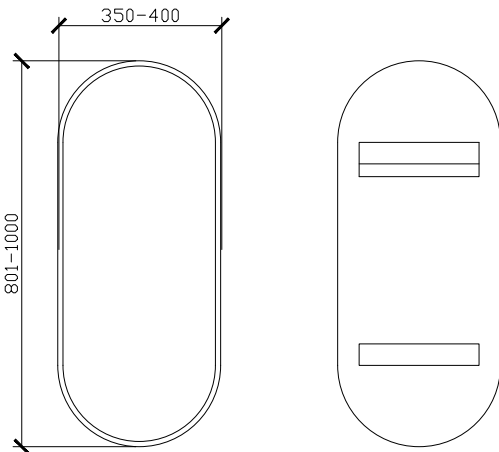

401-600W x 38D x 1001-1200H

