



WOLFEN

INSTALLATION MANUAL

9505568 Wolfen Sensor Operated Gooseneck Tap

9506217 Wolfen Sensor Operated Gooseneck Tap with LED





WOLFEN™

CONTENTS

Intro	03
Technical Information	04
Unit Components	06
Installation Instructions	08
Warranty	10

Delivering unrivalled quality

Designed for absolute performance, Wolfen's commercial Sensor Operated Gooseneck Tap sets new standards in quality and durability. Ergonomic design combined with precision engineering ensures that every Wolfen product is easy-to-use and made to last. Here are just some of the many innovative features that make the Wolfen Sensor Operated Gooseneck Tap the smart solution.

Infection control

- Touch-free operation

Commercial durability

- Waterproof electronics
- Protective shield to prevent cable damage

Installation and servicing

- Fixed 1/2" BSP thread provides a fast and stable installation point
- Integrated dress ring creates a larger mounting platform
- Easy side access sensor range adjustment
- Light indicator on power pack self diagnoses effective power supply to unit

Usage features

- Reflection proof sensor prevents false triggering
- Distinctive LED light feature indicates operation (9506217)

Anti-vandal features

- Aerator cannot be easily unscrewed

Application

- Hospital and health care
- Commercial food premises

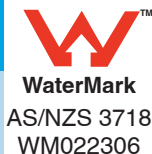
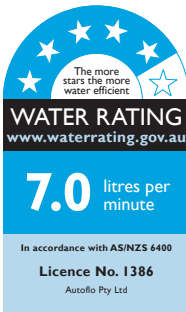

Suitable for High Pressure applications
(minimum 150kPa)

TECHNICAL INFORMATION

Model	Wolfen Sensor Operated Gooseneck Tap	Wolfen Sensor Operated Gooseneck Tap with LED
Product Code	9505568	9506217
Product Type	Kitchen Sensor Tapware	Kitchen Sensor Tapware
Colour	Chrome	Chrome
Finish	Polished	Polished
Material	Brass	Brass
Power Supply	240V AC	240V AC
Max Continuous Flow Working Pressure	500kPa	500kPa
Min Continuous Working Temperature	2°C	2°C
Max Continuous Working Temperature	50°C	50°C
Max Static Pressure	500kPa	500kPa
Height	200mm	200mm
Reach	115mm	115mm

Wolfen Sensor Operated Gooseneck Tap
9505568



Wolfen Sensor Operated Gooseneck Tap with LED
950617



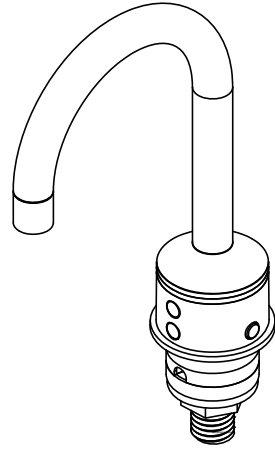
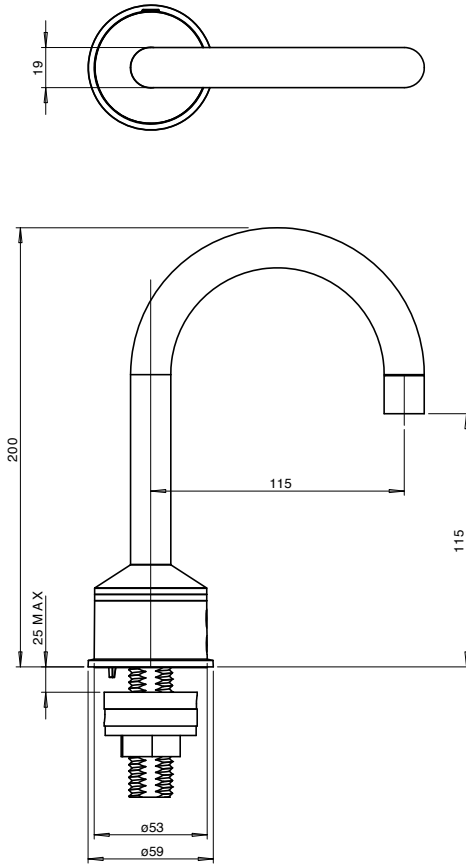

UNIT COMPONENTS

Wolfen Sensor Operated Gooseneck Tap

Item No.	Part Number	Description	Qty
1	300-0113	Sensor Eyebody	1
1	300-0015	LED Light Sensor Eyebody	1
2	600-0180	Gooseneck Spout 1/2 Inch BSP Tail	1
3	600-0112	Sensor Range Adjustment Cap	1
4	300-0105	Cable Spacer Black	2
5	600-0102	Plastic Nut 1/2" BSP	1
6	600-0183	Plastic Solenoid 24V AC	1
7	600-0124A	Powerpack 24V AC	1
8	600-0107	Adhesive Pad	1
9	600-0116	Square Rubber Ring	1

Wolfen Sensor Operated Gooseneck Tap

950568



Wolfen Sensor Operated Gooseneck Tap with LED

950617



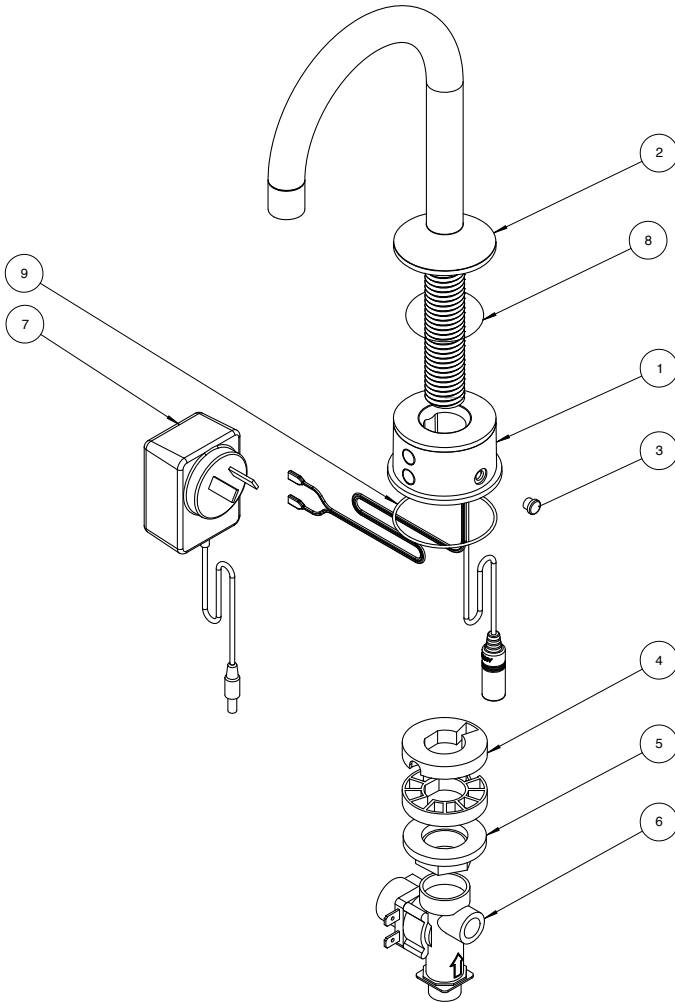

INSTALLATION INSTRUCTIONS

Important Note

The product must be installed to the requirements of AS/NZS 3500 by a qualified plumber. The product comes to you already factory assembled and tested. We do not recommend the dismantling of any internal part of the product. The product is factory tested and sealed so as to give the best performance.

Wolfen Sensor Operated Gooseneck Installation Instructions:

1. Please flush out new pipe work prior to connecting the unit.
2. The product should be installed with isolating stop cocks (Arco brand recommended).
3. This tap is suitable for high pressure applications where cold water supply pressures are at 150kPa or above.
4. It is recommended that the tap be installed with an approved tempering valve before the solenoid.
5. For installations where water pressure exceeds 880kPa, an approved pressure reducing valve must be fitted.
6. Drill a 32mm diameter hole on the sink/basin. Clean sharp edges on any stainless steel surface.
7. Feed the cable through the two spacers as shown on the diagram. One spacer faces down and the second faces upwards. Together they protect and lead the cable out safely, under the fixing nut.

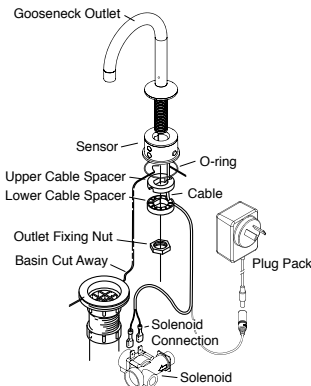
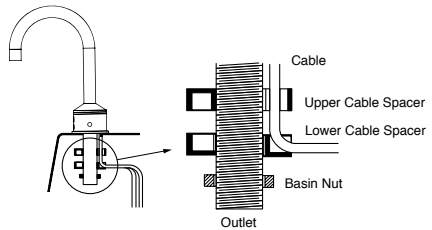

8. Ensure that the solenoid is installed the correct way, with the arrow on the solenoid indicating the water flow direction.
9. Hot water should be adjusted to no more than 42°C.
10. Only after all plumbing and electrical connections are completed should the unit be powered-up.
11. Observe three bursts of water through the spout, indicating the unit is ready for use before assuming normal operation.

Plumbing Installation Instructions:

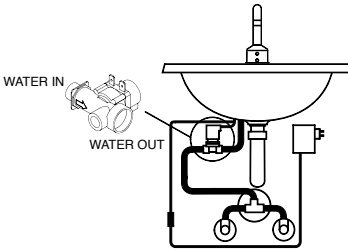

Infrared Detection Range:

The infrared detector has been factory set to suit the supplied outlet and should not need adjustment. If it is necessary to adjust, proceed as follows.

1. Remove the cap from the side of the eye-body.
2. Using a small screwdriver, turn screw in a clockwise direction to increase range, and anti-clockwise to decrease the range.
3. Replace cap.

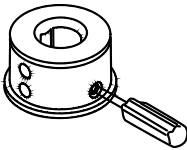

Correct sensor installation when mounted level on basin/sink.

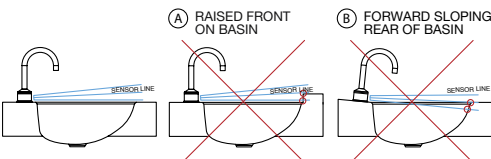

LIGHT RING INDICATOR (for LED model only, Reece code 9506217):

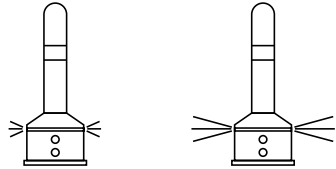

SOFT GLOW = STANDBY

BRIGHT GLOW = OBJECT DETECTED

IMPORTANT INFORMATION:

- The warranty is void if cables on unit or power pack are cut.
- The power pack must be mounted in an area away from likely water contact or physical damage to case. Solenoid connectors must not be allowed to short, as this will cause damage to the eye-body. The supply cord cannot be replaced, if the cord is damaged, the equipment should be discarded.
- Ensure all connections are securely made before turning on power.

If unit fails to work:

If water fails to flow	Turn power OFF and back ON after a few seconds. Check power point for failure.
If water flows continuously after installation	Check that no foreign matter has become lodged in the solenoid. Ensure that the flow direction of the solenoid has been installed the right way round. (Check IN/OUT on solenoid body). Check the installation of eye-body. Unit may be picking up off other side of the basin. If problem still persists, the solenoid may be faulty. In this case, a replacement is required.
Infrared range is not great enough	See installation instruction for detection range.

REECE PRODUCT QUALITY GUARANTEE



You have purchased a quality product from Reece Australia Pty Ltd ABN 84 004 097 090 ("Reece"). This product is covered by a 5 year replacement product warranty and a 12 month warranty over spare parts and labour.

5 YEAR WARRANTY

This warranty covers faults in the product construction, material and assembly. Products which are within 5 years from the date of purchase, found upon inspection by an authorised Reece representative, to be defective in construction, material or assembly, will be repaired or exchanged with an equivalent product free of charge. Replaced items become Reece's property.

All replacement products will be available for collection without charge to the customer at the nearest Reece branch to the customer's location, or elsewhere as agreed between the customer and Reece.

Labour and Spare Parts

The labour for the replacement of products and spare parts to which this warranty applies will be supplied by Reece or relevant supplier using licensed plumbers engaged by Reece or relevant supplier within 1 year from the date of purchase. Spare parts other than those listed in the Manufacturer's Provisions above, which are within 1 year from the date of purchase found upon inspection by an authorised Reece representative to be defective in construction, material or assembly, will be replaced free of charge.

Warranty Conditions

This warranty will apply only under all of the following conditions:

- The item has been installed by a licensed plumber
- Failure is due to a fault in the manufacture of the product
- Proof of purchase (including the date of purchase) is provided
- The installation of the product is in accordance with the instructions provided

This warranty does not cover products purchased as an ex-display without being fully checked and tested for sale by the manufacturer.

This warranty does not include faults caused by:

- Unsuitable or improper use
- Incorrect installation or installation not in accordance with the instructions provided
- Installation or part installation by the purchaser or any person other than a LICENSED PLUMBER
- Normal wear and tear
- Inadequate or complete lack of maintenance
- Chemical, electrochemical or electrical influences
- Harsh detergents or abrasive cleaners used on product finishes

EXCLUSIONS

To the fullest extent permitted by law, Reece excludes all liability for damage or injury to any person, damage to any property, and any indirect consequential or other loss or damage.

CLAIM PROCEDURE

For all warranty queries customers are to contact the branch where the product was purchased. These details can be found on your purchase invoice.

Our goods come with guarantees that cannot be excluded under the Australian Consumer Law. You are entitled to a replacement or refund for a major failure and for compensation for any other reasonably foreseeable loss or damage. You are also entitled to have the goods repaired or replaced if the goods fail to be of acceptable quality and the failure does not amount to a major failure.

Don't risk it, use a licensed plumber.™

IF AFTER CHECKING THE
INSTALLATION INSTRUCTIONS
AND IMPORTANT
INFORMATION, THE PROBLEM
HAS NOT BEEN IDENTIFIED,
PLEASE CONTACT AUTOFLO
CUSTOMER SUPPORT ON:

+61 3 9380 8244 (Australia)

+61 9 282 1502 (New Zealand) or

customerservice@autoflo.com.au



WOLFEN™

reece.com.au/wolfen