

COOL-FIT 4.0 Reducer

Model:

- Pre-insulated PE100 SDR11, metric
- Insulation made from GF HE foam
- Outer jacket impact resistant. Colour: black
- Electrofusion Fitting with integrated sealing lip, for a water and vapour tight sealing
- *d32/90 - d110/180 available from Q4 2018

* 160/250-140/200 + 225/315-140/200 available as from 08.2019

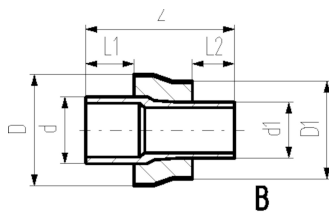
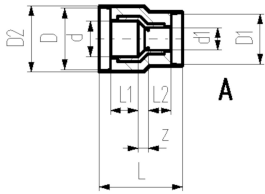

d/D (mm)	d1/D1 (mm)	PN (bar)	Code	Weight (kg)
40/110	32/90	16	738 903 206	0.250
50/110	32/90	16	738 903 209	0.280
50/110	40/110	16	738 903 210	0.320
63/125	32/90	16	738 903 212	0.217
63/125	40/110	16	738 903 213	0.232
63/125	50/110	16	738 903 214	0.243
75/140	63/125	16	738 903 318	0.264
90/160	63/125	16	738 903 322	0.387
90/160	75/140	16	738 903 323	0.416
110/180	63/125	16	738 903 327	0.566
110/180	75/140	16	738 903 328	0.577
110/180	90/160	16	738 903 329	0.644
160/250	63/125	16	738 903 347	1.298
160/250	90/160	16	738 903 349	1.323
160/250	110/180	16	738 903 350	1.362
*	160/250	140/200	738 904 351	1.664
225/315	63/125	16	738 903 364	2.960
225/315	90/160	16	738 903 366	3.018
225/315	110/180	16	738 903 367	3.079
*	225/315	140/200	738 904 368	3.172
225/315	160/250	16	738 903 369	3.550

d/D (mm)	d1/D1 (mm)	D2 (mm)	L (mm)	L1 (mm)	L2 (mm)	z (mm)	Closest inch (inch)	Type
40/110	32/90	117	143	40	36	17	1 1/4 - 1	A
50/110	32/90	117	151	44	36	21	1 1/2 - 1	A
50/110	40/110	117	149	44	40	15	1 1/2 - 1 1/4	A
63/125	32/90	132	160	48	36	26	2 - 1	A
63/125	40/110	132	159	48	40	21	2 - 1 1/4	A
63/125	50/110	132	159	48	44	17	2 - 1 1/2	A
75/140	63/125			55	48	170	2 1/2 - 2	B
90/160	63/125			62	48	190	3 - 2	B
90/160	75/140			62	55	189	3 - 2 1/2	B
110/180	63/125			72	48	204	4 - 2	B
110/180	75/140			72	55	205	4 - 2 1/2	B
110/180	90/160			72	62	205	4 - 3	B
160/250	63/125			90	48	244	6 - 2	B
160/250	90/160			90	62	244	6 - 3	B
160/250	110/180			90	72	242	6 - 4	B
*	160/250	140/200		90	84	257	6 - 5	B
225/315	63/125			110	48	295	8 - 2	B
225/315	90/160			110	62	295	8 - 3	B
225/315	110/180			110	72	295	8 - 4	B
*	225/315	140/200		110	84	296	8 - 5	B
225/315	160/250			110	90	279	8 - 6	B

Data sheet

valid from: 8/13/19



The technical data are not binding. They neither constitute expressly warranted characteristics nor guaranteed properties nor a guaranteed durability. They are subject to modification. Our General Terms of Sale apply.

Georg Fischer Piping Systems Ltd, Postfach, CH-8201 Schaffhausen/Switzerland

Phone +41 -(0)52-631 1111

e-mail: info.ps@georgfischer.com

Internet: <http://www.gfps.com>