



# Water Control Systems

## 600HLR Series PRV

## 15-50mm

### Application

Zurn Wilkins model 600HLR is designed for installation on potable water lines to reduce high inlet pressure to a lower outlet pressure. The integral strainer makes this device most suitable for residential and commercial water systems requiring frequent cleaning because of sediment and debris. The direct acting integral by-pass design prevents buildup of excessive system pressure caused by thermal expansion. The balanced piston design enables the regulator to react in a smooth and responsive manner to changes in system flow demand, while at the same time, providing protection from inlet pressure changes.

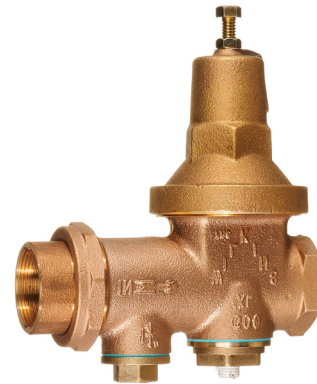

### Standards Compliance

Australian Watermark Approved



### Materials

Main valve body	Low Lead Cast Bronze ASTM B 584
Access Covers	Low Lead Cast Bronze ASTM B 584 Low Lead Brass (20mm only)
Fasteners	Stainless Steel, 300 Series
Stem & Plunger	Low Lead Cast Bronze ASTM B 584 Low Lead Brass (20mm only)
Elastomers	Buna Nitrile, EPDM
Cap Gaskets	Natural Vulcanized Fibre Acetal (Delrin™)
Strainer Screen	Stainless Steel, 300 Series
Strainer Seat	Stainless Steel, 300 Series

### Operating Parameters

Max. Working Water Pressure	2000kPa
Max. Working Water Temp	60°C
Reduced Pressure Range	170-875kPa
Factory Preset	500kPa
Maximum Reduction	3 to 1

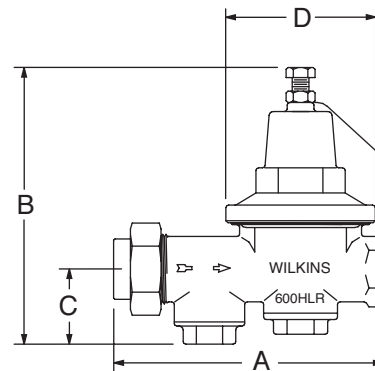

### Dimensions & Weights (do not include pkg.)

SIZE	ZURN CODE	REECE CODE	DIMENSIONS (approximate)				WEIGHT
			A	B	C	D	
mm			mm	mm	mm	mm	kg
15	12-600HLRLUTBS	108586	133	159	32	70	1.5
20	34-600HLRLUTBS	108587	135	140	32	70	1.5
25	1-600HLRLUTBS	108588	156	184	51	86	2.5
32	114-600HLRTBS	108589	181	203	51	100	3.0
40	112-600HLRTBS	108590	232	254	64	127	6.0
50	2-600HLRTBS	108591	260	305	76	165	9.5

## Flow Characteristics

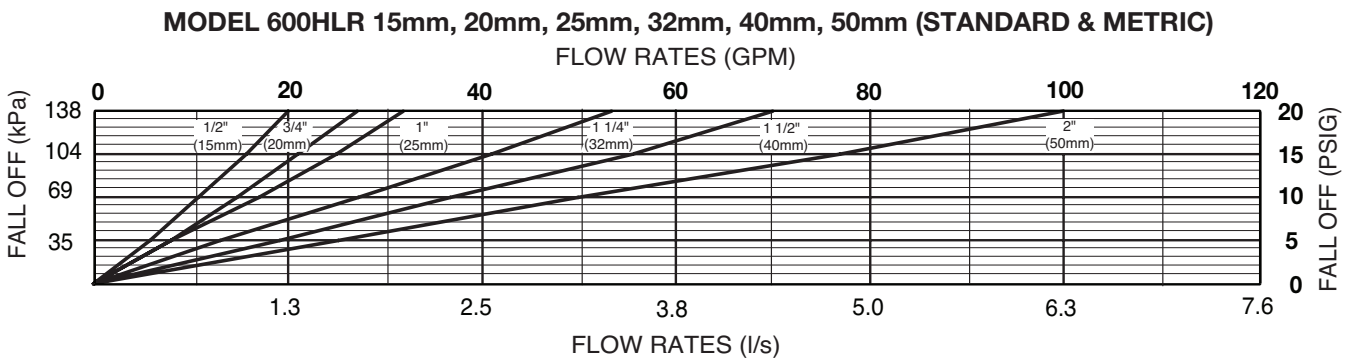

## Typical Installation

Local codes shall govern installation requirements. To be installed in accordance with the manufacturers' instructions and the latest edition of the Plumbing Code of Australia and/or AS/NZS 3500. The Model 600HLR may be installed in any position. Multiple installations are recommended for wide demand variations or where the desired pressure reduction is more than 3 to 1 (i.e.: 1050 kpa inlet reduced to 350 kpa outlet). **CAUTION:** Anytime a reducing valve is adjusted, a pressure gauge must be used downstream to verify correct pressure setting. Do not bottom adjustment bolt on bell housing.

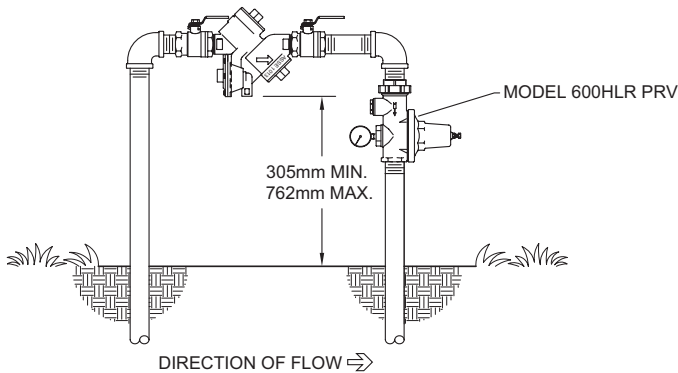

OUTDOOR INSTALLATION

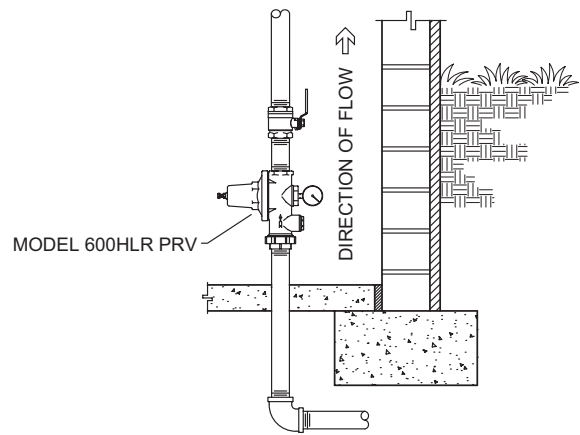

VERTICAL INSTALLATION

## Specifications

The Pressure Reducing Valve shall be certified to local codes, consist of a low lead bronze body and bronze bell housing, shall have separate access covers for the plunger and strainer screen and shall have a bolt to adjust the downstream pressure. The Pressure Reducing Valve shall be of the balanced piston design and shall reduce pressure downstream within a range of 170-875kPa. The bronze bell housing and access caps shall be threaded to the body and shall not require the use of ferrous screws and should allow for servicing without removing from the line. The Pressure Reducing Valve shall be a ZURN Model 600HLR.