



Milli Inox Sink Mixer (5*)

INSTALLATION INSTRUCTIONS:

1. Cut a mounting hole 35mm in diameter
2. Feed hoses through nut, washer and Threaded Sleeve
3. From underneath the sink, feed the flexible hoses up through the sink hole and through the Dress Ring
4. Connect the hoses into the recessed connection in the mixer body
5. Screw the Dress Ring to the body and fit the Threaded Sleeve into the Dress Ring
6. Tighten the nut on the washer to fixer the mixer firmly to the sink
7. Connect the water supply:
 - Red Marking Hose to Hot Water
 - Blue Marking Hose to Cold Water
8. Turn on the water supply and check for leaks

WATER SUPPLY REQUIREMENTS:

To ensure optimum performance and customer satisfaction please adhere to the following:

- If the water pressure exceeds or is likely to exceed 500kPa, an approved pressure limiting valve must be fitted
- Flush out all pipe work prior to installation
- If the water temperature exceeds 50°C, an approved tempering valve must be fitted
- Installation should comply with Australian standard AS/NZS 3500 or relevant local authority requirements

CLEANING RECOMMENDATIONS:

We recommend the use of soapy water or approved cleaners. This product should not be cleaned with abrasive materials. Damage caused by any improper treatment is not covered by the product warranty. Refer to Warranty Conditions

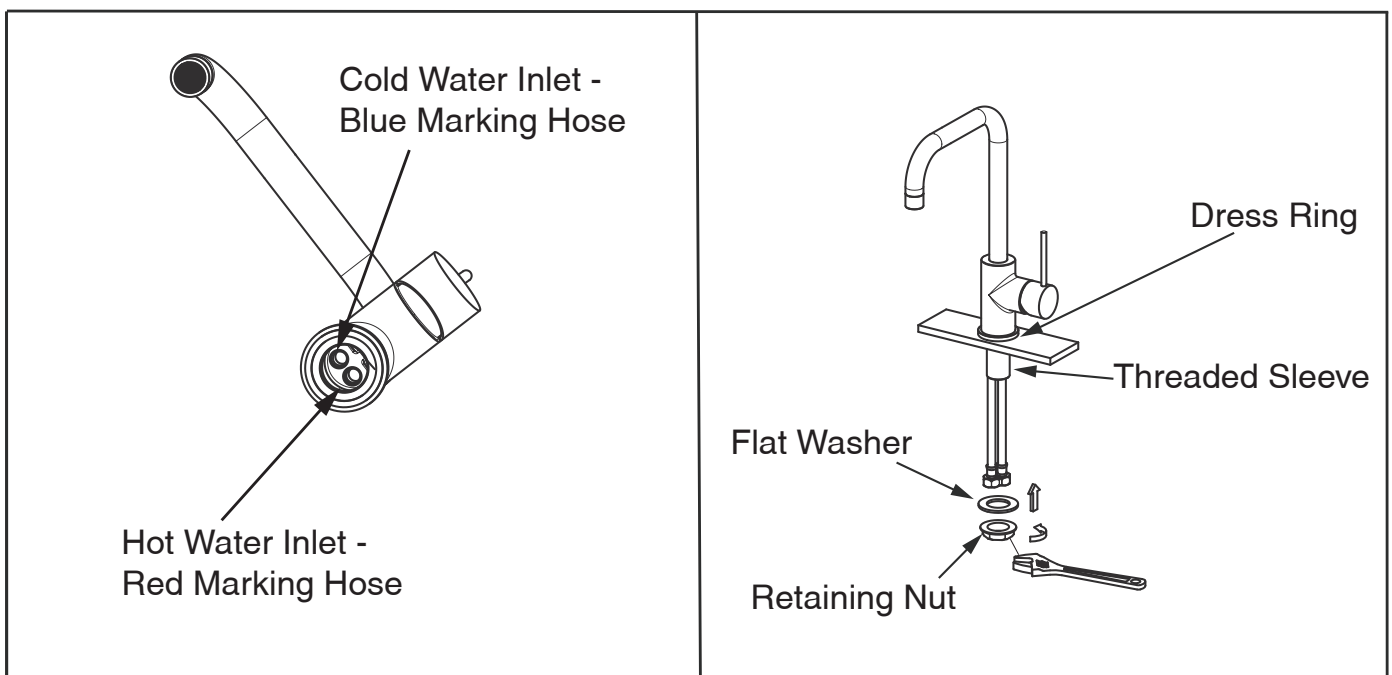

Plumbers, please ensure a copy of the Installation Instructions are left with the end user for future reference