

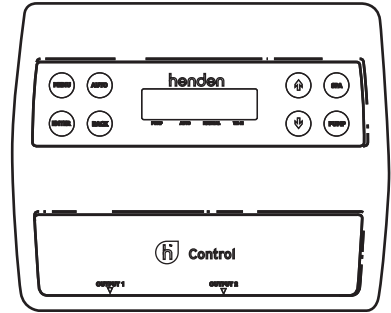

Control

QUICK START GUIDE



Thank you for purchasing the Henden Control.

The Henden Control allows you to effortlessly control pumps, heater, sanitiser, valves, water features, spa equipment and much more! Simply download the app to program, monitor and control the pool from the palm of your hands. It's pool automation, made simple.

HELPFUL HINTS

- Install the Henden Control out of direct weather.
- Ensure a strong 2.4ghz Wi-Fi signal at the install location.

IMPORTANT
Please read carefully



CAUTIONS AND WARNINGS:

The Henden Control is not intended for use by young children or infirm persons without supervision. Please ensure that young children are supervised to ensure they do not play with the appliance.

Installation must be handled by a professional pool builder/service agent.

Repair and disposal must be carried out by manufacturer approved service personnel.

Scan to view the complete installation manual:



henden™

SPECIFICATIONS

	ELECTRICAL CONNECTION	NUMBER OF POWER OUTLETS	MAXIMUM COMBINED LOADS
Henden Control	10a Plug	2x 10amp	9.9amp (2370w)
Henden Control 10amp Expansion Module	10a Plug	3x 10amp	9.9amp (2370w)
Henden Control 15amp Expansion Module	15a Plug	3x 10amp	14.9amp (3570w)

*Please refer to each unit's rating label.

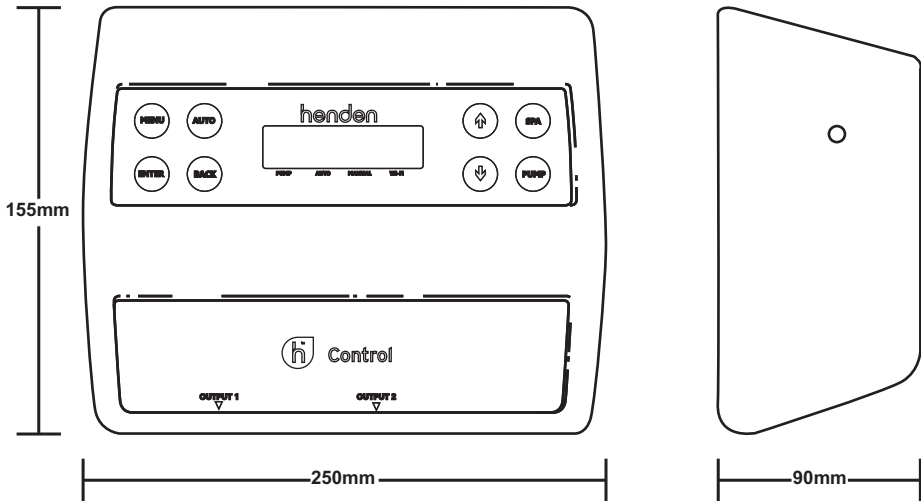

INSTALLATION

Positioning the Henden Control

Position the Henden Control at least 3m from the pool water's edge, and a minimum of 600mm above ground level.

Ensure the Henden Control is plugged directly into a general power outlet.

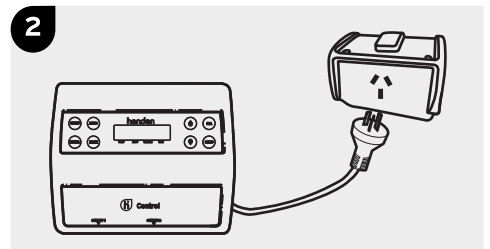
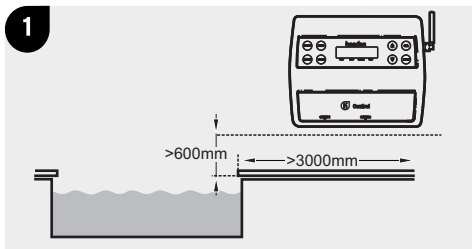

INSTALLATION

Mounting the Henden Control

Use the screw and wall plug kit provided to mount the bracket to a solid structure with a flat surface. Place the Henden Control onto the bracket. Adjust the screws on the back of the Henden Control to ensure a snug fit.

Connect the Wi-Fi antenna to the Henden Control. Do not use a tool to tighten the antenna.

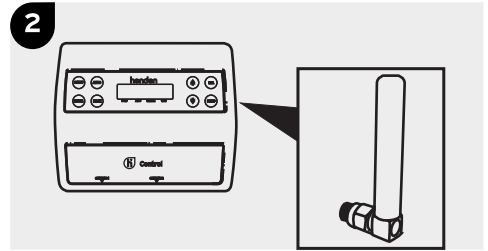
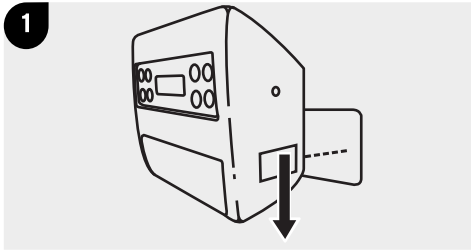

Connecting Equipment to the Henden Control

Using the labels on the underside of the Henden Control as a guide, connect the supplied temperature sensor & required equipment.

Warning! The maximum combined load for both sockets on the Henden Control is 9.9 AMPS at 2380W.

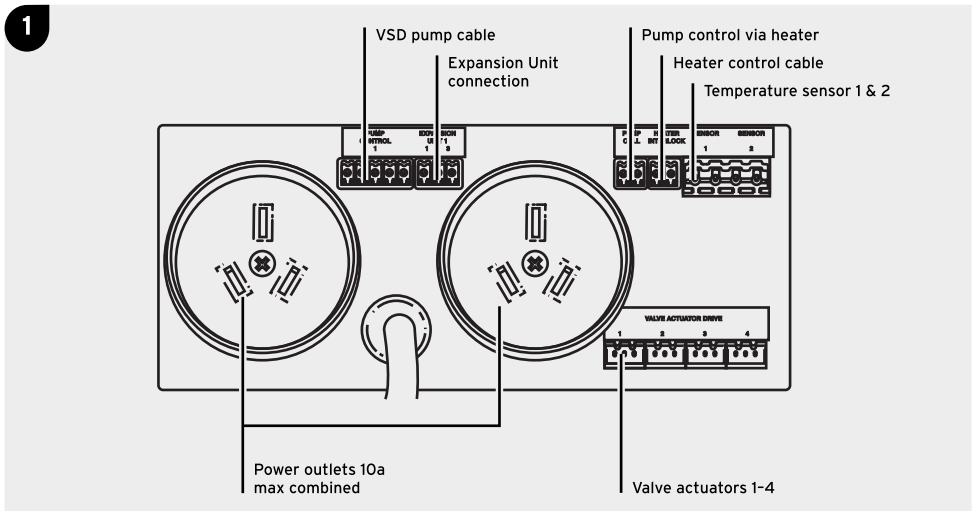

Connecting a Pool Temperature Sensor

Position the pool sensor before the heat pump within the heating circuit and outside of direct sunlight.

Drill a 14.5mm hole in the side of the PVC pipe.

Handy Tip! Do not drill a hole on the top of the pipe.

Handy Tip! To minimise pipe shatter either use a grinding drill or create a small pilot hole, then use a 14mm drill-bit spinning in a counter-clockwise direction.

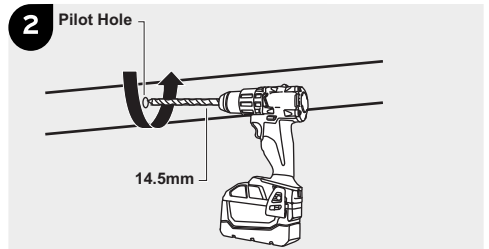
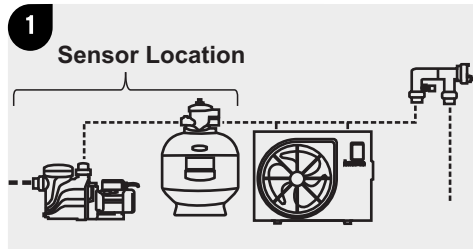

Insert the grommet into the pipe and gently push in the sensor barb.

Handy Tip! To prevent extreme ambient conditions effecting the sensor, tie at least 30cm of the cable to the shaded side of the pipe.

Note: If you are connecting the roof sensor refer to the full manual.

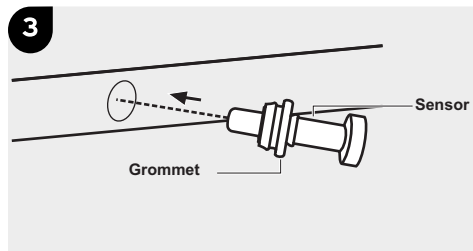

INSTALLATION

Connecting Henden Control Expansion Modules

If you're using a Henden Control Expansion Module, follow the steps below.

Connect the communication cable from 'Expansion Unit 1' on the Henden Control to 'Expansion In' on the Henden Control Expansion Module.

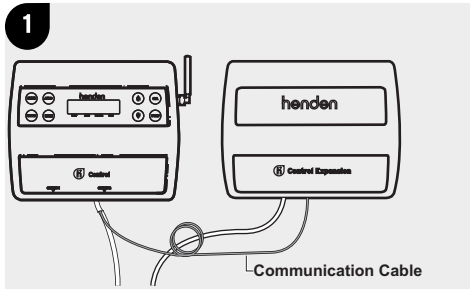

Connecting a Multi-Speed Pump Communication Cable

To enable pump speed and power control, a communication cable (purchased separately) is required to connect a multi speed pump to the Henden Control. Refer to your pump installation manual for correct connection to the pump.

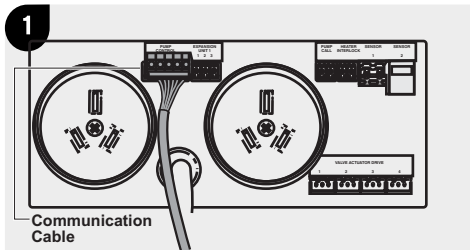

Connecting a Heater With the Interlock Cable Supplied

Warning! If the heater's flow or pressure switch circuit is 240V, an external relay (KIT10) is required and can be purchased separately, this connection is required to be completed by a licensed electrician.

To prevent the heater setpoint limiting the temperature setpoint in the Henden Control, adjust the heater setpoint to its maximum (typically 40°C).

Connect the terminated end of the interlock cable to the 'heater interlock' port on the Henden Control.

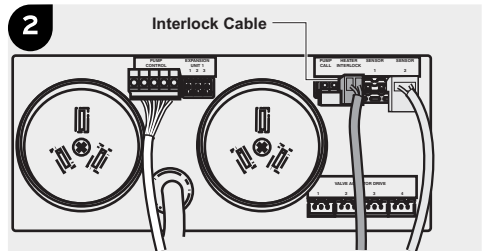
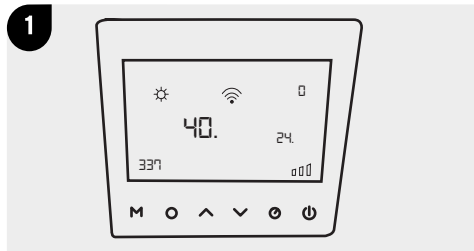

Connect the heater end of the interlock cable in series with the heater's external controller input, pressure, flow or fireman's switch.

For connecting as a 'Heat Demand' function, refer to the Henden Control full installation guide.

Handy Tip! Refer to your heater installation manual for appropriate connection method for the external controller input.

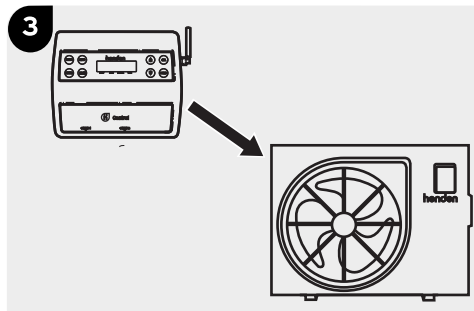

FIRST TIME START UP VIA THE APP

Handy Tip! If no smart device or Wi-Fi connection is available, refer to the complete installation manual for setup using the Henden Control display.

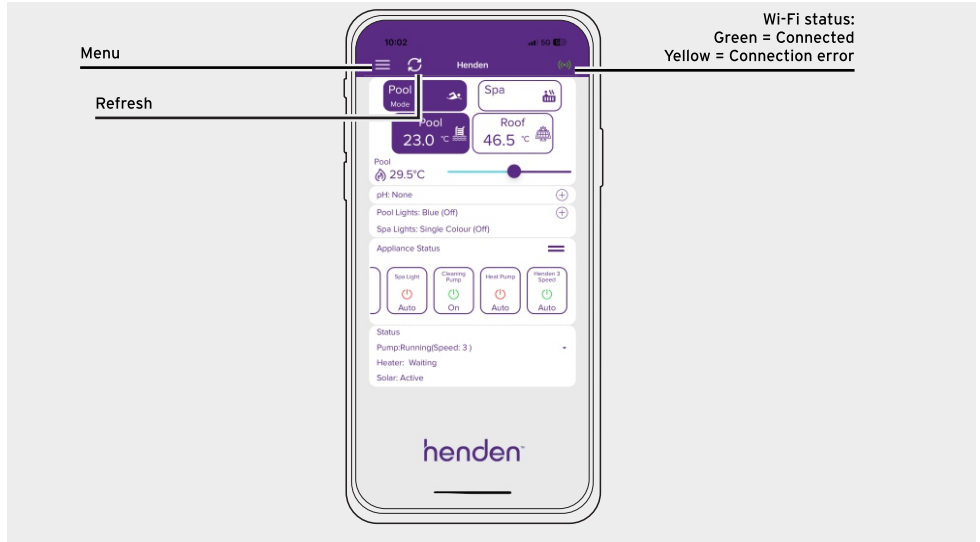

Download the Henden Control App via the app store or Google Play.



Open the app and select Menu, Device and then Scan. This will launch the QR Code Scanner.

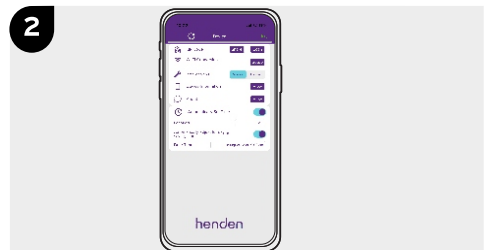

FIRST TIME START UP VIA THE APP

Scan the QR code on the Henden Control.

Handy Tip! Ensure the smart device is connected to the same 2.4ghz Wi-Fi network you want the Henden Control to connect with.

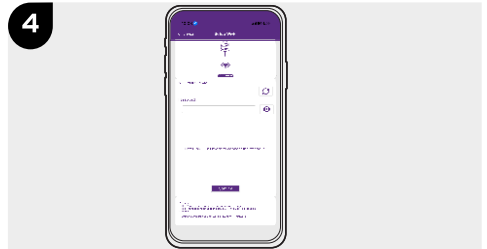
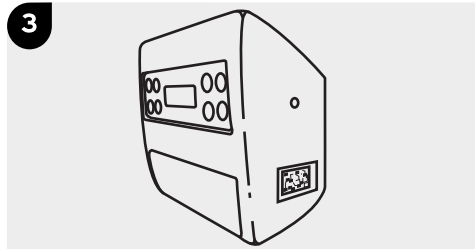

In the menu, select 'Appliance Setup'. A full list of available sockets and valves will appear. Use the dropdown selections to choose the connected products. To rename any of the appliances, tap the pencil icon and enter a new name.

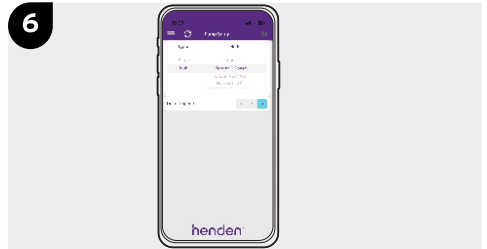
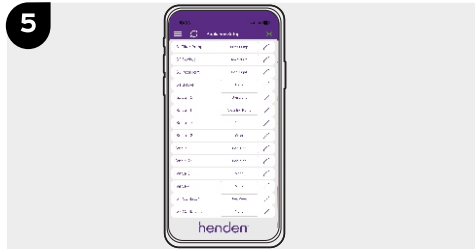

In the menu, select 'Light Setup'. Options will appear for any sockets selected during 'appliance set up' as Pool Light or Spa Light. Select the brand of lights installed.

If pairing with a Henden Balance, please refer to the Henden Balance installation manual.

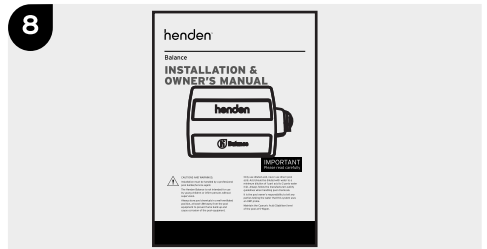
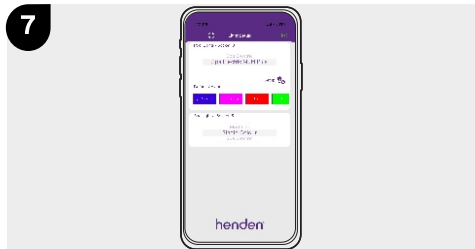

FIRST TIME START UP VIA THE APP

In the menu, select 'Heating Setup'. Any heater you selected during the 'appliance setup' process will appear. Select the mode you want to activate the heater in off/pool/spa. Select whether you want the sanitizer to operate while the heater is on. To set a timer for the heater outside filtration timers, select Timers on the menu and set the 'Heat Demand' timer.

Handy Tip! Henden highly recommends using 'Cool Down' for gas heaters. This will keep the filtration pump running after the heating has finished, to slowly cool down the heater element and prevent potential water boiling inside the heater.

Handy Tip! The Pump speed setting will apply when the heater is 'ON' and using a multi speed pump.

In the menu, select 'Spa Setup' and use the slider to enable or disable Spa Mode.

Use the drop down to choose the Spa Timeout duration to automatically return to Pool Mode.

Connected equipment will appear with the option to run during Spa Mode or when a temperature is reached in Spa Mode.

Handy Tip! When selecting 'At Temperature' use the slider to set the ON temperature for the devices

Handy Tip! If no ORP probe is being used, reducing the Sanitiser ON time % helps prevent over chlorination, as the spa is a smaller body of water than the pool.

If a multispeed pump is connected, select the pump speed to operate when in Spa Mode.

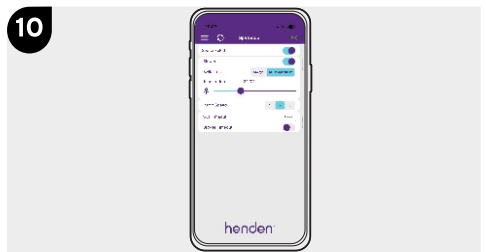
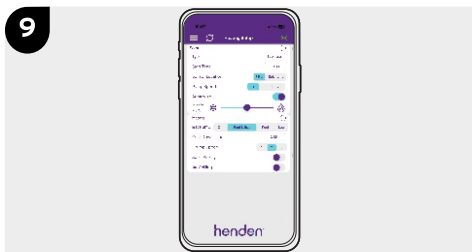

In the menu, select 'Filter Times'. There are four available timers for the connected 'filtration pumps' and 'sanitisers'. Use the drop-down time options to set the Start and End times for each timer. If a multi speed pump is connected, there will be an option to select the pump speed to run for each timer. The 'Run Once' timer can be used to run the filtration system one time only.

Warning: Avoid having active timers overlap their 'From' and 'To' times.

Handy Tip! For continuous pump operation, set one timer to end at the same as the next timer starts.

In the menu select 'Temperature'. Use the slider to select the setpoint for the heater when activated.

Handy Tip! When commissioning heat pumps, activate the 'Run till heated' option. This will keep the filtration system running until the temperature setpoint is achieved.

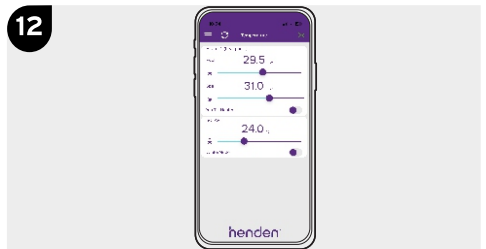
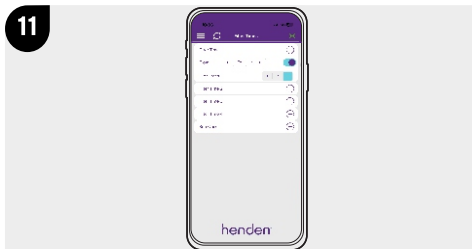

FIRST TIME START UP VIA THE APP

In the menu select 'Timers'. Here you can schedule timers for all non-filtration system devices connected to the Henden Control.

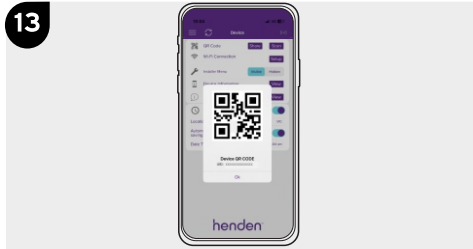

In the menu, select 'Device' then select 'Share'. This can be shared or scanned by another smart device to automatically load the device and settings.

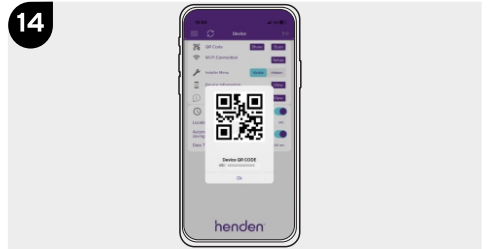

Congratulations! The Henden Control is now set up and ready to use. Use the home screen of the app for complete control of the pool.

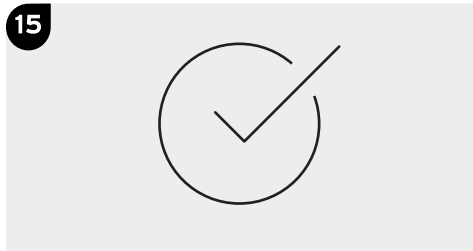

NOTES

HENDEN™ REPAIR OR REPLACEMENT GUARANTEE

Thank you for purchasing the Henden Control. The Henden Control is covered by a limited 3 year warranty against component failure or faulty workmanship from the date of installation.

By using the Henden Control you accept the terms and conditions of this warranty. The warranty is subject to the qualifications, conditions and limitations as described below.

Should you experience any difficulties with your Henden Control, please contact your local Reece Irrigation & Pools branch or call 1300 Henden – our customer support line. On receipt of your claim, Henden will seek to resolve your difficulties – if the product is faulty or defective, our team will advise you on how to have your Henden product repaired, obtain a replacement or a refund. Henden does not cover normal wear or tear, or damage resulting from misuse or negligent handling, improper use for which the product was not designed or advertised, failure to properly follow the provided installation and operating instructions, failure to carry out maintenance, corrosive or abrasive water or other liquid, lightning or high voltage spikes, or unauthorized persons attempting repairs.

Where applicable, your Henden product must only be connected to the voltage shown on the nameplate. Henden does not cover freight, or any other costs incurred in making a claim. Please retain your receipt as proof of purchase; you **MUST** provide evidence of the date of original purchase when making a claim. To the maximum extent of the law, **Henden shall not be liable for any loss of profits or any consequential, indirect, or special loss, damage to persons or property, or injury of any kind whatsoever arising directly or indirectly from Henden products.** Should your Henden product require repair or service after the guarantee period; contact your nearest Reece Irrigation & Pools branch.

For a complete list of Reece Irrigation & Pools branches visit our website reece.com.au/storefinder

Technical and after sales support:
1300 HENDEN (1300 436 336)

Manufacturer:
Dontek Electronics Pty Ltd
19 Melrich Road
Bayswater VIC 3153

Scan to view the complete installation manual:

