

KADO

NEUE FLUTED ALL DRAWER SINGLE CURVED END / SINGLE SQUARED END



12mm Bullnose benchtop /
Blonde Oak



20mm Bullnose benchtop /
Boston Oak



50mm Squared benchtop/
Florentine Walnut



90mm Squared benchtop /
Ultra White

SPECIFICATIONS

Recommended Use	Domestic, Hotel and Commercial
Vanity Top Material	Bullnose edge - 12mm Durasein, 20mm Cherry Pie or 20mm Caesarstone Mineral (Surcharge applies). Squared edge - 50mm or 90mm Thick Benchtop available (Durasein only) Basin sold separately. For more information please refer to the Colour Finish and Material Variations Document.
Vanity Unit Material	MDF MR E0 (Medium Density Fibreboard, Moisture Resistant, Rated Emission Level E0)
Vanity Colour Variations	Thermolaminated Fluted Cabinetry available in: Ultra White Matte, Blonde Oak Woodmatt, Boston Oak Woodmatt, Florentine Walnut Woodmatt
Interior Finish	Premium Graphite
Tap Hole Availability	0, 1 or 3 Tap Holes (pending basin selection)
Waste	Chrome Universal Plug & Waste 40mm Outlet (included)
Fixing	Bolted/Screwed to the wall by a licensed tradesperson (Fixings not included).
Drawer(s)	ADP Deluxe Solid Sided Drawers with internal drawer & Graphite Interiors
Handle Options	Handle Options: Aria, 350mm Blaze or Francis For finishes available refer to the Colour Finish and Material Variations Document.

Disclaimer: Products in this specification manual must by regulation be installed by licensed and registered trade people. The manufacturer/distributor reserves the right to vary specifications or delete models from their range without prior notification. Dimensions are nominal measurements only. Dimensions and set-outs listed are correct at time of publication however the manufacturer/distributor takes no responsibility for printing errors.

Tech Page Version 1

To see the complete KADO range go to
www.reece.com.au/bathrooms



KADO

NEUE FLUTED ALL DRAWER SINGLE CURVED END / SINGLE SQUARED END

STANDARD SIZES	600mm	750mm	1050mm	1350mm	1650mm
Number of Drawers (Including internal)	2	2	4	4	6
Basin Configurations	Centre	Centre	Centre/Offset	Centre/Offset/ Double	Centre/Offset/ Double
12mm Bullnose Benchtop (Durasein Only)					
Width (mm)	626	778	1071	1375	1669
Depth (mm)	506	506	506	506	506
Height (mm)	462	462	462	462	462
20mm Bullnose Benchtop (Cherry Pie & Caesarstone Mineral Only)					
Width (mm)	630	782	1075	1379	1673
Depth (mm)	510	510	510	510	510
Height (mm)	470	470	470	470	470
50mm Squared Benchtop (Durasein Only)					
Width (mm)	620	772	1065	1369	1663
Depth (mm)	500	500	500	500	500
Height (mm)	500	500	500	500	500
90mm Squared Benchtop (Durasein Only)					
Width (mm)	620	772	1065	1369	1663
Depth (mm)	500	500	500	500	500
Height (mm)	540	540	540	540	540

KADO

NEUE FLUTED ALL DRAWER SINGLE CURVED END / SINGLE SQUARED END

Left Curved End Shown, Right is same but mirrored. If against wall installation is required, remove 6mm from benchtop on flat end. (Please indicate on order form)

600mm - 12mm Bullnose (Durasein Only)

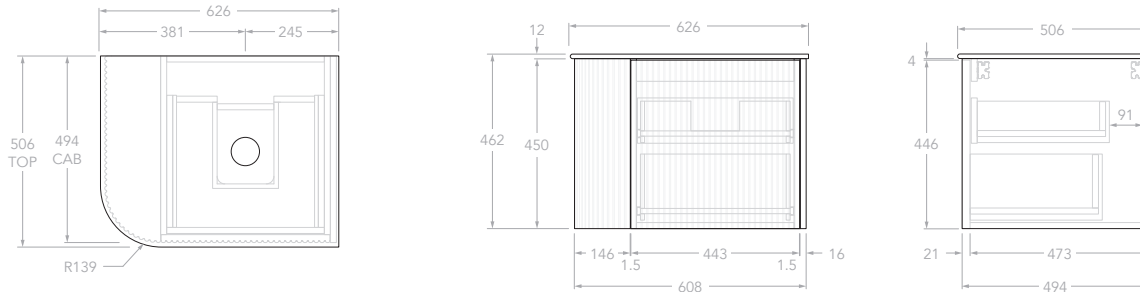

600mm - 20mm Bullnose (Cherry Pie & Caesarstone Only)

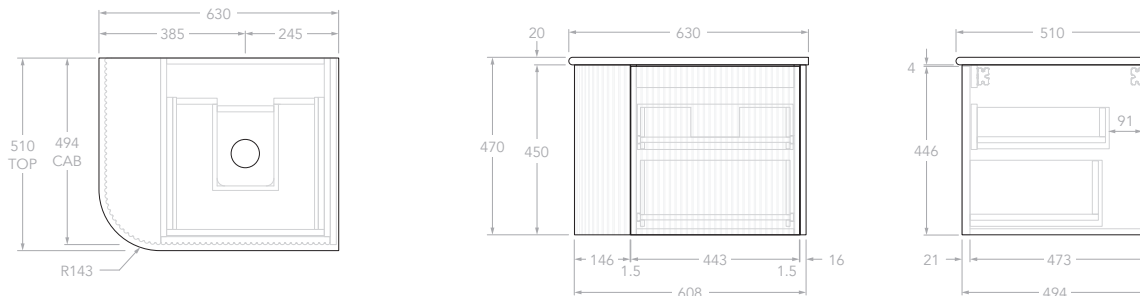

600mm - 50mm Squared (Durasein Only)

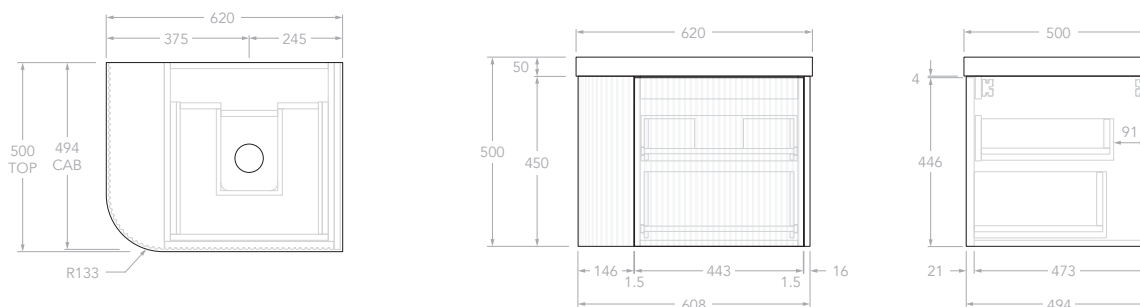

600mm - 90mm Squared (Durasein Only)

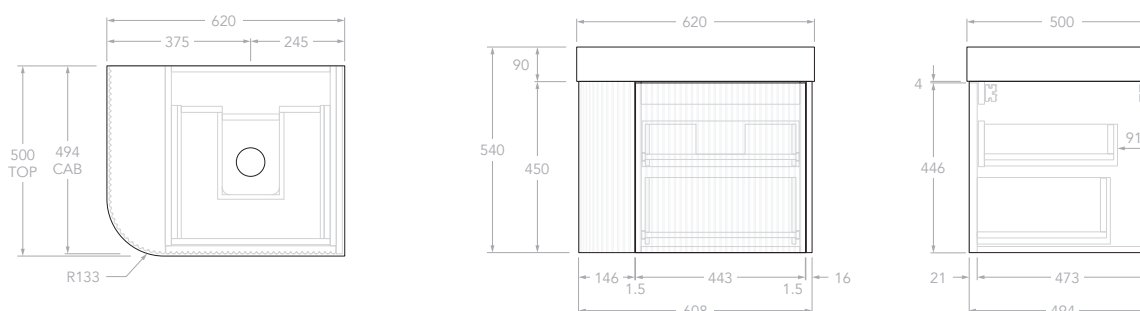

KADO

NEUE FLUTED ALL DRAWER SINGLE CURVED END / SINGLE SQUARED END

Left Curved End Shown, Right is same but mirrored. If against wall installation is required, remove 6mm from benchtop on flat end. (Please indicate on order form)

750mm - 12mm Bullnose (Durasein Only)

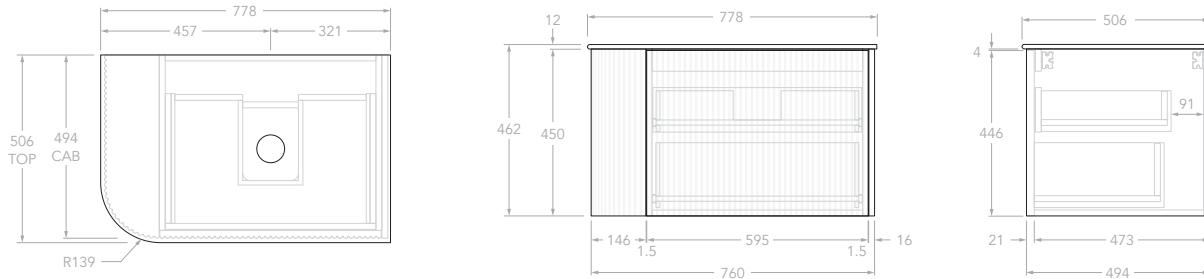

750mm - 20mm Bullnose (Cherry Pie & Caesarstone Only)

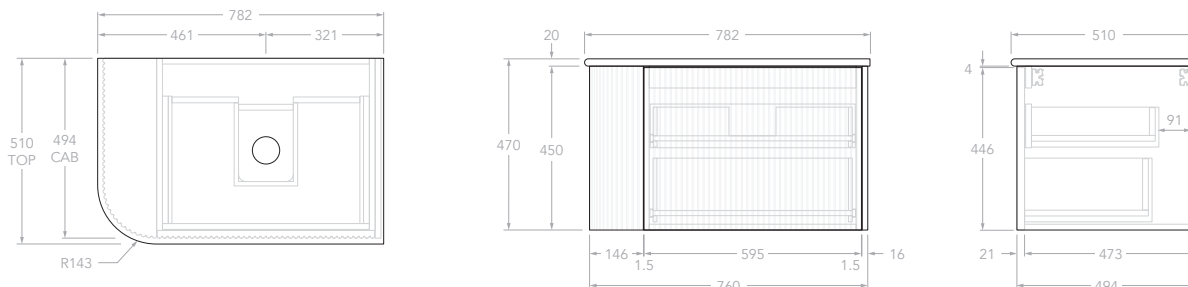

750mm - 50mm Squared (Durasein Only)

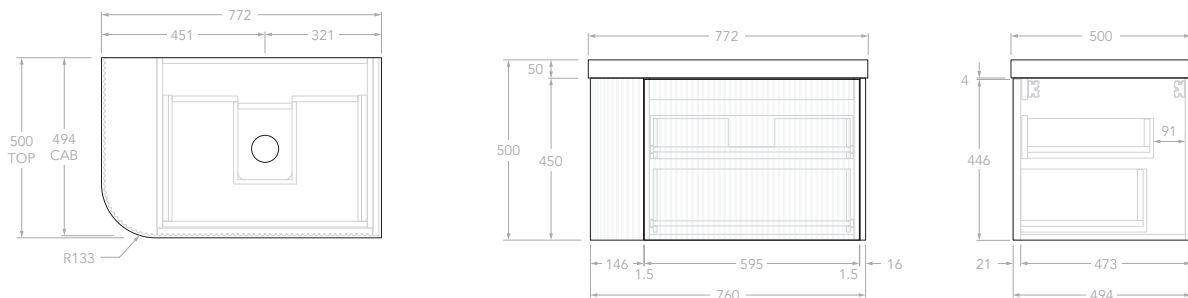

750mm - 90mm Squared (Durasein Only)

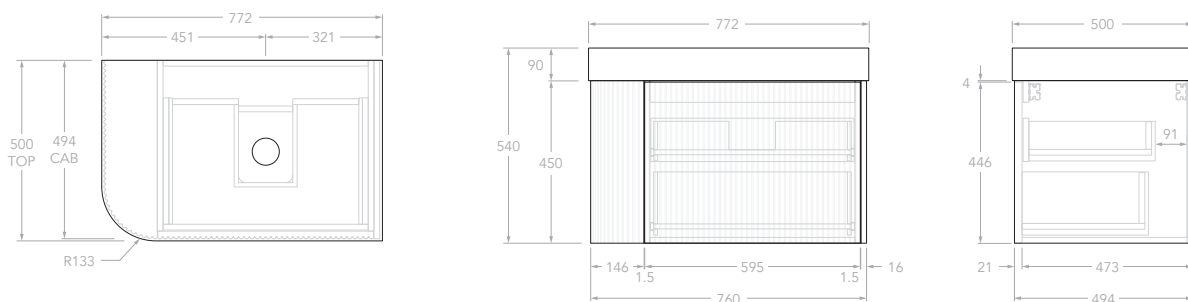

KADO

NEUE FLUTED ALL DRAWER SINGLE CURVED END / SINGLE SQUARED END

Left Curved End Shown, Right is same but mirrored. If against wall installation is required, remove 6mm from benchtop on flat end. (Please indicate on order form)

1050mm - 12mm Bullnose (Durasein Only)

Centre

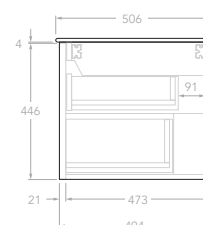
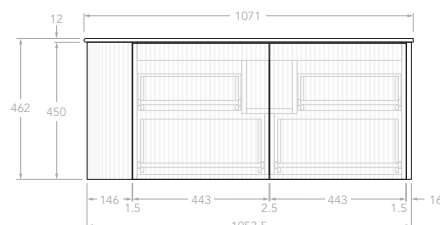
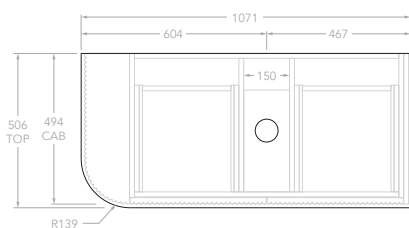

Left Offset

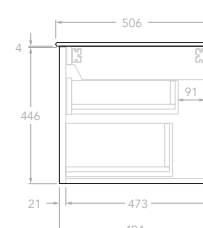
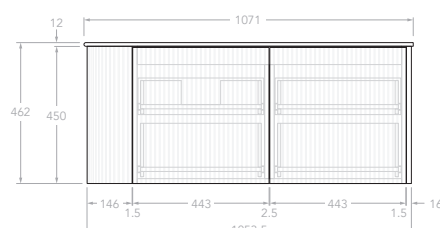
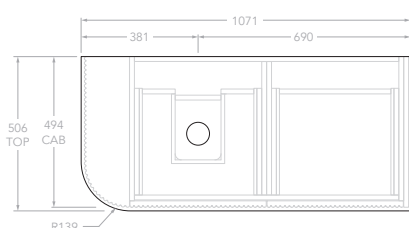

Right Offset

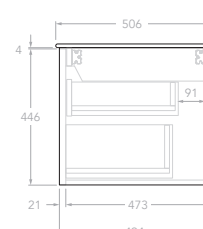
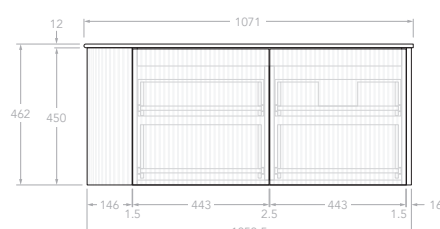
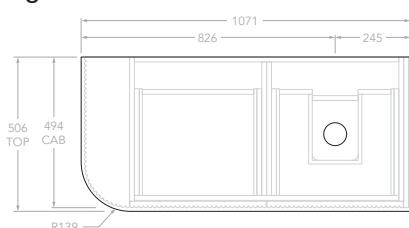

1050mm - 20mm Bullnose (Cherry Pie & Caesarstone Only)

Centre

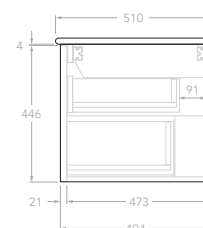
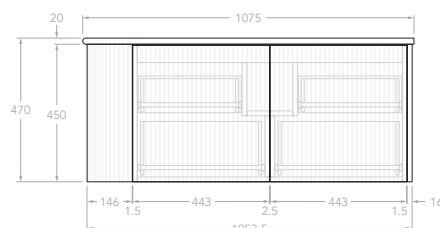
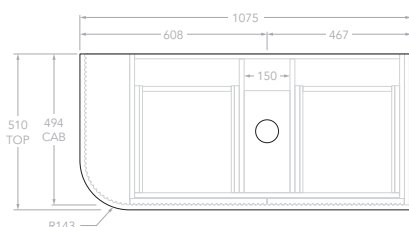

Left Offset

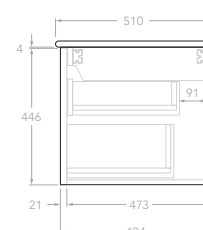
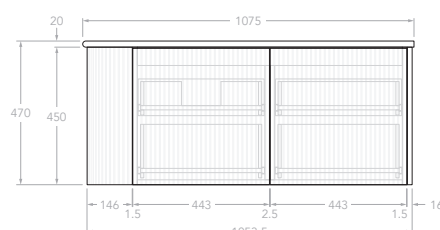
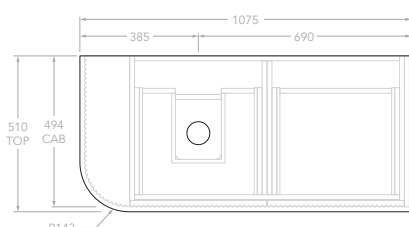

Right Offset

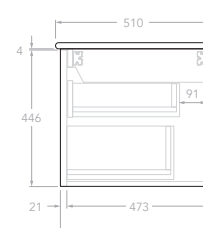
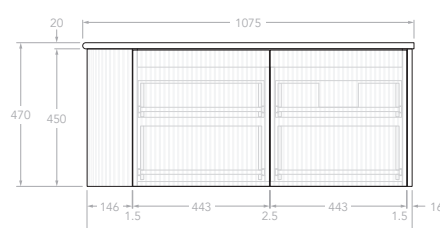
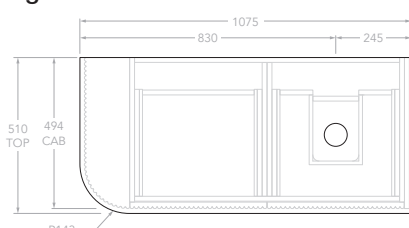

KADO

NEUE FLUTED ALL DRAWER SINGLE CURVED END / SINGLE SQUARED END

Left Curved End Shown, Right is same but mirrored. If against wall installation is required, remove 6mm from benchtop on flat end. (Please indicate on order form)

1050mm - 50mm Squared (Durasein Only)

Centre

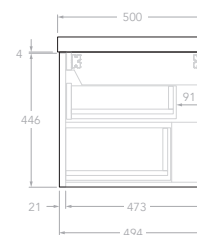
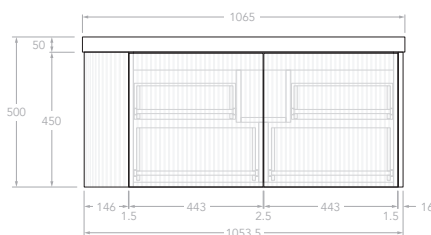
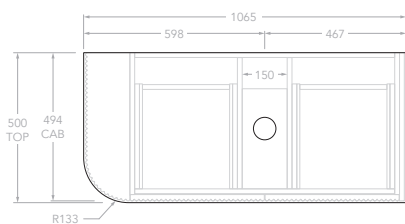

Left Offset

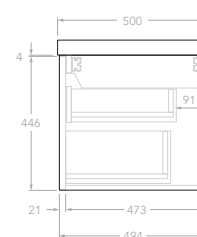
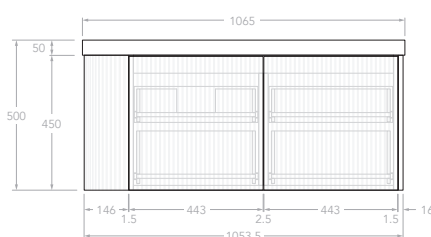
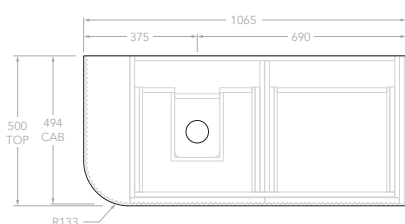

Right Offset

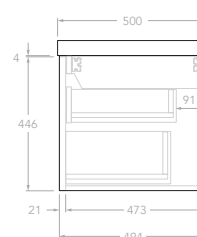
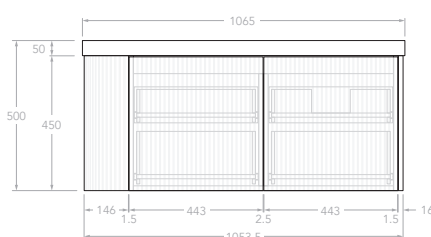
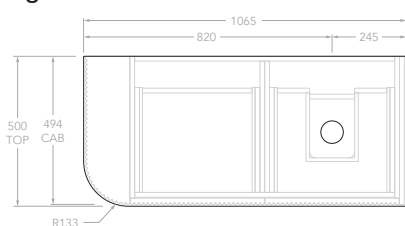

1050mm - 90mm Squared (Durasein Only)

Centre

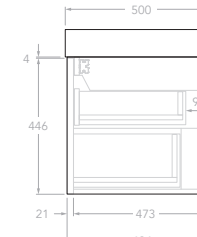
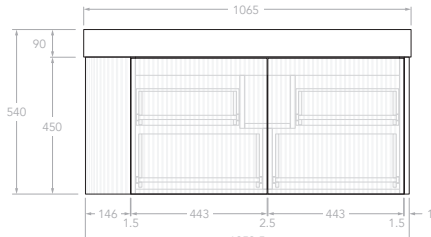
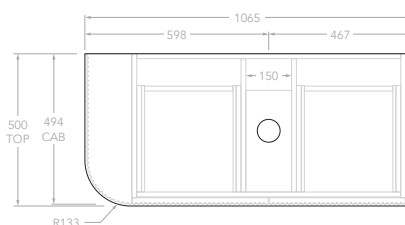

Left Offset

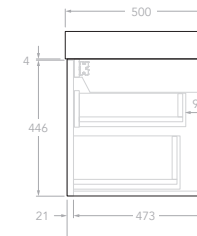
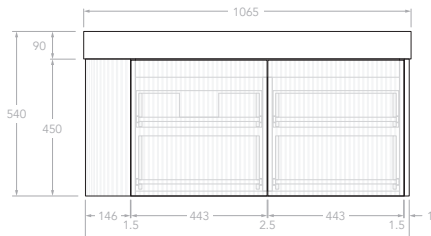
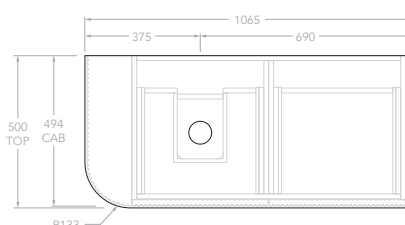

Right Offset

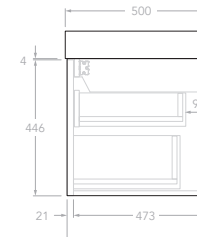
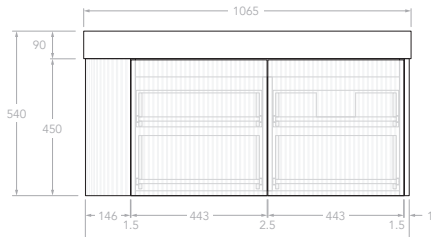
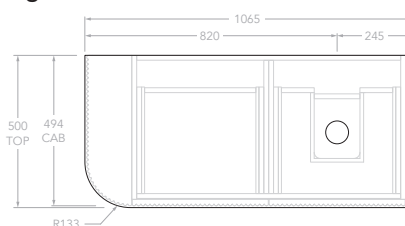

KADO

NEUE FLUTED ALL DRAWER SINGLE CURVED END / SINGLE SQUARED END

Left Curved End Shown, Right is same but mirrored. If against wall installation is required, remove 6mm from benchtop on flat end. (Please indicate on order form)

1350mm - 12mm Bullnose (Durasein Only)

Centre

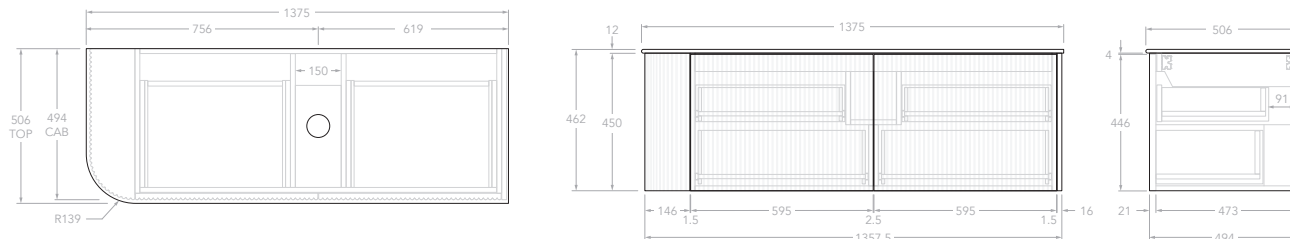

Left Offset

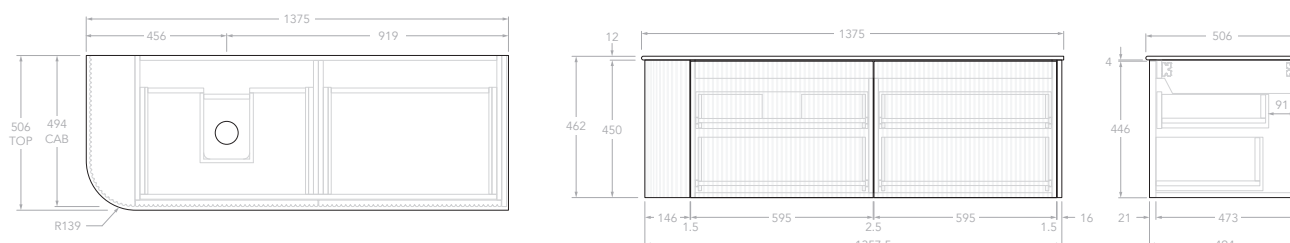

Right Offset

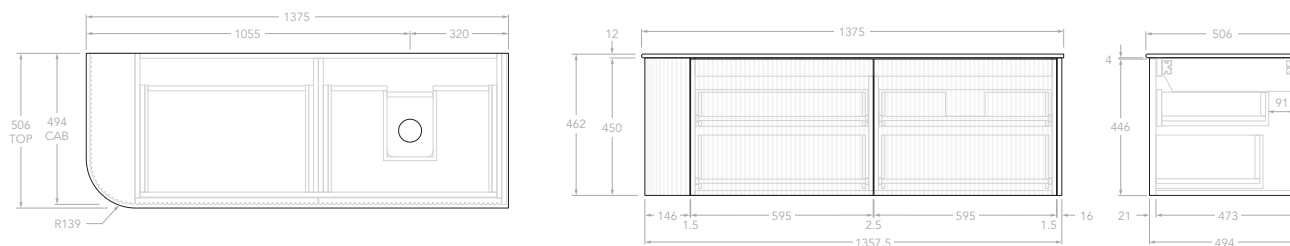

Double

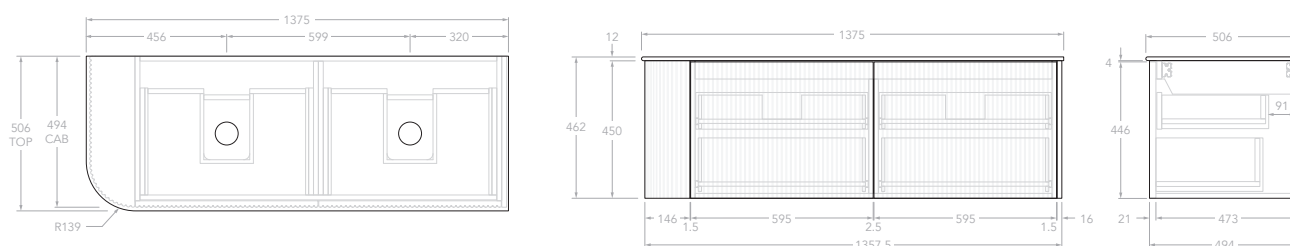

KADO

NEUE FLUTED ALL DRAWER SINGLE CURVED END / SINGLE SQUARED END

Left Curved End Shown, Right is same but mirrored. If against wall installation is required, remove 6mm from benchtop on flat end. (Please indicate on order form)

1350mm - 20mm Bullnose (Cherry Pie & Caesarstone Only)

Centre

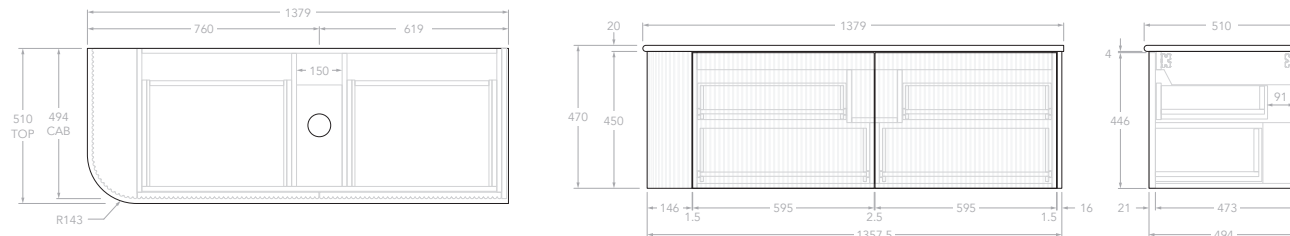

Left Offset

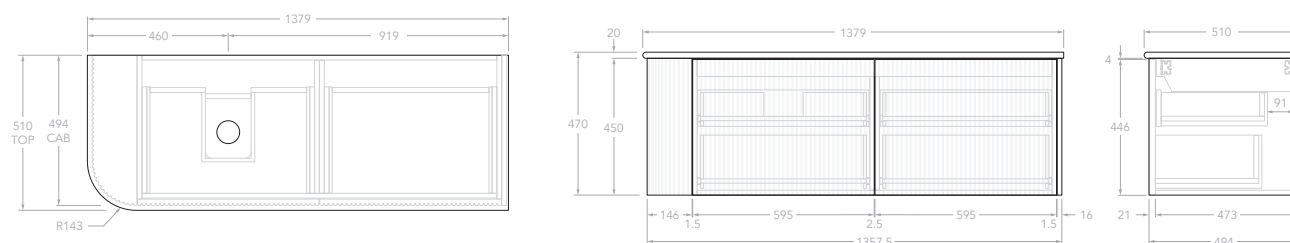

Right Offset

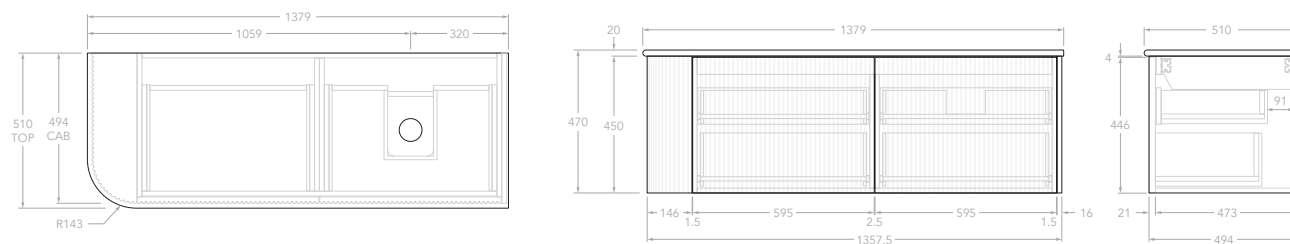

Double

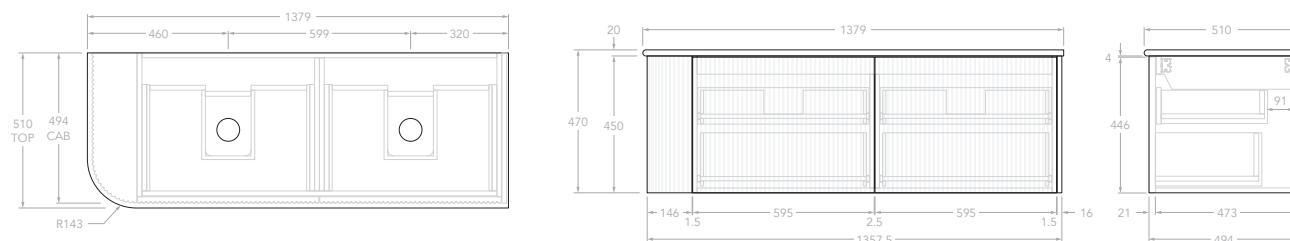

KADO

NEUE FLUTED ALL DRAWER SINGLE CURVED END / SINGLE SQUARED END

Left Curved End Shown, Right is same but mirrored. If against wall installation is required, remove 6mm from benchtop on flat end. (Please indicate on order form)

1350mm - 50mm Squared (Durasein Only)

Centre

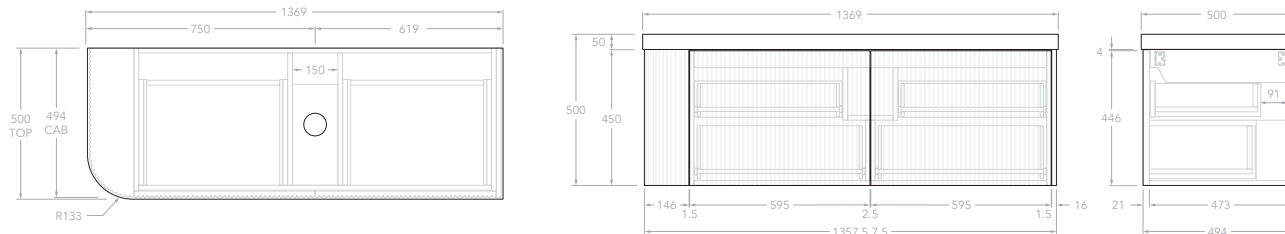

Left Offset

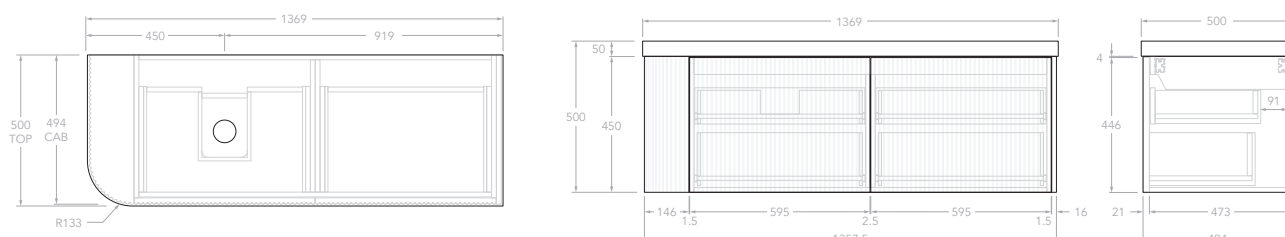

Right Offset

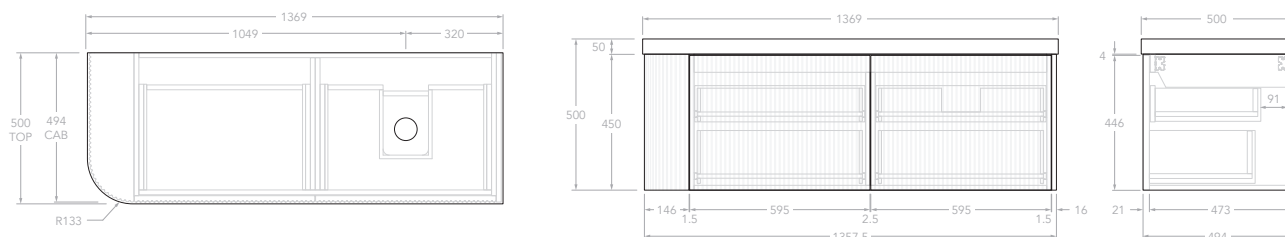

Double

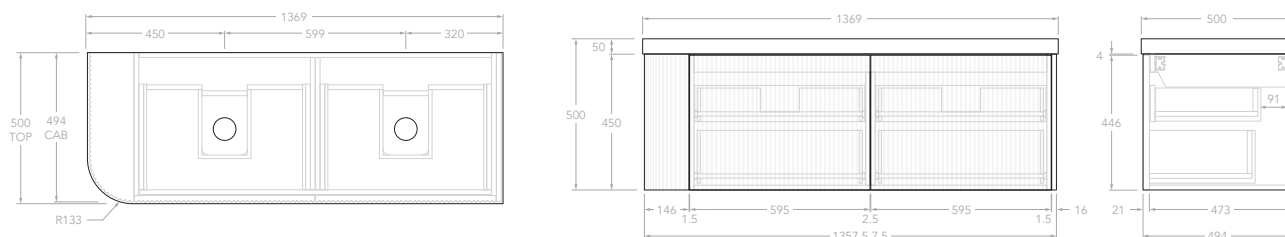

KADO

NEUE FLUTED ALL DRAWER SINGLE CURVED END / SINGLE SQUARED END

Left Curved End Shown, Right is same but mirrored. If against wall installation is required, remove 6mm from benchtop on flat end. (Please indicate on order form)

1350mm - 90mm Squared (Durasein Only)

Centre

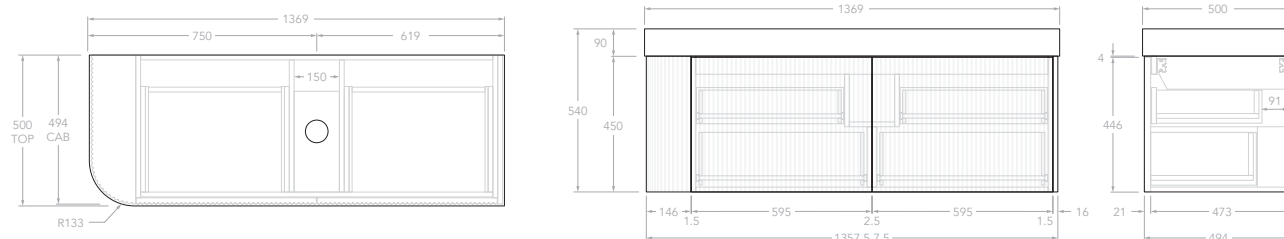

Left Offset

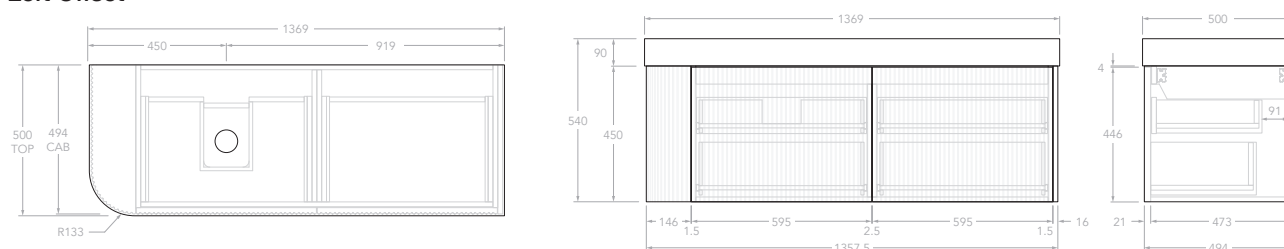

Right Offset

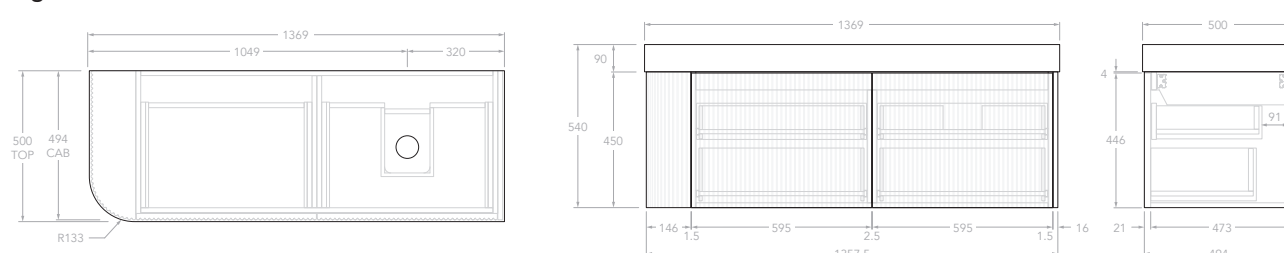

Double

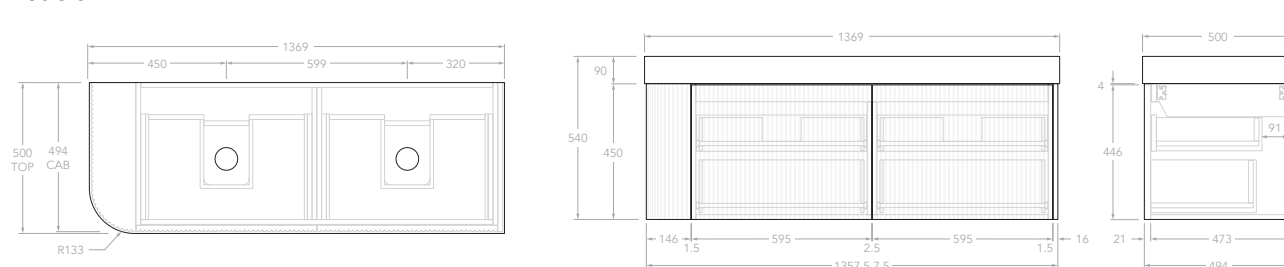

KADO

NEUE FLUTED ALL DRAWER SINGLE CURVED END / SINGLE SQUARED END

Left Curved End Shown, Right is same but mirrored. If against wall installation is required, remove 6mm from benchtop on flat end. (Please indicate on order form)

1650mm - 12mm Bullnose (Durasein Only)

Centre

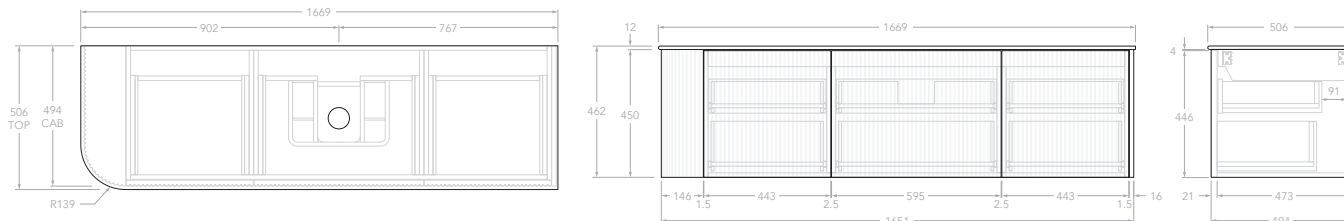

Left Offset

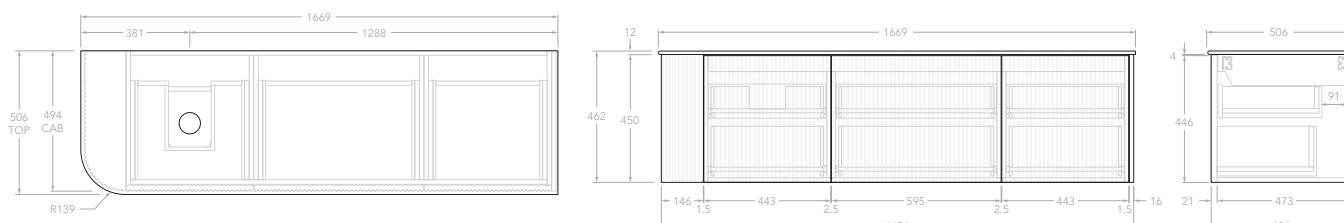

Right Offset

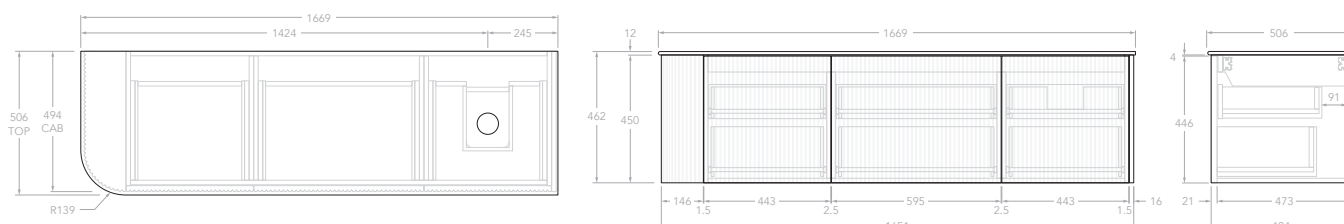

Double

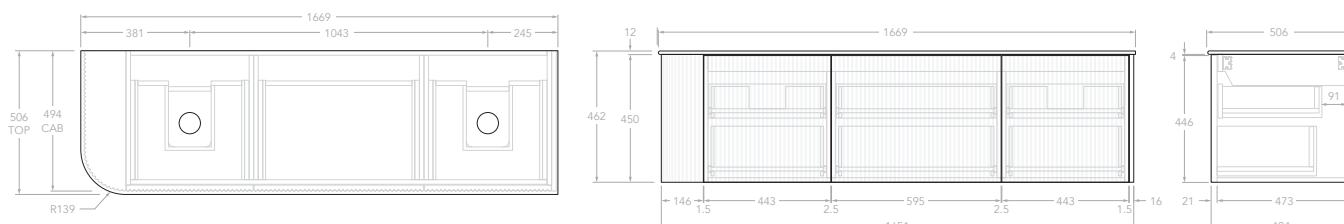

KADO

NEUE FLUTED ALL DRAWER SINGLE CURVED END / SINGLE SQUARED END

Left Curved End Shown, Right is same but mirrored. If against wall installation is required, remove 6mm from benchtop on flat end. (Please indicate on order form)

1650mm - 20mm Bullnose (Cherry Pie & Caesarstone Only)

Centre

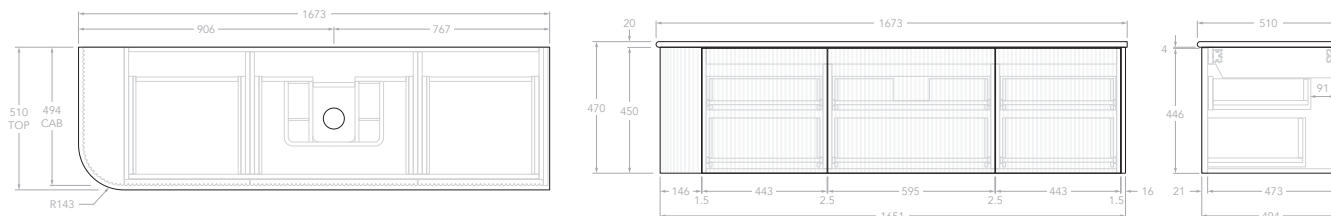

Left Offset

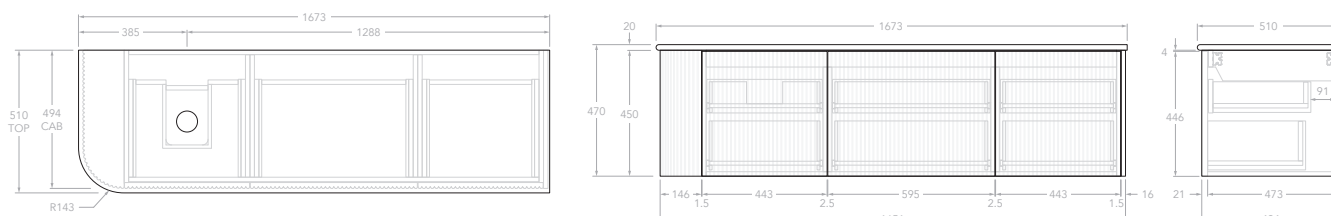

Right Offset

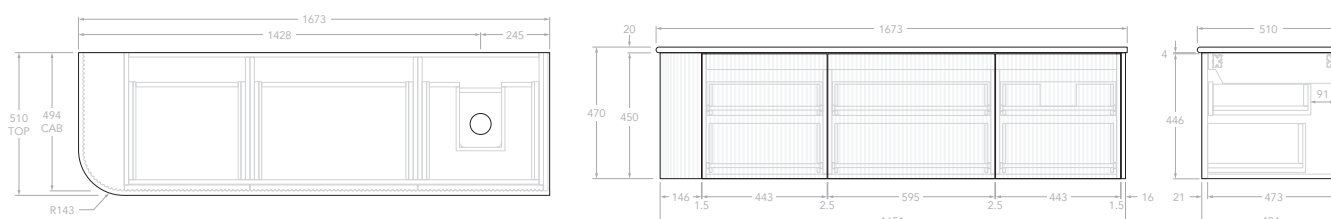

Double

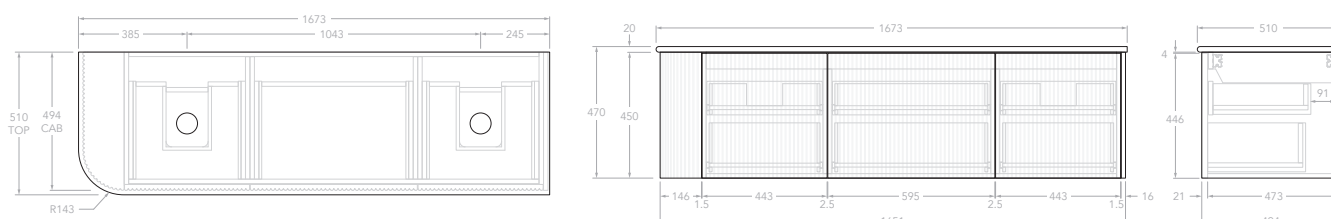

KADO

NEUE FLUTED ALL DRAWER SINGLE CURVED END / SINGLE SQUARED END

Left Curved End Shown, Right is same but mirrored. If against wall installation is required, remove 6mm from benchtop on flat end. (Please indicate on order form)

1650mm - 50mm Squared (Durasein Only)

Centre

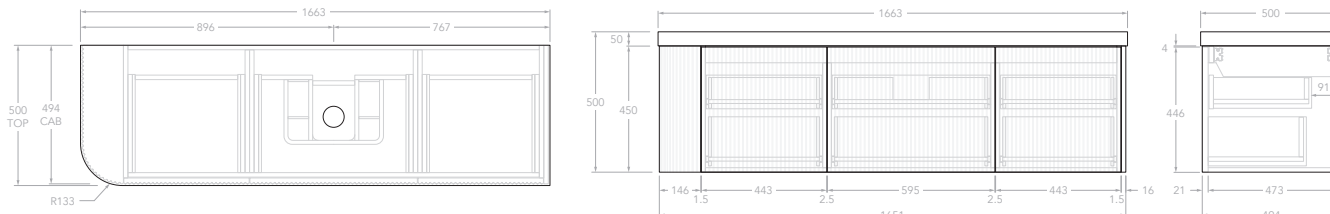

Left Offset

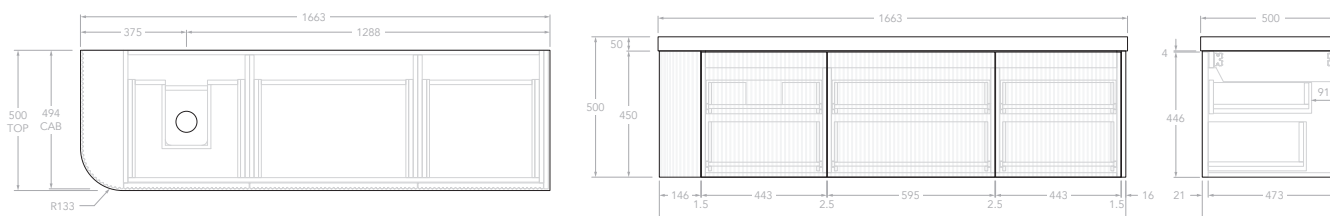

Right Offset

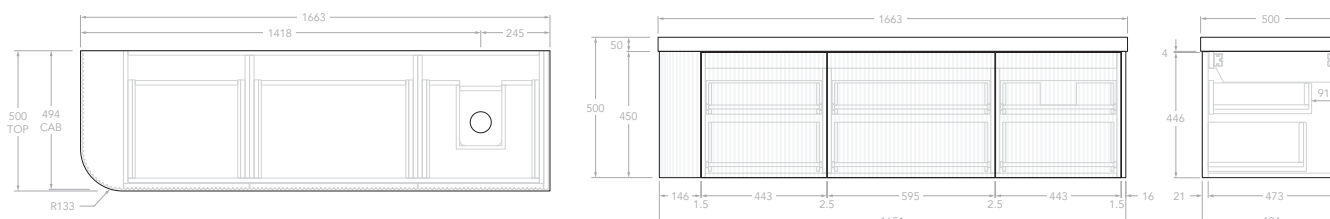

Double

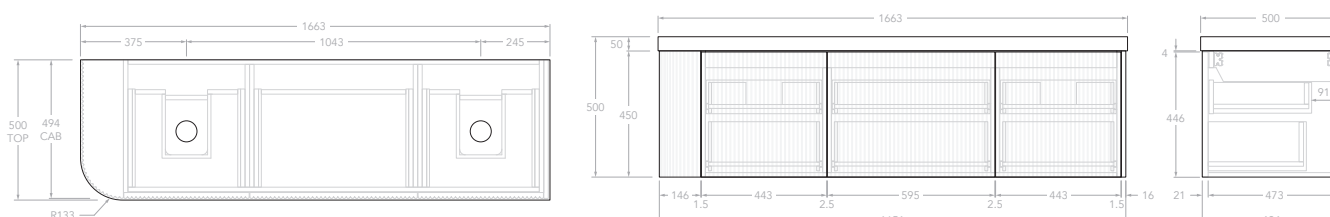

KADO

NEUE FLUTED ALL DRAWER SINGLE CURVED END / SINGLE SQUARED END

Left Curved End Shown, Right is same but mirrored. If against wall installation is required, remove 6mm from benchtop on flat end. (Please indicate on order form)

1650mm - 90mm Squared (Durasein Only)

Centre

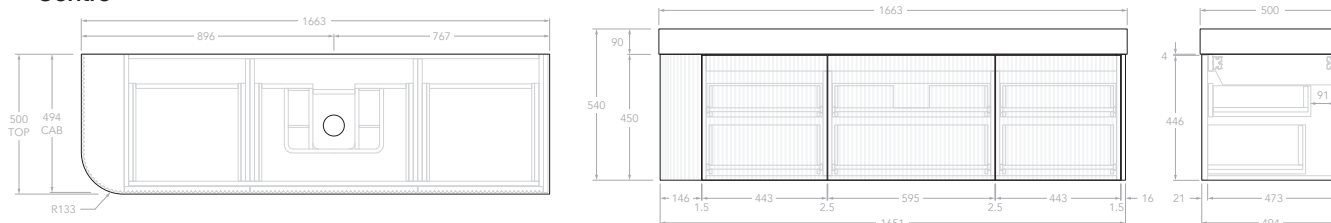

Left Offset

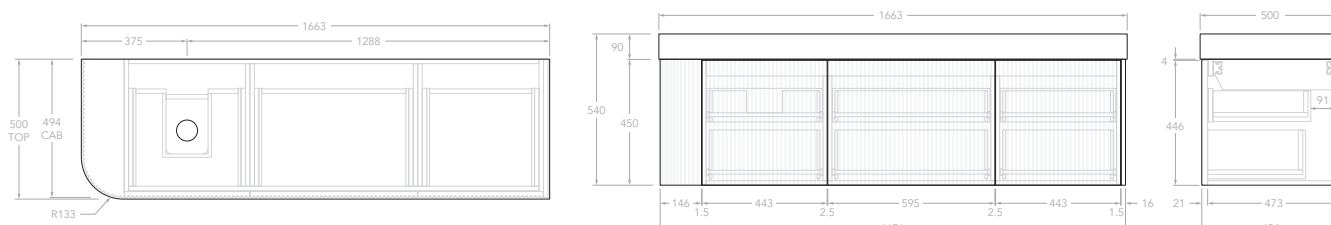

Right Offset

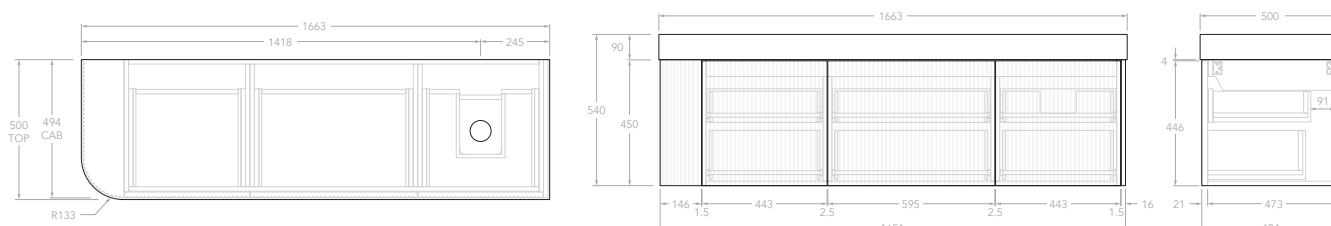

Double

