

### Milli Etch Shower Mixer Tap System with Hand Shower

**1**

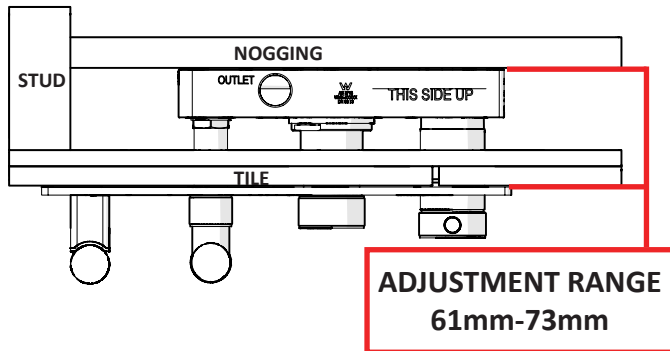

**2**

Screw the Mixer Breach onto Nogging to dimensions shown in adjustment range.

Ensure that the mixer body is level.

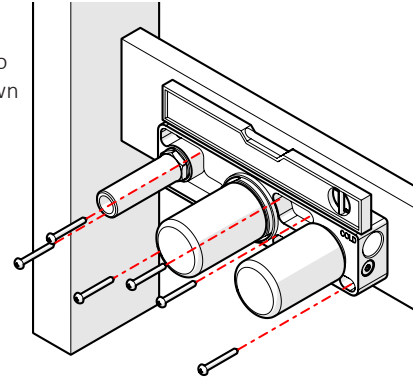

**3**

Plumb all connections to Mixer Body.

Ensure wall outlet fitting is capped. Perform **PRESSURE TEST** and check for leaks.

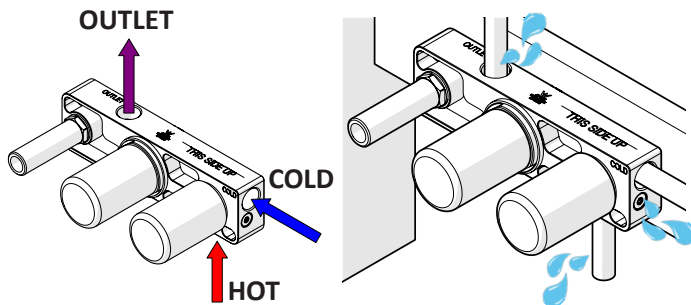

**4**

Check centre distance of the breach assembly is 75mm. Create a 25mm hole and two 45mm hole on the sheet and tiles, as shown

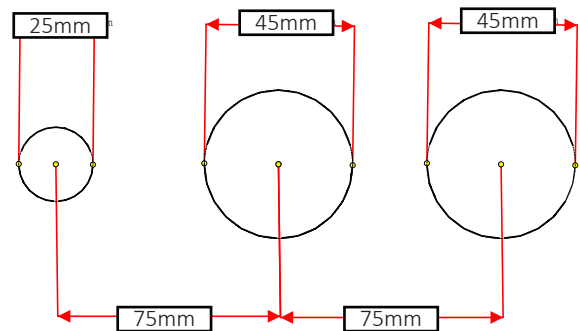

**5**

Cement sheet, waterproof and tiles as shown.

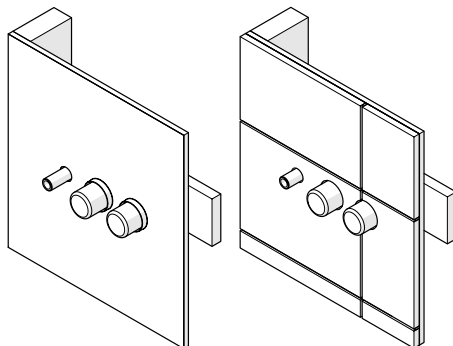

**6**

Remove Protective covers as shown.

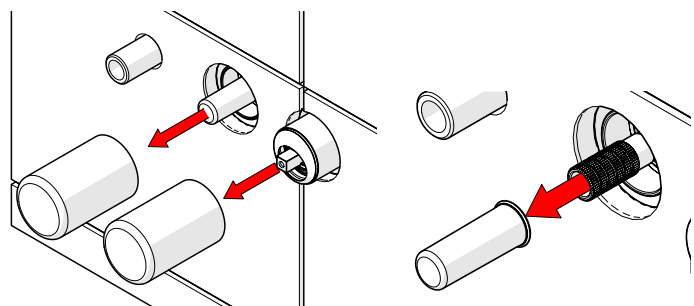

**7**

Ensure no more than 20mm of G1/2" tail is protruding from the tile face. If greater trim to size.

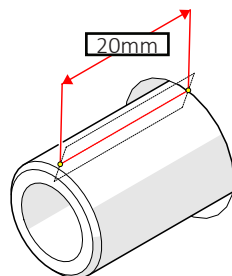

**8**

Ensure between 18mm-21mm of the Diverter spindle is protruding from the tile face. If greater trim to size using hack saw.

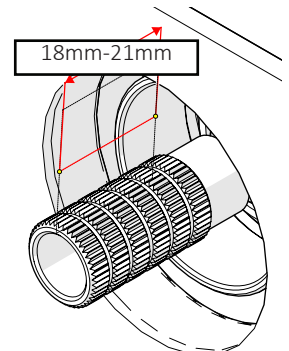

### Care Details

We recommend the use of soapy water or approved cleaners. This product should not be cleaned with abrasive materials. Damage caused by any improper treatment is not covered by the product warranty. Refer to Warranty Conditions

Installation should comply with Australian standard AS3500.1 or relevant local authority requirements. Showers may not be suitable for use within:

- Gravity-fed water systems
- Some instantaneous hot water systems

Any flow controller incorporated in the outlet to be tightened to prevent removal by hand. As Per AS3718

**Plumbers, please ensure a copy of the installation instruction is left with the end user for future reference.**



- 9** Push Dress Plate until flush with tile face.

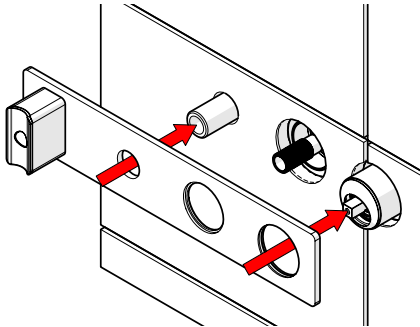

- 10** Tighten Diverter Locknut securing the dress plate.

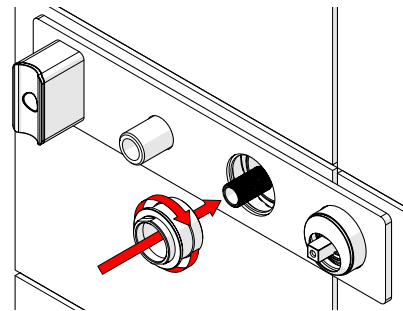

Apply Teflon tape. Tighten Hand Shower Adaptor to G1/2" thread.

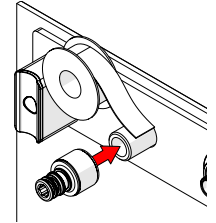

- 11** Push on Hand Shower Wall Adaptor and secure with supplied grub screw.

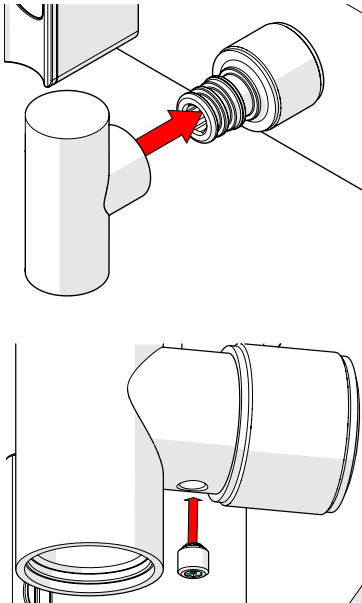

- 12** Push on Diverter Handle ensuring supplied bearing is in position.

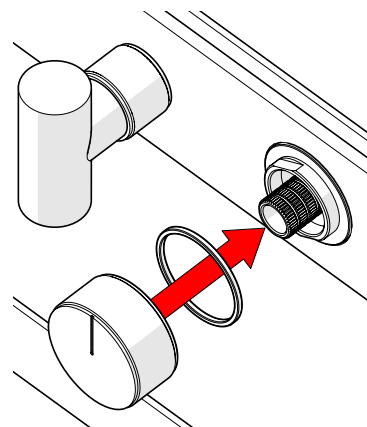

Secure with supplied Grub Screw. Push on Rubber cap to finish.

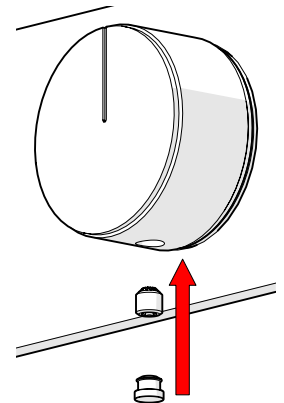

- 13** Push Mixer Handle onto cartridge stem.

Secure grub screw and install Pin as shown.

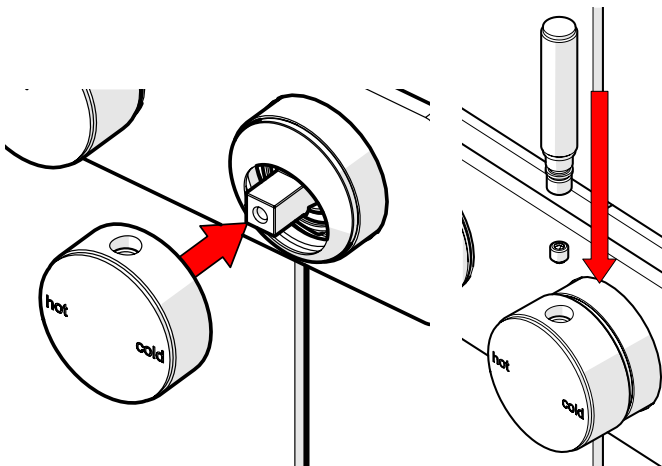

- 14** Ensure Flow controllers are installed as shown.

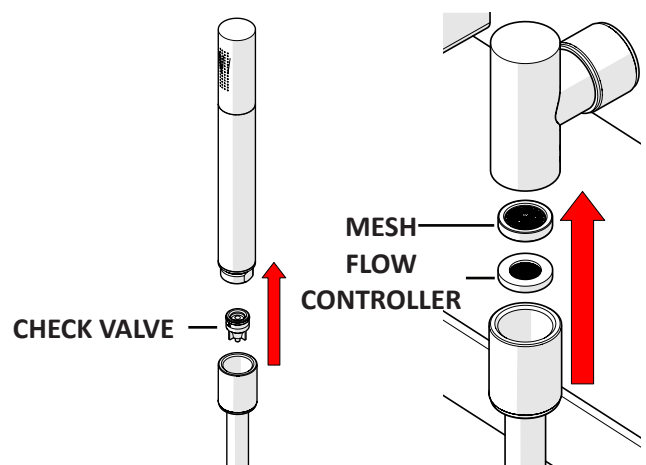

### Care Details

We recommend the use of soapy water or approved cleaners. This product should not be cleaned with abrasive materials. Damage caused by any improper treatment is not covered by the product warranty. Refer to Warranty Conditions

Installation should comply with Australian standard AS3500.1 or relevant local authority requirements. Showers may not be suitable for use within:

- Gravity-fed water systems
- Some instantaneous hot water systems

Any flow controller incorporated in the outlet to be tightened to prevent removal by hand. As Per AS3718

**Plumbers, please ensure a copy of the installation instruction is left with the end user for future reference.**

