

# KADO

## Kado Arc Towel Ladder American Solid Oak

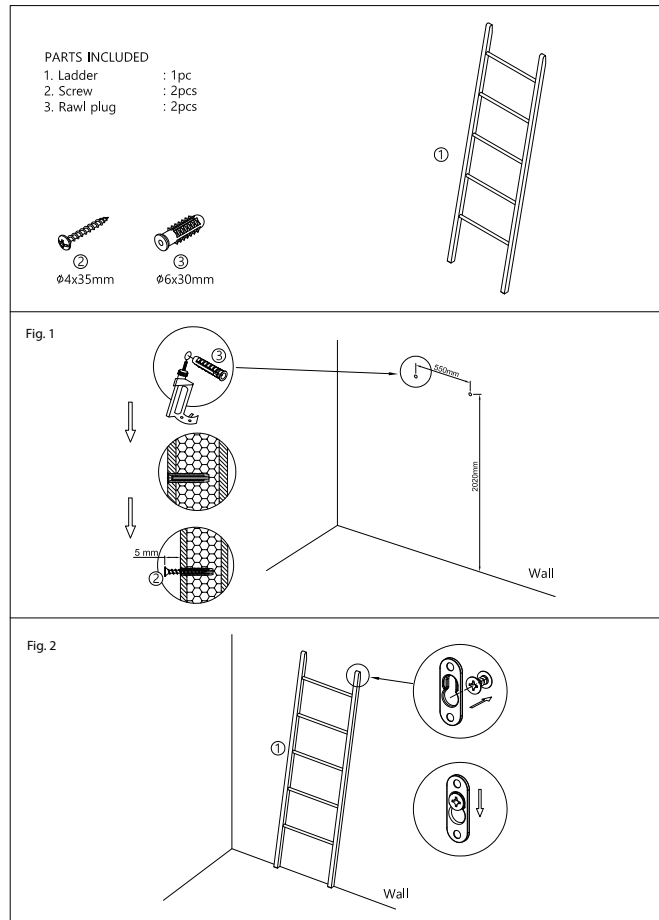
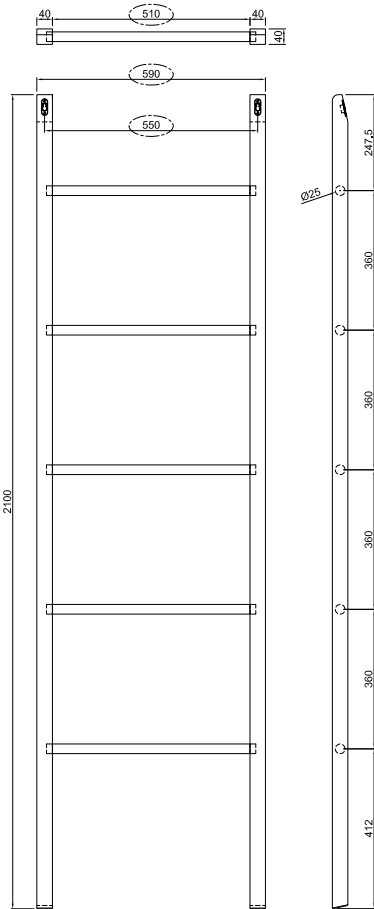

### IMPORTANT NOTE:

This product is intended for domestic use as a towel rail only. Children must be supervised to ensure they do not climb or hang from the rail as it may cause serious injury.

### INSTALLATION INSTRUCTIONS:

1. Place towel ladder against wall in the desired position with both fixing points in the side rails facing up.
2. Recommended the towel ladder is pulled out, away from the wall at the bottom, so it can be free standing.
3. Mark out 2 x fixing points on wall for 2 x screws, to restrain towel ladder preventing movement (Fig.1).
4. Pre-drill both screw holes and fit both screws (Fig. 2).

**Note:** Wall materials vary. The fixing kit supplied is suited for timber framed walls, please ensure the product is fixed to a stud/noggin behind the wall. Where a stud/noggin is not available, please use suitable hollow wall fixings.

Dimensions are nominal measurements only.

**Disclaimer:** Products in this specification manual must by regulation be installed by licensed and registered trade people. The manufacturer/distributor reserves the right to vary specifications or delete models from their range without prior notification. Dimensions are nominal measurements only. Dimensions and set-outs listed are correct at time of publication however the manufacturer/distributor takes no responsibility for printing errors.

Published 15/06/2020