

THERMANN™

COMMERCIAL

PERFORMANCE PACK 1150 MAINS PRESSURE, CONTINUOUS FLOW BOOST



Tank & Heat Exchanger*



Parts and Labour*

**Delivers in excess of 1150L
of hot water in the first hour**

**Combines a 315L commercial storage
tank, with a 28L/min commercial
continuous flow in a convenient package**

PERFORMANCE PACK 1150



Performance Pack 1150, the latest addition to the Thermann Commercial range. This commercial gas water heater delivers up to 1155L of hot water in the first hour, more than enough for most light commercial applications.

Easy to assemble on site, it combines a 315L storage tank, prefitted with a pump and controller. It's designed for easy fitment of either a Thermann 28L/min indoor or outdoor continuous flow unit. This makes for easy handling and simple installation on site.

The system provides high efficiency, with full mains pressure hot water delivery.



Tank & Heat Exchanger*



Parts and Labour*



SPECIFICATIONS		
Model Number - Outdoor Model	9509800	9509801
Model Number - Indoor Model	9509802	9509803
Gas Type	Natural Gas	LPG
First Hour Capacity (L)	1155	
Tank Storage Capacity (L)	321	
Continuous Flow Recovery (L/hr @ 50°C rise)	840	
Weight (kg) - Tank	113	
Weight (kg) - Continuous Flow	26	
Relief Valve Pressure Rating (kPa) - Tank	1000	
Tank Temperature Setting (°C) - Min	65	
Tank Temperature Setting (°C) - Max	75	
Max Water Supply Pressure (kPa)	800	
Cold Water Connection (mm)	32mm 1¼"	
Hot Water Connection (mm)	32mm 1¼"	
Gas Connection (mm)	20mm ¾"	
Maximum Rated Current (Amp)	1.5	

28L/MIN CONTINUOUS FLOW SPECIFICATIONS		
Continuous Flow Rate (L/min @ 25°C rise)	28	
Thermal Efficiency# (%)	84.5	
Water Pressure (kPa)	200 - 800	
Minimum Flow Rate (L/min)	2.5	
Dimensions H x W x D (mm)	600 x 350 x 240 (Outdoor)	
Dimensions H x W x D (mm)	600 x 350 x 280 (Indoor)	
Cold Water Inlet (mm)	20mm ¾"	
Hot Water Outlet (mm)	20mm ¾"	
Gas Inlet (mm)	20mm ¾"	
Power Supply	230 - 240 VAC (50Hz)	
Power Consumption (W)	Operation - 75 Freeze Prevention - 193	
Gas Consumption (MJ/hr)	220 (Outdoor)	205 (Indoor)
Gas Pressure (kPa)	NG - 1.13 - 3.00 LPG - 2.75 - 3.50	

DIMENSIONS (MM)	
A - Total Height	1760
B - Total Diameter	617
C - Relief Valve Height	1537
D - Outlet Height	1465
E - Optional Cold Connection Height (suitable for Ring main connection)	700
F - Default Cold Connection	285
G - Depth over Continuous Flow unit	900

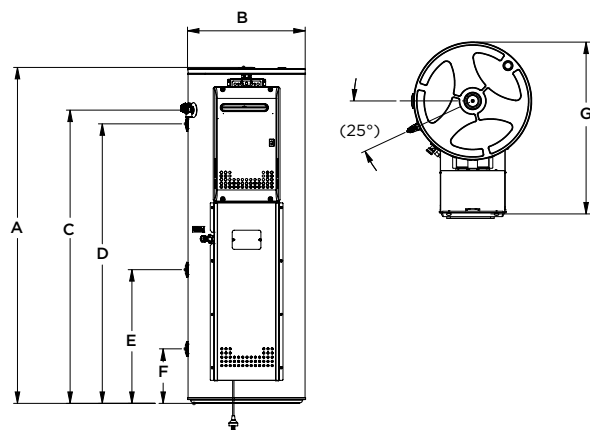

*Warranty terms and conditions are in the Owner's Manual. A 5 year warranty on heat exchanger & storage tank and 2 years parts and labour warranty applies for commercial use. A 12 year warranty on heat exchanger, 10 year warranty on the storage tank and 2 years parts and labour warranty applies for residential use (single family dwelling).

#Thermal efficiency of the continuous flow unit as tested with 15°C inlet water temperature and 60°C hot water outlet temperature at maximum burn capacity.

The information supplied was correct at time of printing. Specification and materials may change without notice. 0320

Brochure Reorder Code: 2131826 THERMANN PP1150 FLYER 2020 (10)

THERMANNTM
COMMERCIAL