



coneKta vitaq valve



TECHNICAL SHEET 11/2018 | IPO2025

SCOPE

ConeKta valves are used into water pipe systems. They are used to shut off individually water supply to washing machines, dishwashers and other different water supply points to proceed to their repairing or replacement..

VITAQ SYSTEM makes them particularly suitable to avoid the effects of lime, increasing the life span of the valve.

These valves are 1/4 turn operated.

SERVICE CONDITIONS

Nominal pressure:	16 bar
Test pressure:	25 bar
Temperature range:	cold and hot water up to 95°C
Fluid:	Water intended to human consumption and domestic hot water



COMPONENTS

Item	Component	Material	Treatment
1	Ring	Stainless steel	
2	Nut	European Brass CW614N	Chrome plated
3	Body	European Brass CW617N	Chrome plated
4	Supporting clip	POM	
5	Seat	NBR	
6	Stem-ball	Antilime polymer	
7	Handle	ABS	
8	Screw	Stainless steel	
9	O-ring	NBR	
10	Supporting clip	POM	

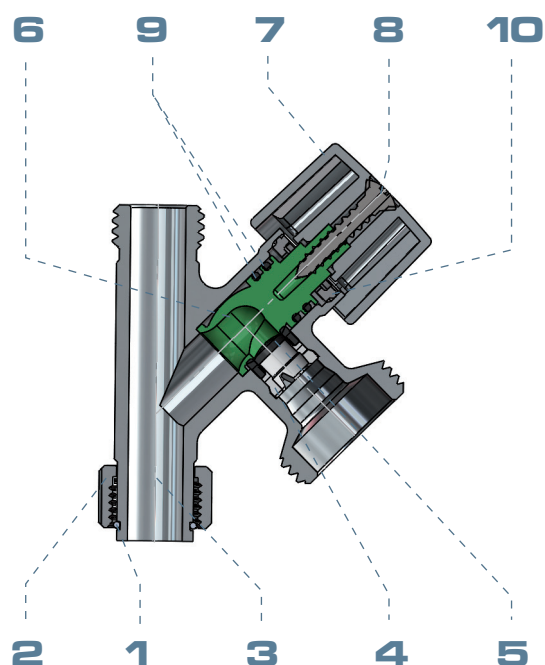

MAIN CONSTRUCTIVE FEATURES

VITAQ SYSTEM

VITAQ stem-ball are manufactured in one piece made of special anti-lime polymer, which increases its resistance, allows a softer operation of the valve and blocks the lime adhesion on it.

This VITAQ stem-ball has the same design than ARCO traditional brass-made shut off. It has the same characteristics of leak tightness and loss of pressure than this traditional one, but with the special advantage to prevent negative effects of lime.

In those installations where water's hardness and temperature make easier the lime deposition, as well as a low maneuver frequency; leads to the valve's hard operation after long periods of time.

This anti-lime ball is the solution to avoid a hard operation and keep a constant flow rate and avoid the loss of flow caused by the lime adhered



MAIN CONSTRUCTIVE FEATURES

ONE PIECE BODY

Main body manufactured in European brass alloy CW617N, by mean of a hot stamping process.

Monoblock body without any possibility of leak, for being made in one piece, against the competitors from other models made in two pieces.

ORIENTABLE & ACCESSIBLE

The design of coneKta valve allows complete orientation (360°) towards the supply point, the inclined outlet facilitates connection to the equipment and easy maneuver.



LEAKTIGHTNESS

Internal

The supporting clip made of POM is placed in the valve to push the NBR seat against the stem-ball.

This system cannot be dismantled, avoiding improper manipulations.

External

A double NBR seal placed on the stem assure external leak tightness. This double joint system guarantees safety against external leakage, use, ageing...

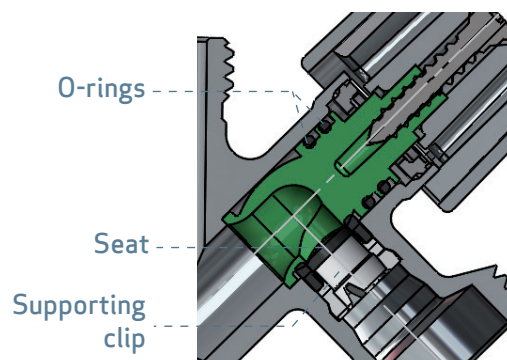

DIMENSIONS

Size	A	B	C	D
3/8Mx3/8SNx3/4M	60	G3/8	G3/8	G3/4
1/2Mx1/2SNx3/4M	75	G1/2	G1/2	G3/4

G Thread ISO 228

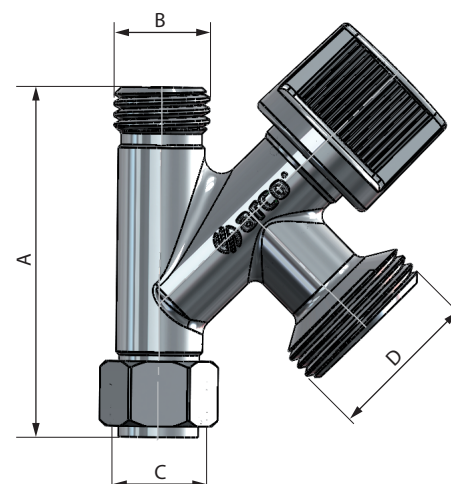

HYDRAULIC FEATURES

Hydraulic characteristics obtained according to EN 1267.

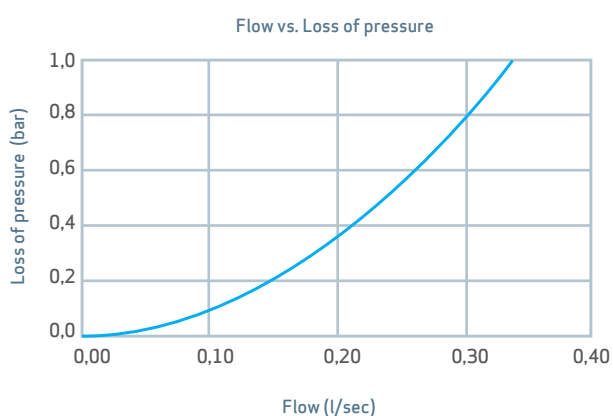

INSTALATION AND ASSEMBLY

The installation of valves must be done with the right tool.

The tool should be adjusted to the flat sides of the body of the valve, avoiding the deformation of the zone by high pressure of the tool.

Components of the valve must not be altered. The substitution or dismantelling of the handle can provoke external leaks.

All quarter turn handle valves should work totally open.

