

WALL MOUNTED AIR CONDITIONER

Remote Controller Manual

KSI Series

KSI06 | KSI09 | KSI12
KSI18 | KSI24 | KSI28



kaden°
your perfect climate

Table of contents

1. Remote controller specifications	4
2. Function buttons	4
3. Handling the remote controller	5
4. Remote LCD screen indicators	6
5. How to use the basic functions	7
6. How to use the advanced functions	12

Important note

Read this manual carefully before installing or operating your new air conditioning unit. Make sure to save this manual for future reference.

1. Remote controller specifications

	RG66A1/BGEF
Rated voltage	3.0V (dry batteries R03/LR03×2)
Signal receiving range	8m
Environment	-5°C~60°C

2. Function buttons

Before you begin using your new air conditioner, make sure to familiarise yourself with its remote control. The following is a brief introduction to the remote control itself. For instructions on how to operate your air conditioner, refer to the How to use the basic/advance functions section of this manual.

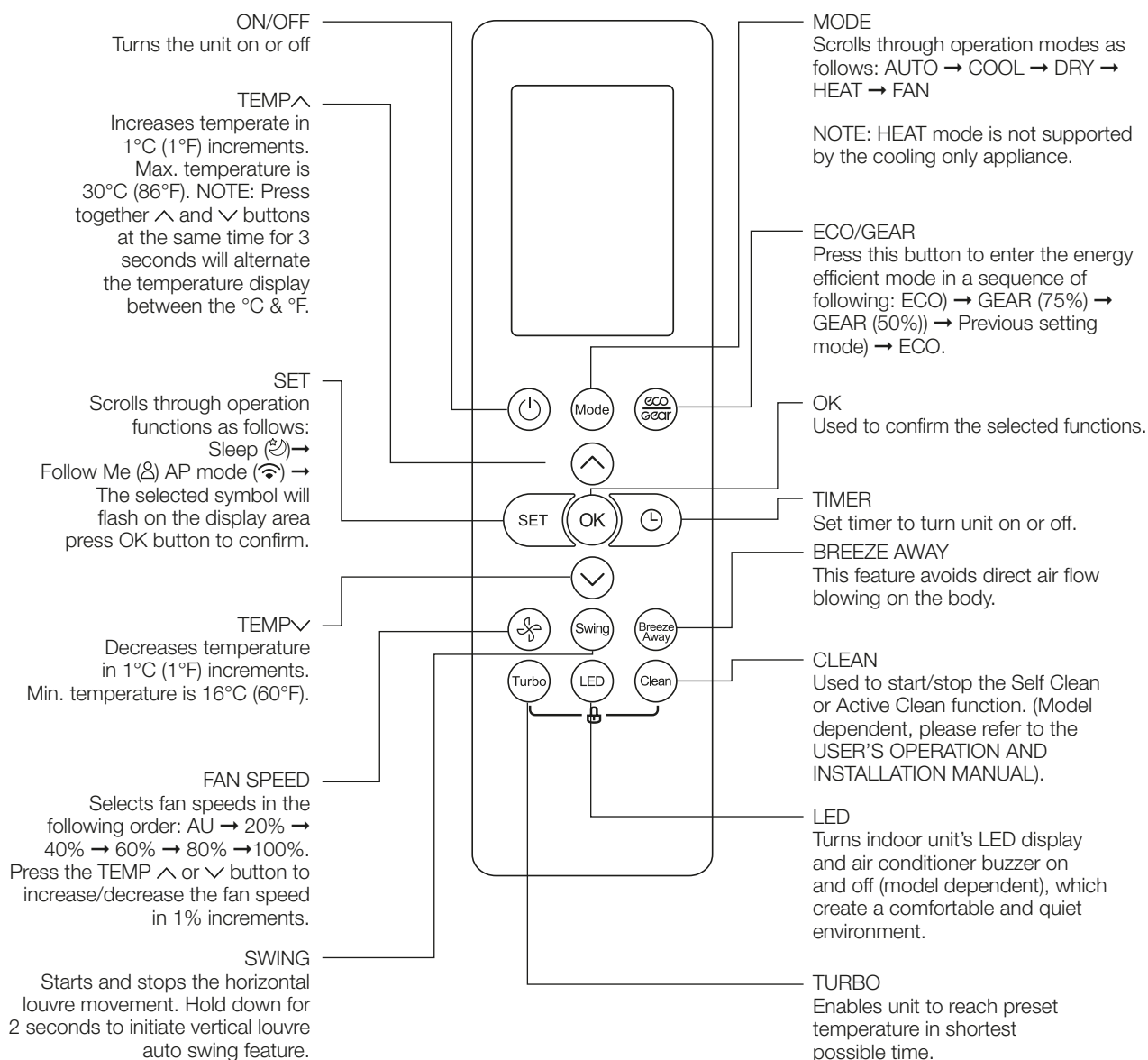

3. Handling the remote controller

Not sure what a function does?

Refer to the How to use basic functions and How to use advanced functions sections of this manual for a detailed description of how to use your air conditioner.

Inserting and replacing batteries

Your air conditioning unit comes with two AAA batteries. Put the batteries in the remote control before use:

1. Remove the back cover from the remote control, exposing the battery compartment.
2. Insert the batteries, paying attention to match up the (+) and (-) ends of the batteries with the symbols inside the battery compartment.
3. Install the back cover.

Tips for using remote control

- The remote control must be used within 8 meters of the unit.
- The unit will beep when remote signal is received.
- Curtains, other materials and direct sunlight can interfere with the infrared signal receiver.
- Remove batteries if the remote control will not be used more than 2 months.

Installing remote control holder

The remote controller can be attached to a wall or stand by using a remote controller holder.

1. Before installing the remote controller, check that the air conditioner receives the signals properly.
2. Install the holder with two screws.
3. Put the remote controller in the holder.

! Battery notes

For optimum product performance:

- **Do not** mix old and new batteries, or batteries of different types.
- **Do not** leave batteries in the remote control if you don't plan on using the device for more than 2 months.

! Battery disposal

Do not dispose of batteries as unsorted municipal waste. Refer to local laws for proper disposal of batteries.

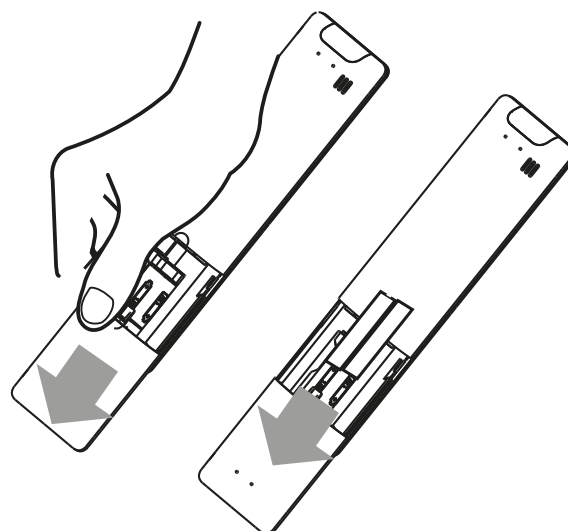

4. Remote LCD screen indicators

Information is displayed when the remote controller is powered up.

NOTE: All indicators shown in the figure are for the purpose of clear presentation. But during the actual operation, only the relative function signs are shown on the display window.

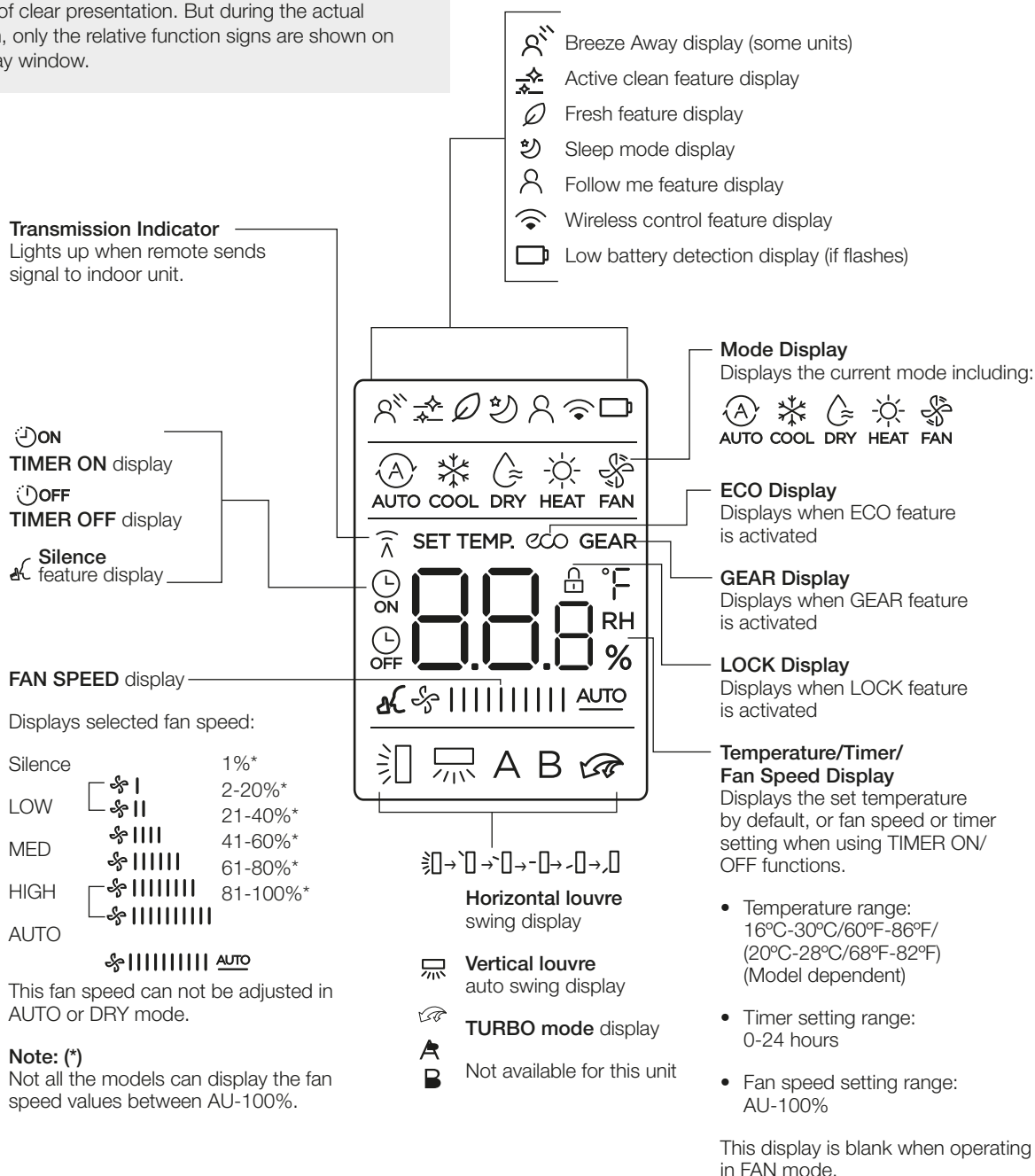

Note:

All indicators shown in the figure are for the purpose of clear presentation. But during actual operation, only the relative function signs are shown on the display window.

5. How to use the basic functions

AUTO operation

In **AUTO** mode, the unit will automatically select the **COOL**, **FAN**, **HEAT** or **DRY** mode based on the set temperature.

1. Press the **MODE** button to select **AUTO** mode.
2. Set your desired temperature using the **Temp +** or **Temp -** button.
3. Press the **ON/OFF** button to start the unit.

NOTE: **FAN SPEED** can't be set in Auto mode.

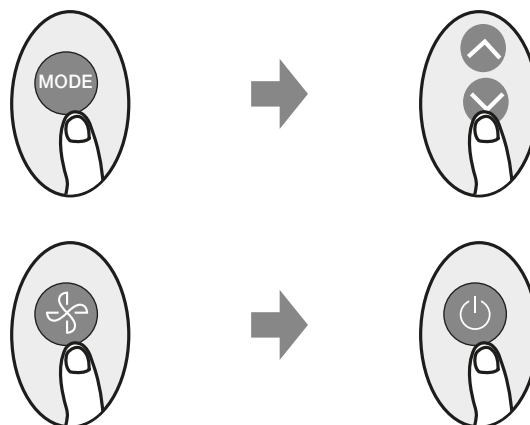

COOL or HEAT operation

1. Press the **MODE** button to select **COOL** mode.
2. Set your desired temperature using the **Temp +** or **Temp -** button.
3. Press the **FAN** button to select the fan speed.
4. Press the **ON/OFF** button to start the unit.

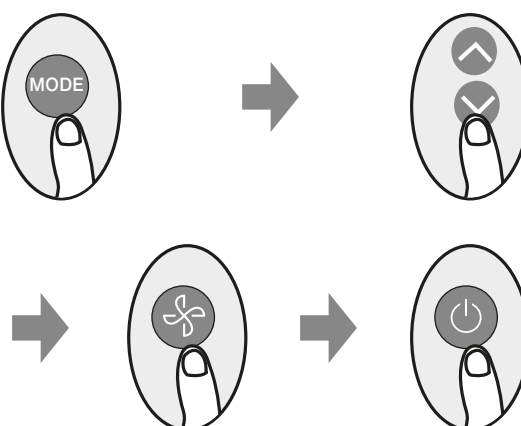

Setting temperature

The operating temperature range for units is 17°C – 30°C. You can increase or decrease the set temperature in 1°C increments.

DRY operation (dehumidifying)

1. Press the **MODE** button to select **DRY** mode.
2. Set your desired temperature using the **Temp +** or **Temp -** button.
3. Press the **ON/OFF** button to start the unit.

NOTE: **FAN SPEED** can't be changed in **DRY** mode.

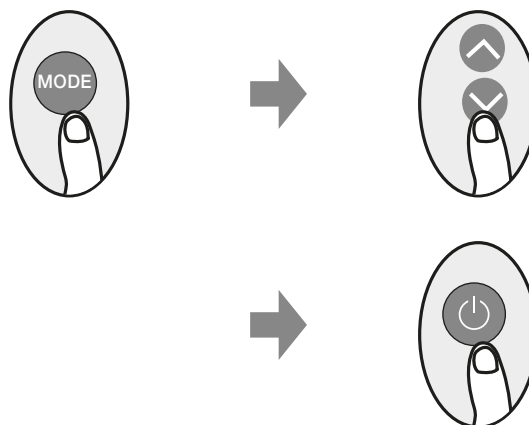

FAN operation

1. Press the **MODE** button to select **FAN** mode.
2. Press the **FAN** button to select the fan speed.
3. Press the **ON/OFF** button to start the unit.

NOTE: You can't set temperature in **FAN** mode.
As a result, your remote control's LCD screen will not display temperature.

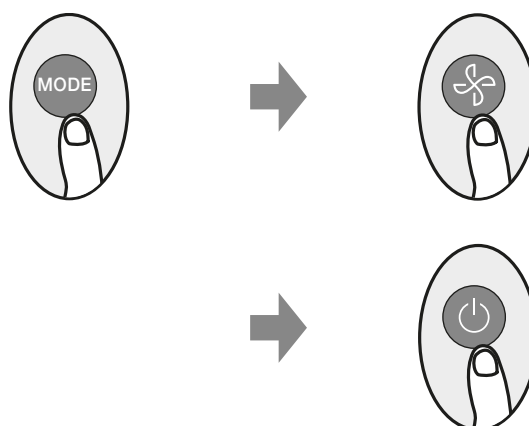

Setting the TIMER function

Your air conditioning unit has two timer-related functions:

- **TIMER ON** – sets the amount of time after which the unit will automatically turn on.
- **TIMER OFF** – sets the amount of time after which the unit will automatically turn off.

TIMER ON function

The **TIMER ON** function allows you to set a period of time after which the unit will automatically turn on, such as when you come home from work.

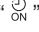
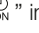

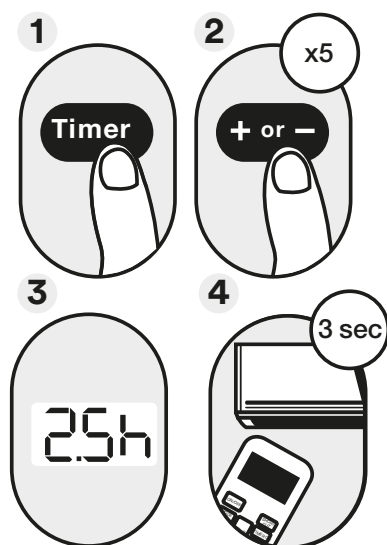
1. Press the **Timer** button, the Timer on indicator “” displays and flashes. By default, the last time period that you set and an “h” (indicating hours) will appear on the display.
- Note:** This number indicates the amount of time after the current time that you want the unit to turn on. For example, if you set **TIMER ON** for 2.5 hours, “2.5h” will appear on the screen, and the unit will turn on after 2.5 hours.
3. Press the **Temp +** or **Temp –** button repeatedly to set the time when you want the unit to turn on.
4. Wait 3 seconds, then the **TIMER ON** function will be activated. The digital display on your remote control will then return to the temperature display. The “” indicator remains on and this function is activated.



Example: Setting unit to turn on after 2.5 hours

TIMER OFF function

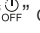
The **TIMER off** function allows you to set a period of time after which the unit will automatically turn off, such as when you wake up.

1. Press the **Timer** button, the Timer off indicator “” displays and flashes. By default, the last time period that you set and an “h” (indicating hours) will appear on the display.
- Note:** This number indicates the amount of time after the current time that you want the unit to turn off. For example, if you set **TIMER OFF** for 5 hours, “5.0h” will appear on the screen, and the unit will turn off after 5 hours.
3. Press the **Temp +** or **Temp –** button repeatedly to set the time when you want the unit to turn off.
4. Wait 3 seconds, then the **TIMER OFF** function will be activated. The digital display on your remote control will then return to the temperature display. The “” indicator remains on and this function is activated.

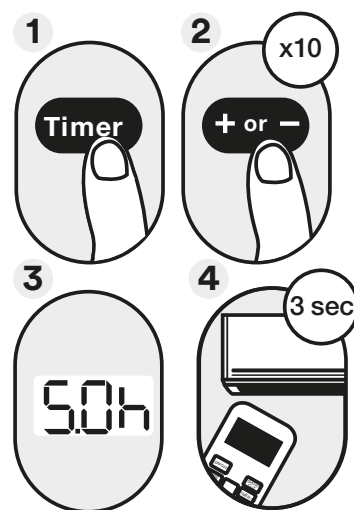

Example: Setting unit to turn on after 5 hours

NOTE: When setting the **TIMER ON** or **TIMER OFF** functions, up to 10 hours, the time will increase in 30 minute increments with each press. After 10 hours and up to 24, it will increase in 1 hour increments. The timer will revert to zero after 24 hours. You can turn off either function by setting its timer to “0.0h”.

Setting both TIMER ON and TIMER OFF at the same time

Keep in mind that the time periods you set for both functions refer to hours after the current time. For example, say that the current time is 1:00 PM, and you want the unit to turn on automatically at 7:00 PM. You want it to operate for 2 hours, then automatically turn off at 9:00 PM.

Do the following:

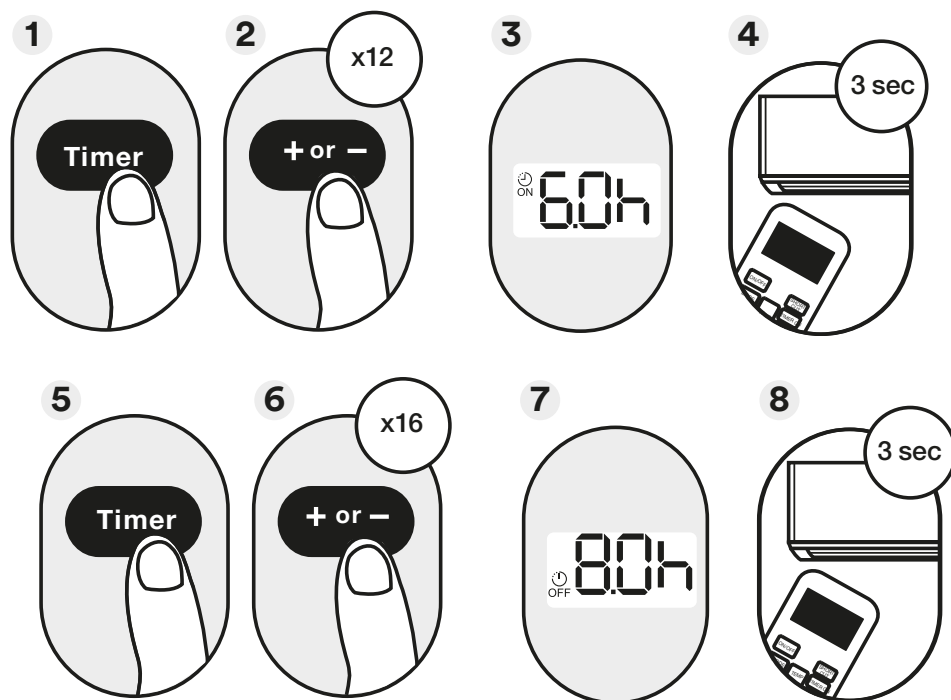

Example: Setting the unit to turn on after 6 hours, operate for 2 hours, then turn off (see figure below).

Your remote display:



Timer is set to turn ON
6 hours from current time



Timer is set to turn OFF
8 hours from current time

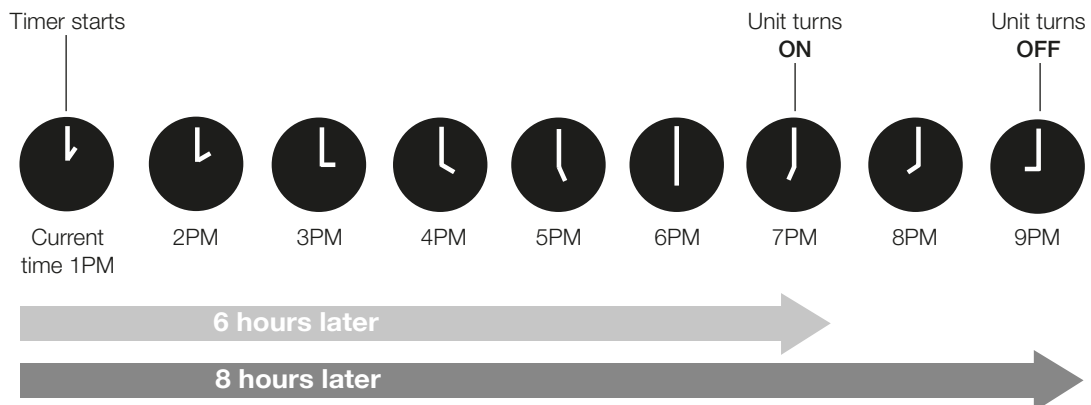

6. How to use the advanced functions

ECO function

ECO/GEAR function (some units)



Press X-ECO button to enter the energy efficient mode in a sequence of following:

ECO → GEAR (75%) → GEAR (50%) → Previous setting mode → ECO...

Note: This function is only available under COOL mode.

NOTE: This function is only available under **COOL** mode.

ECO operation

When the **ECO** feature is activated, the air conditioner will operate automatically at 24°C.

The fan speed is Auto.

NOTE: Pressing the ON/OFF button, modifying the mode or adjusting the set temperature to less than 24°C will stop **ECO** operation.

Under **ECO** operation, the set temperature should be 24°C or higher. It may result in insufficient cooling if you feel uncomfortable, just adjust the temperature to stop it.

NOTE: The **SLEEP** function is not available in **FAN** or **DRY** mode.

SLEEP function

The **SLEEP** function is used to decrease energy use while you sleep (and don't need the same temperature settings to stay comfortable). This function can only be activated via remote control. For detail, see "sleep operation" in OWNER'S MANUAL.

TURBO function

The **TURBO** function makes the unit work extra hard to reach your present temperature in the shortest amount of time possible.

- When you select **TURBO** feature in **COOL/HEAT** mode, the unit will blow cool/hot air with strongest wind setting to jump-start the cooling/heating process.

ACTIVE CLEAN function

- The Active clean technology washes away dust, mould, and grease that may cause odours when it adheres to the heat exchanger by automatically freezing and then rapidly thawing the frost. A "pi-pi" sound will be heard. The **ACTIVE CLEAN** operation is used to produce more condensed water to improve the cleaning effect, and the cold air will blow out. After cleaning, the internal wind wheel then keeps operating with hot air to blow-dry the evaporator, thus preventing the growth of mould and keeping the inside clean.
- When this function is turned on, the indoor unit display window appears "CL", after 20 to 45 minutes, the unit will turn off automatically and cancel **ACTIVE CLEAN** function.

NOTE: You can only activate this function in **COOL** or **DRY** mode.

Breeze away function

This feature avoids direct air flow blowing on the body.

NOTE: This feature is available under cool, **FAN** and **DRY** mode only.

AP function

Choose **AP** mode to do wireless network configuration. For some units, it doesn't work by pressing the SET button. To enter the **AP** mode, continuously press the LED button seven times in 10 seconds.

FOLLOW ME function

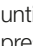
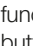
The follow me function enables the remote control to measure the temperature at its current location and send this signal to the air conditioner every 3 minute interval. When using **AUTO**, **COOL**, or **HEAT** modes, measuring ambient temperature from the remote control (instead of from the indoor unit itself) will enable the air conditioner to optimise the temperature around you and ensure maximum comfort. Press SET button until the Follow ME “” sign come up on the display then press OK to confirm the mode. To turn off the FOLLOW ME function follow the same process above or press the OFF “” button.

Breeze away / sleep / follow me function

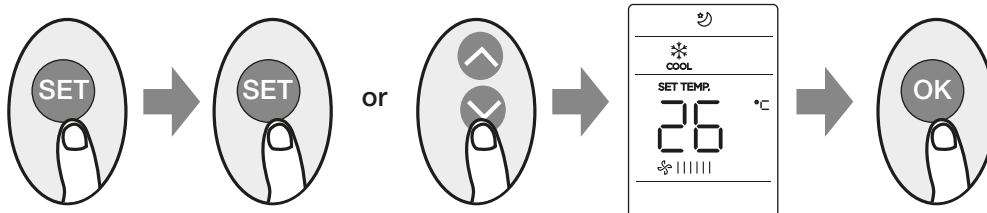

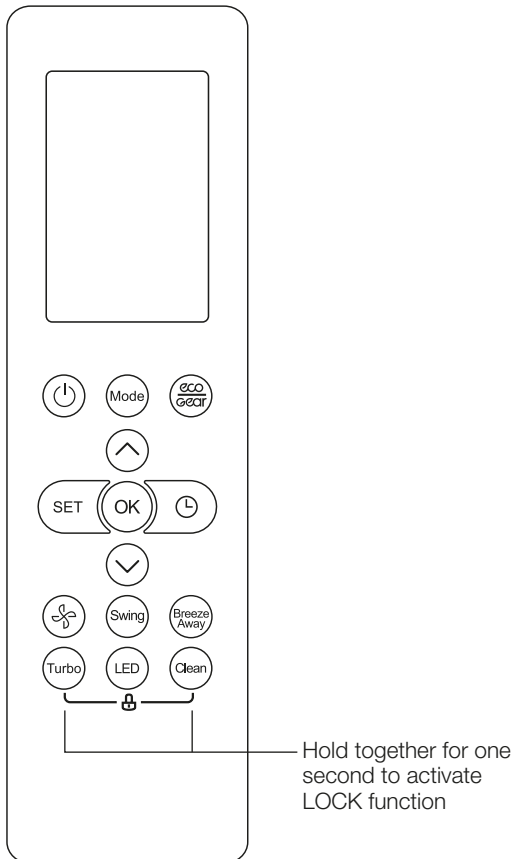

LOCK function

Press Turbo button and self clean button simultaneously for one second to lock or unlock the keyboard.

FOLLOW ME function

The follow me function enables the remote control to measure the temperature at its current location and send this signal to the air conditioner every 3 minute interval. When using **AUTO**, **COOL**, or **HEAT** modes, measuring ambient temperature from the remote control (instead of from the indoor unit itself) will enable the air conditioner to optimise the temperature around you and ensure maximum comfort. Press SET button until the Follow ME "⋈" sign come up on the display then press OK to confirm the mode. To turn off the FOLLOW ME function follow the same process above or press the OFF "⏻" button.

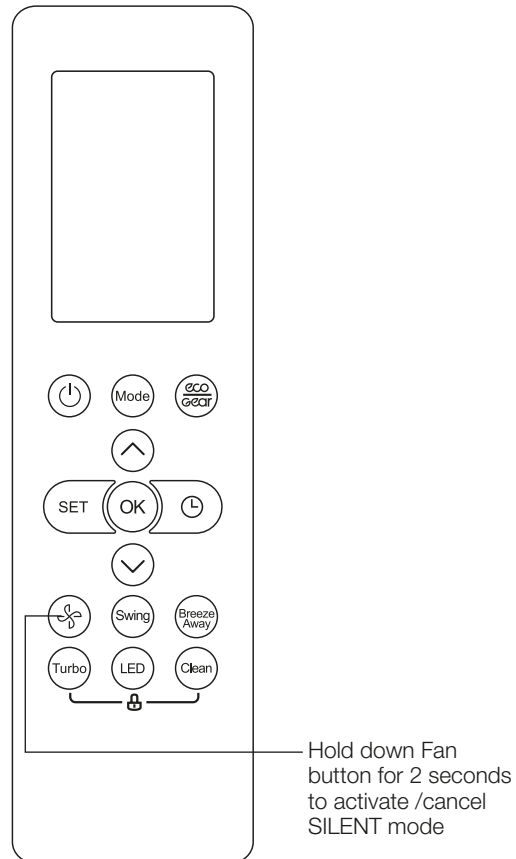

SILENT function

Hold down Fan button for 2 seconds to activate /cancel **SILENT** mode. Due to low frequency operation of compressor, it may result in insufficient cooling and heating capacity.

SWING function

Swing Button

Used to stop or start vertical louvre movement and set the desired left/right air flow direction. The vertical louvre changes 6 degree in angle for each press. If keep pushing more than 2 seconds, the vertical louvre auto swing feature is activated.

Swing Button

Used to stop or start horizontal louvre movement or set the desired up/down air flow direction. The louvre changes 6 degree in angle for each press. If keep pushing more than 2 seconds, the louvre will swing up and down automatically.

Swing function:

Press swing function

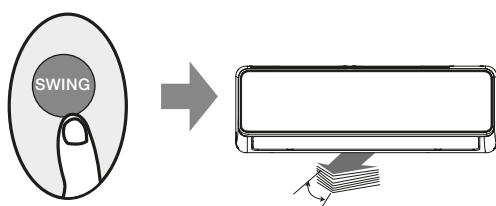

The horizontal louvre will swing up and down automatically when pressing SWING button. Press again to make it stop.

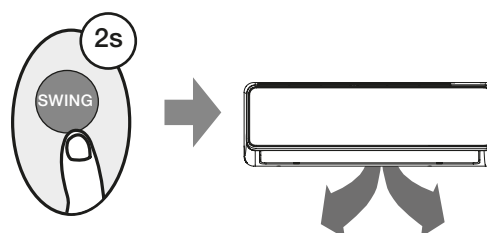

Keep pressing this button more than 2 seconds, the vertical louvre SWING function is activated (model dependent).

Wi-Fi operation setup

For instructions on setting up Wi-Fi connectivity for your Kaden air conditioner, please scan the QR code below, or visit kadenair.com.au



Wi-Fi setup video

For video instructions on setting up Wi-Fi connectivity for your Kaden air conditioner, please scan the QR code below, or visit kadenair.com.au





kadenair.com.au