

AXA

CENTO SEMI RECESSED BASIN

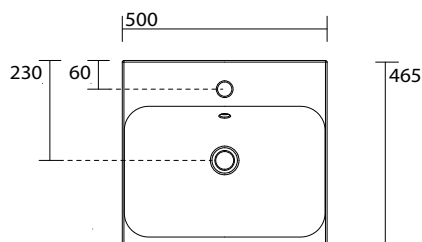

TOP VIEW

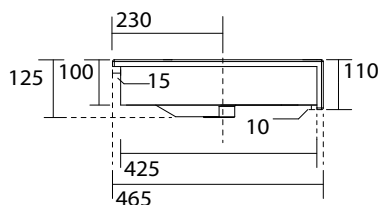

SIDE VIEW

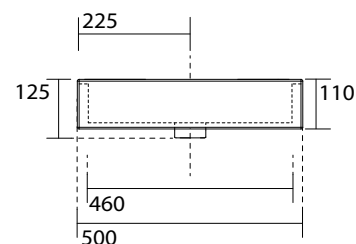

FRONT VIEW

Dimensions are nominal measurements only.

SPECIFICATIONS

| | |
|-------------------------------|-------------------------------------|
| Recommended use | Domestic, hotel and commercial |
| Material | Fine Fire Clay |
| Colour | White |
| Capacity | 3 Litres |
| Weight | 13kg |
| Taphole availability | 1 Taphole |
| Integrated overflow | Yes |
| Overflow dress ring | Yes (Chrome only) |
| Plug and waste | 32x40 Overflow Waste (Not supplied) |
| Additional Information | Cut out templates supplied |



To see the complete AXA range go to www.reece.com.au/bathrooms

CLEANING RECOMMENDATIONS

We recommend the use of soapy water or approved cleaners.

This product should not be cleaned with abrasive materials.

Damage caused by any improper treatment is not covered by the product warranty. Refer to Warranty Conditions.

INSTALLATION INSTRUCTIONS

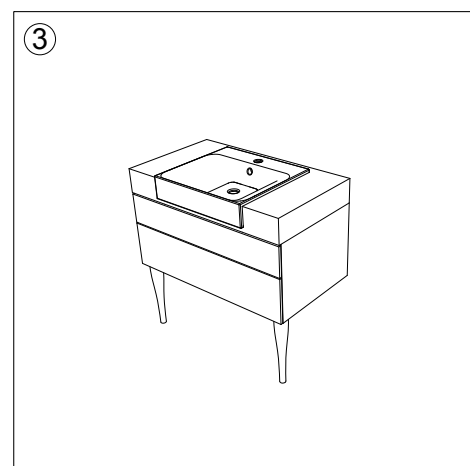
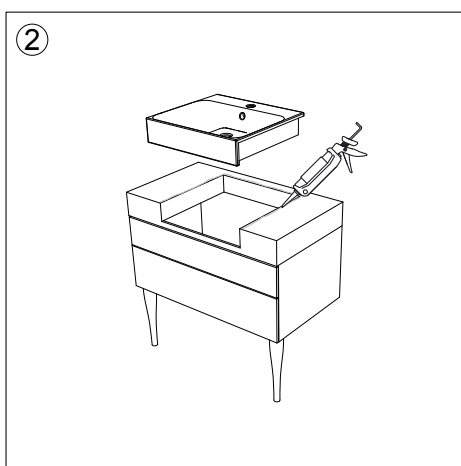
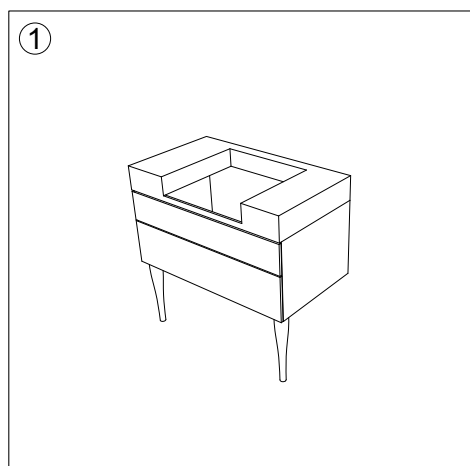

Disclaimer: Products in this specification manual must by regulation be installed by licensed and registered trade people. The manufacturer/distributor reserves the right to vary specifications or delete models from their range without prior notification. Dimensions are nominal measurements only. Dimensions and set-outs listed are correct at time of publication however the manufacturer/distributor takes no responsibility for printing errors.

Tech Page Version 1