

Posh Solus MK3 Gooseneck Sink Mixer (4 Star)

IMPORTANT NOTE:

Mixer must be installed to the requirements of AS/NZS 3500 by a qualified plumber. Your mixer comes to you already factory assembled and tested. We do not recommend the dismantling of any internal part of the mixer. The mixers are factory tested and sealed so as to give the best performance.

Installer is responsible for ensuring water connections to the mixer body are watertight.

INSTALLATION REQUIREMENTS:

1. Flush out new pipe work prior to connecting the new mixer.
2. Place the base washer from the fixing kit (13) over the tap hole.
3. Pass the pre-fitted hot and cold hoses (12) through the tap hole and sit the base of the sink mixer on top of the tap hole. Ensure that the base washer sits firmly inside the sink mixer dress ring.
4. Underneath the mounting surface, secure the horseshoe plate and retaining nut from the fixing kit (13) to the sink mixer's shank, making sure the rubber side of the horseshoe plate is contacting the under surface. Undermount sink stabiliser must be used if installing the mixer directly onto a stainless-steel sink hole.
5. Fit the spout (10) spigot into the top opening in the mixer body (5). When using the lock screw (6) to secure the spout to the body, ensure the screw is installed into the non-fiction ring on the end of the spigot as shown in figure (B) in the exploded diagram.
6. Cold water supply must be fitted to blue coloured hose and hot water supply must be fitted to red colour hose.
7. Fastening nuts on pre-fitted flexible hoses (12) must be installed to a water supply with compliant 1/2" male BSP threads. It is recommended that both the cold and hot water supply have a means of isolating the supply.
8. Hose fastening nuts must be tightened by hand plus an additional half a turn of tightening using a wrench.

NOTES

- **Do not twist hose braiding to tighten hoses.**
- **Do not use Teflon tape or thread locking compounding on any of the threaded connections.**
- **Do not bend hoses in a manner that will cause them to kink and deform.**
- **Water supply flexible hoses are pre-fitted to the mixer. Do not attempt to remove hoses from mixers.**
- **Mixer must be installed only with pressurised hot water storage and instantaneous water systems only.**

SERVICING - REPLACEMENT OF CARTRIDGE:

1. Isolate hot and cold water supplies from stop valves.
2. Have the tap lever open and drain any excess water from the tap by disconnecting the hot and cold hose nuts from their stop valves.
3. Disassemble the handle (1) from the mixer body by removing the locking grub screw cap and unscrewing the locking grub screw with a 1.5mm Allen key.
4. Unscrew the cartridge dome (2) and use a wrench to unscrew the cartridge locknut (3).
5. Remove and replace the mixer cartridge (4). Reassemble the locknut (3), cartridge dome (2) and handle assembly (1).
6. Reconnect hoses to stop valves and test reassembled mixer for leaks.

CLEANING RECOMMENDATIONS:

We recommend the use of soapy water or approved cleaners.

This product should not be cleaned with abrasive materials.

Damage caused by any improper treatment is not covered by the product warranty - refer to Warranty Conditions.

Please ensure a copy of the installation instructions is left with the end user for future reference

Posh Solus MK3 Gooseneck Sink Mixer (4 Star)

EXPLODED DIAGRAM:

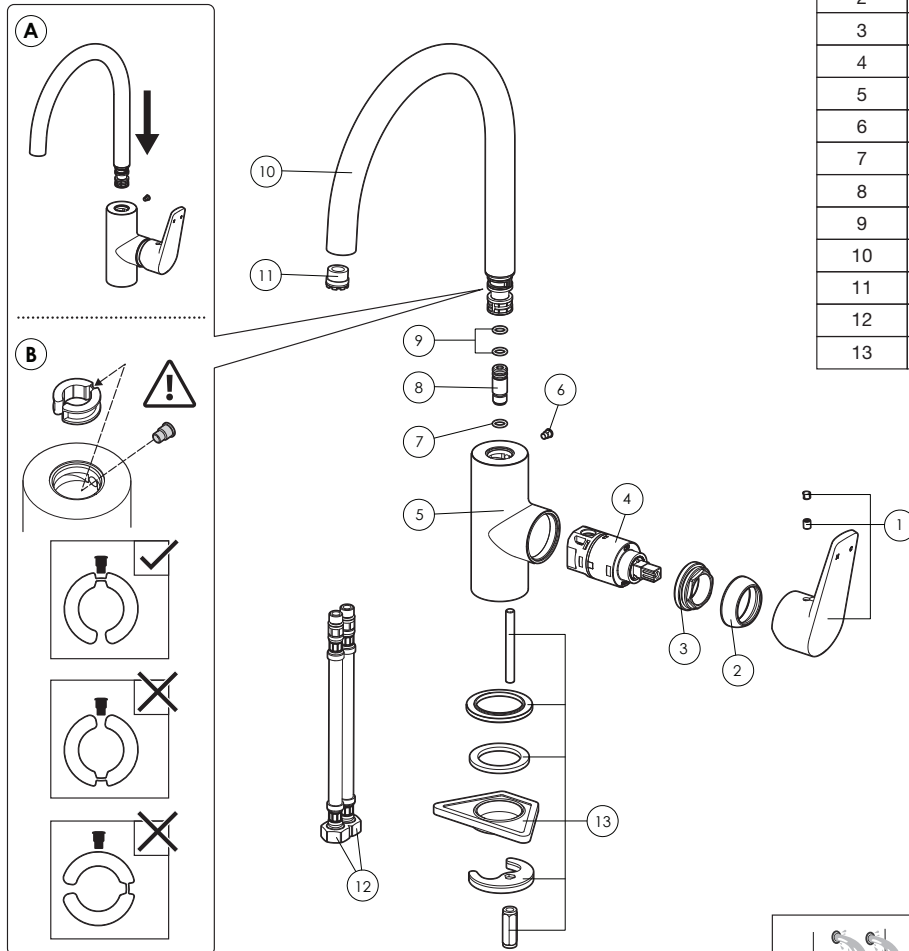

Number	Part	Code
1	Handle complete	2250694
2	Cartridge dome	
3	Cartridge locknut	
4	Cartridge	2251359
5	Mixer body	
6	Screw	
7	O-Ring	
8	Spout link	
9	O-Rings	
10	Spout	
11	Aerator complete	2250693
12	Hoses (hot and cold)	2250684
13	Fixing kit	2250695

NOTE: grub screw must be aligned with specified groove in spout.

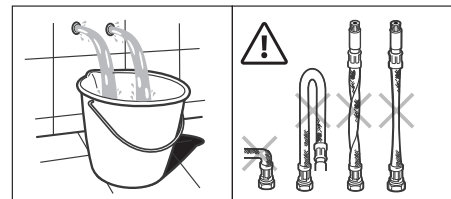

	P	P bar	MIN. 0,5	MAX. 10	5	
	T	°C	-80 MAX.	-65	-45	

A503081407h

Please ensure a copy of the installation instructions is left with the end user for future reference