

# mizu

## Soothe MK2 Gooseneck Sink Mixer Curve (5 Star)

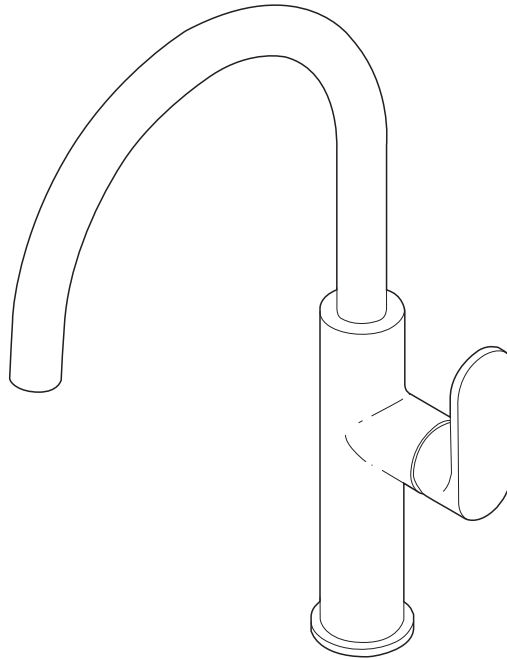

### Installation Instructions



**Mixer must be installed to the requirements of AS/NZS 3500 by a qualified plumber. Your mixer comes to you already factory assembled and tested. We do not recommend the dismantling of any internal part of the mixer. The mixers are factory tested and sealed so as to give the best performance.**

1. Fit with isolating stops on both hot and cold water supply.
2. Attach Flexible Tails to the mixer; connecting Blue Labelled Hose (26) to the Cold 'C' Inlet (32) and Red Labelled Hose (25) to the Hot 'H' Inlet (31). Screw and tighten both hoses (25-26) firmly on to tail extensions (31-32).
3. Place Dress Ring (23) and Rubber Washer from Fixing Kit (24) at base of mixer body.
4. From Fixing Kit, take two threaded bolts and screw into bottom of mixer body. Ensure slotted ends are away from mixer.
5. Position mixer over tap hole and push through Flexible Tails (25 & 26) one at a time.
6. From underneath, guide O-ring/ Washer from Fixing Kit (24) around the flex tails, then align and push metal horseshoe plate onto threaded rods. Screw brass locking nuts onto threaded rods.
7. From above, align mixer into final position. From underneath, fully tighten brass locking nuts using provided Tool (27) or suitable plumbers socket.
8. From underneath, screw flexi tail nuts onto corresponding hot and cold isolation valves until watertight seal is achieved. Refer below for precautions (Note -Isolation valves not included).
9. Turn on water supply and operate mixer. Check for leaks on any connections. Ensure that mixer is operating correctly.

**NOTE: Do not over tighten hose tail into the mixer, do not stretch the flexi hoses.  
Do not twist hose braiding to tighten hoses, do not excessively bend hoses.  
Do not use Teflon tape or thread locking compound on any of the threaded connections.**

# mizu

## Soothe MK2 Gooseneck Sink Mixer Curve (5 Star)

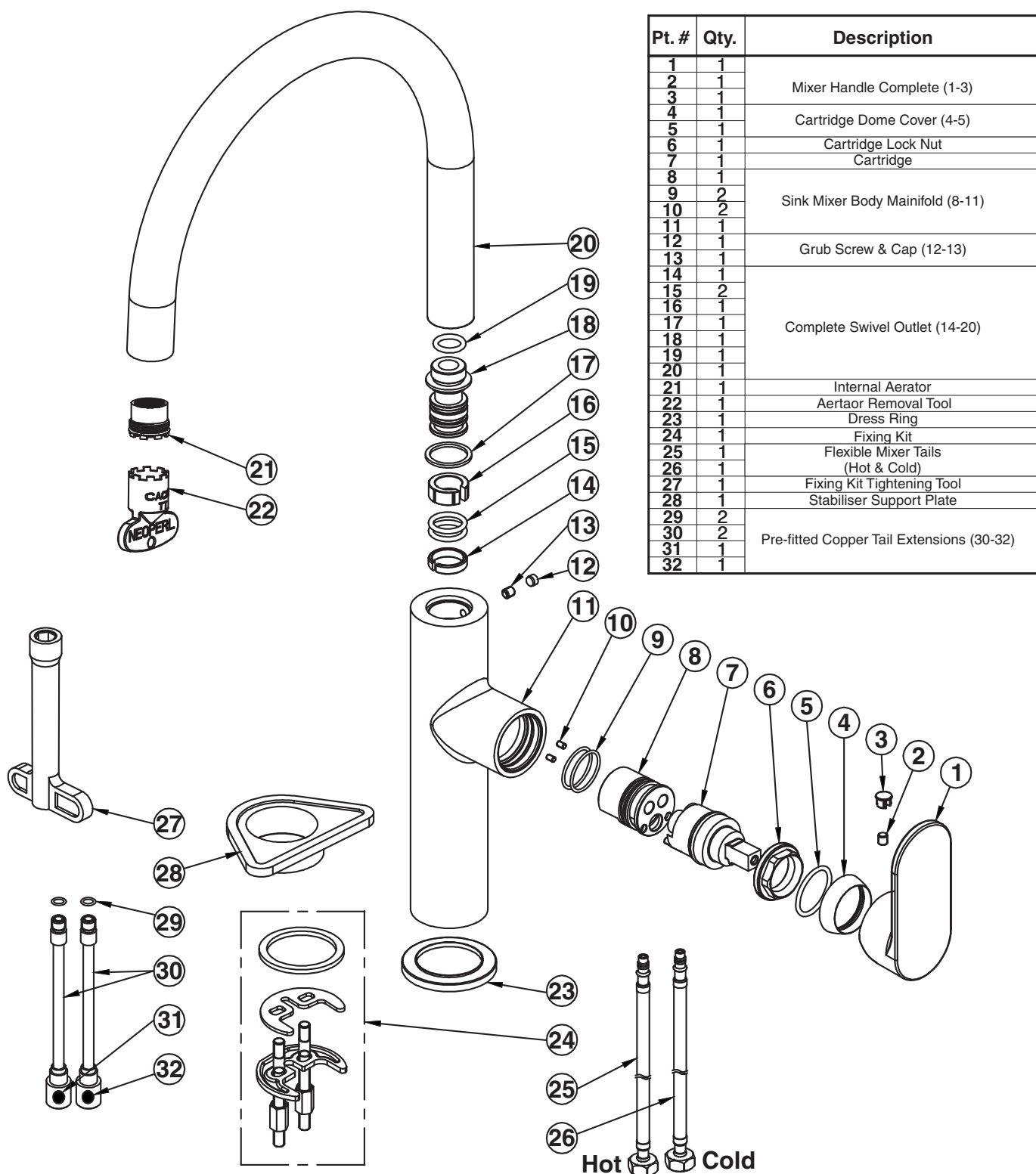

### Care Details

We recommend the use of soapy water or approved cleaners. This product should not be cleaned with abrasive materials. Damage caused by any improper treatment is not covered by the product warranty - refer to Warranty Conditions on the last page.

**Plumbers, please ensure a copy of the installation instruction is left with the end user for future reference.**

