

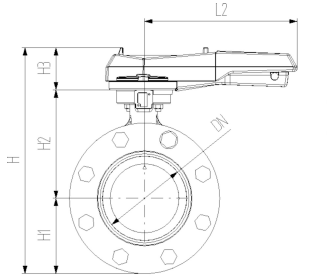

## COOL-FIT 4.0 Butterfly valve kit type 567, hand-operated

### Model:

- Material: ABS with spigot PE100 SDR11, metric
- Including valve, flange adaptors, backing flanges PP-Steel, hardware and insulation half shells
- Separate Fittings type A needed for joining



d	DN	PN	Cv-value	EPDM	weight
(mm)	(mm)		(l/min)	Part No.	(kg)
110	100	10	6500	<b>138 567 114</b>	8.950
160	150	10	16600	<b>138 567 117</b>	17.975
225	200	10	39600	<b>138 567 120</b>	28.316

d	DN	D	D1	D2	L	L1	L2	L3	H	H1	H2	H3	z	z1	z2
(mm)	(mm)	(mm)	(mm)	(mm)	(mm)	(mm)	(mm)	(mm)	(mm)	(mm)	(mm)	(mm)	(mm)	(mm)	(mm)
110	100	310	188	168	556	72	255	106	325	104	167	55	696	320	56
160	150	358	259		720	90	255	115	143	143	203	55	895	412	72
225	200	409	325		776	110	408	149	465	170	210	85	996	462	73

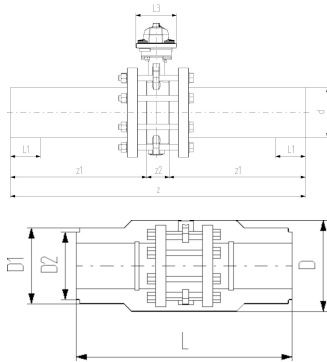

d	DN	closest inch
(mm)	(mm)	(inch)
110	100	4
160	150	5
225	200	8

The technical data are not binding. They neither constitute expressly warranted characteristics nor guaranteed properties nor a guaranteed durability. They are subject to modification. Our General Terms of Sale apply.

Georg Fischer Piping Systems Ltd, Postfach, CH-8201 Schaffhausen/Switzerland

Phone +41 -(0)52-631 1111

e-mail: [info.ps@georgfischer.com](mailto:info.ps@georgfischer.com)

Internet: <http://www.gfps.com>