

Ballerina Recessed Shaving Cabinet



Shaving Cabinet Fitting Instructions

- Prior to installation it is important to inspect the shaving cabinet to ensure no damage has occurred in transit. If damage has occurred, or a visible defect exists, do not proceed with the installation and advise supplier immediately. No warranty claim for damage will be accepted if the shaving cabinet is installed. This includes scratches to the glass.
- Prior to installation check wall/tile surface where shaving cabinet will be fitted is clean and level.
- It is recommended that the mirror is protected during installation.

PLEASE NOTE: MANUFACTURER WILL NOT BE LIABLE FOR THE COST OF INSTALLATION OR REMOVAL OF THE MIRROR & THE WARRANTY WILL BE VOIDED IF DAMAGE OCCURRED DURING INSTALLATION.

1. Check that the shaving cabinet will fit into the location. On timber studded walls, mark the positions of the studs, so to be able to fix the unit to these later.

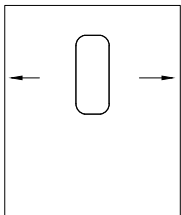

2. To aid Installation; first remove the doors by unclipping the hinges from the mounting plate. Place doors in a secure location in the meantime.

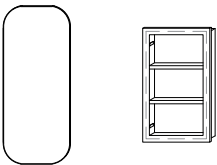

3. Mark where unit is to be installed. If possible, screw through side of the shaving cabinet at the level where the adjustable shelves will be placed. This way the screws will be hidden by the shelves. **ENSURING SCREWS ARE FIXED TO STUDS.** Allow enough fixing points at the top and bottom of the side panel. Note: to install internal shelves, place shelf pins into the appropriate brass bushes.

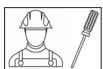
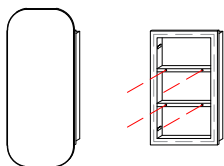

Shaving cabinet should be installed by a qualified, licensed trade person.

Plumbers, please ensure a copy of the Installation Instructions are left with the end user for future reference

Ballerina Recessed Shaving Cabinet

4. Ensure the shaving cabinet is installed level; as this will affect the alignment of the doors.

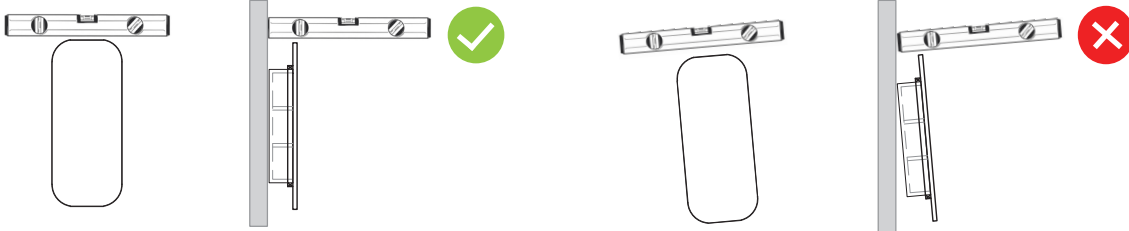

5. Attach the doors back on by sliding the hinges on the bracket and adjust accordingly using the hinge adjustment screws.

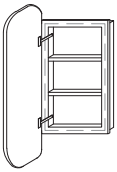

TO MAKE ADJUSTMENT



Start by removing the Zuster tag off the hinge plate to reveal the phillips head screws.

SIDE TO SIDE ADJUSTMENT

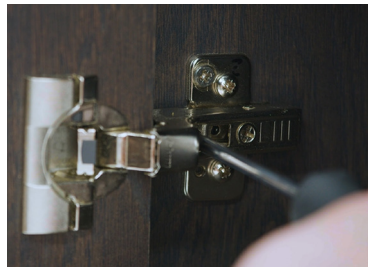

Turn front screw found closest to the door. This can be turned left or right.

DEPTH ADJUSTMENT

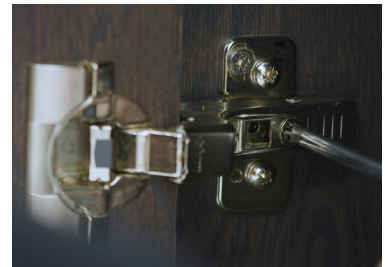

Turn back screw found at the back of the hinge. This can be turned left or right.

HEIGHT ADJUSTMENT

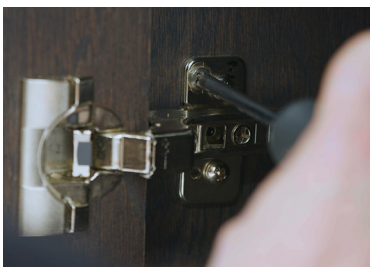

Turn screw found on the hinge mount. This can be turned left or right.

SCAN ME FOR A DETAILED ADJUSTMENT VIDEO:

