



WOLFEN™

INSTALLATION MANUAL

9506034 Wolfen Wall Mounted Outlet with Plate and Wave-On Sensor



Installation Details | Warranty



WOLFEN™

CONTENTS

Intro	03
Technical Information	04
Unit Components	06
Installation Instructions	08
Warranty	14

Delivering unrivalled quality

Designed for absolute performance, Wolfen's commercial wall mounted outlet with plate and wave-on sensor sets new standards in quality and durability. Ergonomic design combined with precision engineering ensures that every Wolfen product is easy-to-use and made to last. Here are just some of the many innovative features that make the Wolfen commercial wall mounted outlet with plate and wave-on sensor the smart solution.

- Infrared activated wall mounted outlet
- The tap body is designed for concealed installation into stud walls
- The unit can be connected to supply cold water only or pre-mixed water via a thermostatic mixing valve

Commercial durability

- 12V mains power via plug-pack power supply
- Low power consumption in standby
- Solenoid cartridge has integrated stainless steel strainer
- Water resistant gold-plated cable pluggable connectors
- Brushed 260mm stainless steel spout and cover plate
- Program adjustability via optional remote control
- Auto line flush when unit has not been used for 24hrs



Suitable for High Pressure applications
(minimum 150kPa)

Installation and servicing

- Plug pack transformer with 4.8m cable
- Modular components allow easy maintenance and changeover
- Quick connect moulded electrical plugs
- Plate can be removed without disassembling spout
- Everything except transformer is contained within a pre-assembled in-wall installation box
- Only 70mm wall cavity required
- Integrated maintenance shut-off valve

Usage features

- Quick and easy program adjustment via optional remote control
- Features an automated water shut-off function
- Tap can be set up to fill a bath tub
- Aerator with 5L/m flow regulator
- Vandal resistant wall mounted components

Application

- Hospital and health care
- Commercial food premises

TECHNICAL INFORMATION

Product Code	9506034
Country of Origin	Australia
Colour	Stainless Steel
Finish	Brushed
Material	Stainless Steel
Min Continuous Working Pressure	150kPa
Max Continuous Working Pressure	500kPa
Max Static Pressure	800kPa
Max Working Temperature	50°C
Min Working Temperature	5°C
Ambient Temperature	Min 5°C Max 40°C

Wolfen Wall Mounted Outlet with Plate and Wave-On Sensor



Optional Remote:

9506370 Wolfen Remote Control

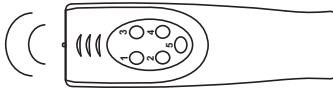

6.7

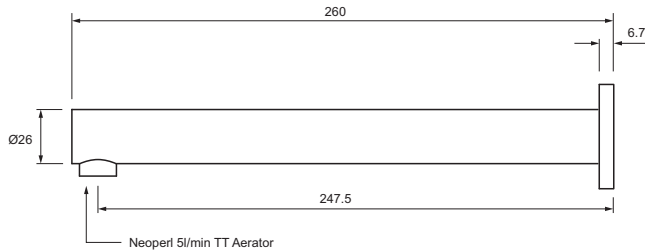
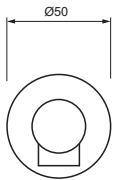

Ø50

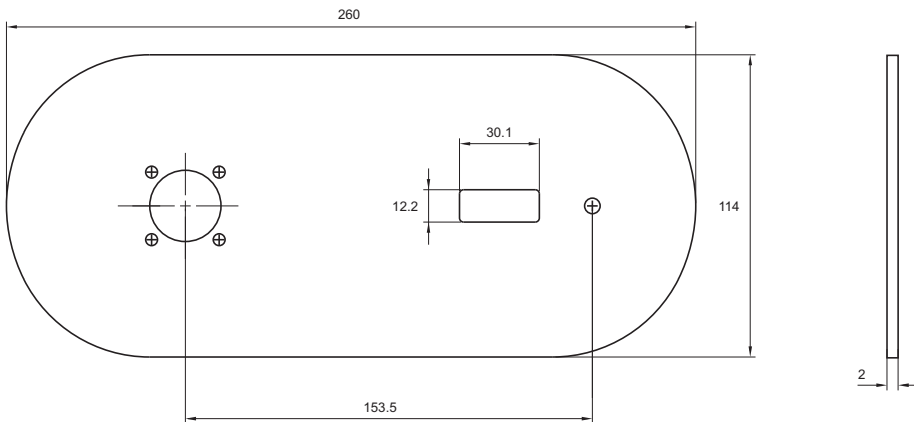

UNIT COMPONENTS

Wolfen Hob Mounted Sensor Tap with Internal Solenoid

Item No.	Part Number	Description	QTY.
1	TR-5	Transformer, 240V AC to 12V DC	1
2	100.019	Transformer Extension Cable	1
3	300.080	Face Plate including Sensor	1
3a	300.079	Face Plate	1
3b	300.076	Swipe Sensor	1
4	300.014	Fastening Flange	1
5		Maintenance Shut-off Valve	1
6	SV-2	Electronic Tap Valve	1
6a	SN02-03	Valve Body	1
6b	SV-2A	Solenoid Cartridge 12V DC	1
7	300.070	Spout Connection Fitting	1
8	300.071	Installation Box	1
9	300.072	Backing Plate	1
10	300.073	Fastening Plate	1
11	Loctite 577	Thread Sealant, AS/NZS 4020 Tested	1

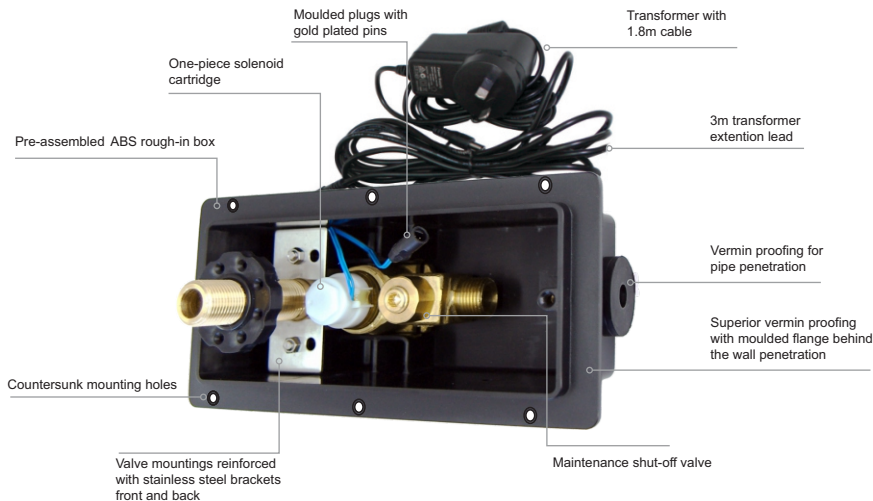

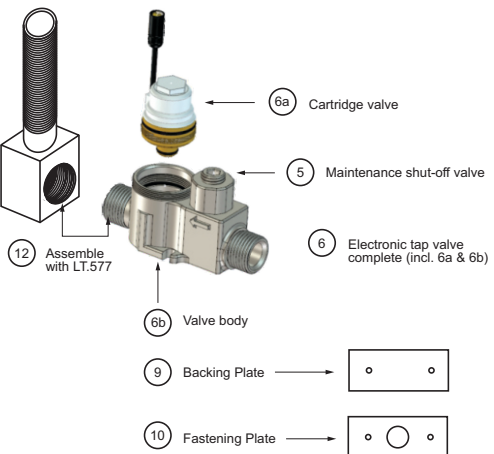
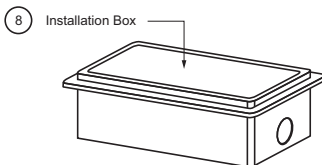
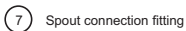
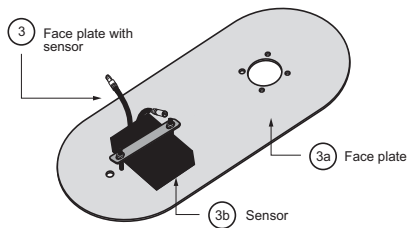
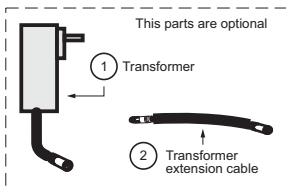

INSTALLATION INSTRUCTIONS

Important Note

Mixer must be installed to the requirements of AS/NZS 3500 by a qualified plumber. Your mixer comes to you already factory assembled and tested. We do not recommend the dismantling of any internal part of the mixer. The mixer is factory tested and sealed so as to give the best performance.

1. Please flush out new pipe work prior to connecting the new mixer.
2. This tap is suitable for high pressure applications where both hot and cold water supply pressures are at 150kPa or above.

Operation and Safety Precautions:

1. The Wolfen Wall Mounted Outlet with Plate and Wave-On Sensor and its components are for indoor use only.
2. Install the Wolfen infrared tap and its' components only in a dry environment.
3. When performing any work on the Wolfen infrared tap or its' connected components, disconnect the power supply first and isolate the water supply.
4. The transformer and the electrical components should be installed as per the local regulations.
5. Only the original supplied transformer should be connected to the Wolfen infrared wall mounted tap.
6. For the installation and operation, observe all relevant electrical, safety plumbing and building standards.
7. All supplied components should only be used for the purpose they are designed for.
8. The built in shut-off valve is designed to be used only for maintenance purposes. It should not be used as an end of line shut off device. In operation, it **must be fully opened**.

Installation Instructions:

Do not mount the installation box in any other way than as shown in the installation instruction. The outlet is to be mounted at a sufficient height over the basin. Ensure adequate rigidity of the wall outlet.

1. Install noggings above and below the installation housing, ensuring it fits snug in between the noggings. Position the housing so that the spout fitting is in the centre of the basin. Fasten housing with 3 screws to each nogging (Fig.1,2,5)
2. Check with the designer for the correct installation height and mount the installation box into the stud wall as indicated (Fig.1&5).
3. Use a Rehau (or equivalent) loose nut union fitting with a fibre waster to connect the water supply to the shut-off valve. Prior to crimping the fitting slide the grommet onto the pipe.
4. Use a second spanner to hold the valve in place when tying up the pipe connection to the valve (Fig.2).
5. Check the installation for leaks.
6. Install the conduit and low voltage power supply cable penetrating the installation box from the top only. (Fig.1).
7. Close the shut-off valve and install the supplied Styrofoam protection over the installation housing. Fit an end-cap to the end of the spout connection fitting.

Fig. 1

Installation overview

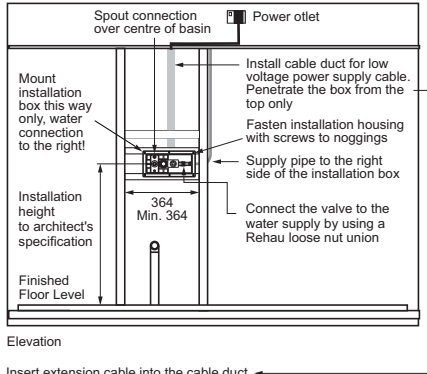

The transformer connects to the octagon shaped socket of the extension cable.



The sensor on the cover plate connects to the female socket of the extension cable.

Fig. 2

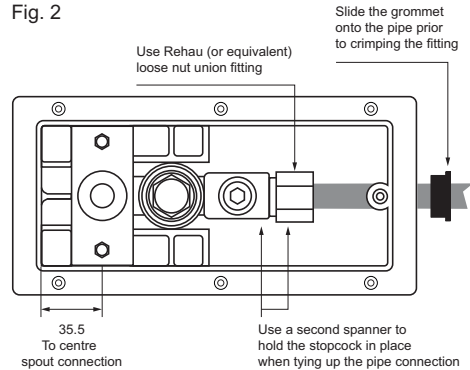

Note: The shut-off valve is designed for temporary maintenance shut-off only. In normal operation it shall be fully opened and shall not be used as a permanent end of line shut-off device.

Fig. 4

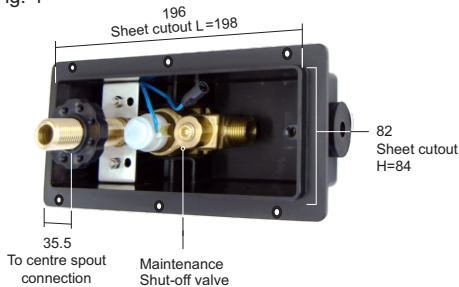
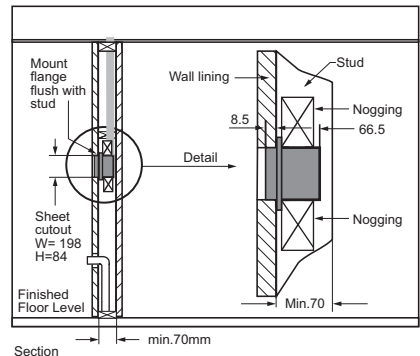

Fig. 5



Selecting a program run-time time is quicker by simply skipping through the different pre-set times. Push button 5 repeatedly to skip forward through the programs. When the next program is selected the sensor acknowledges it by flashing the number of times indicating the program number it is set at (e.g. program 5 the sensor will flash 5 times). There are 6 programs.

Program 1:

Range between min. 3 seconds and max. 15 seconds. One second steps-per push

Program 2:

Range between min. 15 seconds and max. 30 seconds. One second steps-per push

Program 3:

Range between min. 30 seconds and max. 45 seconds. One second steps-per push

Program 4:

Range between min. 45 seconds and max. 60 seconds. One second steps-per push

Program 5:

Range between min. 60 seconds and max. 3 minutes. 15 second steps-per push

Program 6:

Range between min. 3 minutes and max. 8 minutes. 30 second steps-per push

INSTALLATION INSTRUCTIONS

Instructions for fit out

- Before installing the sensor plate, make sure that the transformer which supplies the sensor with power is disconnected from the mains supply. If the tap is powered by a battery, disconnect the battery.
- Adjust the installation flange so that it is flush with the finished wall surface (Fig. 1).
- Slowly open the maintenance shut-off valve inside the installation box. **Important note:** It is possible that water will discharge briefly from the fitting where the spout will be connected later. The water discharge will stop once the water pressure has built up behind the diaphragm of the solenoid valve. Catch the spillage with a bucket.
- Check that the black masking tape which is glued across the sensor window is in-place (Fig. 2). The black masking tape will prevent the sensor from activating the solenoid. The tape should only be removed once the complete installation is finished.
- There are two low voltage cables attached to the sensor. One lead connects to the low voltage output of the transformer (or battery) and the other to the solenoid valve. Plug them both into the corresponding plug or socket.
- Screw the sensor plate with the supplied screws onto the fastening flange and the thread insert of the installation box (Fig. 2).
- Install the spout. If the spout is installed at a later stage it is recommended that an end cap is fitted onto the spout connection fitting.
- Test and adjust the sensor as required.**
- Apply the supplied sticker "blue circle" for taps connected to cold water only and "yellow circle" for taps connected to tempered water supply. The sticker should be applied so it is clearly visible.

Fig. 1

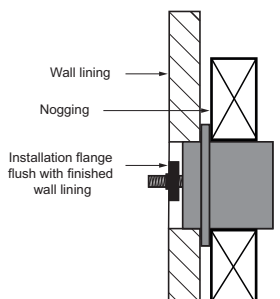
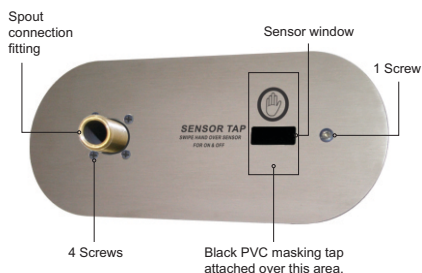

Fig. 2



Cleaning note:

Do not use harsh or abrasive cleaners on any of the tap surfaces.

Use a suitable mild detergent (follow the manufacturers instructions) and dry with a soft cloth.

Activating the solenoid valve via the infrared sensor

To activate the solenoid valve swipe the hand across the sensor. The solenoid valve will stay open for a pre-set time and will then switch off automatically. Various time settings can be set with the optional remote control.

While the solenoid valve is active, it can also be switched off manually. Just swipe the hand over the sensor again and the valve will switch off. If the sensor has not been activated for 24hrs, it will automatically flush the line for 20 seconds to discharge stagnant water in the line.

The settings of the sensor can be customised to meet individual requirements. Adjustments are carried out with the optional remote control (Reece code 9506370).

The settings can be changed at any time and are not lost when the power to the sensor is disconnected. If the factory pre-sets are adequate, no adjustments are required.

Factory settings of the sensor

Run-time before auto shut off: Approximately 4 seconds.

Detection distance of the sensor:
Approximately 100mm

Auto run-time range setting: Program 1

Adjusting the sensor settings via the remote control

To change settings, point the remote control towards the sensor from approximately 500mm distance and press the desired button. Once the sensor has received the signal and has changed its setting, it will acknowledge by flashing. The remote control has 5 buttons which perform the following adjustments.

Button	Function	Comment
1	Extend detection distance	Max. distance is 150mm
2	Shorten the detection distance	Min. distance is 50mm
3	Extend run-time	Depends on program
4	Shorten run-time	Depends on program
5	Select auto-run time range	6 programs

Optional Remote:

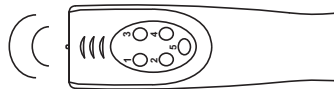

TROUBLESHOOTING

No water when activating	Check that: <ul style="list-style-type: none"> • the power is switched on • transformer is plugged in • battery is connected and charged (if applicable) • all cable connectors are plugged in correctly • connection plugs pin are not bent or broken • the water is turned on • the shut-off valve is open
Detection range is too short or too far away	Extend or shorten the detection range with the optional remote control
Water flow is too long or too short	Extend or shorten the run time with the optional remote control
Water flow activates unexpectedly for 20 seconds and switched off again	The tap has not been used for 24 hours and triggers a line flush. This is normal.

NOTE If supplied, the batteries are consumables and are not covered by the warranty.

FOR ADDITIONAL PRODUCT SUPPORT PLEASE CONTACT

SANITRON CUSTOMER SUPPORT ON: 07 3875 2465

Maintenance

Prior to commencing any work, switch off the power and shut down water supply. Be careful when removing the solenoid it still can be pressurised.

Important ! The solenoid cartridge should screw in to the valve body freely without much resistance - for about **2½-3** turns. **Read and follow the steps below to avoid damage or failure of the solenoid cartridge !**

- 1) To remove the solenoid cartridge use a 17 mm socket or tube spanner (turn anti clockwise).
- 2) Lubricate the o-rings of the new solenoid and **seats in the valve body**. Use only silicone based o-ring lubricant approved for potable water application.
- 3) Screw the new solenoid cartridge by **hand** all the way into the valve body (approx. **2½-3** turns). Make sure that solenoid is screwed in straight and apply slight **inward pressure** while screwing in the solenoid. Finally tighten with torque wrench, **do not over tighten**. The maximum torque is **1Nm** which is just a bit above hand tight. If the solenoid cartridge is hard to turn after **1** revolution **STOP!!** Unscrew the cartridge and repeat the above steps. Activate the valve several times and check for leaks.
- 4) If solenoid cartridge leaks out the side of the big o-ring, it has not been screwed in properly (cross-threaded). Remove solenoid and check that threads are not damaged. If threads check OK, re-insert solenoid.
If not **replace solenoid**.
- 5) It is recommended to check in regular maintenance intervals that the solenoid functions correctly and that there are no leaks on the valve or its components.

REECE PRODUCT QUALITY GUARANTEE



You have purchased a quality product from Reece Australia Pty Ltd ABN 84 004 097 090 ("Reece"). This product is covered by a 5 year replacement product warranty and a 12 month warranty over spare parts and labour.

5 YEAR WARRANTY

This warranty covers faults in the product construction, material and assembly. Products which are within 5 years from the date of purchase, found upon inspection by an authorised Reece representative, to be defective in construction, material or assembly, will be repaired or exchanged with an equivalent product free of charge. Replaced items become Reece's property.

All replacement products will be available for collection without charge to the customer at the nearest Reece branch to the customer's location, or elsewhere as agreed between the customer and Reece.

Note: The solenoid valve is classified as a spare part and is covered by the 12 months spare parts and labour warranty as per the manufacturer's provisions.

Labour and Spare Parts

The labour for the replacement of products and spare parts to which this warranty applies will be supplied by Reece or relevant supplier using licensed plumbers engaged by Reece or relevant supplier within 1 year from the date of purchase. Spare parts other than those listed in the Manufacturer's Provisions above, which are within 1 year from the date of purchase found upon inspection by an authorised Reece representative to be defective in construction, material or assembly, will be replaced free of charge.

Warranty Conditions

This warranty will apply only under all of the following conditions:

- The item has been installed by a licensed plumber
- Failure is due to a fault in the manufacture of the product

- Proof of purchase (including the date of purchase) is provided
- The installation of the product is in accordance with the instructions provided

This warranty does not cover products purchased as an ex-display without being fully checked and tested for sale by the manufacturer.

This warranty does not include faults caused by:

- Unsuitable or improper use
- Incorrect installation or installation not in accordance with the instructions provided
- Installation or part installation by the purchaser or any person other than a LICENSED PLUMBER
- Normal wear and tear
- Inadequate or complete lack of maintenance
- Chemical, electrochemical or electrical influences
- Harsh detergents or abrasive cleaners used on product finishes

EXCLUSIONS

To the fullest extent permitted by law, Reece excludes all liability for damage or injury to any person, damage to any property, and any indirect consequential or other loss or damage.

CLAIM PROCEDURE

For all warranty queries customers are to contact the branch where the product was purchased. These details can be found on your purchase invoice.

Our goods come with guarantees that cannot be excluded under the Australian Consumer Law. You are entitled to a replacement or refund for a major failure and for compensation for any other reasonably foreseeable loss or damage. You are also entitled to have the goods repaired or replaced if the goods fail to be of acceptable quality and the failure does not amount to a major failure.

Don't risk it, use a licensed plumber.™



WOLFEN™

reece.com.au/wolfen

IF AFTER CHECKING THE
INSTALLATION INSTRUCTIONS
AND IMPORTANT
INFORMATION, THE PROBLEM
HAS NOT BEEN IDENTIFIED,
PLEASE CONTACT SANITRON
CUSTOMER SUPPORT ON:

+61 7 3875 2465