

# KADO

## Thin Round Above Counter Basin 380mm (No Taphole)

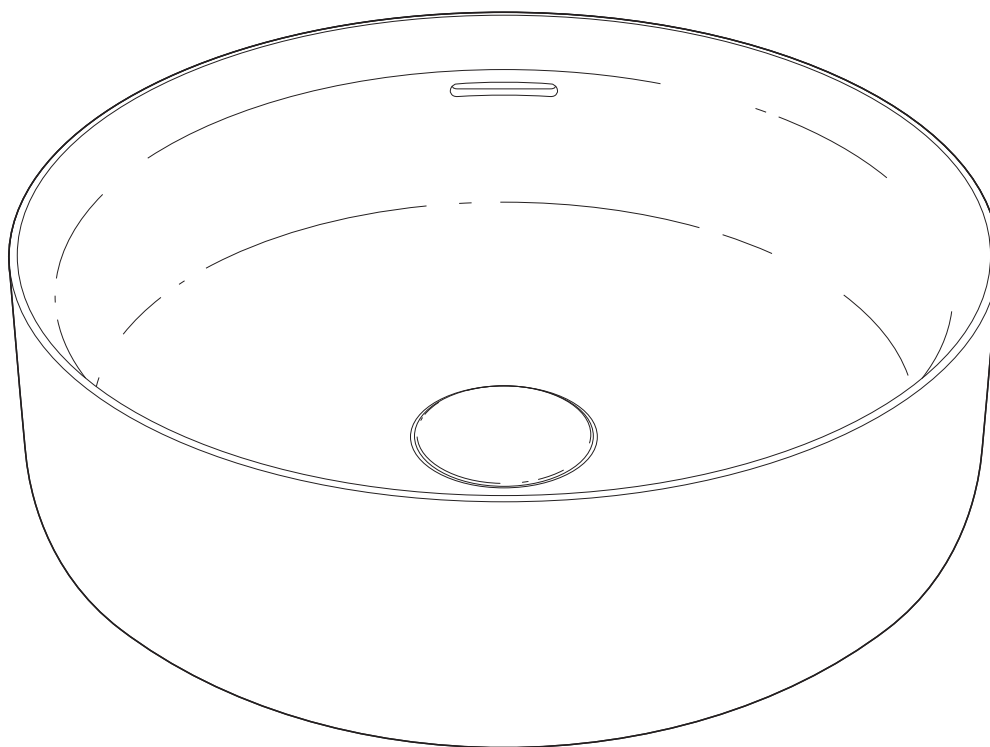

### Pre-Installation Check



Please unwrap the basin and check it carefully to ensure it has not been damaged in handling or transport.



Basin must be installed to the requirements of AS/NZS 3500 by a qualified plumber



If using wall mounted tapware, please take into consideration the length of the outlet to the position of the Basin on the Benchtop.  
If the Tapware is to be bench mounted, allow suitable bench top width for fitting the tapware.

### Waste Assembly

1. Fit the supplied (40mm) solid surface overflow pop up waste plug to basin.

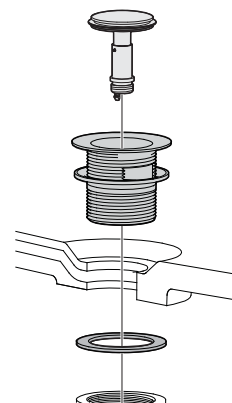

# KADO

## Thin Round Above Counter Basin 380mm (No Taphole)

### Installation

**Note:** 150 mm diameter hole recommended to allow for waste and plumbing.

**Note:** Consider positioning of basin in relation to selected tapware.

2. Cut out Bench Top with clearance hole to fit waste.

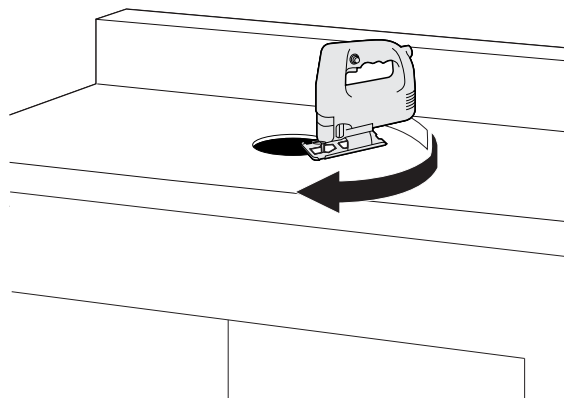

3. Apply waterproof sealant under the rim of the Basin.
4. Position Basin, complete with fittings, onto the benchtop and press firmly all around. Ensure basin is positioned evenly.
5. Remove any excess Sealant.

**Note:** Do not use for 24 hours, allow silicone to dry or refer to instructions as per sealant manufacturer.

6. Once all plumbing has been done fill basin and check for leaks.

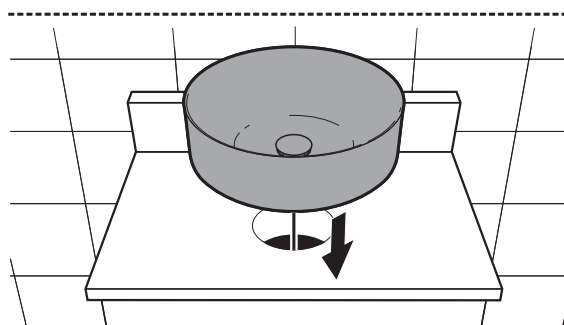
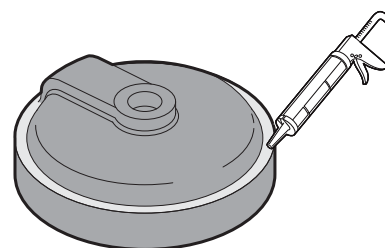

### Care Details

#### Care and Maintenance

- For general cleaning use soapy water or an approved cleaner for solid surfaces.
- For a deeper periodic clean, to maintain the matte surface use the Kado Solid Surface Care Maintenance Kit (can be purchased separately).
- When marks or dirt appear on the surface that general cleaning does not fully remove, the solid surface Cleaning and Maintenance paste can be used, wipe any residue from surface and finish off by wiping and drying with soft clean cloth. Can also use fine sandpaper 1500-2000 grit to remove minor scratching or stubborn residue stains.
- Damage caused by any improper treatment is not covered by the product warranty. Refer to Warranty Conditions.

**Plumbers, please ensure a copy of the installation instruction is left with the end user for future reference.**

