

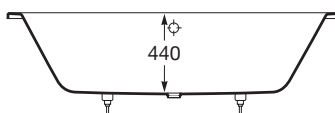

LUN PLUS BATH

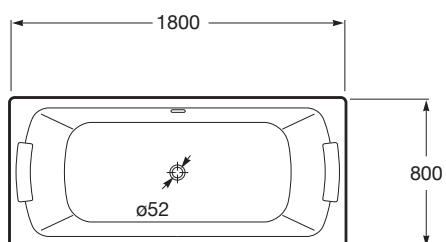
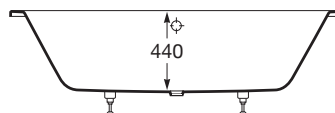
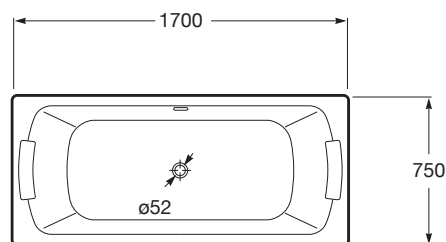

min 130 - max 170
if installed with feet

Dimensions are nominal only

SPECIFICATION

Recommended use	Domestic, hotel and commercial
Material	Enamelled pressed steel
Fixing	Hob mounted or checked into wall
Overflow	Yes
Installation	Inset / Levelling Feet
Plug and waste	Pop up overflow dial waste (included)
Colour availability	White
Capacity	1700mm - 225L 1800mm - 264L

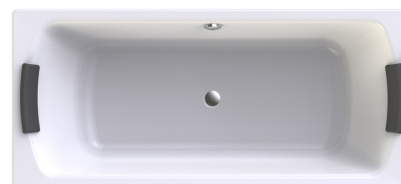

To see the complete Roca range go to
www.reece.com.au/bathrooms

CLEANING RECOMMENDATIONS

Soapy water or approved bathroom cleaners. This bathroom product should not be cleaned with abrasive materials. Damage caused by any improper treatment is not covered by the product warranty. Refer to Warranty Conditions on the last page.

LUN PLUS BATH

HANDLING INSTRUCTIONS

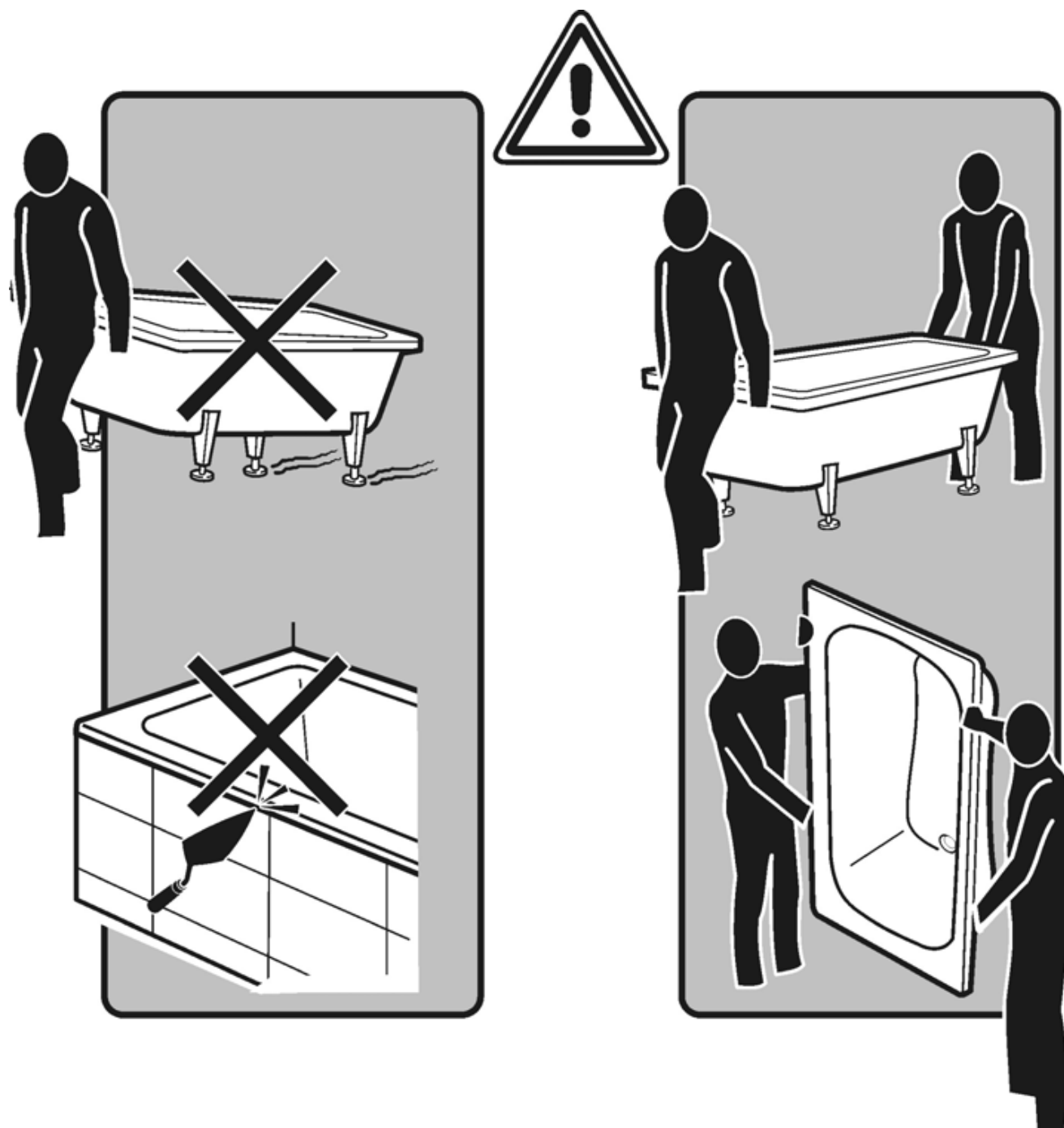



LUN PLUS BATH

INSTALLATION INSTRUCTIONS - WITHOUT FEET

Note: Please check surface thoroughly before installing. Installation of the bath will be taken as full acceptance of the product .. Also, it is important to install the product in accordance with the installation instructions below

Installation of bath without feet, flush-mounted/built-in to wall and with support wall.

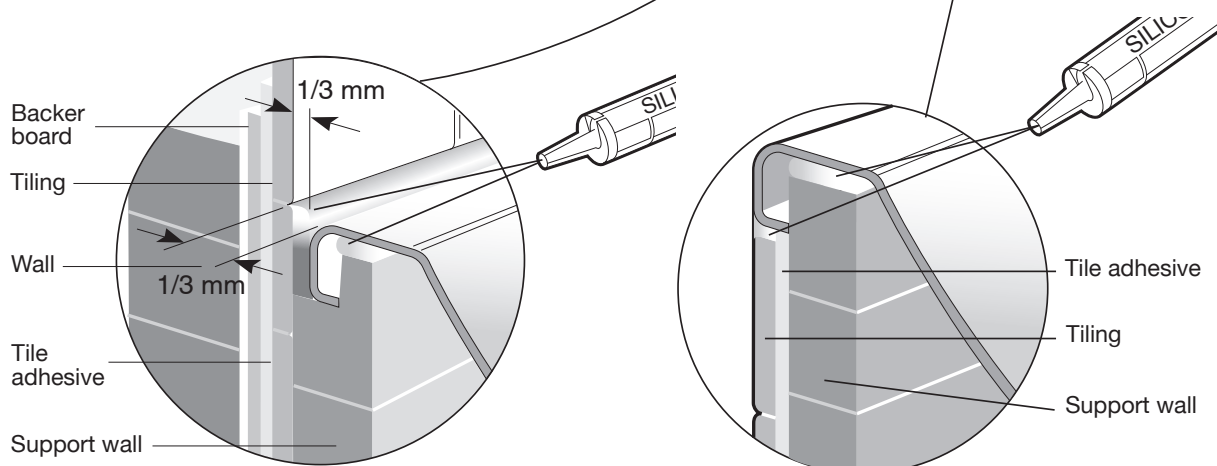
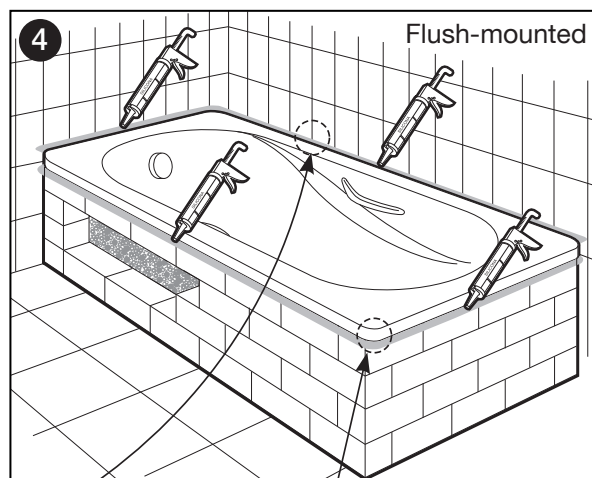
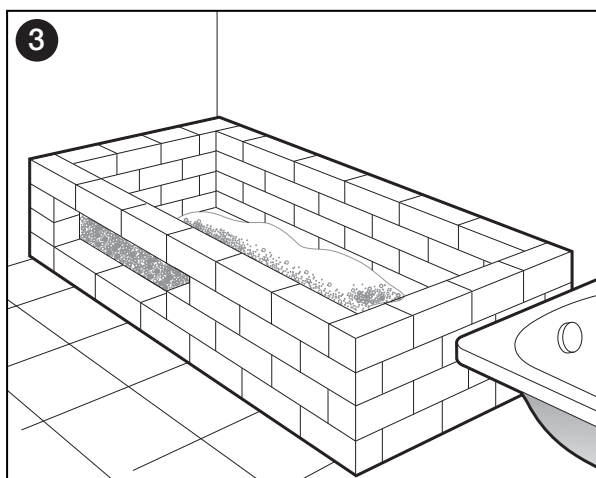
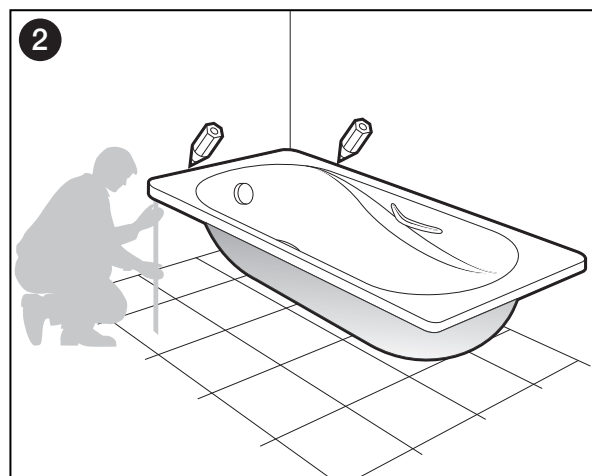
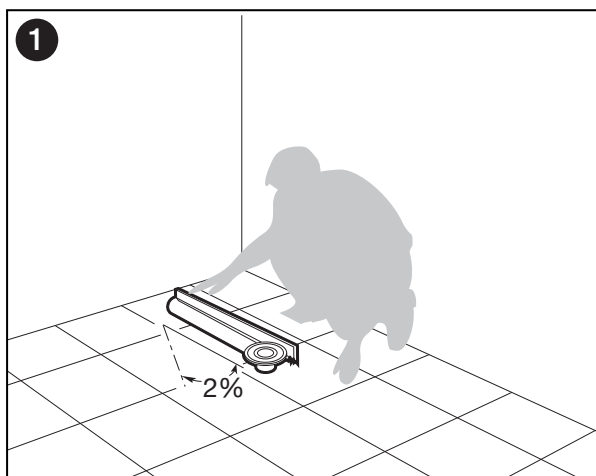

Plumbers, please ensure a copy of the installation instructions is left with the end user for future reference



LUN PLUS BATH

INSTALLATION INSTRUCTIONS - WITHOUT FEET

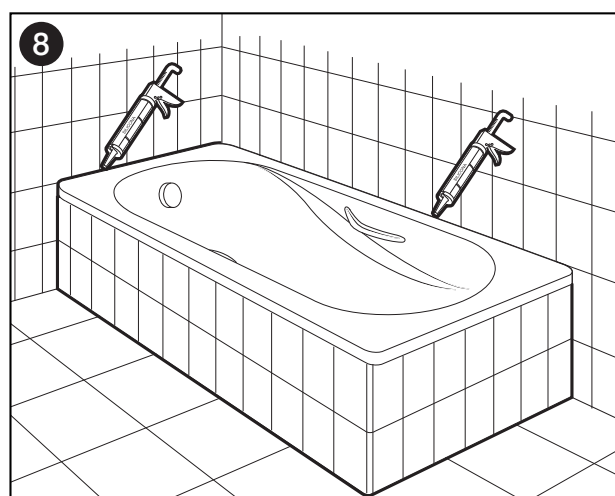
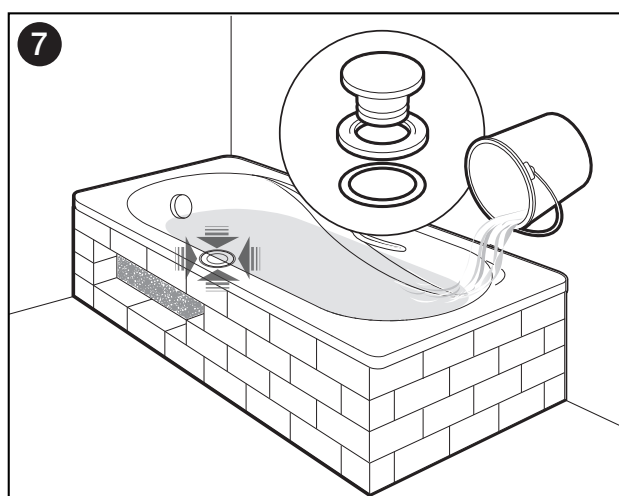
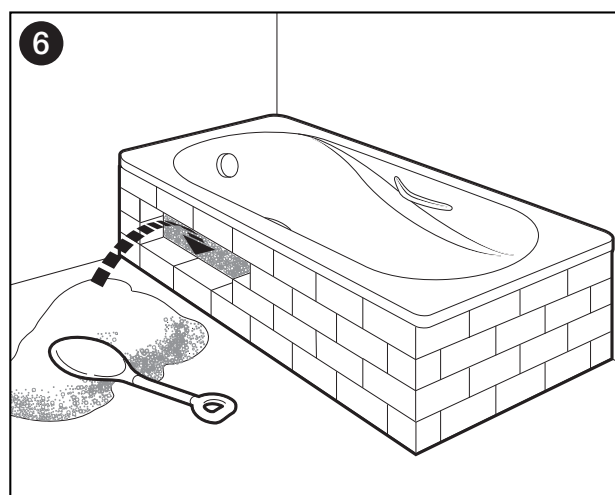
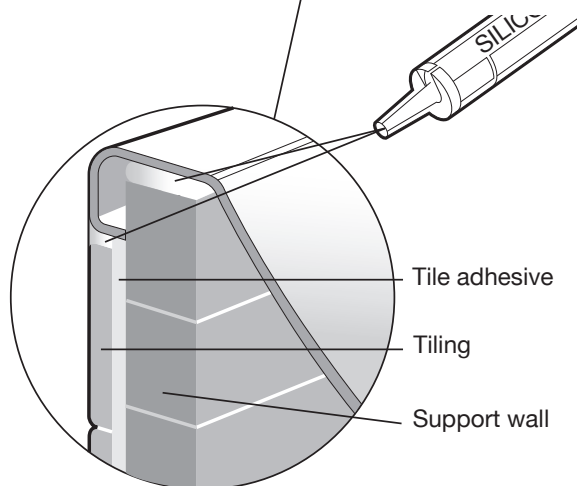
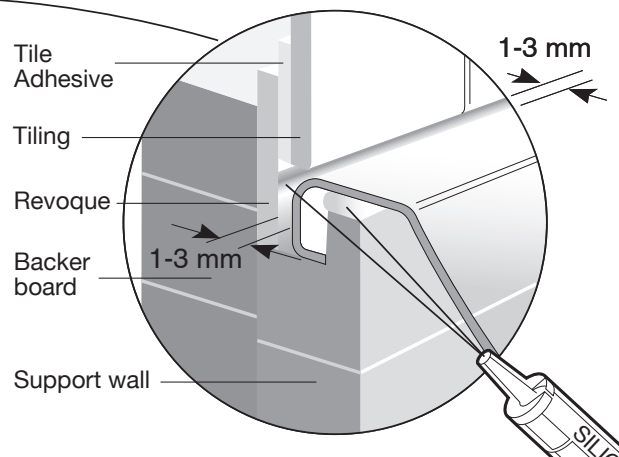
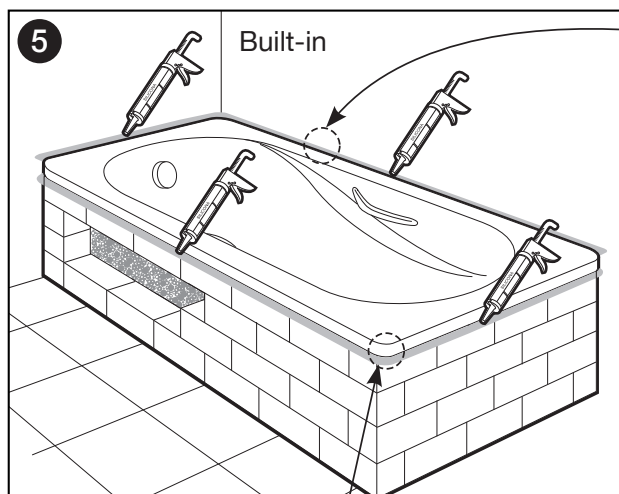

Plumbers, please ensure a copy of the installation instructions is left with the end user for future reference

LUN PLUS BATH

ROCA FEET SET SPECIFICATIONS

FEATURES / SPECIFICATIONS

- The package contains two legs and a fixation set. It is composed by two metallic crossbars of 560x75 and two adjustable plastic feet.
- Variable adjustment range from 115 to 155 mm.
- Made by combination of steel and plastic parts.

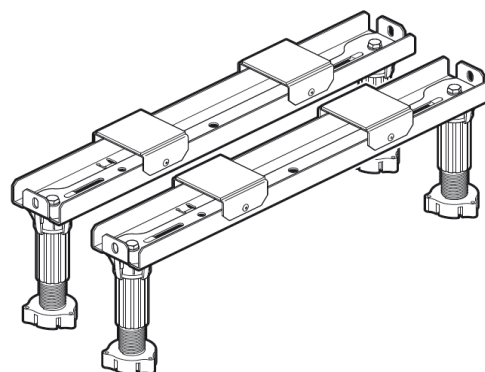
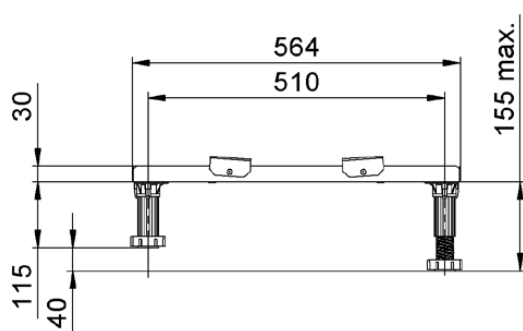

MODELS / REFERENCES

Reference	Dimensions	Colours / Finishes (...)	Description
A248427000	560x75	Galvanized steel + Black plastic	FEET FOR STEEL BATHTUB

INSTALLATION NOTES

- Free-standing installation.

PRODUCT DIAGRAM

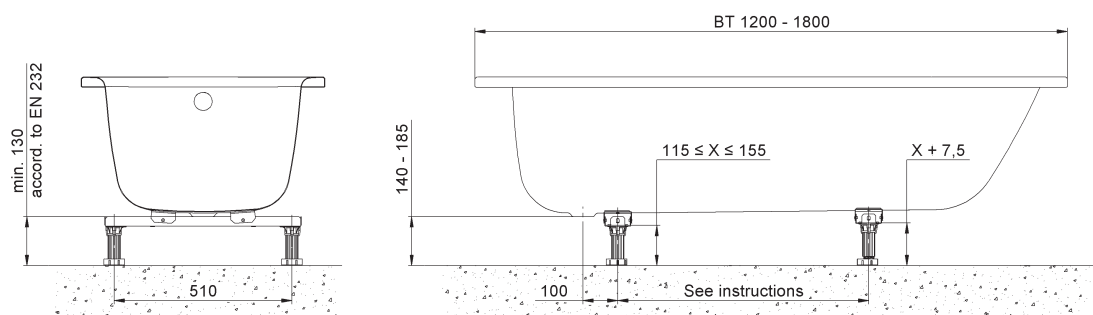

LUN PLUS BATH

INSTALLATION INSTRUCTIONS - WITH FEET

Note: Please check surface thoroughly before installing. Installation of the bath will be taken as full acceptance of the product .. Also, it is important to install the product in accordance with the installation instructions below

Installation of bathtub with feet, flush-mounted or built-in to wall and with support wall or panel.
NB: The feet are sold separately and must be mounted on the bath.

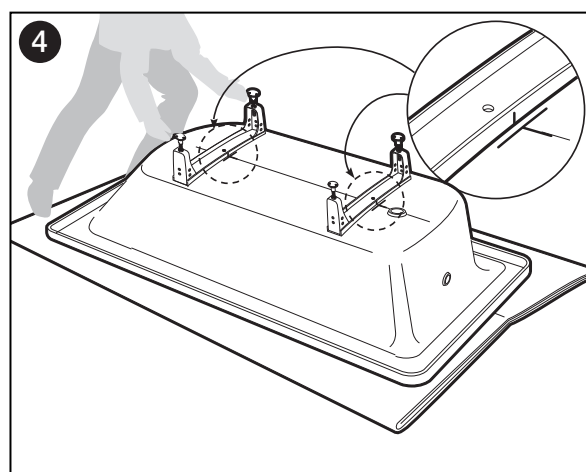
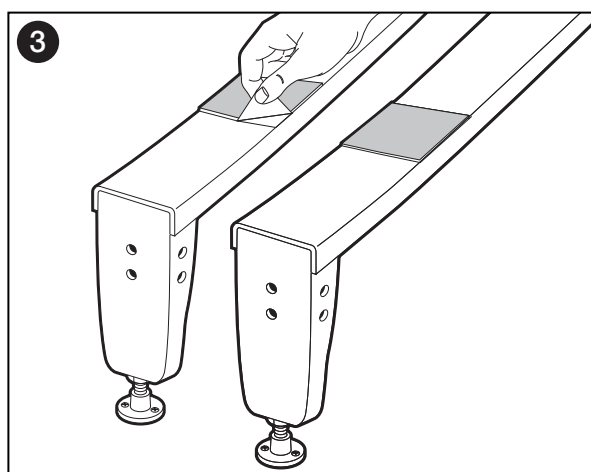
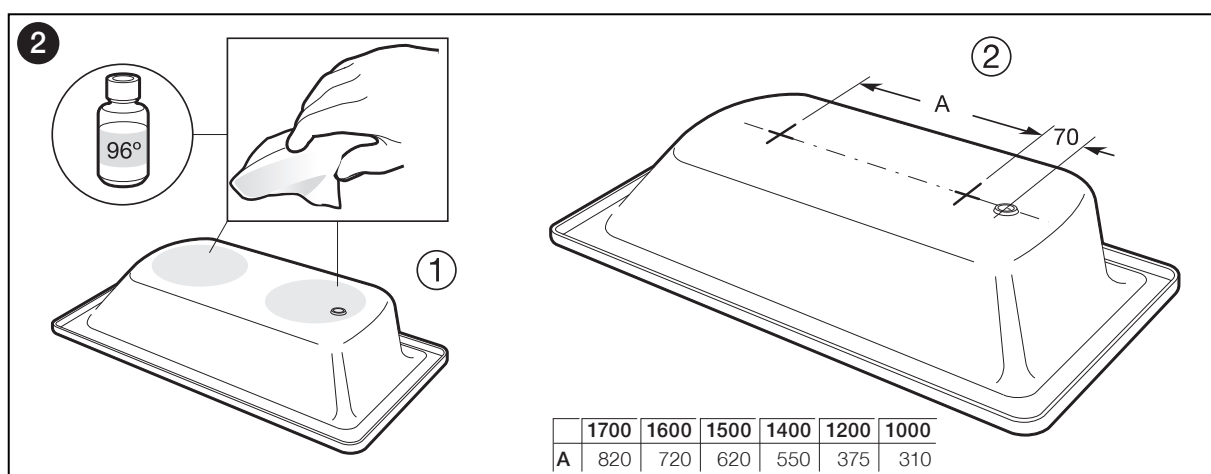
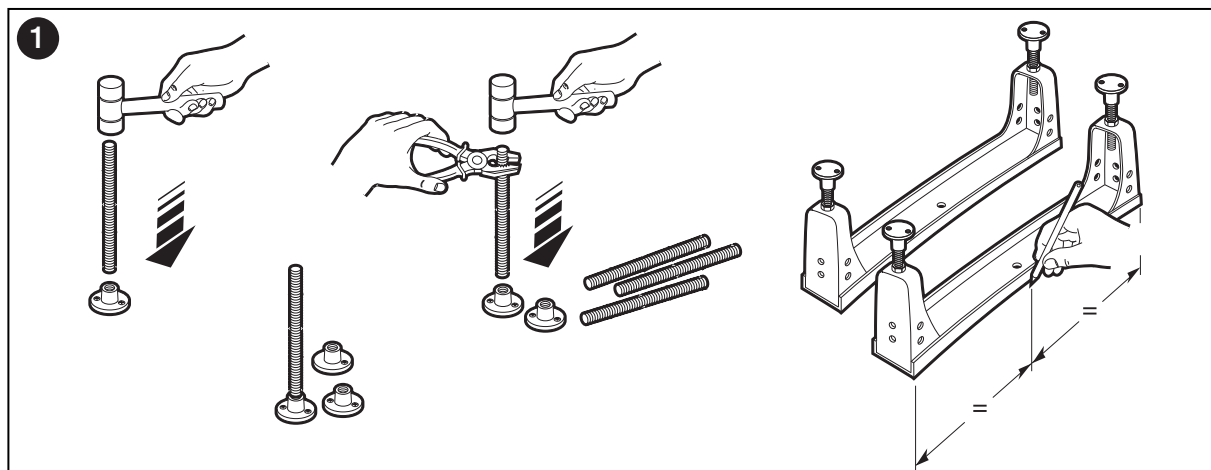

LUN PLUS BATH

INSTALLATION INSTRUCTIONS - WITH FEET

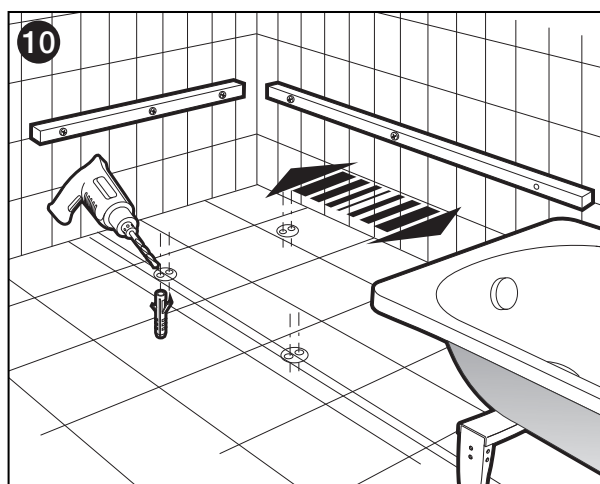
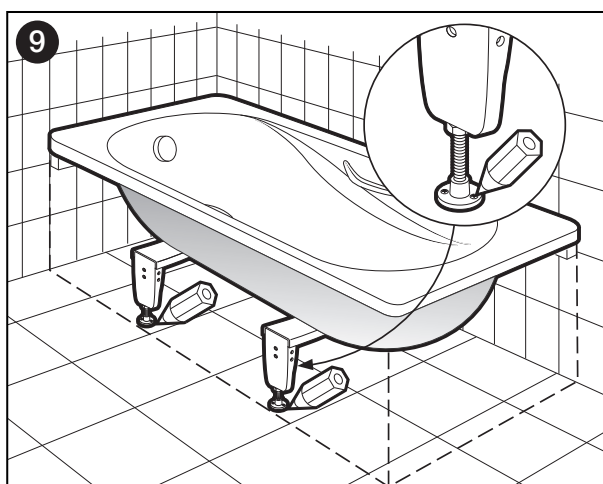
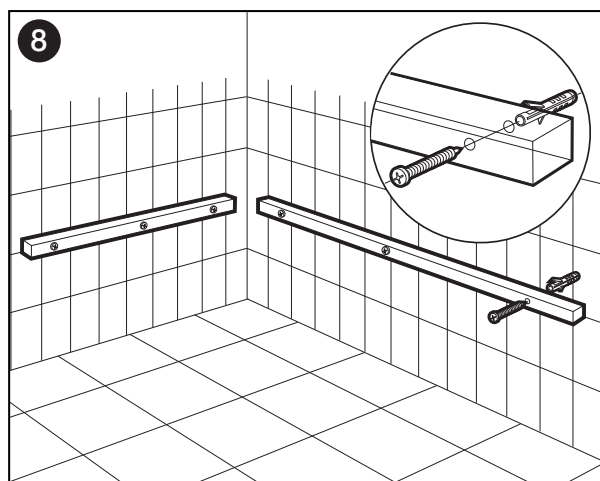
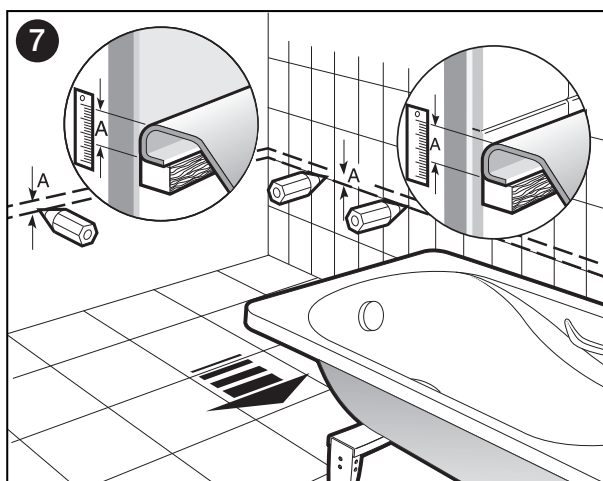
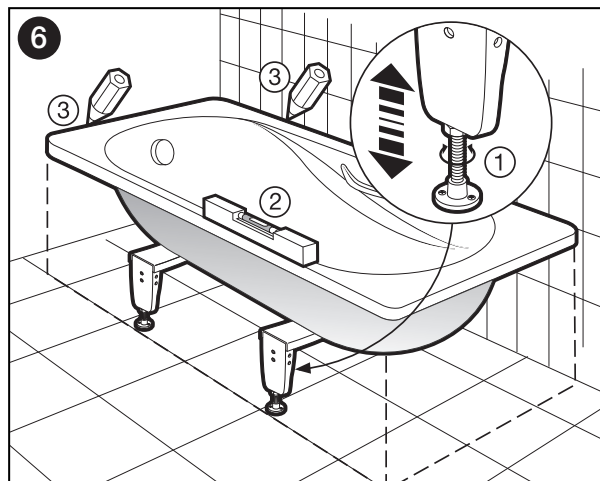
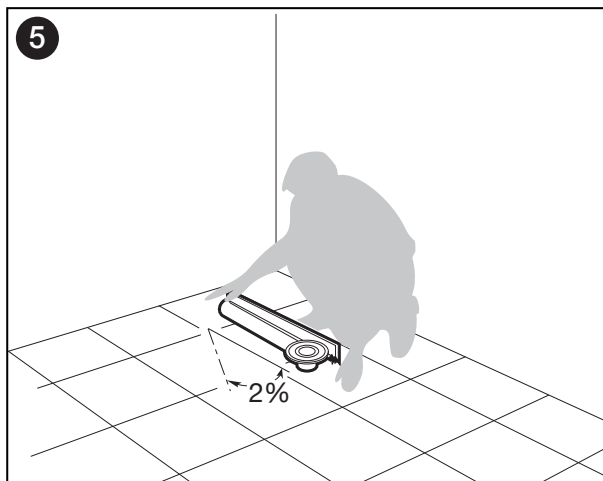

LUN PLUS BATH

INSTALLATION INSTRUCTIONS - WITH FEET

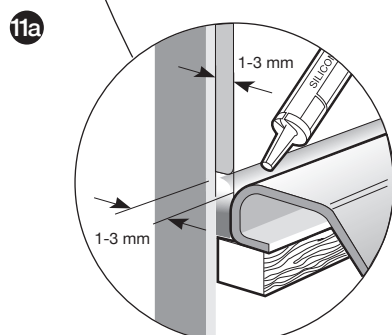
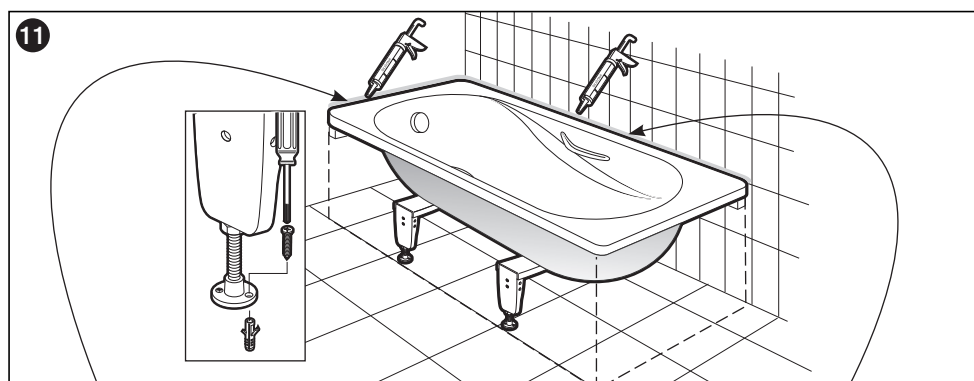

Built-in

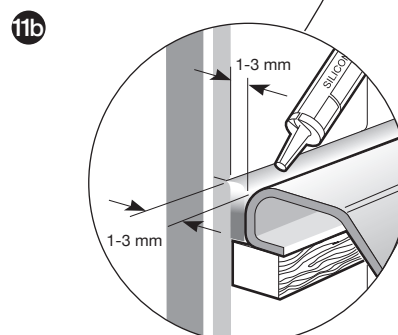

Flush-mounted

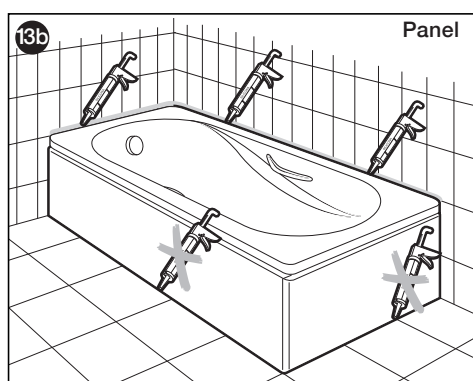
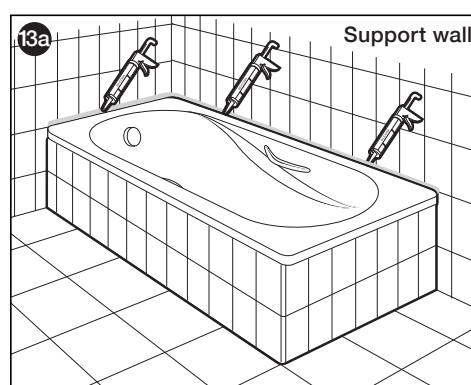
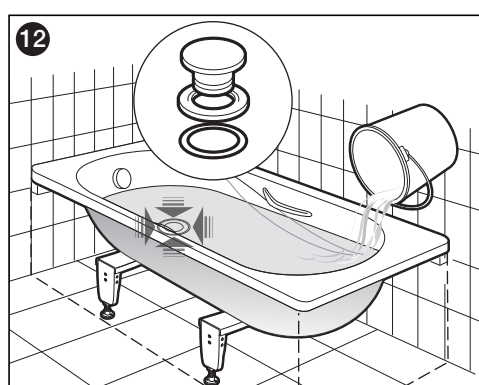

Plumbers, please ensure a copy of the installation instructions is left with the end user for future reference