



boss

The complete range for mobile-ready local supervision

Supervisors for small, medium and large sites

with built-in Wi-Fi, accessible from all mobile devices

boss range

- Completely browsable from mobile devices, from commissioning to daily access for system maintenance;
- Built-in Wi-Fi to create a network and allow the supervisor to be accessed from the user's devices without requiring other network infrastructure.
- Built-in 4G modem on boss-micro for sending emails / instant messages / SMS without needing to use the building's IT infrastructure to connect to the Internet



Energy saving & system optimisation

Algorithms for analysis and comparison, developed exploiting CAREL's experience, to facilitate and guide users in optimising energy consumption.



Secure data & browsing

HTTPS protocol for secure data transfer over the web from boss to an external device. Customised operating system to guarantee system reliability.



Intuitive & customisable interface

All the information is available to the user in just a few simple clicks, including system configuration and device management.



boss always in your pocket

Responsive web pages offer the possibility to access all boss pages for both programming and everyday operations using mobile devices. The graphics automatically to the device they are displayed on (computers with different screen resolutions, tablets, smartphones), minimising the need for the user to resize the pages and scroll the contents.

centralised management

boss permits automatic data and alarm synchronisation with RemotePRO, so as to keep the situation on all connected systems under control from just one interface. Centralised system management also increases reliability, through alarm analysis and scheduling of service. It also allows increased energy efficiency by comparing energy consumption and performance between the different sites and identifying possible cost reduction actions.

remote service

Access to typical operating system functions, such as printer driver installation, copying files, etc. is also available via a web interface, another first for a supervisory system. This means that remote service operations can be performed by authorised personnel without needing to travel on site, as is required with other supervisory systems.

Protocols and connectivity

Management of Modbus®, BACnet™ and SNMP protocols for third-party device integration.

Third-party device integration

Management of these three protocols offers high potential for integration with third-party devices. The SNMP manager and BACnet™ Client protocols, available both in MS/TP and IP modes, as well as the Modbus® protocol in RS485 and TCP modes, offer the possibility to interact

with the widest range of devices on the HVAC/R market

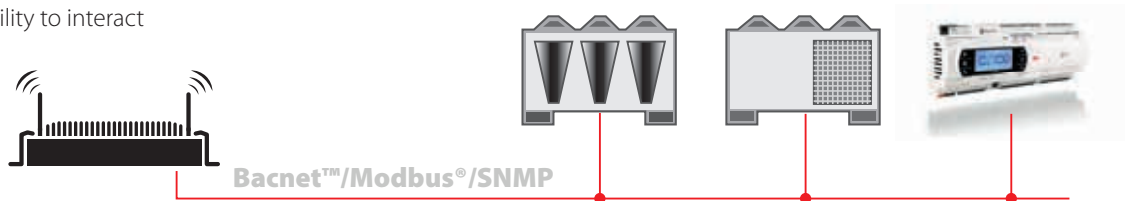

Integration into BMS systems

In addition to Client mode, the SNMP, BACnet™ and Modbus® protocols are also available on boss in Server mode, the BACnet™ protocol is also available on boss in TCP/IP Slave mode, allowing boss to be integrated into a higher-level BMS, sharing the values of interest for overall building management (e.g. unit status, alarm status, ON/OFF controls,...)



Wireless field connectivity

If Modbus RTU devices cannot be connected directly to the boss/boss-mini RS485 network due to installation constraints, these can be integrated into the boss system via its Wi-Fi network, using the WiFi-Modbus gateways (GTW0000WTO). Nonetheless, when a wired connection is available, this is the preferred option due to its reliability.

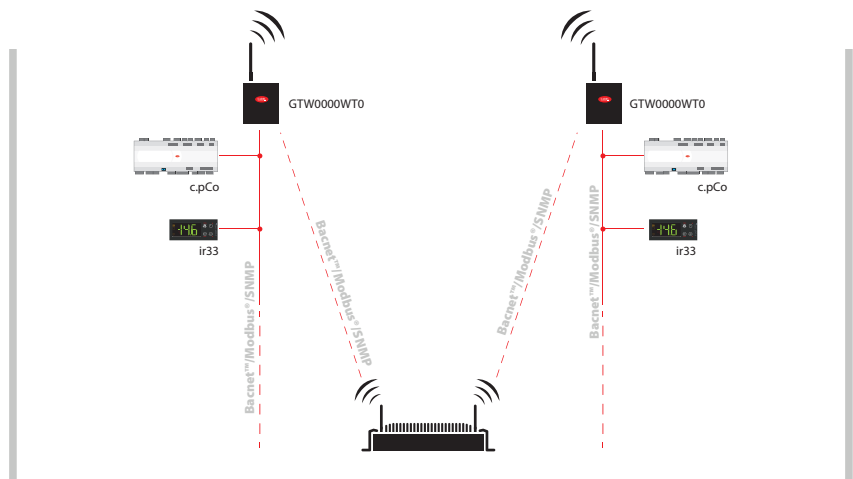

System optimisation functions

KPI Performance index



Allows users to analyse the thermodynamic behaviour of the individual units connected to boss, defining for each, or for groups of units, the minimum and maximum operating thresholds for different variables, creating dashboards to identify which units are operating outside of the optimum conditions.

ENERGY Consumption control and management



Allows users to monitor system energy consumption using graphs and reports, and then implement actions aimed at reducing waste or fixing any faults highlighted.

FLOATING SUCTION Optimised suction pressure

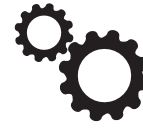

This is used to optimise - in real time - the compressor rack working set point, thus reducing power consumption, by analysing the duty cycle of the connected cabinets. Based on cabinet cooling demand, the plug-in increases or decreases the compressor rack set point.

DEW POINT BROADCAST Share the dew point

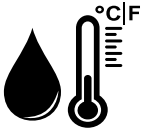

This is used to optimise activation of the anti-sweat heaters on the refrigeration units connected to boss, and consequently reduce power consumption. Connected to a room temperature and humidity probe, boss calculates the dew point in the area and sends the value to the entire network of connected units.

SAFE RESTORE Safe compressor rack restart



This is used to manage safe and optimum compressor rack restart following a fault, in the event of specific compressor rack conditions putting all the connected refrigeration units in safety mode.

PARAMETER CONTROL Parameter control



This is used to monitor all fundamental parameter setting actions on the units connected to the supervisor, for example the set point, performed either using boss or directly on the unit, and then activate restore logic, sending alerts when such occur.

LOGICAL DEVICE/GROUND Logical devices & logical variables



This is used to create new "virtual" variables and devices on boss, and then manage these as if they were real variables or devices, created based on physical variables on the existing network devices.

ALGORITHM PRO Customised logic

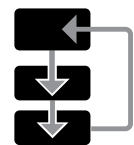

This is used to create additional customised logic using the Java programming language, so as to increase interaction between boss and the connected devices.

HVAC SMART START Optimised air-conditioning ON/OFF



This is used to optimise activation, shutdown and set point change on HVAC units based on the ambient information acquired by boss, such as inside and outside temperature, system inertia, occupancy and air quality.

GEO - LIGHTING Optimised management of lights based on outside light



This is used to optimise switch-on and switch-off of outdoor lights based on site latitude and longitude, thus knowing the time when the sun rises and sets.

SMART HIGH PURGE Optimised free cooling on HVAC units



The air-conditioning system can be started before sunrise using calculations based on system enthalpy (inside and outside), so as to fully exploit free cooling.

USAGE BALANCER Optimised unit capacity management



By reading the room temperature and humidity probes, the average values can be calculated so as to determine the actual capacity required and optimise and balance the operating cycles of the various units installed (**)

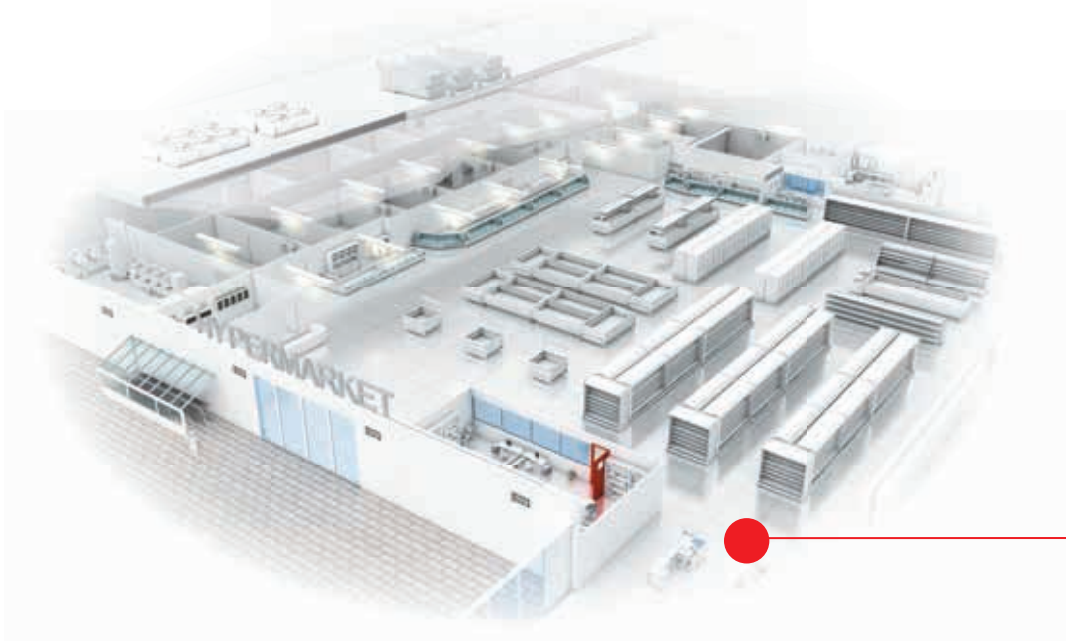

Up to 300 devices

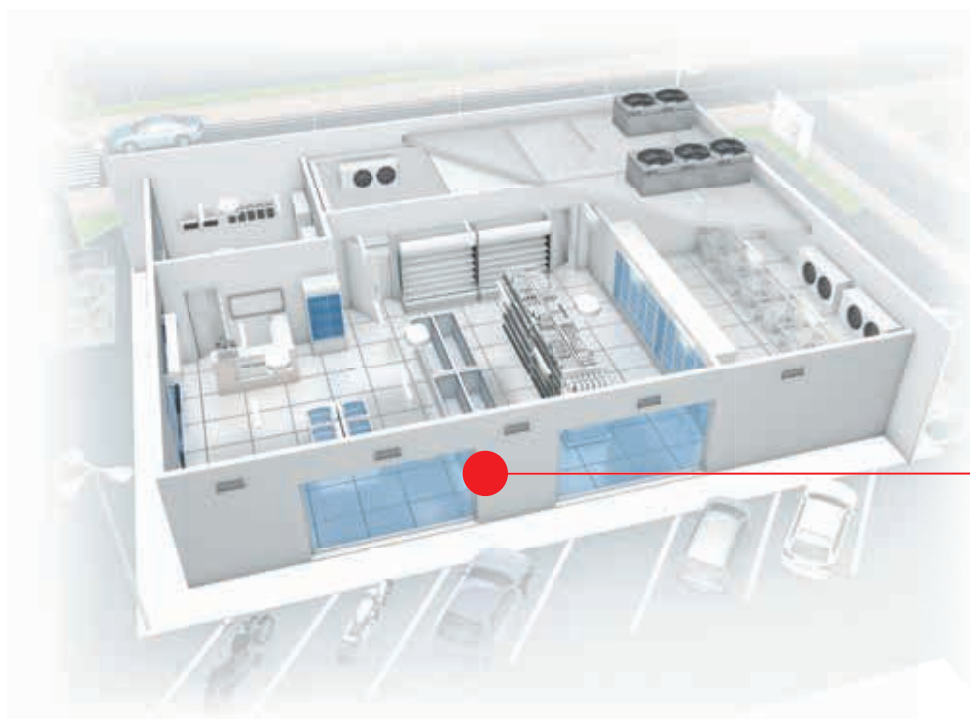

Up to 50 devices

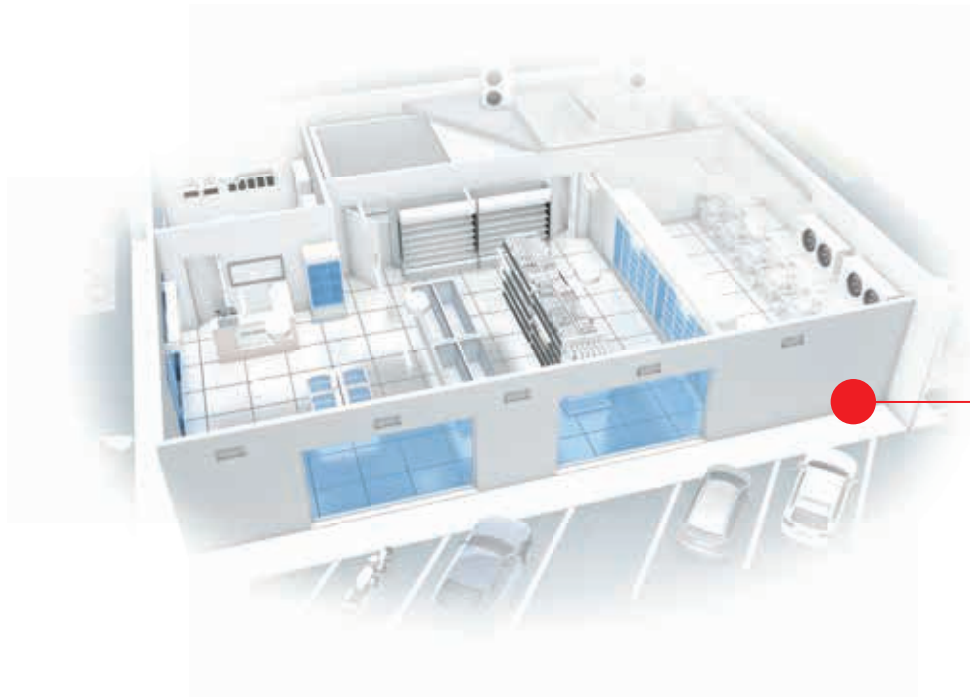

Up to 15 devices

Refrigeration applications

Optimisation of retail systems

In addition to all the functions of a standard supervisor, boss all includes functions for managing refrigeration units and interaction between units, meaning not only is the system controlled, but also optimised in terms of thermodynamic performance and energy consumption.

CAREL's extensive and in-depth knowledge of these applications has also led to the development of user interfaces that are configured based on the type of user (i.e. installer, maintenance personnel, system manager) and the type of use, so as ensure simpler and faster commissioning.



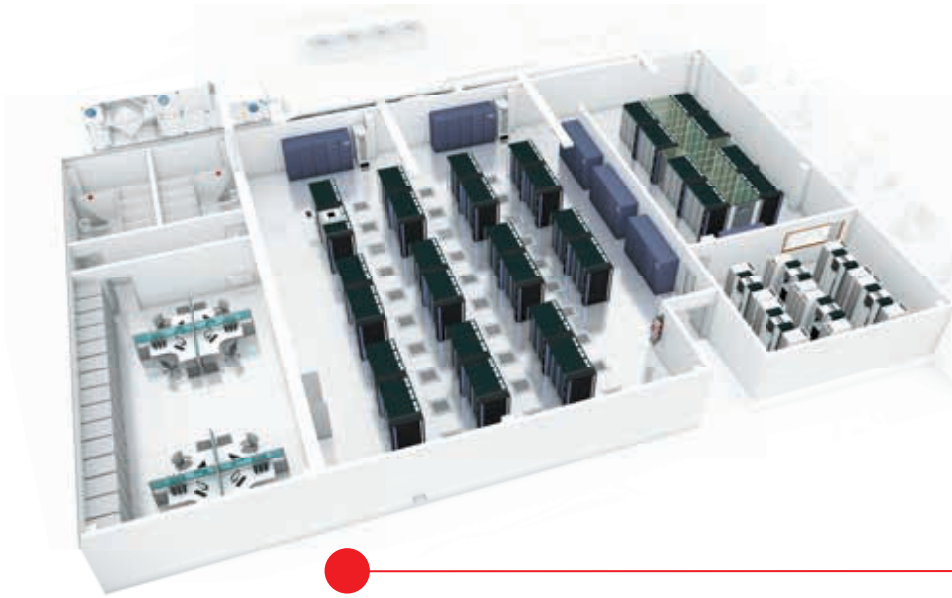

Up to 300 devices

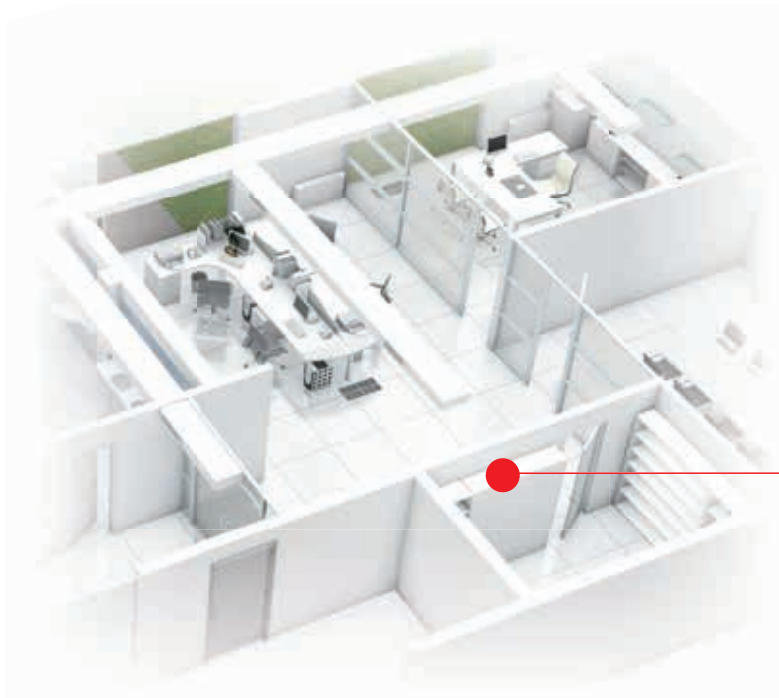

Up to 50 devices

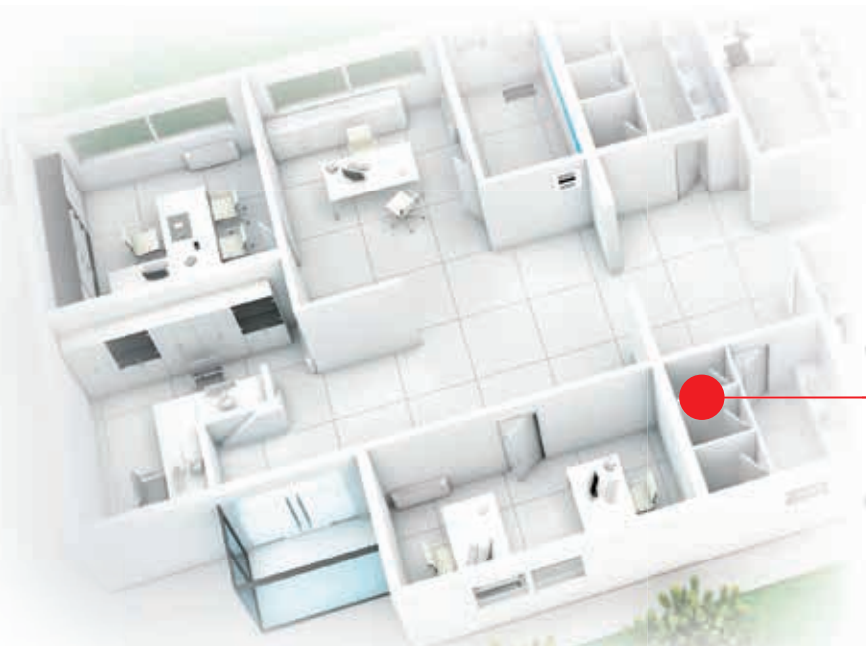

Up to 15 devices

Air-conditioning applications

Optimisation of HVAC systems

The high level of configurability, the possibility to customise maps and the availability of BACnet, SNMP and Modbus standard protocols for communication over the Ethernet network, make boss suitable for numerous HVAC applications.

The supervisor can also interface with other BMS systems, for example in large buildings where the main BMS manages those systems that are not included among the functions handled by boss (security, fire safety, ...).

In this case, boss manages the HVAC systems, providing specific data that create added value for the end customer, and then sharing with the main BMS only the information needed to understand system status.



Customised graphics

User interfaces that can be customised according to the way in which information is managed by different users

With the c.web tool, system status and the main variables relating to each controller can be represented using customised graphics. Indeed c.web offers several powerful features, such as the creation of vectorial images that can adapt to all screen sizes on both desktop and mobile devices without losing resolution, the possibility to develop customised animated widgets in just a few clicks, and the reusability of graphic libraries developed for one project inside another.

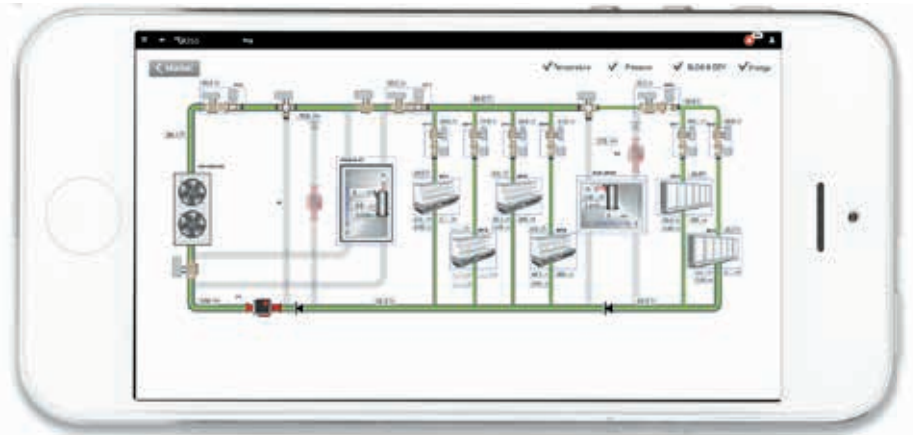

The same hardware is suitable for all applications

No moving mechanical devices for heat dissipation, thus allowing installation in various different equipment rooms and other spaces, allowing installation even in unfavourable technical environments.

boss

boss mini

boss micro



Desktop



Wall-mounted

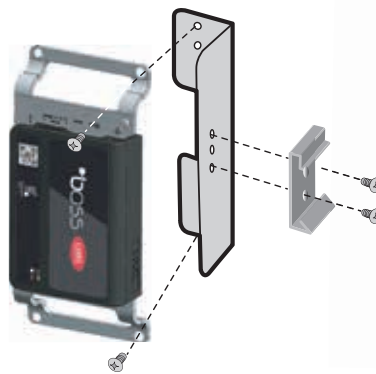

DIN rail

Dimensions and key

boss

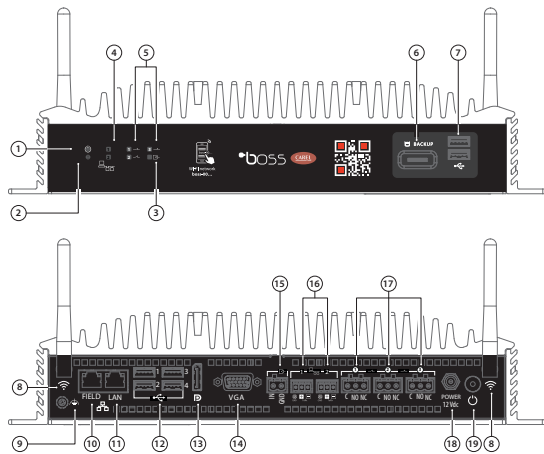
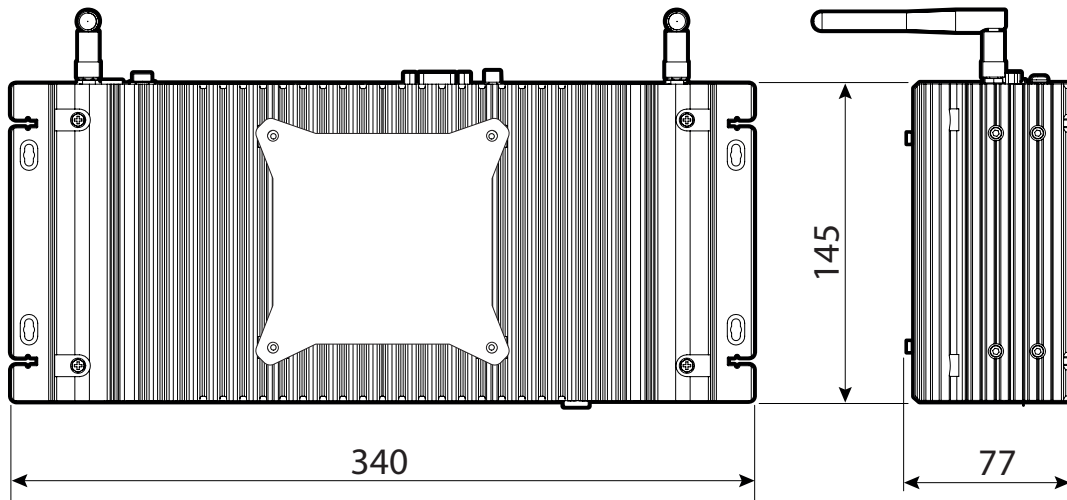

Key

- | | |
|-------------------------------|-----------------------------|
| 1. ON/OFF status LED | 11. LAN Ethernet |
| 2. Alarm status LED | 12. USB ports (1, 2, 3, 4) |
| 3. Digital input status LED | 13. Display port |
| 4. RS485 status LED (1, 2) | 14. VGA port |
| 5. relay status LED (1, 2, 3) | 15. Digital inputs |
| 6. μ SD port | 16. RS485 line (1, 2) |
| 7. USB ports (1, 2) | 17. Relay outputs (1, 2, 3) |
| 8. Two antennas | 18. Power supply |
| 9. Earth | 19. ON/OFF button |
| 10. FIELD Ethernet | |

boss mini

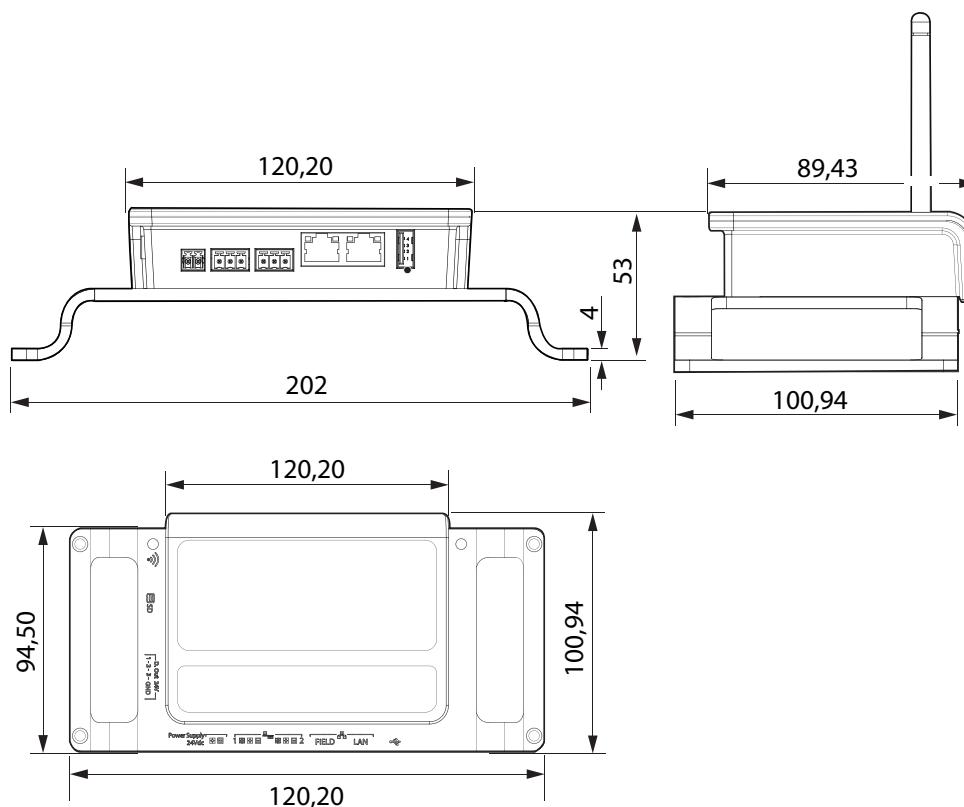

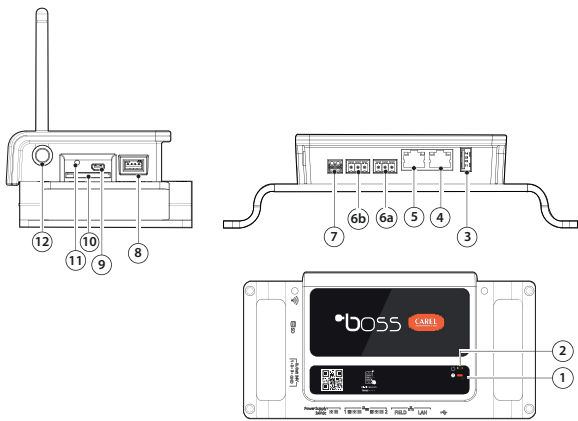

Key

- | | |
|------------------------------------|-------------------------------------|
| 1. Alarm status LED | 7. Power supply |
| 2. ON/OFF status LED | 8. Digital outputs +24Vdc (1, 2, 3) |
| 3. USB host port | 9. μ HDMI port |
| 4. LAN Ethernet | 10. SD port |
| 5. FIELD Ethernet | 11. Temporary IP enable button |
| 6a: RS485 Serial non opto-isolated | 12. wi-fi antenna (*) |
| 6b: RS485 Serial opto-isolated | |

(*) only in the models prepared

boss micro

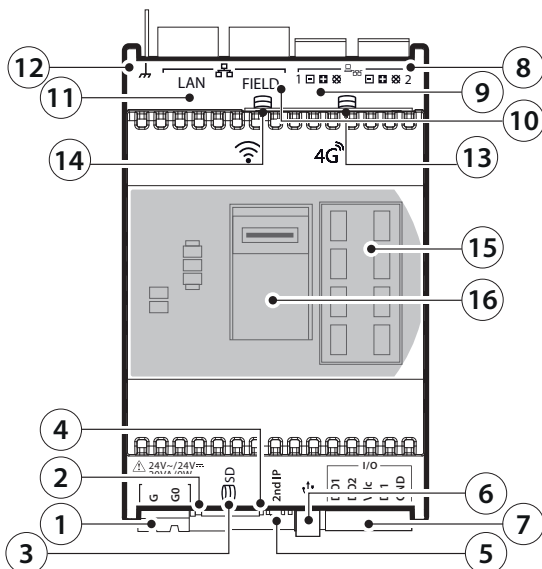
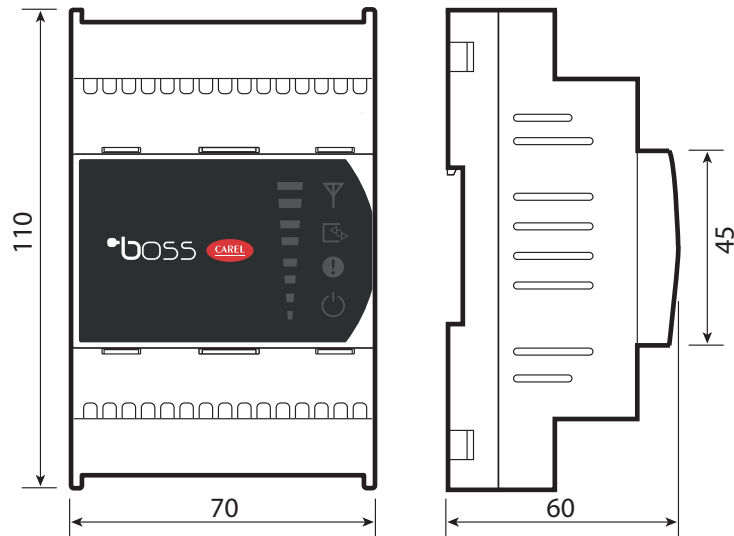

Key

- | |
|---|
| 1. Power supply connector [G(+), G0(-)] 24Vac/Vdc |
| 2. LED power-on (green) |
| 3. uSD-card reader for backup/recovery function |
| 4. Ethernet signal Led |
| 5. Reset button and Enable temporary IP |
| 6. Standard HOST USB port, type A connector, for upgrading FW and downloading log files |
| 7. External relay command and free contact digital input |
| 8. RS485 serial opto-isolated |
| 9. RS485 serial not opto-isolated |
| 10. FIELD Ethernet |
| 11. LAN Ethernet |
| 12. Faston for shield ethernet port earth connection |
| 13. 2G/3G/4G Antenna connector (*) |
| 14. Wi-Fi Antenna connector (*) |
| 15. LED synoptic |
| 16. SIM connector (*) |
- (*) depending on the model

Code produit

P/N	Description	Maximum number of devices controlled/ variables logged
BMEST**RS0	boss-mini Monitoring System Standard Capacity - Headless	30/300
BMEST**RE0	boss-mini Monitoring System Standard Capacity - Headless	50/500
BMEST**LE0	boss-mini Monitoring System Extended Capacity - Wi-Fi / Video Output	50/500
BMHST**XS0	boss Monitoring System Standard Capacity	100/1500
BMHST**XE0	boss Monitoring System Extended Capacity	300/3500
BMBST00RP0	Boss-Micro Monitoring System Wired	15/150
BMBST00FP0	Boss-Micro Monitoring System Wireless Wi-Fi	15/150
BMBST00GP0	Boss-Micro Monitoring System Wireless 4G EMEA	15/150
BMBST00CP0	Boss-Micro Monitoring System Wireless 4G China	15/150
BMBST00BP0	Boss-Micro Monitoring System Wireless 4G Australia & South America	15/150
BMBST00MP0	Boss-Micro Monitoring System Wireless Wi-Fi and 4G EMEA	15/150
BMBST00NP0	Boss-Micro Monitoring System Wireless Wi-Fi and 4G China	15/150
BMBST00DP0	Boss-Micro Monitoring System Wireless Wi-Fi and 4G Australia & South America	15/150

Code accessoires

P/N	Description
PGTA00TRX0	Power supply for boss-micro DIN rail - 110-230 Vac / 24 Vdc
BMBSTEWA00	3 m extension cable for remote Wi-Fi antenna
BMBSTEGA00	3 m extension cable for remote 4G antenna
BMEST01P00	Credit for 1 Boss-mini Plug-in
BMEST03P00	Credit for 3 Boss-mini Plug-ins
BMESTDNA0K	DIN rail mounting bracket kit for boss-mini
BMESTPWA00	Power supply for boss-mini / boss micro multi-country plug - 110-230 Vac / 24 Vdc
PGTA00TRF0	Power supply for boss-mini DIN rail - 110-230 Vac / 24 Vdc
BMESTRLA00	Boss-mini / boss-micro relay expansion module
BMHST01P00	Credit for 1 Boss Plug-In
BMHST03P00	Credit for 3 Boss Plug-In
BMHST05P00	Credit for 5 Boss Plug-In
BMHSTDNA0K	DIN rail mounting bracket kit for boss
BMHSTMDA00	UMTS modem for sending SMS on boss / boss-mini

Functionality

Funzionalità		boss (BMHS****0)	boss-mini (BMEST****0)	boss-micro (BMBST****0)
HARDWARE	Integrated Wi-Fi connectivity to mobile devices	YES	YES (depending on the model)	
	Video output	VGA/Display Port	micro HDMI (depending on the model)	NO
	Double Ethernet port (separation of LAN / Internet connections)	Yes		
	Integrated backup memory expansion	Yes (uSD)	YES already inserted in BMEST**LE0 models	Yes (uSD)
	Embedded RS485 ports	2 opto-isolated	1 opto-isolated 1 not opto-isolated	1 opto-isolated 1 not opto-isolated
	Integrated digital input	Yes	NO	Yes
	Temporary IP address / reset button	NO	Yes	Yes
	Integrated digital outputs	3 relays with changeover contacts N.O./N.C.	3 voltage outputs 24 Vdc	2 voltage outputs 24 Vdc
	USB host ports	6 (2 front and 4 rear)	1	1
	Status LEDs	8 front (status and I/O)	2 front (status)	8 front (status, I/O, wireless signal)
	Possibility to connect external USB peripherals	Yes		NO (not necessary)
	Power supply	100-240 V ~ 50-60Hz (power supply module input)	24 Vdc	24 Vac/Vdc
SOFTWARE	Minimum variable sampling time	5 sec	30 sec	30 sec
	Maximum number of devices and variables that can be logged	300/3500	50/500	15/150
	All pages responsive	Yes		
	Graphic customisation with HTML5 / SVG technology (using c.web tool)	Yes		
	Web connection with encrypted protocol (HTTPS)	Yes		
	Third-party device integration	Yes (using device creator tool)		
	Modbus TCP/IP / RTU client protocol	Yes		
	Data synchronisation with RemotePRO	Yes (cost 1 plug-in credit)		
	BACnet client Protocol (MSTP and TCP/IP)	Yes (cost 1 plug-in credit)		
	BACnet server Protocol (TCP/IP)	Yes (cost 1 plug-in credit)		
	Modbus RTU or TCP/IP server protocol	Yes (cost 1 plug-in credit)		
	XML server protocol	Yes (cost 1 plug-in credit)		
	XML push protocol	Yes		
	SNMP Manager protocol	Yes		
	MQTT protocol:	Yes		
	SNMP Agent protocol	Yes		
	Custom logic development by customer	Yes (cost 1 plug-in credit)		
	Logical devices / logical variables	Yes (cost 1 plug-in credit)		
	Performance index (cost 1 plug-in credit)	Yes	Yes	NO
	Energy consumption control and management	Yes (cost 1 plug-in credit)		
	Suction pressure optimisation	Yes (cost 1 plug-in credit)		
	Parameter control (cost 1 plug-in credit)	Yes	Yes	NO
	Compressor rack safe restart (cost 1 plug-in credit)	Yes	Yes	NO
	Dew point broadcast	Yes (cost 1 plug-in credit)		
	HVAC unit free cooling optimisation	Yes (cost 1 plug-in credit)		
	Air-conditioning on/off optimisation	Yes (cost 1 plug-in credit)		
	Optimised lighting management based on outside light	Yes (cost 1 plug-in credit)		
	Optimised unit capacity management (cost 1 plug-in credit)	Yes		
	Maximum number of extra functions that can be enabled (plug-ins)	20	4	2
	Send email	Yes		
	Send instant messages (Telegram)	Yes		
	Send SMS	Yes		
	Manual and/or automatic reports in CSV and PDF format	Yes		
Scheduled activity management	Yes			
Languages available	Italian, English, German, French, Spanish, Portuguese, Russian, Turkish, Chinese, Polish, Danish, Swedish, Japanese, Hungarian, Dutch, Korean			

Headquarters

CAREL INDUSTRIES HQs
Via dell'Industria, 11
35020 Brugine - Padova (Italy)
carel@carel.com



HygroMatik GmbH

Lise-Meitner-Straße 3
24558 Henstedt-Ulzburg - Germany
hy@hygromatik.de

RECUPERATOR

Via Valfurva 13
20027 Rescaldina (MI), Italy
customercare@recuperator.eu

For more information

CAREL Asia
www.carel.hk

CAREL Australia
www.carel.com.au

CAREL Central & Southern Europe
www.carel.com

CAREL Czech & Slovakia
CAREL spol. s.r.o.
www.carel.cz

CAREL Deutschland
www.carel.de

CAREL China
www.carel-china.com

CAREL France
www.carelfrence.fr

CAREL Korea
www.carel.kr

CAREL Ibérica
www.carel.es

CAREL Ireland
FarrahVale Controls & Electronics Ltd.
www.carel.ie

CAREL Italy
www.carel.it

CAREL India
www.carel.in

CAREL Japan
www.carel-japan.com

CAREL Mexicana
www.carel.mx

CAREL Middle East
www.carel.ae

CAREL Nordic
www.carelnordic.se

CAREL Poland
Alfaco Polska Sp z o.o.
www.carel.pl

CAREL Russia
www.carelrussia.com

CAREL South Africa
www.carel.com

CAREL Sud America
www.carel.com.br

CAREL Thailand
www.carel.co.th

CAREL Turkey
CFM Sogutma ve Otomasyon San. Tic. Ltd.
www.carel.com.tr

CAREL U.K.
www.careluk.com

CAREL U.S.A.
www.carelusa.com

CAREL Ukraina
www.carel.ua

CAREL Canada
Enersol Inc.
www.enersol.ca

CAREL

To the best of CAREL INDUSTRIES S.p.A. knowledge and belief, the information contained herein is accurate and reliable as of the date of publication. However, CAREL INDUSTRIES S.p.A. does not assume any liability whatsoever for the accuracy and completeness of the information presented without guarantee or responsibility of any kind and makes no representation or warranty, either expressed or implied. A number of factors may affect the performance of any products used in conjunction with user's materials all of which must be taken into account by the user in producing or using the products. The user should not assume that all necessary data for the proper evaluation of these products are contained herein and is responsible for the appropriate, safe and legal use, processing and handling of CAREL's products. The information provided herein does not relieve the user from the responsibility of carrying out its own tests, and the user assumes all risks and liabilities related to the use of the products and/or information contained herein. © 2021 CAREL INDUSTRIES S.p.A. All rights reserved.