

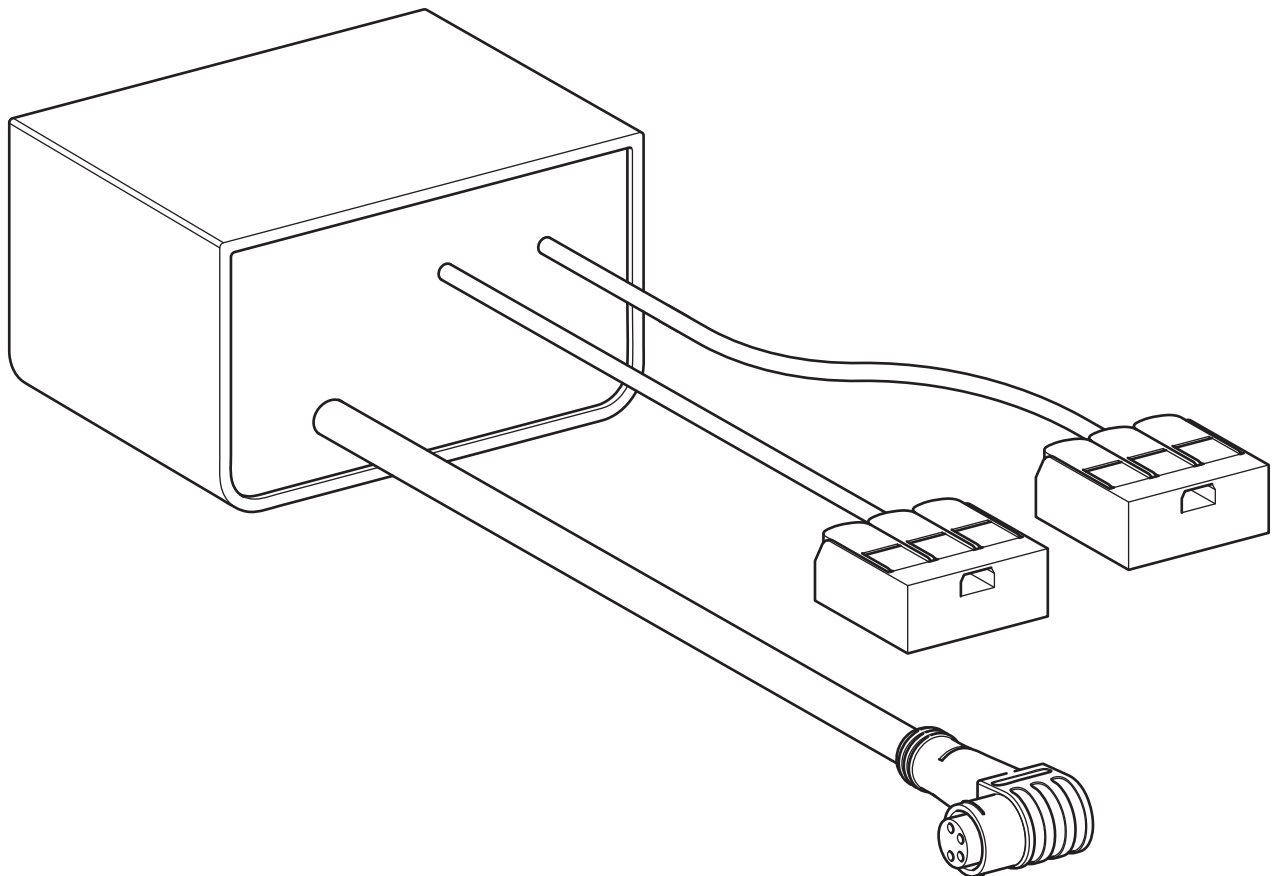

## Geberit DuoFresh Power Module

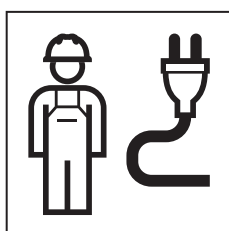

# INSTALLATION MANUAL



All electrical installation work needs to be carried out by a licenced electrician.

Published 28/07/2021



## Geberit DuoFresh Power Module



---

### **WARNING**

#### **Electric shock**

Incorrect installation can lead to death or serious injuries.

- ▶ Switch off all mains circuits before accessing the terminals.
- ▶ Install the unit with an all-pole disconnecting device with a contact opening that complies with the conditions of overvoltage category III for full disconnection.
- ▶ The unit should only be connected by an electrically skilled person.

### **Geberit DuoFresh Power Module**

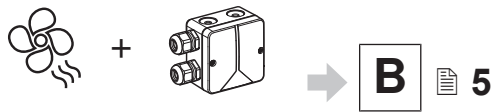
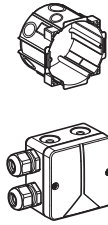
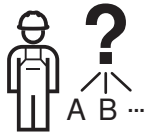

# **A**

#### **✓ Flush mount install**

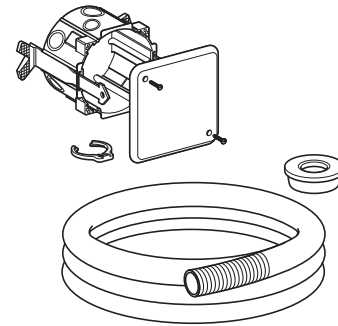

Flush mount install set is included in the DuoFresh Odour Extraction System.

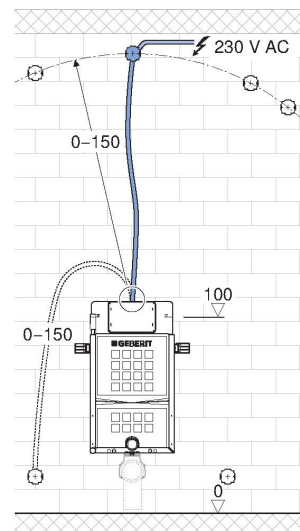
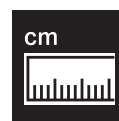
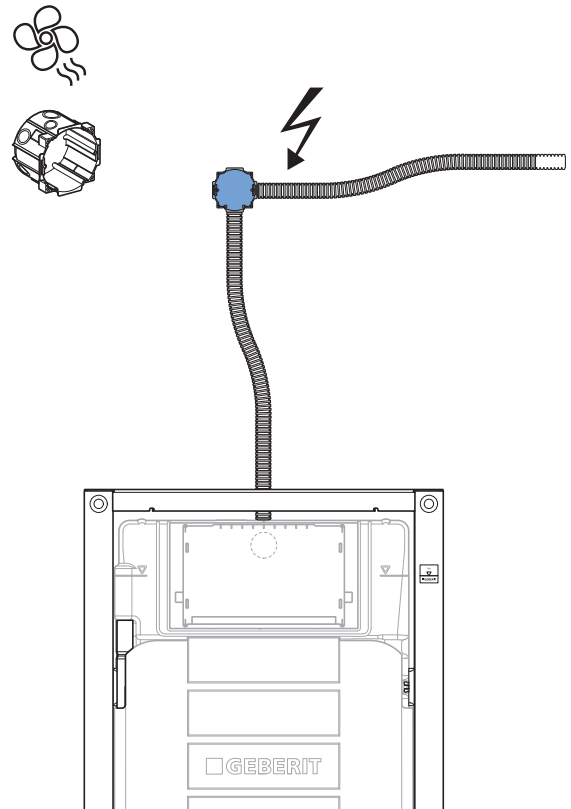

### **Geberit DuoFresh Power Module**

**1**

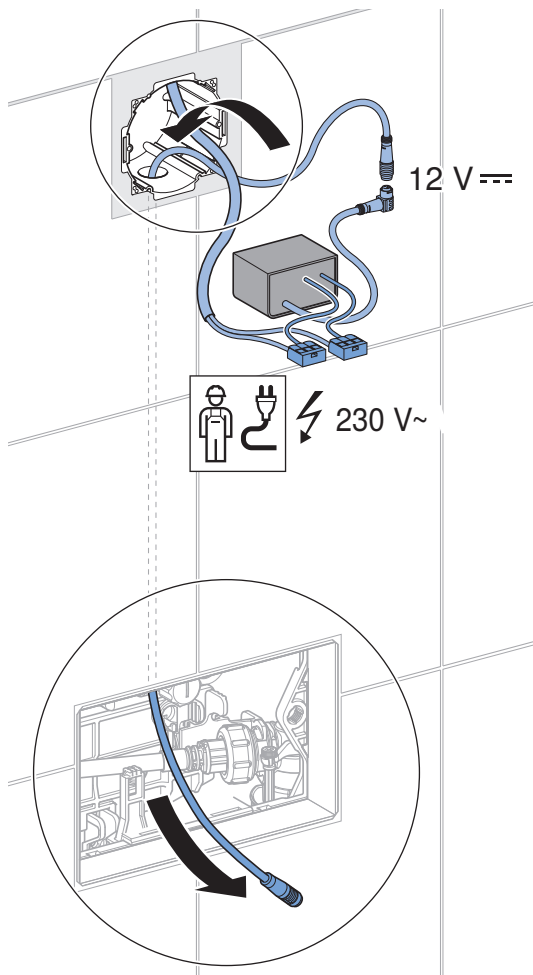

**2**

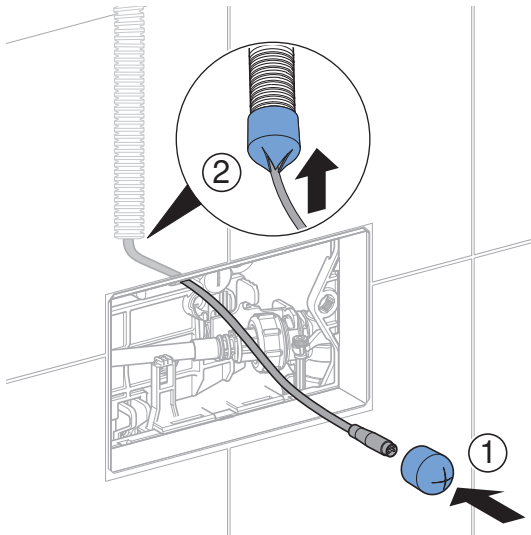

**3**

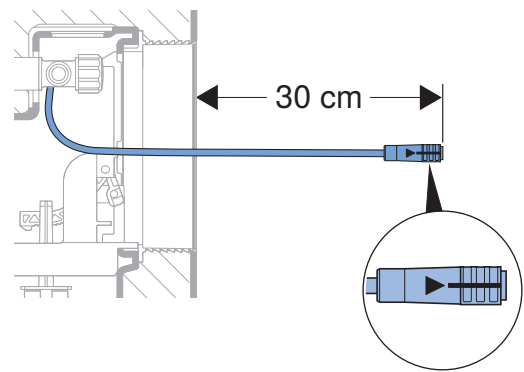

For detailed installation on flush mount install, please scan the QR code below:



### **Geberit DuoFresh Power Module**

# **B**

#### **✓ Remote install**

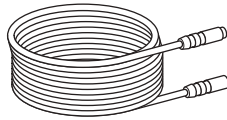
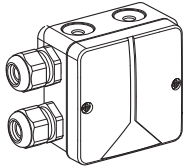

Remote  
installation kit

For mounting power supply unit in remote  
location (e.g. ceiling or vanity unit):

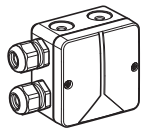

## **1**

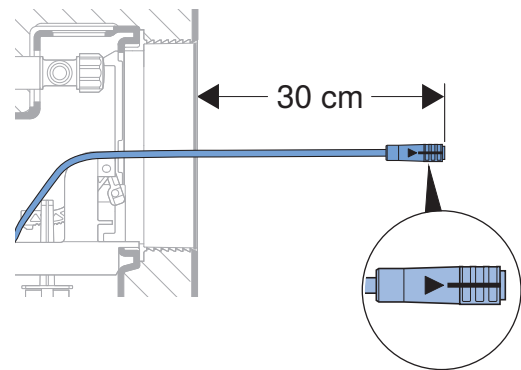

## **2**

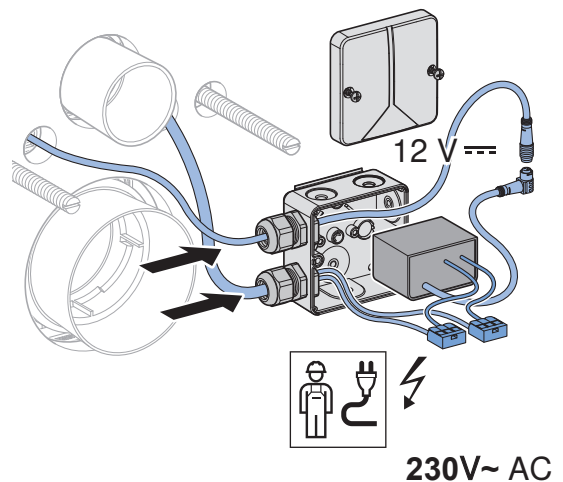

For detailed installation on  
remote install, please scan  
the QR code below:



Geberit International AG  
Schachenstrasse 77, CH-8645 Jona  
documentation@geberit.com  
www.geberit.com

