



Backflow Prevention

700 Series Dual Check Valve 15-40mm

Installation, Testing & Maintenance Instructions

- Installation of backflow prevention valves must be by a licenced plumber.
- Commissioning and testing of devices must only be performed by a qualified, licenced tester.

CAUTION: Installation of Model 700 must be performed by qualified, licensed personnel. Faulty installation could result in an improperly functioning device.

The licenced installer of this valve should ensure that this backflow prevention valve is suitable for the intended installation and complies with the requirements of A.S. 3500. 1 Section 4.

- Designed for installation on water lines to protect against both backsiphonage and backpressure of polluted water into the water supply.
- Assembly shall provide protection where a potential low hazard exists.
- If potential health hazard is high, use a ZURN WILKINS Model 375 Reduced Pressure Principle Backflow Preventor.

Proper performance is dependent upon following these installation instructions and prevailing governmental and industry standards and codes. Failure to do so, according to ZURN WILKINS Limited Warranty "...releases ZURN WILKINS of any liability that it might otherwise have with respect to that device." Such failure could also result in an improperly functioning device.

1. Before installing a ZURN WILKINS Model 700 Dual Check Valve, flush the pipe lines thoroughly to remove all debris, chips and other foreign matter. If required, a strainer should be placed upstream of the valve to prevent fouling of the checks.
2. The valve is not position sensitive. It may be installed horizontally or vertically.
3. Install the valve in a location that will be easy to reach for future maintenance.
4. Use caution when soldering near the valve. Remove check assemblies if excessive heat will be applied to the valve.
5. The valve must be protected from freezing.

NOTICE: Annual inspection and maintenance is required of all plumbing system components. To ensure proper performance and maximum life, this product must be subject to regular inspection, testing and cleaning.

INSTALLATION

Local codes shall govern installation requirements. To be installed in accordance with the manufacturers' instructions and the latest edition of the Plumbing Code of Australia and/or AS/NZS 3500. Unless otherwise specified, the assembly shall be mounted at a minimum of 12" (305mm) and a maximum of 30" (762mm) above adequate drains with sufficient side clearance for testing and maintenance. The installation shall be made so that no part of the unit can be submerged.

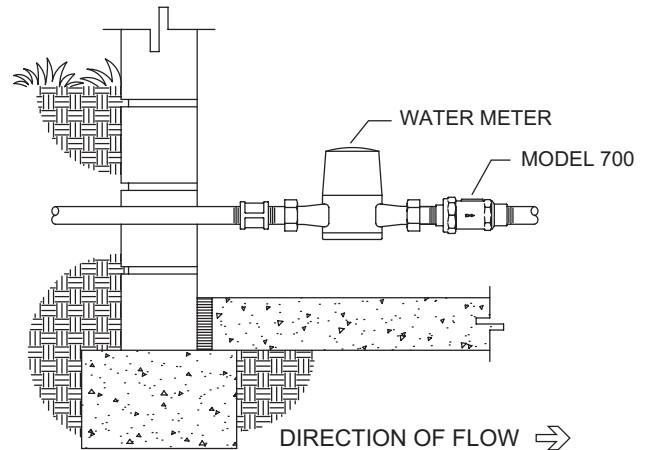

HORIZONTAL INSTALLATION

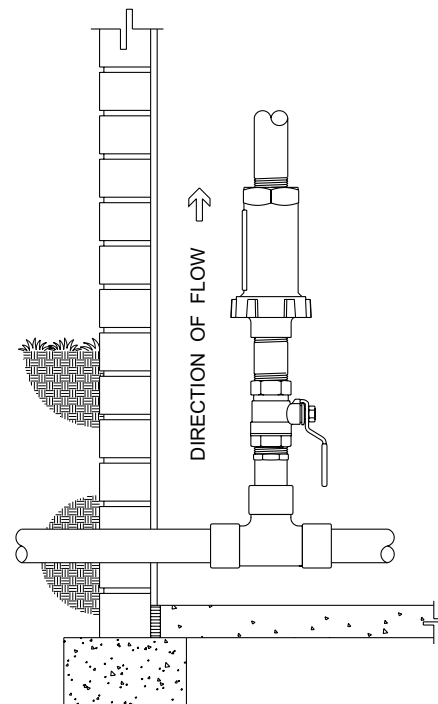

VERTICAL INSTALLATION

MAINTENANCE INSTRUCTIONS

Servicing the Model 700 involves replacing the check assemblies.

1. Turn off inlet water supply.
2. Loosen union nut.
3. Remove valve from the line.
4. Note the direction of check assemblies and o-ring locations.
Push check assemblies out of valve.
5. Clean inside of valve body.
6. Replace parts in reverse order of removal. Make sure check assemblies are installed in correct direction.
7. Reinstall valve and turn on water.

FLOW CHARACTERISTICS

PERFORMANCE CHARACTERISTICS

SPECIFICATIONS

Maximum working water pressure 1200 kPa
Maximum working water temperature 82°C

MODEL 700 15mm & 20mm (STANDARD & METRIC)

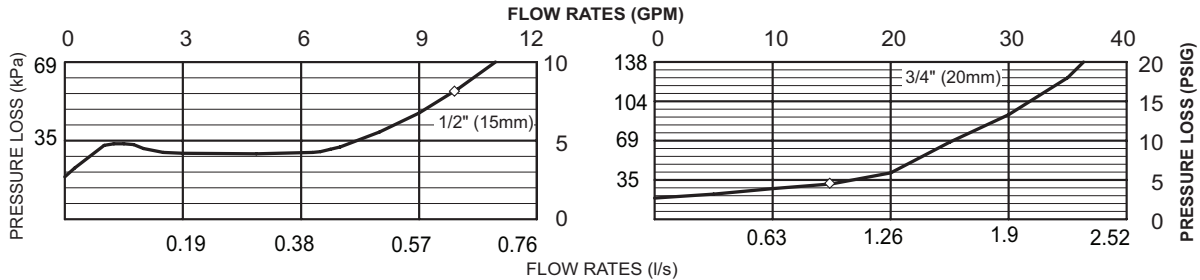

MODEL 700 25mm, 32mm, 40mm (STANDARD & METRIC)

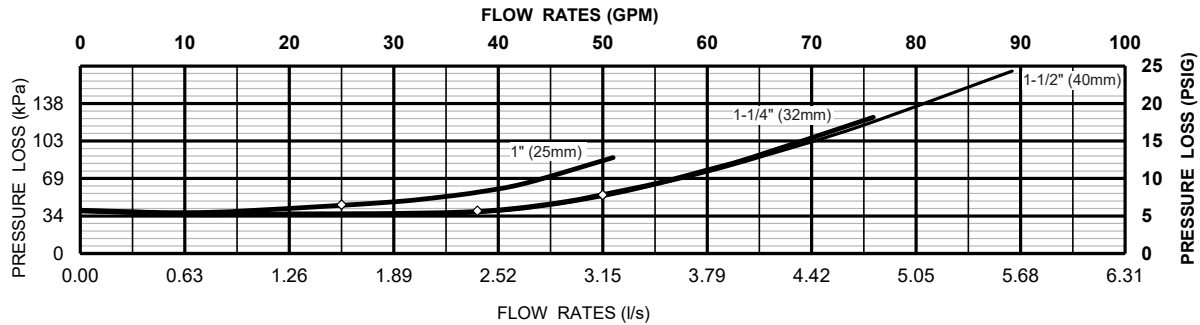

COMPONENTS

MODEL 700 15mm, 20mm, 25mm

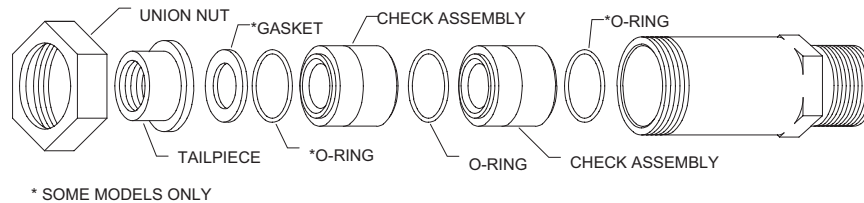

MODEL 700 32mm, 40mm

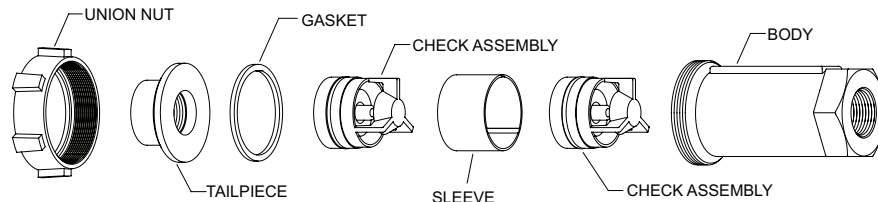

Proper performance is dependent upon licenced, qualified personnel performing regular, periodic testing according to ZURN WILKINS' specifications and prevailing governmental and industry standards and codes and upon following these installation instructions. Failure to do so releases ZURN WILKINS of any liability that it might otherwise have with respect to that device. Such failure could also result in an improperly functioning device.