



commercial **anti-vandal** tapware

ROBUST, EASY TO CLEAN VANDAL
RESISTANCE FOR COMMERCIAL,
INSTITUTIONAL AND PUBLIC USE

- CS (Concealed Spindle) Series
- Plaza Series
- School Pattern Series
- Traditional Series
- Detention Series
- Key Operated
and Rough Brass Tapware

cs series

The ergonomically designed CS (Concealed Spindle) Series handle features a dress skirt that conceals the anti-vandal handle fixing and the spindle. An internal locking ring secures the handle to the spindle, which may only be released by using the key provided.

ENWARE'S PROVEN VANDAL RESISTANT CS RANGE FEATURES:

- Vandal-resistant internal locking ring secures the handle – can only be released by the key
- Highest quality construction in dezincification resistant brass
- Supplied complete with handles, buttons and outlets
- Choice of attractive finishes in standard heavy duty bright chrome, plus satin chrome and powder coated options.



Enware Tapware is manufactured to the exacting WaterMark standard AS/NZS3718 and AS4020.

water efficiency

ENWARE AUSTRALIA HAS USED THE PERFORMANCE CRITERIA OF:

- AS/NZS6400 – Water Efficient Products – Rating and Labelling
- AS/NZS3718 – Tapware
- AS/NZS3662 – Showers

as the benchmark for our water efficient product performance.

The pressure compensating flow control technology included in Enware's product ensures a more consistent flow rate delivery across the pressure band from 150kPa–500kPa.

TAPWARE



WELS 3 Star (8lpm) water efficiency rating supplied as standard. For 5 Star (6lpm) request when ordering.

SHOWERS



Fixed showers are 3 Star (8lpm) water efficiency rating.

Hand held showers are 3 Star (8.5lpm) water efficiency rating.

options

FINISHES:

- Bright chrome is standard
- Optional satin chrome or epoxy powder coating

INDICATORS:

- CS Series: Supplied standard with Red or Blue buttons
- Yellow for warm water is also available; specify your requirements when ordering

VALVING OPTIONS:

- Jumper Valve — **CS**
- ¼ turn Ceramic Disc — **CSQ**
- ½ turn Ceramic Disc — **CSH**
- ¾ turn Ceramic Disc — **CST**

SPOUT OPTIONS:

- Custom sizing and shapes are available; please refer to Outlets on Page 208

OUTLET OPTIONS:

- Aerators are supplied standard on basin and sink mixing sets
- Laminar flow is available, please refer to Enware's Outlets brochure for further details

technical information

A

	CERAMIC DISC	JUMPER VALVE
Minimum–Maximum Working Pressure (AS/NZS 3500)*	50–500kPa	30–500kPa
Maximum Static Pressure	800kPa	1200kPa
Maximum Working Temperature**	85°C	95°C

*Enware products are to be installed in accordance with AS/NZS3500. **Heated Water Supply AS/NZS 3500.4: For all sanitary fixtures used primarily for personal hygiene purposes are to deliver heated water not exceeding: **a) 45°C** for early childhood centres, primary and secondary schools and nursing homes or similar facilities for young, aged care, sick people with disabilities **b) 50°C** in all other buildings.

wall depth adjustments

Enware's recess tapware have adjustments for installation flexibility – Standard spindle adjustment is shown here. Extended spindles are available in 15, 20, 25, 30 and 40mm.

JUMPER VALVE

From 6mm in front of finished wall to 15mm behind finished wall.

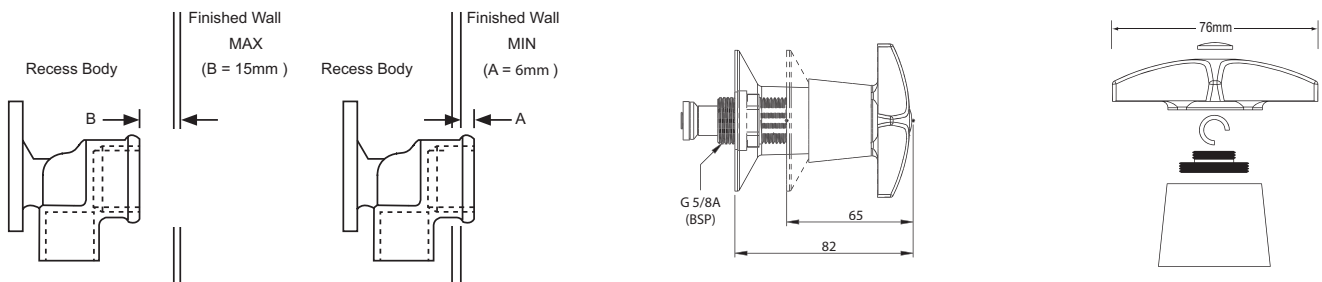

CERAMIC DISC

From 5mm in front of finished wall to 15mm behind finished wall.

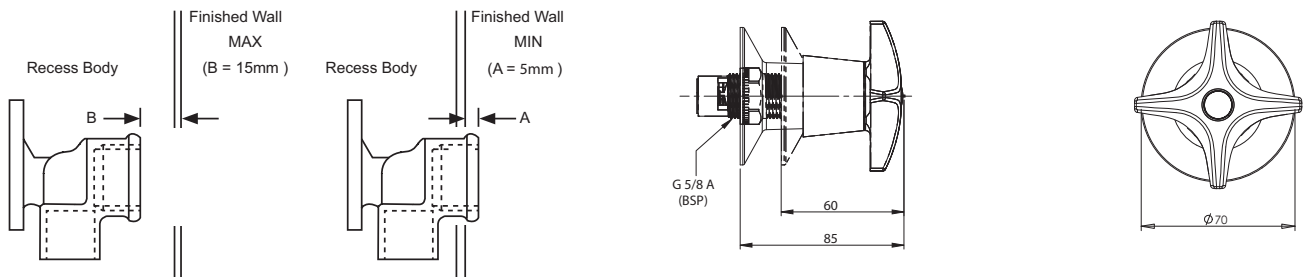

CS Recess Adaptor

CS308	Jumper Valve Standard
CSH308	1/2 Turn Ceramic Disc Standard
CSQ308	1/4 Turn Ceramic Disc Standard
CST308	3/4 Turn Ceramic Disc Standard

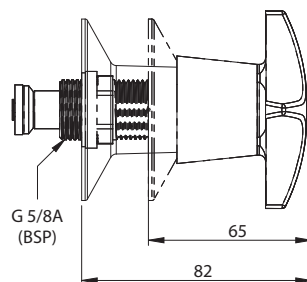

CS Recess Adaptor 20mm Fullway

CS348	Jumper Valve
-------	--------------

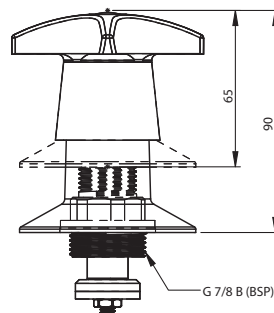

CS Forward Bowl Sink Set With SP010 Spout

CS307	Jumper Valve
CSH307	1/2 Turn Ceramic Disc
CSQ307	1/4 Turn Ceramic Disc
CST307	3/4 Turn Ceramic Disc

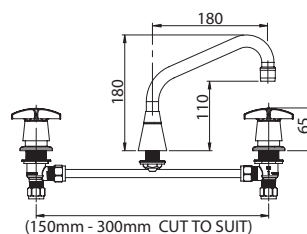

CS Recess Set With SP110 Swivel Aerated Spout

CS315	Jumper Valve
CSH315	1/2 Turn Ceramic Disc
CSQ315	1/4 Turn Ceramic Disc
CSQ315S	1/4 Turn Ceramic Disc (S/Spec—SP126)
CSQ315SS	1/4 Turn Ceramic Disc (S/Spec—SP026)
CST315	3/4 Turn Ceramic Disc

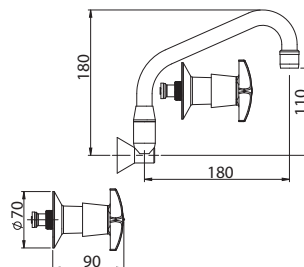

CS Dual Mixer With SP020 Spout

CS370	Jumper Valve
CSH370	1/2 Turn Ceramic Disc
CSQ370	1/4 Turn Ceramic Disc
CST370	3/4 Turn Ceramic Disc

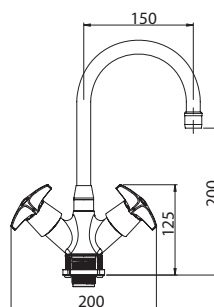

CS Basin Set With SP001 Spout

CS306	Jumper Valve
CSH306	1/2 Turn Ceramic Disc
CSQ306	1/4 Turn Ceramic Disc
CSQ306S	1/4 Turn Ceramic Disc (S/Spec—SP003 Spout)
CST306	3/4 Turn Ceramic Disc

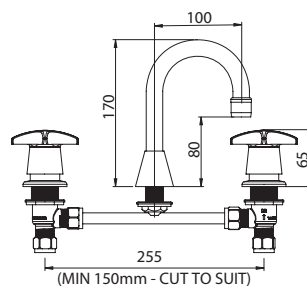

CS Basin Set Cold Only With SP001 Spout

CS306H	Half Set Jumper Valve
CSQ306H	Half Set 1/4 Turn Ceramic Disc
CSQ306SH	Half Set 1/4 Turn Ceramic Disc (Qld S/Spec—SP003)

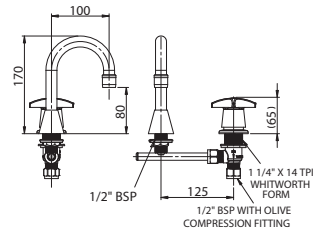

CS Pillar Tap 15mm

CS302	Jumper Valve
CSH302	1/2 Turn Ceramic Disc
CSQ302	1/4 Turn Ceramic Disc
CST302	3/4 Turn Ceramic Disc

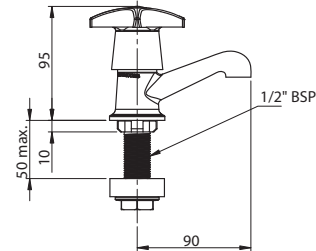

CS Pillar Tap

CS327	Aerated Outlet — Jumper Valve
CSQ327	Aerated Outlet — 1/4 Turn Ceramic Disc

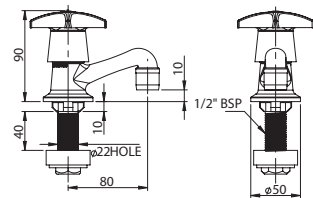

CS Pillar Tap 15mm

CS337	Ablution Outlet — Jumper Valve
CSQ337	Ablution Outlet — 1/4 Turn Ceramic Disc

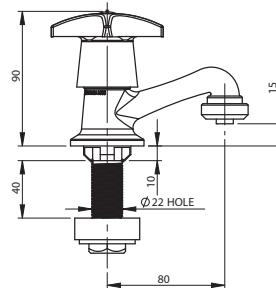

CS Bib Tap FI 15mm

CS301F	Jumper Valve
CSH301F	1/2 Turn Ceramic Disc
CSQ301F	1/4 Turn Ceramic Disc
CST301F	3/4 Turn Ceramic Disc

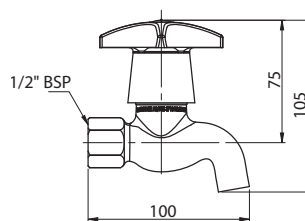

CS Bib Tap MI 15mm

CS301M	Jumper Valve
CSH301M	1/2 Turn Ceramic Disc
CSQ301M	1/4 Turn Ceramic Disc
CST301M	3/4 Turn Ceramic Disc

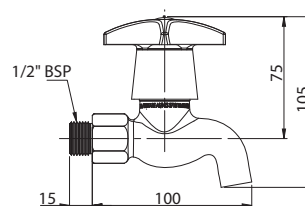

CS Bib Tap FI 15mm

CS312F

Ablution Outlet — Jumper Valve

CSQ312F

Ablution Outlet — 1/4 Turn Ceramic Disc

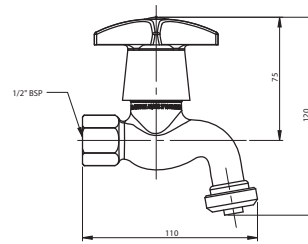

CS Bib Tap FI 15mm

CS325F

Aerated Outlet — Jumper Valve

CSQ325F

Aerated Outlet — 1/4 Turn Ceramic Disc

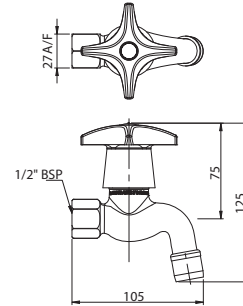

CS Bib Tap MI 15mm

CS312M

Ablution Outlet — Jumper Valve

CSQ312M

Ablution Outlet — 1/4 Turn Ceramic Disc

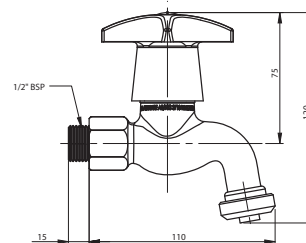

CS Bib Tap MI 15mm

CS325M

Jumper Valve

CSQ325M

1/4 Turn Ceramic Disc

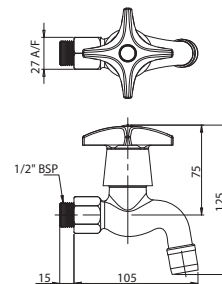

CS Bib Tap FI 50mm Extended

CS321F

Jumper Valve

CSQ321F

1/4 Turn Ceramic Disc

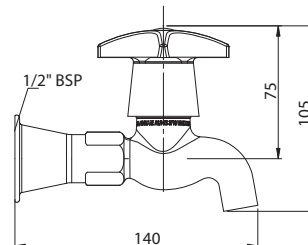

CS Bib Tap FI 50mm Extended

CS322F

Aerated Outlet — Jumper Valve

CSQ322F

Aerated Outlet — 1/4 Turn Ceramic Disc

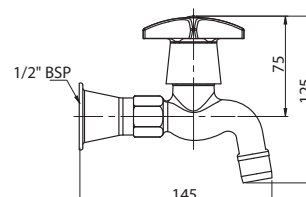

CS Bib Tap FI 50mm

CS333F

Ablution Outlet — Jumper Valve

CSQ333F

Ablution Outlet — 1/4 Turn Ceramic Disc

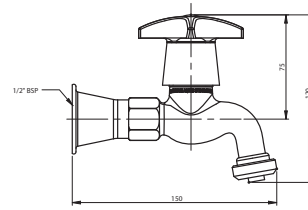

CS Recess Set With SP201 Fixed Aerated Spout

CS314

Jumper Valve

CSH314

1/2 Turn Ceramic Disc

CSQ314

1/4 Turn Ceramic Disc

CST314

3/4 Turn Ceramic Disc

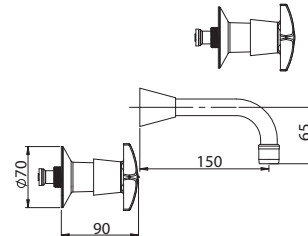

CS Shower Set With SP261 Shower

CS316

Jumper Valve

CSH316

1/2 Turn Ceramic Disc

CSQ316

1/4 Turn Ceramic Disc

CST316

3/4 Turn Ceramic Disc

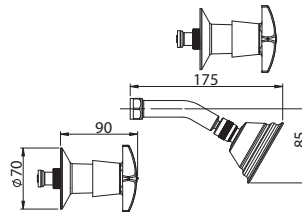

CS Shampoo Set Basin Mounted

CS346

Jumper Valve

CSQ346

1/4 Turn Ceramic Disc

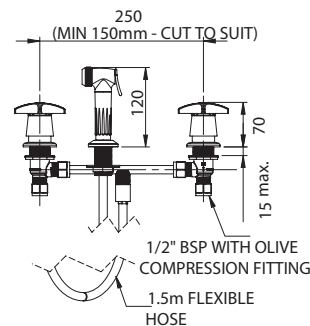

CS Recess Set With SP263 Shower

CS349

Jumper Valve

CSH349

1/2 Turn Ceramic Disc

CSQ349

1/4 Turn Ceramic Disc

CST349

3/4 Turn Ceramic Disc

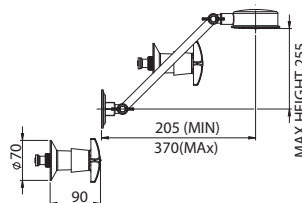

CS Recess Set With VP310 Shower

CS354

Jumper Valve

CSH354

1/2 Turn Ceramic Disc

CSQ354

1/4 Turn Ceramic Disc

CST354

3/4 Turn Ceramic Disc

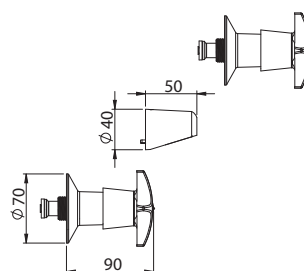

CS Recess Set With SP272 White Hand Held Shower Set

CS361	Jumper Valve
CSQ361	1/4 Turn Ceramic Disc

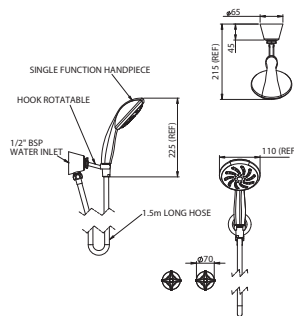

CS Recess Set with SP272C Chrome Hand Held Shower with 1.5m Hose

CS361C	Jumper Valve — Smooth Matte Chrome Hose
CSQ361C	1/4 Turn Ceramic Disc — Smooth Matte Chrome Hose

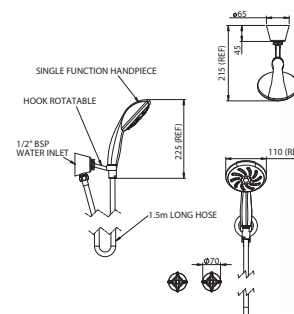

CS Recess Set With SP273 White Hand Held Shower and Heavy Duty 900mm Wall Bar

CS363	Jumper Valve
CSQ363	1/4 Turn Ceramic Disc

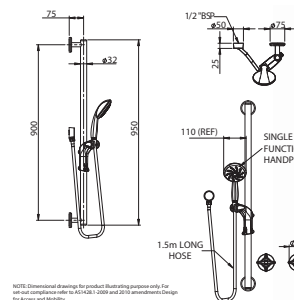

CS Recess Set with SP273C Chrome Hand Held Shower and Heavy Duty 900mm Wall Bar

CS363C	Jumper Valve — Smooth Matte Chrome Hose
CSQ363C	1/4 Turn Ceramic Disc — Smooth Matte Chrome Hose

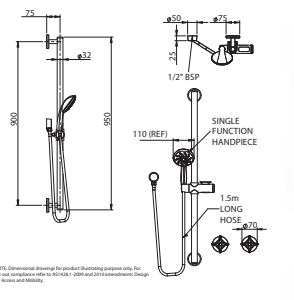

CS Recess Set With SGR023 White Hand Held Shower and 900mm Stainless Steel Grab Rail

CS364	Jumper Valve
CSQ364	1/4 Turn Ceramic Disc

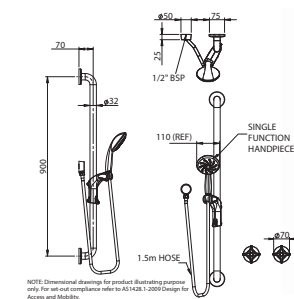

CS Recess Set With SGR023C Chrome Hand Held Shower and 900mm Stainless Steel Grab Rail

CS364C	Jumper Valve — Smooth Matte Chrome Hose
CSQ364C	1/4 Turn Ceramic Disc — Smooth Matte Chrome Hose

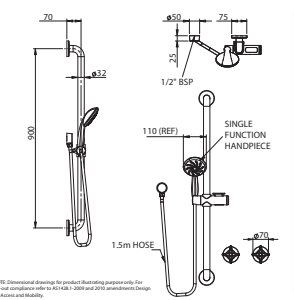

CS Recess Set With SP251 Laundry Arm

CS347

Jumper Valve

CSQ347

1/4 Turn Ceramic Disc

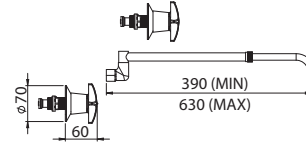

CS Washing Machine Tap

CS313

Jumper Valve

CSH313

1/2 Turn Ceramic Disc

CSQ313

1/4 Turn Ceramic Disc

CST313

3/4 Turn Ceramic Disc

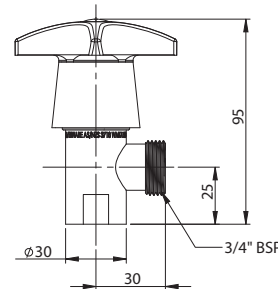

CS Cistern Tap Right Angle M&F 15mm

CS303

Jumper Valve

CSQ303

1/4 Turn Ceramic Disc

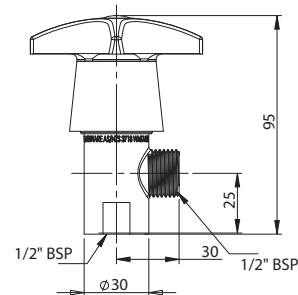

CS Stop Tap F&F 15mm

CS304

Jumper Valve

CSQ304

1/4 Turn Ceramic Disc

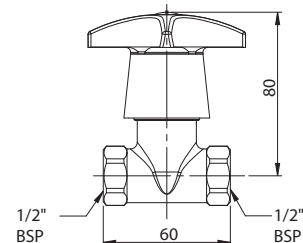

CS Hose Tap FI 15mm

CS305F

Jumper Valve

CSQ305F

1/4 Turn Ceramic Disc

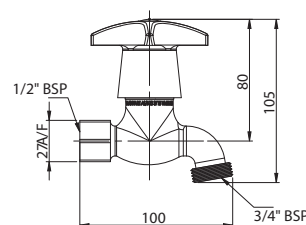

CS Stop Tap M&F 15mm

CS344

Jumper Valve

CSQ344

1/4 Turn Ceramic Disc

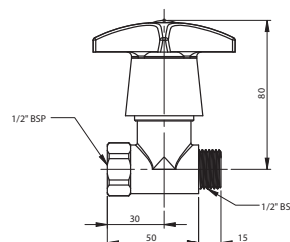

CS Hose Tap Extended 50mm FI with Non-Return Valve

CS305FDC

Jumper Valve

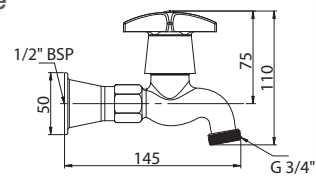

CS Hose Tap MI 15mm

CS305M

Jumper Valve

CSQ305M

1/4 Turn Ceramic Disc

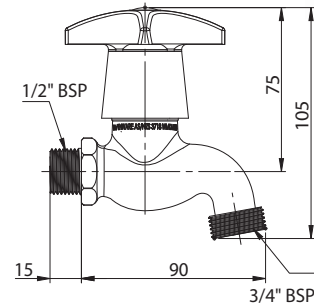

CS Shrouded Hose Tap 15mm FI

CSQ343

1/4 Turn Ceramic Disc

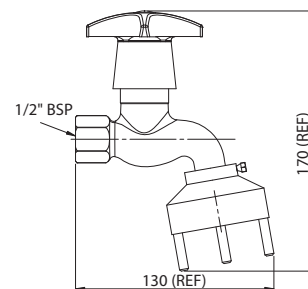

CS Hose Tap MI 3/4\"BSP X 1\"BSP

CS345M

Jumper Valve

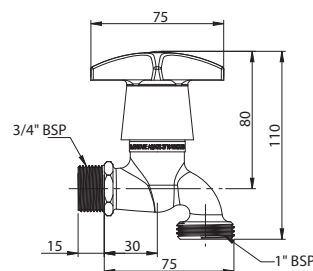

CS Recess Set With FS729 Spray

CS365

Jumper Valve

CSQ365

1/4 Turn Ceramic Disc

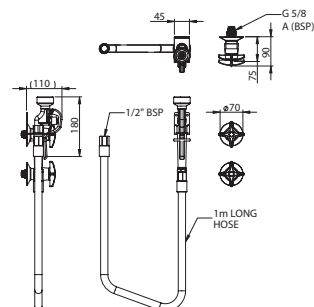

CS Handle & Skirt

CS378

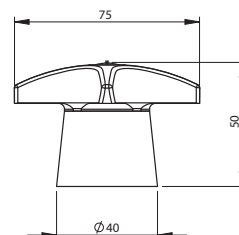

CS Bib/Pillar Stuffing Box Assembly

CS380

Jumper Valve

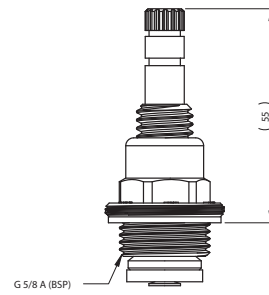

CSQ Bib/Pillar Stuffing Box Assembly

CSQ380

1/4 Turn Ceramic Disc

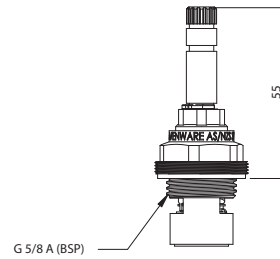

CS Basin/Sink Stuffing Box Assembly

CS381

Jumper Valve

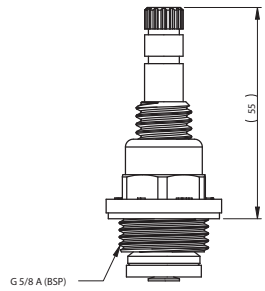

CSQ Basin/Sink Stuffing Box Assembly

CSQ381

1/4 Turn Ceramic Disc

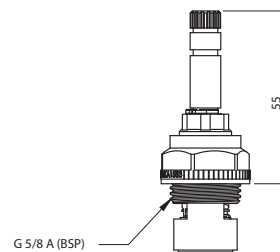

CS Recess Stuffing Box Assembly

CS382

Jumper Valve Standard

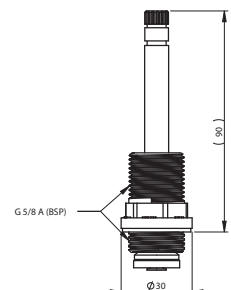

CSQ Recess Stuffing Box Assembly

CSQ382

1/4 Turn Ceramic Disc Standard

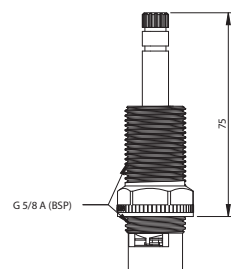

CS Recess Stuffing Box Assembly Extended

CS383	Jumper Valve 15mm Extended
CS384	Jumper Valve 20mm Extended
CS385	Jumper Valve 25mm Extended
CS386	Jumper Valve 30mm Extended
CS387	Jumper Valve 40mm Extended

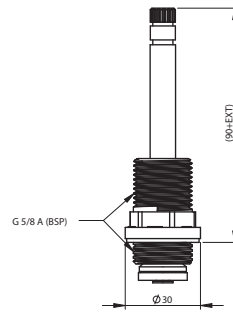

CSQ Recess Stuffing Box Assembly Extended

CSQ383	1/4 Turn Ceramic Disc 15mm Extended
CSQ384	1/4 Turn Ceramic Disc 20mm Extended
CSQ385	1/4 Turn Ceramic Disc 25mm Extended
CSQ386	1/4 Turn Ceramic Disc 30mm Extended
CSQ387	1/4 Turn Ceramic Disc 40mm Extended

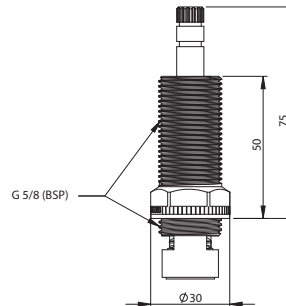

CS Bib/Pillar Top Assembly

CS390	Jumper Valve
-------	--------------

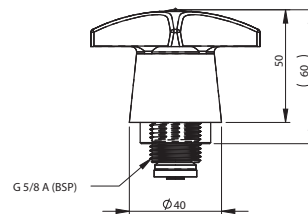

CSQ Bib/Pillar Top Assembly

CSQ390	1/4 Turn Ceramic Disc
--------	-----------------------



CS Basin/Sink Top Assembly

CS391	Jumper Valve
-------	--------------

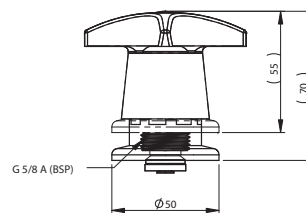

CSQ Basin/Sink Top Assembly

CSQ391	1/4 Turn Ceramic Disc
--------	-----------------------

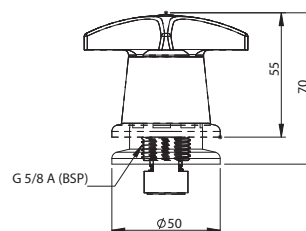

CS Recess Adaptor Extended

CS392	Jumper Valve 15mm Extended
CS393	Jumper Valve 20mm Extended

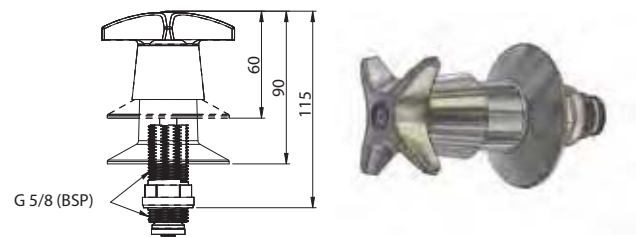

CSQ Recess Adaptor Extended

CSQ392	1/4 Turn Ceramic Disc 15mm Extended
CSQ393	1/4 Turn Ceramic Disc 20mm Extended
CST392	3/4 Turn Ceramic Disc 15mm Extended



plaza series

The Plaza Series provides a stylish option for washrooms where some vandal resistance is preferred. The streamlined capstan handle has an internal locking ring securing the handle to the spindle, which may only be released by using the key provided.

ENWARE'S PLAZA SERIES RANGE FEATURES:

- Vandal-resistant internal locking ring secures the handle – can only be released by the key
- Highest quality construction in dezincification resistant brass
- Supplied complete with handles, stamped indicators and outlets
- Option of yellow/blue/red button – request when ordering
- Choice of attractive finishes in standard heavy duty bright chrome, plus satin chrome and powder coated options.



Enware Tapware is manufactured to the exacting WaterMark standard AS/NZS3718 and AS4020.

water efficiency

ENWARE AUSTRALIA HAS USED THE PERFORMANCE CRITERIA OF:

- AS/NZS6400 – Water Efficient Products – Rating and Labelling
- AS/NZS3718 – Tapware
- AS/NZS3662 – Showers

as the benchmark for our water efficient product performance.

The pressure compensating flow control technology included in Enware's product ensures a more consistent flow rate delivery across the pressure band from 150kPa–500kPa.

TAPWARE



WELS 3 Star (8lpm) water efficiency rating supplied as standard. For 5 Star (6lpm) request when ordering.

SHOWERS



WELS 3 Star (8lpm) water efficiency rating supplied as standard.

options

FINISHES:

- Bright chrome is standard
- Optional satin chrome or epoxy powder coating

INDICATORS:

- Plaza Series: supplied standard with etched H or C
- Coloured buttons are available; specify when ordering

SPOUT OPTIONS:

- Custom sizing and shapes are available; please refer to Outlets on Page 208

OUTLET OPTIONS:

- Aerators are supplied standard on basin and sink mixing sets
- Laminar flow is available, please refer to Enware's Outlets brochure for further details

VALVING OPTIONS:

- Jumper Valve — **PZ**
- ¼ turn Ceramic Disc — **PZQ**
- ½ turn Ceramic Disc — **PZH**
- ¾ turn Ceramic Disc — **PZT**

technical information

	CERAMIC DISC	JUMPER VALVE
Minimum–Maximum Working Pressure (AS/NZS 3500)*	50–500kPa	30–500kPa
Maximum Static Pressure	800kPa	1200kPa
Maximum Working Temperature**	85°C	95°C

*Enware products are to be installed in accordance with AS/NZS3500. **Heated Water Supply AS/NZS 3500.4: For all sanitary fixtures used primarily for personal hygiene purposes are to deliver heated water not exceeding: a) 45°C for early childhood centres, primary and secondary schools and nursing homes or similar facilities for young, aged care, sick people with disabilities b) 50°C in all other buildings.

wall depth adjustments

Enware's recess tapware have adjustments for installation flexibility – Standard spindle adjustment is shown here. Extended spindles are available in 15, 20, 25, 30 and 40mm.

JUMPER VALVE

From 1mm behind finished wall to 14mm behind finished wall.

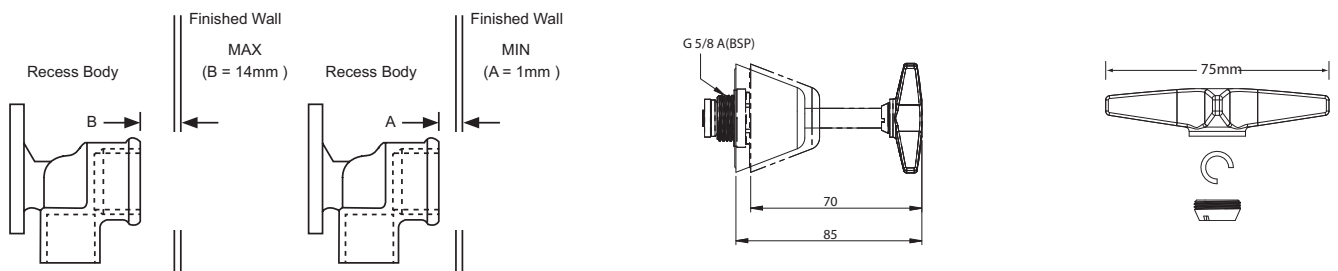

CERAMIC DISC

From 4mm behind finished wall to 18mm behind finished wall.

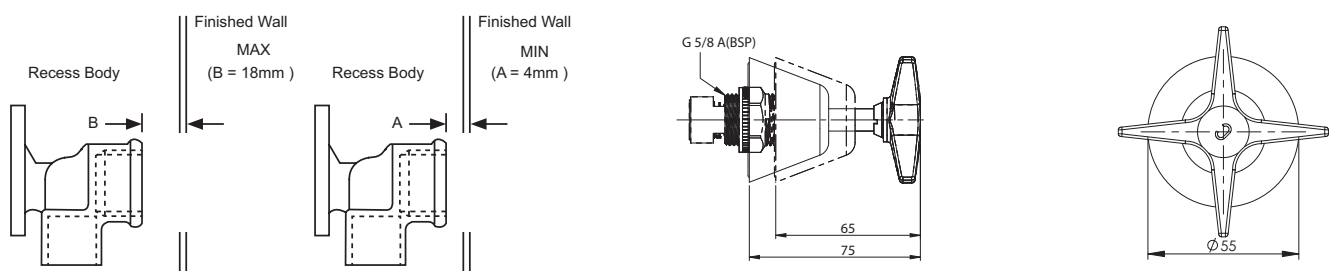

Plaza Recess Adaptor

PZ308	Jumper Valve Standard
PZH308	1/2 Turn Ceramic Disc Standard
PZQ308	1/4 Turn Ceramic Disc Standard
PZT308	3/4 Turn Ceramic Disc Standard

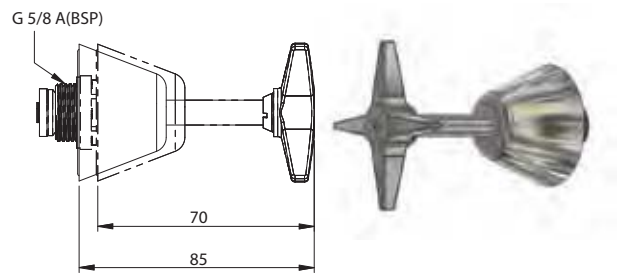

Plaza Recess Adaptor 20mm Fullway

PZ348	Jumper Valve
-------	--------------

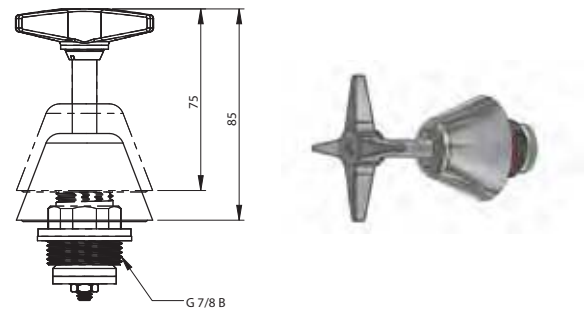

Plaza Forward Bowl Sink Set With SP010 Spout

PZ307	Jumper Valve
PZH307	1/2 Turn Ceramic Disc
PZQ307	1/4 Turn Ceramic Disc
PZT307	3/4 Turn Ceramic Disc

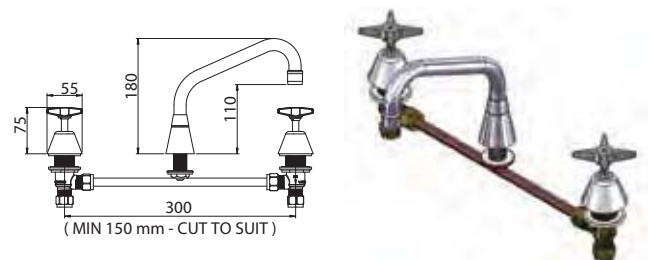

Plaza Recessed Set With SP110 Swivel Spout

PZ315	Jumper Valve
PZH315	1/2 Turn Ceramic Disc
PZQ315	1/4 Turn Ceramic Disc
PZT315	3/4 Turn Ceramic Disc

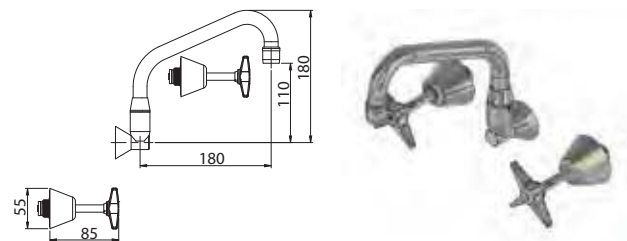

Plaza Dual Mixer With SP020 Spout

PZ370	Jumper Valve
PZH370	1/2 Turn Ceramic Disc
PZQ370	1/4 Turn Ceramic Disc
PZT370	3/4 Turn Ceramic Disc

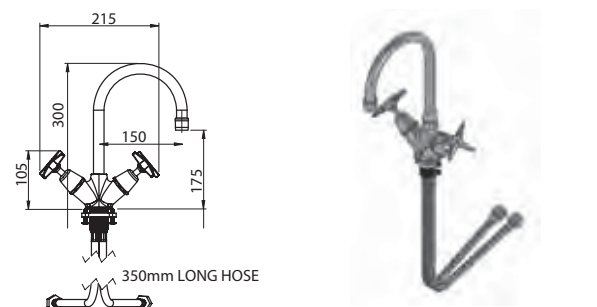

Plaza Basin Set With SP001 Spout

PZ306	Jumper Valve
PZH306	1/2 Turn Ceramic Disc
PZQ306	1/4 Turn Ceramic Disc
PZT306	3/4 Turn Ceramic Disc

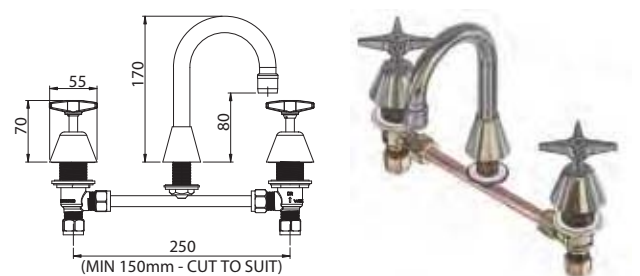

Plaza Recessed Set With SP201 Fixed Spout

PZ314	Jumper Valve
PZH314	1/2 Turn Ceramic Disc
PZQ314	1/4 Turn Ceramic Disc
PZT314	3/4 Turn Ceramic Disc

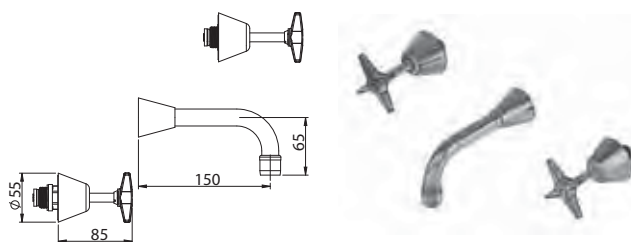

Plaza Pillar Tap 15mm

PZ302	Jumper Valve
PZH302	1/2 Turn Ceramic Disc
PZQ302	1/4 Turn Ceramic Disc

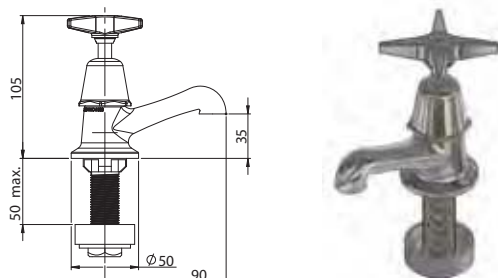

Plaza Pillar Tap

PZ327	Aerated Outlet — Jumper Valve
PZQ327	Aerated Outlet — 1/4 Turn Ceramic Disc

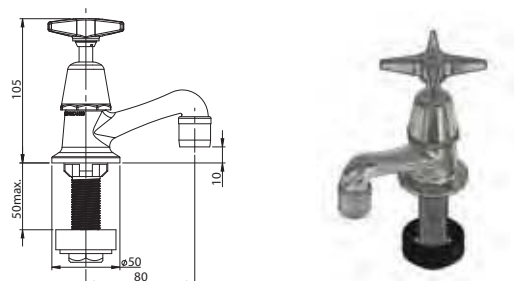

Plaza Pillar Tap 15mm

PZ337	Ablution Outlet — Jumper Valve
PZQ337	Ablution Outlet — 1/4 Turn Ceramic Disc

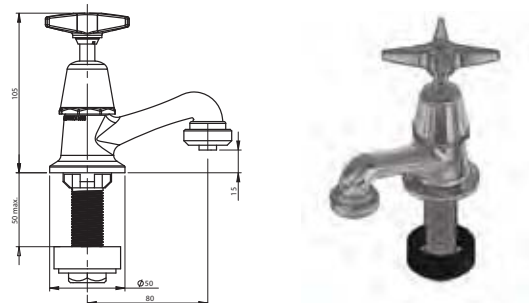

Plaza Bib Tap FI 15mm

PZ301F	Jumper Valve
PZH301F	1/2 Turn Ceramic Disc
PZQ301F	1/4 Turn Ceramic Disc
PZT301F	3/4 Turn Ceramic Disc

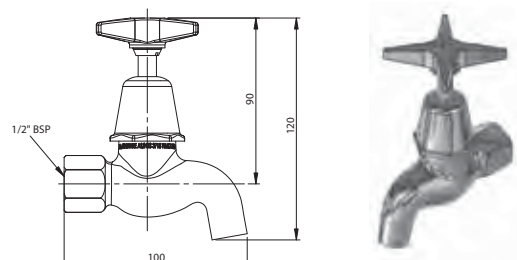

Plaza Bib Tap MI 15mm

PZ301M	Jumper Valve
PZH301M	1/2 Turn Ceramic Disc
PZQ301M	1/4 Turn Ceramic Disc
PZT301M	3/4 Turn Ceramic Disc

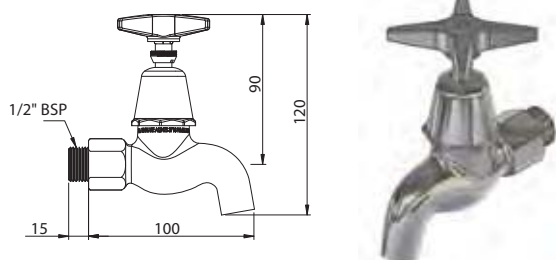

Plaza Bib Tap FI

PZ325F

Aerated Outlet — Jumper Valve

PZQ325F

Aerated Outlet — 1/4 Turn Ceramic Disc

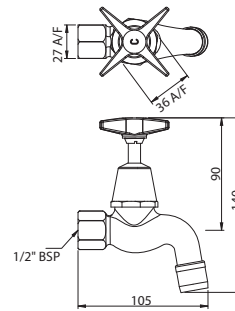

Plaza Bib Tap MI

PZ325M

Aerated Outlet — Jumper Valve

PZQ325M

Aerated Outlet — 1/4 Turn Ceramic Disc

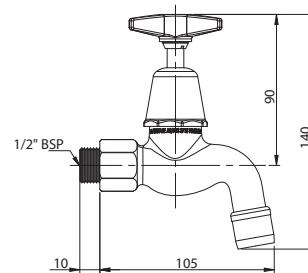

Plaza Bib Tap MI 15mm

PZ312M

Ablution Outlet — Jumper Valve

PZQ312M

Ablution Outlet — 1/4 Turn Ceramic Disc

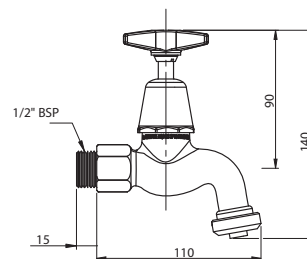

Plaza Bib Tap FI 15mm

PZ312F

Ablution Outlet — Jumper Valve

PZQ312F

Ablution Outlet — 1/4 Turn Ceramic Disc

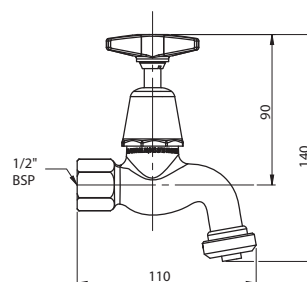

Plaza Bib Tap FI 50mm Extended

PZ321F

Jumper Valve

PZQ321F

1/4 Turn Ceramic Disc

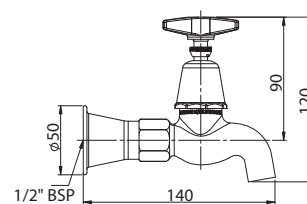

Plaza Bib Tap FI 50mm Extended

PZ322F

Aerated Outlet — Jumper Valve

PZQ322F

Aerated Outlet — 1/4 Turn Ceramic Disc

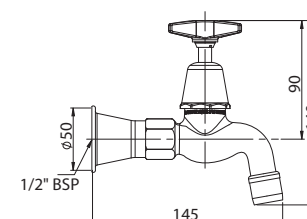

Plaza Bib Tap FI 50mm Extended

PZ333F

Ablution Outlet — Jumper Valve

PZQ333F

Ablution Outlet — 1/4 Turn Ceramic Disc

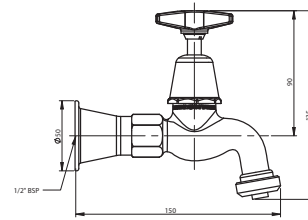

Plaza Recessed Set With SP261 Shower

PZ316

Jumper Valve

PZH316

1/2 Turn Ceramic Disc

PZQ316

1/4 Turn Ceramic Disc

PZT316

3/4 Turn Ceramic Disc

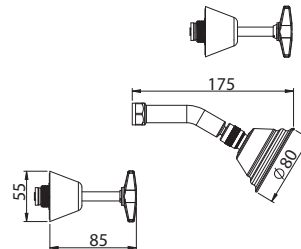

Plaza Recessed Set With SP262 Deluxe Shower

PZ316D

Jumper Valve (SP262 Deluxe Shower)

PZH316D

1/2 Turn Ceramic Disc
(SP262 Deluxe Shower)

PZQ316D

1/4 Turn Ceramic Disc
(SP262 Deluxe Shower)

PZT316D

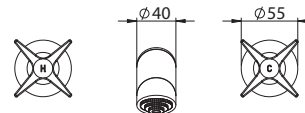
3/4 Turn Ceramic Disc
(SP262 Deluxe Shower)

Plaza Recessed Set With SP263 Shower

PZ349

Jumper Valve

PZH349

1/2 Turn Ceramic Disc

PZQ349

1/4 Turn Ceramic Disc

PZT349

3/4 Turn Ceramic Disc

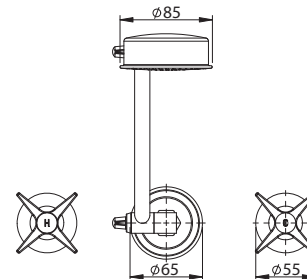

Plaza Recessed Set With VP310 Shower

PZ354

Jumper Valve

PZH354

1/2 Turn Ceramic Disc

PZQ354

1/4 Turn Ceramic Disc

PZT354

3/4 Turn Ceramic Disc

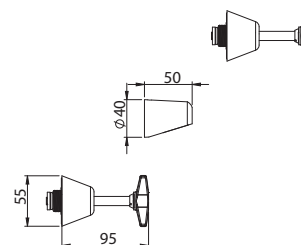

Plaza Recessed Set With SP272 White Hand Held Shower and 1.5m Hose

PZ361

Jumper Valve

PZQ361

1/4 Turn Ceramic Disc

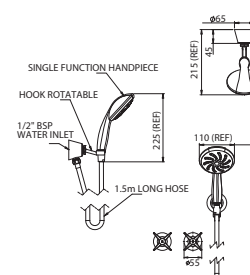

Plaza Recessed Set With SP272C Chrome Hand Held Shower and 1.5m Hose

PZ361C Jumper Valve — Smooth Matte Chrome Hose
 PZQ361C 1/4 Turn Ceramic Disc — Smooth Matte Chrome Hose

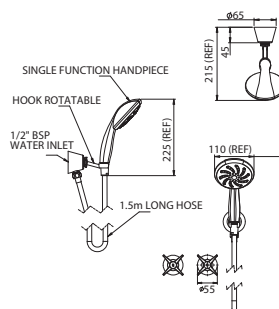

Plaza Recessed Set With SP273 White Hand Held Shower and Heavy Duty 900mm Wall Bar

PZ363 Jumper Valve
 PZQ363 1/4 Turn Ceramic Disc

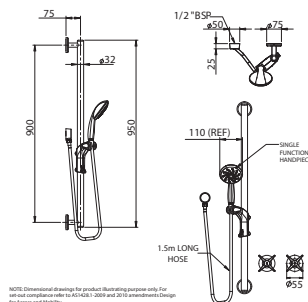

Plaza Recessed Set With SP273C Chrome Hand Held Shower and Heavy Duty 900mm Wall Bar

PZ363C Jumper Valve — Smooth Matte Chrome Hose
 PZQ363C 1/4 Turn Ceramic Disc — Smooth Matte Chrome Hose

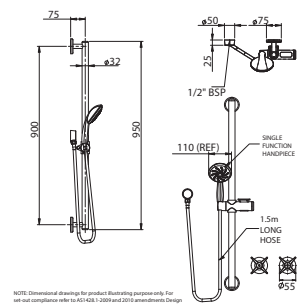

Plaza Recessed Set With SGR023 White Hand Held Shower and 1.5m Hose with 900mm Stainless Steel Grab Rail

PZ364 Jumper Valve
 PZQ364 1/4 Turn Ceramic Disc

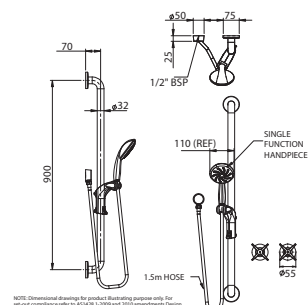

Plaza Recessed Set With SGR023C Chrome Hand Held Shower and 1.5m Hose with 900mm Stainless Steel Grab Rail

PZ364C Jumper Valve — Smooth Matte Chrome Hose
 PZQ364C 1/4 Turn Ceramic Disc — Smooth Matte Chrome Hose

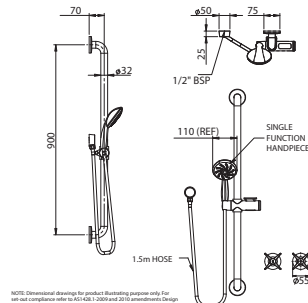

Plaza Shampoo Set Basin Mounted

PZ346 Jumper Valve
 PZQ346 1/4 Turn Ceramic Disc

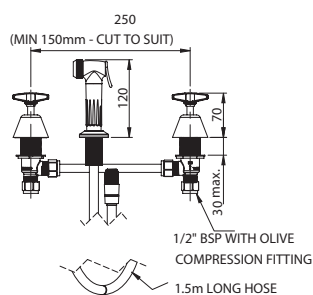

Plaza Recessed Set With SP251 Laundry Arm

PZ347	Jumper Valve
PZH347	1/2 Turn Ceramic Disc
PZQ347	1/4 Turn Ceramic Disc
PZT347	3/4 Turn Ceramic Disc

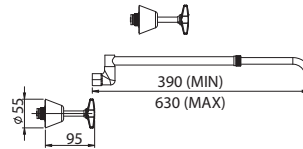

Plaza Washing Machine Tap

PZ313	Jumper Valve
PZH313	1/2 Turn Ceramic Disc
PZQ313	1/4 Turn Ceramic Disc
PZT313	3/4 Turn Ceramic Disc

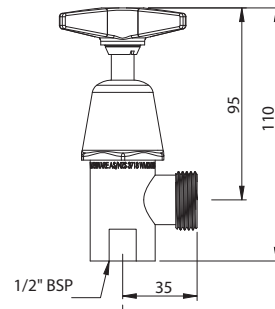

Plaza Cistern Tap Right Angle M&F 15mm

PZ303	Jumper Valve
PZH303	1/2 Turn Ceramic Disc
PZQ303	1/4 Turn Ceramic Disc

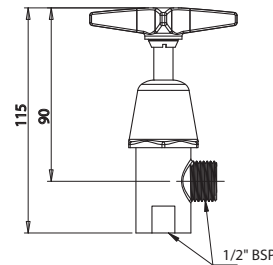

Plaza Hose Tap FI 15mm

PZ305F	Jumper Valve
PZQ305F	1/4 Turn Ceramic Disc

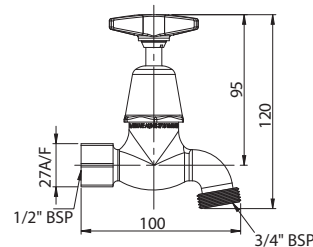

Plaza Stop Tap F&F 15mm

PZ304	Jumper Valve
PZQ304	1/4 Turn Ceramic Disc

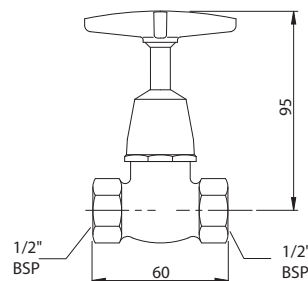

Plaza Stop Tap M&F 15mm

PZ344	Jumper Valve
PZQ344	1/4 Turn Ceramic Disc



Plaza Hose Tap MI 15mm

PZ305M

Jumper Valve

PZQ305M

1/4 Turn Ceramic Disc

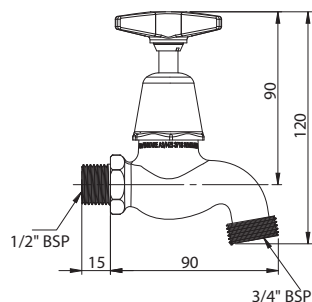

Plaza Hose Tap MI 20mm x 25mm

PZ345M

Jumper Valve

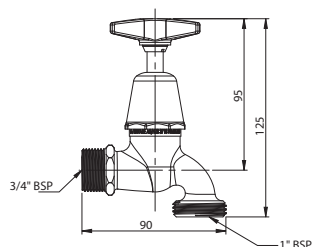

Plaza Handle

PZ378

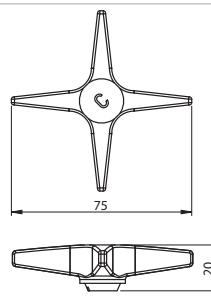

Plaza Bib/Pillar Stuffing Box Assembly

PZ380

Jumper Valve

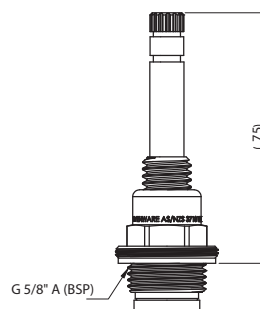

Plaza Basin/Sink Stuffing Box Assembly

PZ381

Jumper Valve

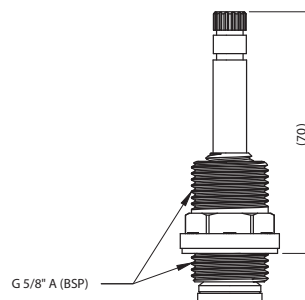

Plaza Bib/Pillar Stuffing Box Assembly

PZQ380

1/4 Turn Ceramic Disc

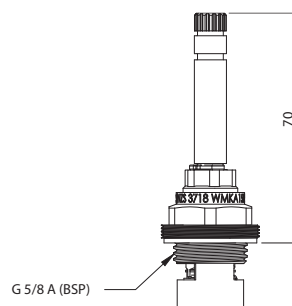

Plaza Recess Stuffing Box Assembly

PZ382

Jumper Valve Standard

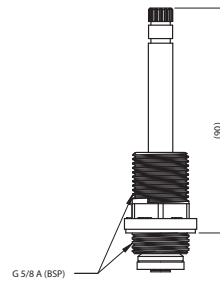

Plaza Basin/Sink Stuffing Box Assembly

PZQ381

1/4 Turn Ceramic Disc

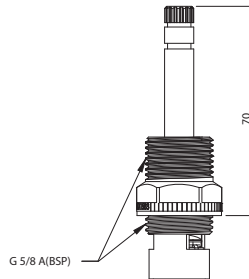

Plaza Recess Stuffing Box Assembly Extended

PZ383

Jumper Valve 15mm Extended

PZ384

Jumper Valve 20mm Extended

PZ385

Jumper Valve 25mm Extended

PZ387

Jumper Valve 40mm Extended

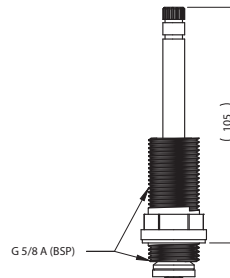

Plaza Recess Stuffing Box Assembly

PZQ382

1/4 Turn Ceramic Disc Standard

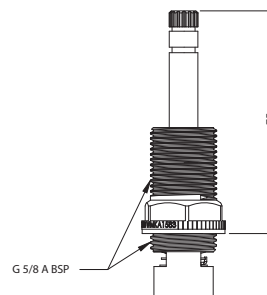

Plaza Bib/Pillar Top Assembly

PZ390

Jumper Valve

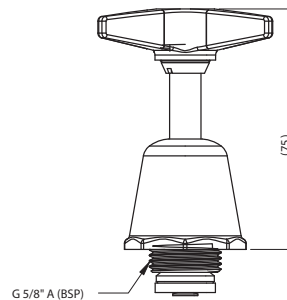

Plaza Recess Stuffing Box Assembly Extended

PZQ383

1/4 Turn Ceramic Disc 15mm Extended

PZQ384

1/4 Turn Ceramic Disc 20mm Extended

PZQ385

1/4 Turn Ceramic Disc 25mm Extended

PZQ386

1/4 Turn Ceramic Disc 30mm Extended

PZQ387

1/4 Turn Ceramic Disc 40mm Extended

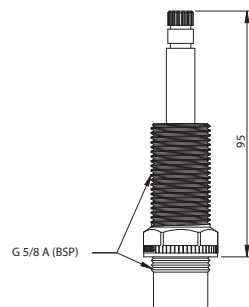

Plaza Basin/Sink Top Assembly

PZ391

Jumper Valve

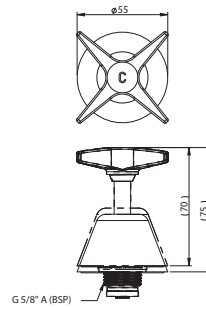

Plaza Bib/Pillar Top Assembly

PZQ390

1/4 Turn Ceramic Disc



Plaza Recess Adaptor Extended

PZ393

Jumper Valve 20mm Extended

PZ394

Jumper Valve 25mm Extended

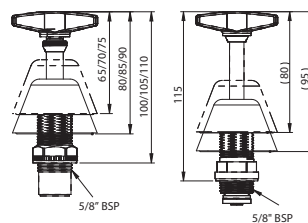

Plaza Basin/Sink Top Assembly

PZQ391

1/4 Turn Ceramic Disc

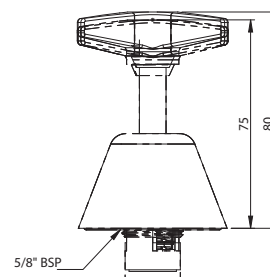

Plaza Trouble Dome 10mm

PZ540

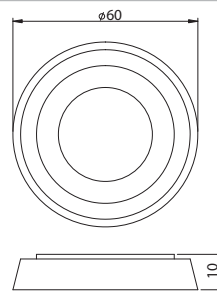

Plaza Recess Adaptor Extended

PZQ392

1/4 Turn Ceramic Disc 15mm Extended

PZQ393

1/4 Turn Ceramic Disc 20mm Extended

PZQ394

1/4 Turn Ceramic Disc 25mm Extended



school pattern series

The vandal resistant School Pattern Series has been proven in some of the busiest washrooms, toilets, showers and amenities.

In applications like schools, public areas, universities and shopping centres, the resilient School Pattern Series continues to provide dependable service year after year.

ENWARE'S SCHOOL PATTERN SERIES RANGE FEATURES:

- Vandal-resistant internal locking ring secures the handle – can only be released by key
- A non-removable handle is available for higher risk applications
- Highest quality construction in dezincification resistant brass
- Supplied complete with handles, buttons and outlets
- Choice of attractive finishes in standard heavy duty bright chrome, plus satin chrome and powder coated options.



WaterMark
AS/NZS 3718 WMKA 1583
SAI Global

Enware Tapware is manufactured to the exacting WaterMark standard AS/NZS3718 and AS4020.

water efficiency

ENWARE AUSTRALIA HAS USED THE PERFORMANCE CRITERIA OF:

- AS/NZS6400 – Water Efficient Products – Rating and Labelling
- AS/NZS3718 – Tapware
- AS/NZS3662 – Showers

as the benchmark for our water efficient product performance.

The pressure compensating flow control technology included in Enware's product ensures a more consistent flow rate delivery across the pressure band from 150kPa–500kPa.

TAPWARE



WELS 3 Star (8lpm) water efficiency rating supplied as standard. For 5 Star (6lpm) request when ordering.

SHOWERS



WELS 3 Star (8lpm) water efficiency rating supplied as standard.

options

FINISHES:

- Bright chrome is standard
- Optional satin chrome or epoxy powder coating

INDICATORS:

- School Pattern: Supplied standard with Red or Blue buttons
- Yellow for warm water is also available; specify your requirements when ordering

SPOUT OPTIONS:

- Custom sizing and shapes are available; please refer to Outlets on Page 208

OUTLET OPTIONS:

- Aerators are supplied standard on basin and sink mixing sets
- Laminar flow is available, please refer to Enware's Outlets brochure for further details

VALVING OPTIONS:

- Jumper Valve — **VP**
- ¼ turn Ceramic Disc — **VPQ**
- ½ turn Ceramic Disc — **VPH**
- ¾ turn Ceramic Disc — **VPT**

technical information

	CERAMIC DISC	JUMPER VALVE
Minimum–Maximum Working Pressure (AS/NZS 3500)*	50–500kPa	30–500kPa
Maximum Static Pressure	800kPa	1200kPa
Maximum Working Temperature**	85°C	95°C

*Enware products are to be installed in accordance with AS/NZS3500. **Heated Water Supply AS/NZS 3500.4: For all sanitary fixtures used primarily for personal hygiene purposes are to deliver heated water not exceeding: **a) 45°C** for early childhood centres, primary and secondary schools and nursing homes or similar facilities for young, aged care, sick people with disabilities **b) 50°C** in all other buildings.

wall depth adjustments

Enware's recess tapware have adjustments for installation flexibility – Standard spindle adjustment is shown here. Extended spindles are available in 15, 20, 25, 30 and 40mm.

JUMPER VALVE

From level with finished wall to 14mm behind finished wall.

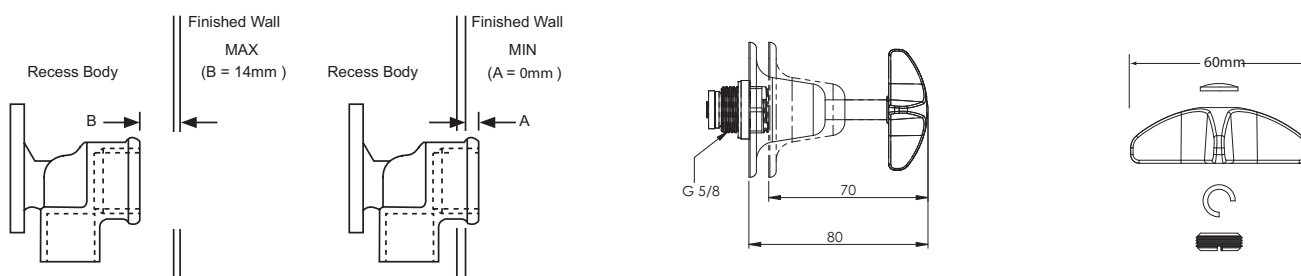

CERAMIC DISC

From 4mm behind finished wall to 18mm behind finished wall.

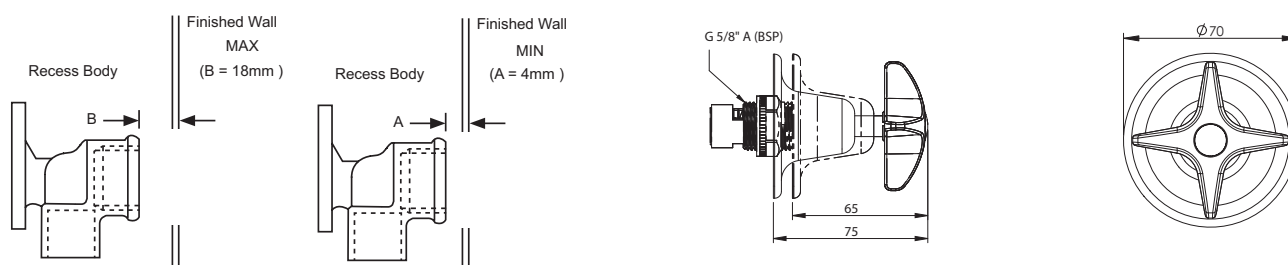

Product details in this guide are indicative only and may change without notice.

School Pattern Recess Adaptor

VP308	Jumper Valve Standard
VPH308	1/2 Turn Ceramic Disc Standard
VPN308	Jumper Valve Non Removable Handle Standard
VPQ308	1/4 Turn Ceramic Disc Standard
VPT308	3/4 Turn Ceramic Disc Standard

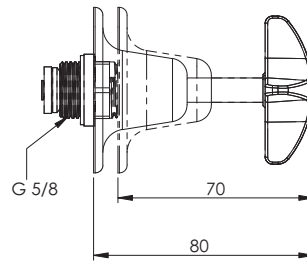

School Pattern Forward Bowl Sink Set With SP010 Spout

VP307	Jumper Valve
VP307S	Jumper Valve (NSW School Specification)
VPH307	1/2 Turn Ceramic Disc
VPN307	Jumper Valve Non Removable Handle
VPQ307	1/4 Turn Ceramic Disc
VPT307	3/4 Turn Ceramic Disc

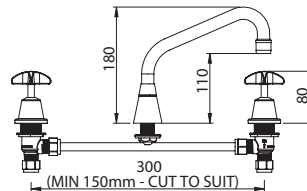

School Pattern Recessed Set With SP110 Swivel Spout

VP315	Jumper Valve
VP315S	Jumper Valve (NSW School Specification — SP121)
VPH315	1/2 Turn Ceramic Disc
VPN315	Jumper Valve Non Removable Handle
VPQ315	1/4 Turn Ceramic Disc
VPT315	3/4 Turn Ceramic Disc

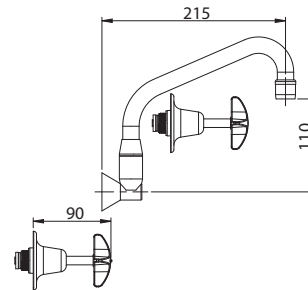

School Pattern Dual Mixer With SP020 Spout

VP370	Jumper Valve
VP370S	Jumper Valve (NSW School Specification — SP010)
VP370Z	Jumper Valve (15mm Inlet New Zealand)
VPH370	1/2 Turn Ceramic Disc
VPQ370	1/4 Turn Ceramic Disc
VPT370	3/4 Turn Ceramic Disc

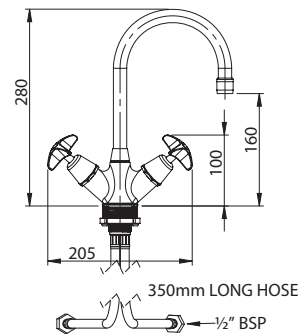

School Pattern Recess Set With SP120 Spout

VP317S	Jumper Valve (NSW School Specification — SP120)
--------	---

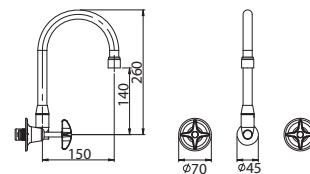

School Pattern Basin Set With SP001 Spout

VP306	Jumper Valve
VP306S	Jumper Valve (NSW School Specification)
VPH306	1/2 Turn Ceramic Disc
VPN306	Jumper Valve Non Removable Handle
VPQ306	1/4 Turn Ceramic Disc
VPT306	3/4 Turn Ceramic Disc

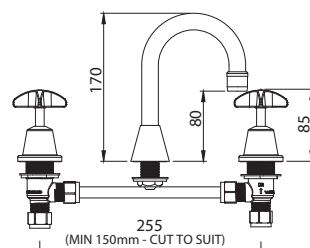

School Pattern Pillar Tap 15mm

VP302	Jumper Valve
VPH302	1/2 Turn Ceramic Disc
VPN302	Jumper Valve Non Removable Handle
VPQ302	1/4 Turn Ceramic Disc
VPT302	3/4 Turn Ceramic Disc

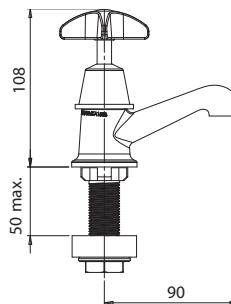

School Pattern Pillar Tap

VP327	Aerated Outlet — Jumper Valve
VP327S	Jumper Valve (NSW School Specification)
VPQ327	Aerated Outlet — 1/4 Turn Ceramic Disc

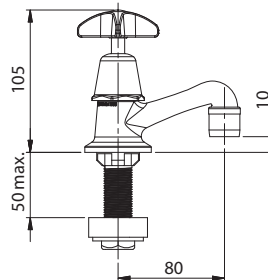

School Pattern Pillar Tap 15mm

VP337	Ablution Outlet — Jumper Valve
VPQ337	Ablution Outlet — 1/4 Turn Ceramic Disc

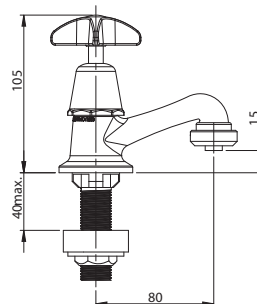

School Pattern Bib Tap FI 15mm

VP301F	Jumper Valve
VPH301F	1/2 Turn Ceramic Disc
VPN301F	Jumper Valve Non Removable Handle
VPQ301F	1/4 Turn Ceramic Disc
VPT301F	3/4 Turn Ceramic Disc

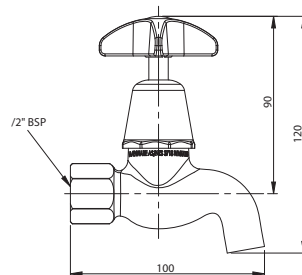

School Pattern Bib Tap MI 15mm

VP301M	Jumper Valve
VPH301M	1/2 Turn Ceramic Disc
VPN301M	Jumper Valve Non Removable Handle
VPQ301M	1/4 Turn Ceramic Disc
VPT301M	3/4 Turn Ceramic Disc

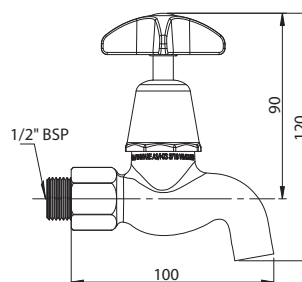

School Pattern Bib Tap FI 15mm

VP325F	Aerated Outlet — Jumper Valve
VPQ325F	Aerated Outlet — 1/4 Turn Ceramic Disc

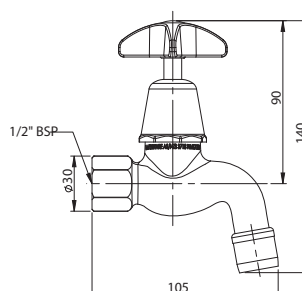

School Pattern Bib Tap MI 15mm

VP325M	Jumper Valve
VP325S	Jumper Valve (NSW School Specification)
VPQ325M	1/4 Turn Ceramic Disc

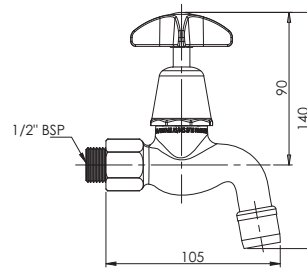

School Pattern Bib Tap FI 15mm

VP312F	Ablution Outlet — Jumper Valve
VPQ312F	Ablution Outlet — 1/4 Turn Ceramic Disc

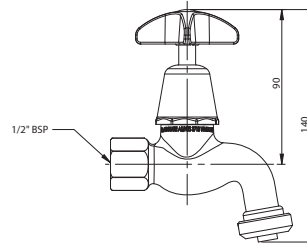

School Pattern Bib Tap MI 15mm

VP312M	Ablution Outlet — Jumper Valve
VP312S	Ablution Outlet — Jumper Valve (NSW School Specification)
VPQ312M	Ablution Outlet — 1/4 Turn Ceramic Disc

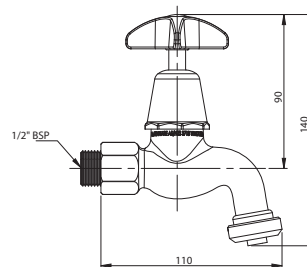

School Pattern Bib Tap FI 50mm Extended

VP321F	Jumper Valve
VPQ321F	1/4 Turn Ceramic Disc

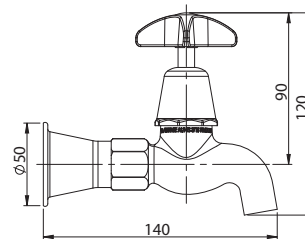

School Pattern Bib Tap FI 50mm Extended

VP322F	Aerated Outlet — Jumper Valve
VPQ322F	Aerated Outlet — 1/4 Turn Ceramic Disc

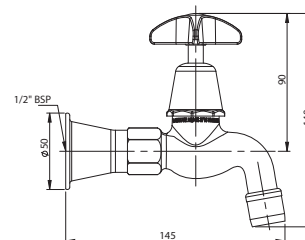

School Pattern Bib Tap FI 15mm — 50mm Extended

VP333F	Ablution Outlet — Jumper Valve
VPQ333F	Ablution Outlet — 1/4 Turn Ceramic Disc

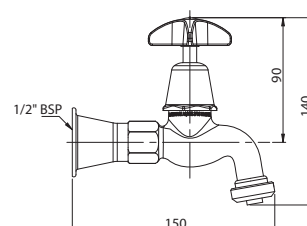

School Pattern Recessed Set With SP261 Shower

VP316	Jumper Valve
VPH316	1/2 Turn Ceramic Disc
VPQ316	1/4 Turn Ceramic Disc
VPT316	3/4 Turn Ceramic Disc

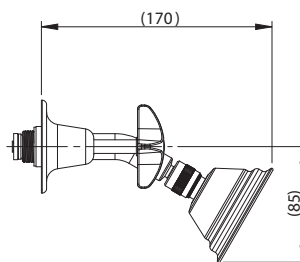

School Pattern Recessed Set With SP263 Shower

VP349	Jumper Valve
VP349S	Jumper Valve (NSW School Specification — SP264)
VPH349	1/2 Turn Ceramic Disc
VPQ349	1/4 Turn Ceramic Disc
VPT349	3/4 Turn Ceramic Disc

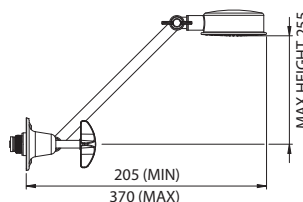

School Pattern Recessed Set With VP310 Shower

VP354	Jumper Valve
VP354S	Jumper Valve (NSW School Specification)
VPH354	1/2 Turn Ceramic Disc
VPQ354	1/4 Turn Ceramic Disc
VPT354	3/4 Turn Ceramic Disc

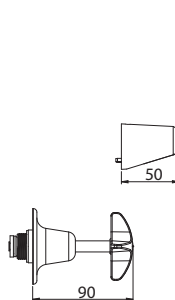

School Pattern Recessed Set With SP272 Shower

VP361	Jumper Valve
VPQ361	1/4 Turn Ceramic Disc

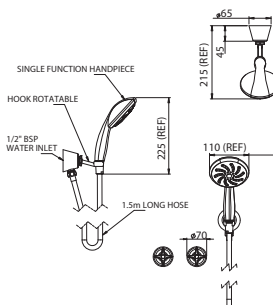

School Pattern Recessed Set With SP272C Chrome Hand Held Shower

VP361C	Jumper Valve — Smooth Matte Chrome Hose
VPQ361C	1/4 Turn Ceramic Disc — Smooth Matte Chrome Hose

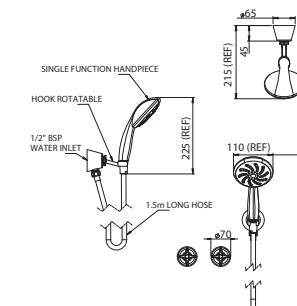

School Pattern Recessed Set With SP273 White Hand Held Shower and Heavy Duty 900mm Wall Bar

VP363	Jumper Valve
VPQ363	1/4 Turn Ceramic Disc

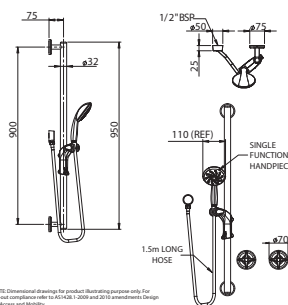

NOTE: Dimensional drawings for product illustration purposes only. For up to date compliance refer to AS/NZS 1538 and AS 1538 for Access and Usability.

School Pattern Recessed Set With SP273C Chrome Hand Held Shower and Heavy Duty 900mm Wall Bar

VP363C

Jumper Valve — Smooth Matte Chrome Hose

VPQ363C

1/4 Turn Ceramic Disc — Smooth Matte Chrome Hose

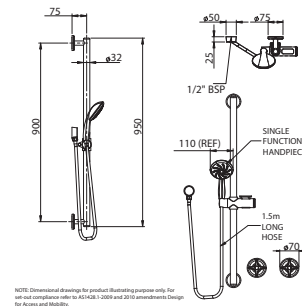

School Pattern Recessed Set with SGR023 White Hand Held Shower and 1.5m Hose with 900mm Stainless Steel Grab Rail

VP364

Jumper Valve

VPQ364

1/4 Turn Ceramic Disc

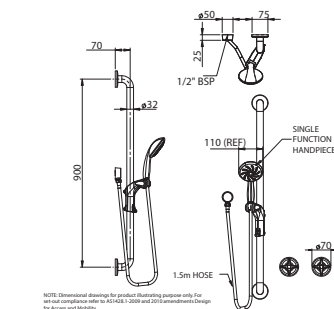

School Pattern Recessed Set With SGR023C Chrome Hand Held Shower and 900mm Stainless Steel Grab Rail

VP364C

Jumper Valve — Smooth Matte Chrome Hose

VPQ364C

1/4 Turn Ceramic Disc — Smooth Matte Chrome Hose

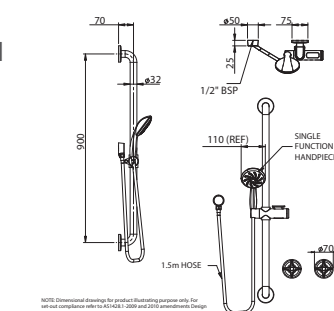

School Pattern Shampoo Set Basin Mounted

VP346

Jumper Valve

VPQ346

1/4 Turn Ceramic Disc

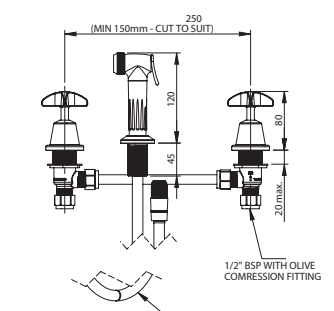

School Pattern Recessed Set With SP201 Fixed Spout

VP314

Jumper Valve

VP314S

Jumper Valve (NSW School Specification — SP200)

VPH314

1/2 Turn Ceramic Disc

VPN314

Jumper Valve Non Removable Handle

VPQ314

1/4 Turn Ceramic Disc

VPT314

3/4 Turn Ceramic Disc

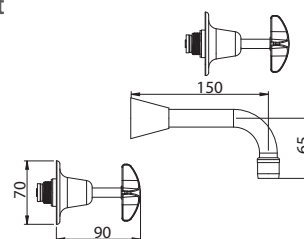

School Pattern Recessed Set With SP251 Laundry Arm

VP347

Jumper Valve

VPQ347

1/4 Turn Ceramic Disc

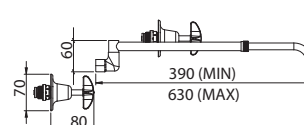

School Pattern Washing Machine Tap

VP313	Jumper Valve
VPH313	1/2 Turn Ceramic Disc
VPN313	Jumper Valve Non Removable Handle
VPQ313	1/4 Turn Ceramic Disc
VPT313	3/4 Turn Ceramic Disc

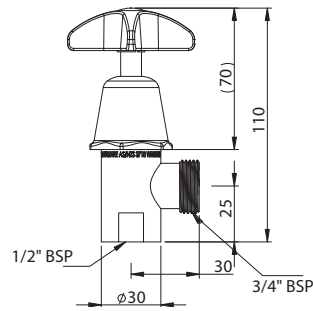

School Pattern Recessed Set With FS729 Spray

VP365	Jumper Valve
VPQ365	1/4 Turn Ceramic Disc

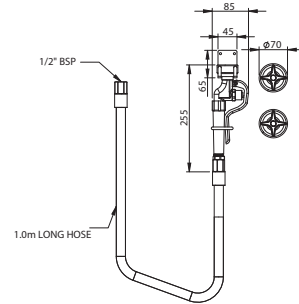

School Pattern Hose Tap FI 15mm

VP305F	Jumper Valve
VPN305F	Jumper Valve Non Removable Handle
VPQ305F	1/4 Turn Ceramic Disc

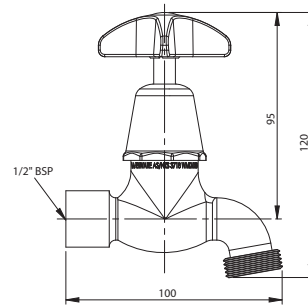

School Pattern Hose Tap Extended 50mm FI with Non-Return

VP305FDC	Jumper Valve
----------	--------------

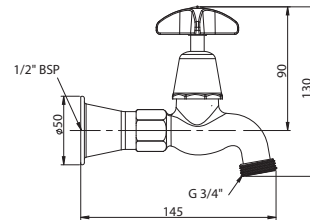

School Pattern Hose Tap MI 15mm

VP305M	Jumper Valve
VPN305M	Jumper Valve Non Removable Handle
VPQ305M	1/4 Turn Ceramic Disc

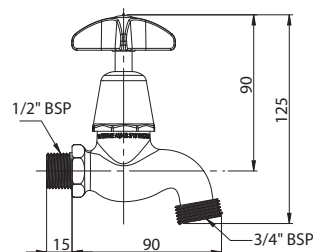

School Pattern Hose Tap MI 20mm x 25mm

VP345M	Jumper Valve
--------	--------------

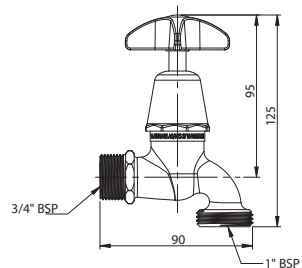

School Pattern Cistern Tap Right Angle M&F 15mm

VP303	Jumper Valve
VPH303	1/2 Turn Ceramic Disc
VPN303	Jumper Valve Non Removable Handle
VPQ303	1/4 Turn Ceramic Disc

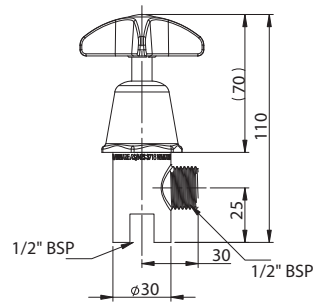

School Pattern Stop Tap F&F 15mm

VP304	Jumper Valve
VPN304	Jumper Valve Non Removable Handle
VPQ304	1/4 Turn Ceramic Disc

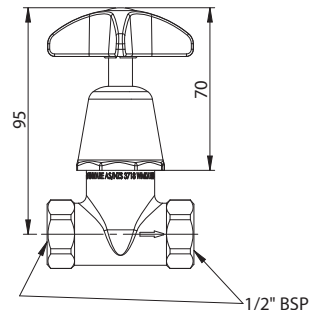

School Pattern Stop Tap M&F 15mm

VP344	Jumper Valve
VPQ344	1/4 Turn Ceramic Disc

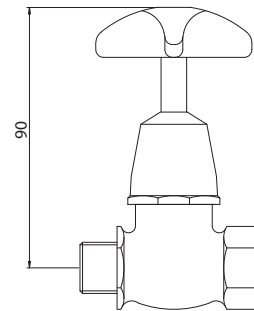

School Pattern Handle

VP378

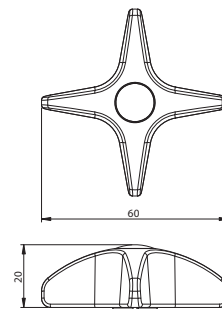

School Pattern Bib/Pillar Stuffing Box Assembly

VP380	Jumper Valve
-------	--------------

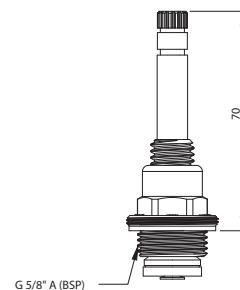

School Pattern Basin/Sink Stuffing Box Assembly

VP381	Jumper Valve
-------	--------------

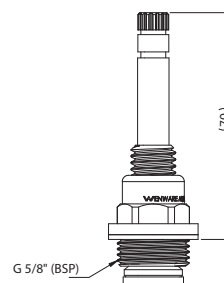

School Pattern Recess Stuffing Box Assembly

VP382

Jumper Valve Standard

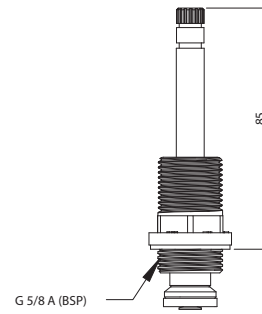

School Pattern Recess Stuffing Box Assembly Extended

VP383

Jumper Valve 15mm Extended

VP384

Jumper Valve 20mm Extended

VP385

Jumper Valve 25mm Extended

VP386

Jumper Valve 30mm Extended

VP387

Jumper Valve 40mm Extended

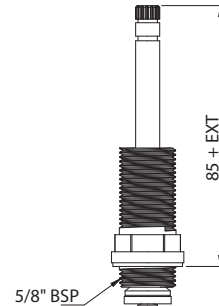

School Pattern Bib/Pillar Top Assembly

VP390

Jumper Valve

VPN390

Jumper Valve Non Removable Handle

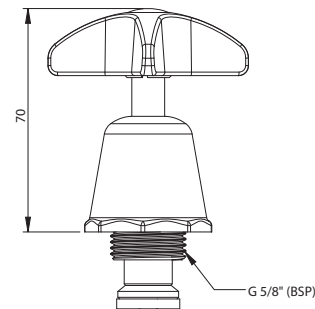

School Pattern Basin/Sink Top Assembly

VP391

Jumper Valve

VPN391

Jumper Valve Non Removable

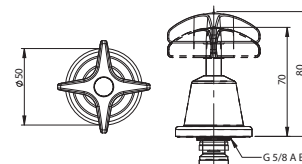

School Pattern Recess Adaptor Extended

VP392

Jumper Valve 15mm Extended

VP393

Jumper Valve 20mm Extended

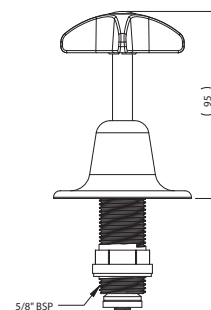

School Pattern Bib/Pillar Stuffing Box Assembly

VPQ380

1/4 Turn Ceramic Disc

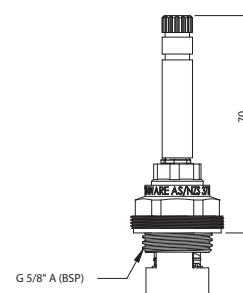

School Pattern Basin/Sink Stuffing Box Assembly

VPQ381

1/4 Turn Ceramic Disc

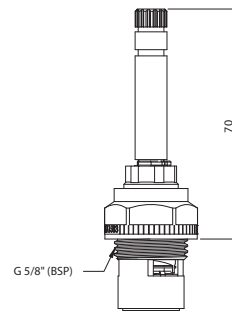

School Pattern Recess Stuffing Box Assembly

VPQ382

1/4 Turn Ceramic Disc Standard

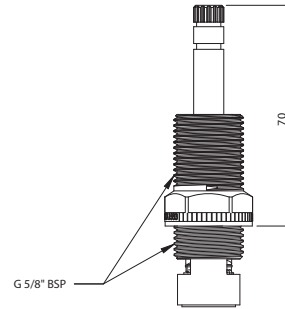

School Pattern Recess Stuffing Box Assembly Extended

VPQ383

1/4 Turn Ceramic Disc 15mm Extended

VPQ384

1/4 Turn Ceramic Disc 20mm Extended

VPQ385

1/4 Turn Ceramic Disc 25mm Extended

VPQ386

1/4 Turn Ceramic Disc 30mm Extended

VPQ387

1/4 Turn Ceramic Disc 40mm Extended

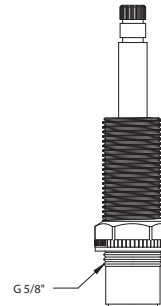

School Pattern Bib/Pillar Top Assembly

VPQ390

1/4 Turn Ceramic Disc

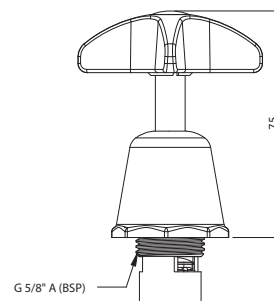

School Pattern Basin/Sink Top Assembly

VPQ391

1/4 Turn Ceramic Disc

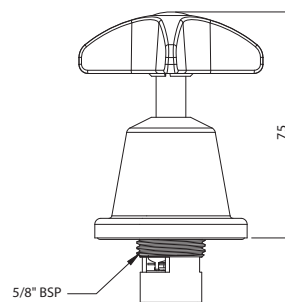

School Pattern Recess Adaptor Extended

VPQ392

1/4 Turn Ceramic Disc 15mm Extended

VPQ393

1/4 Turn Ceramic Disc 20mm Extended



School Pattern Recess Adaptor 20mm Fullway

VP348

Jumper Valve

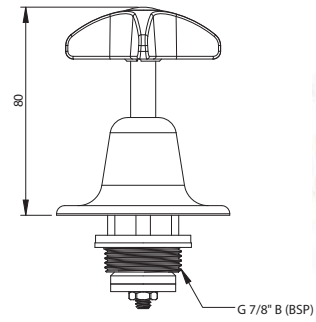

traditional series

A

The easy clean Traditional Series has been proven in some of the busiest washrooms, toilets, showers and amenities.

In applications such as schools, public areas, universities and shopping centres, the resilient Traditional Series continues to provide dependable service year after year.

ENWARE'S RESILIENT VANDAL RESISTANT TRADITIONAL SERIES RANGE FEATURES:

- Vandal-resistant internal locking ring secures the handle – can only be released by the key
- A non-removable Institutional handle is available for higher risk applications
- Highest quality construction in dezincification resistant brass
- Supplied complete with handles, buttons and outlets
- Choice of attractive finishes in standard heavy duty bright chrome, satin chrome and powder coated options.



Enware Tapware is manufactured to the exacting WaterMark standard AS/NZS3718 and AS4020.

water efficiency

ENWARE AUSTRALIA HAS USED THE PERFORMANCE CRITERIA OF:

- AS/NZS6400 – Water Efficient Products – Rating and Labelling
- AS/NZS3718 – Tapware
- AS/NZS3662 – Showers

as the benchmark for our water efficient product performance.

The pressure compensating flow control technology included in Enware's product ensures a more consistent flow rate delivery across the pressure band from 150kPa–500kPa.

TAPWARE



WELS 3 Star (8lpm) water efficiency rating supplied as standard. For 5 Star (6lpm) request when ordering.

SHOWERS



WELS 3 Star (8lpm) water efficiency rating supplied as standard.

options

FINISHES:

- Bright chrome is standard
- Optional satin chrome or epoxy powder coating

INDICATORS:

- Traditional and Institutional: Supplied standard with Red or Blue buttons
- Yellow for warm water is also available; specify your requirements when ordering

SPOUT OPTIONS:

- Custom sizing and shapes are available; please refer to Outlets on Page 208

OUTLET OPTIONS:

- Aerators are supplied standard on basin and sink mixing sets
- Laminar flow is available, please refer to Enware's Outlets brochure for further details

VALVING OPTIONS:

- Jumper Valve — **IN** (removable handle)
INS (non removable handle)
- ¼ turn Ceramic Disc — **INQ**
- ½ turn Ceramic Disc — **INH**
- ¾ turn Ceramic Disc — **INT**

technical information

	CERAMIC DISC	JUMPER VALVE
Minimum–Maximum Working Pressure (AS/NZS 3500)*	50–500kPa	30–500kPa
Maximum Static Pressure	800kPa	1200kPa
Maximum Working Temperature**	85°C	95°C

*Enware products are to be installed in accordance with AS/NZS3500. **Heated Water Supply AS/NZS 3500.4: For all sanitary fixtures used primarily for personal hygiene purposes are to deliver heated water not exceeding: **a) 45°C** for early childhood centres, primary and secondary schools and nursing homes or similar facilities for young, aged care, sick people with disabilities **b) 50°C** in all other buildings.

wall depth adjustments

Enware's recess tapware have adjustments for installation flexibility – Standard spindle adjustment is shown here. Extended spindles are available in 15, 20, 25, 30 and 40mm.

JUMPER VALVE

From 1mm behind finished wall to 15mm behind finished wall.

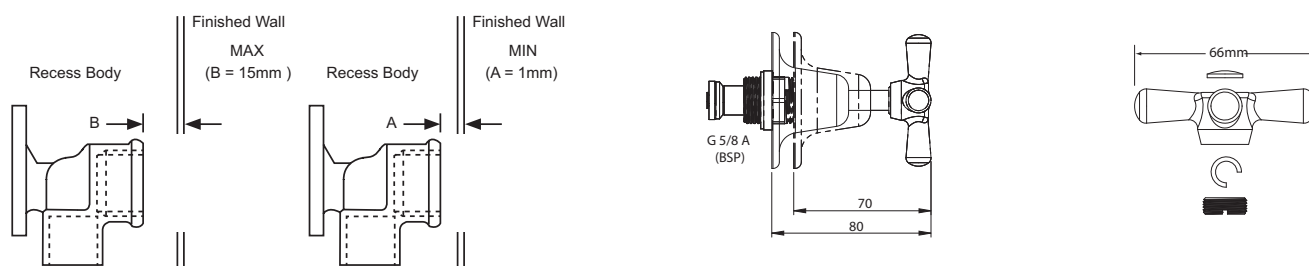

CERAMIC DISC

From 3.5mm behind finished wall to 17mm behind finished wall.

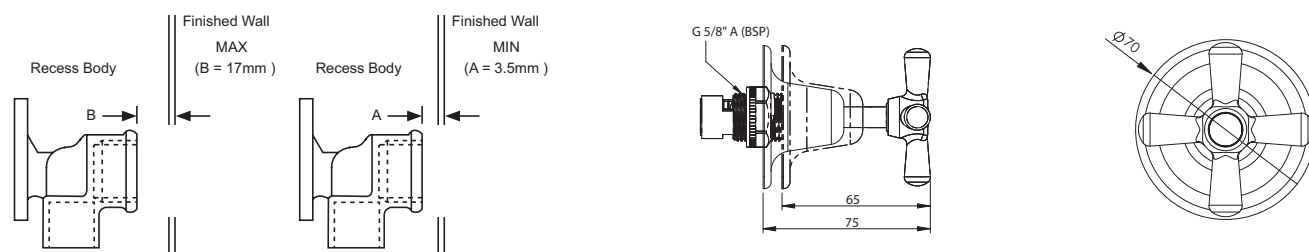

Product details in this guide are indicative only and may change without notice.

Traditional Recess Adaptor

IN308	Jumper Valve Standard
INH308	1/2 Turn Ceramic Disc Standard
INQ308	1/4 Turn Ceramic Disc Standard
INS308	Jumper Valve — Non Removable Handle Standard
INT308	3/4 Turn Ceramic Disc Standard

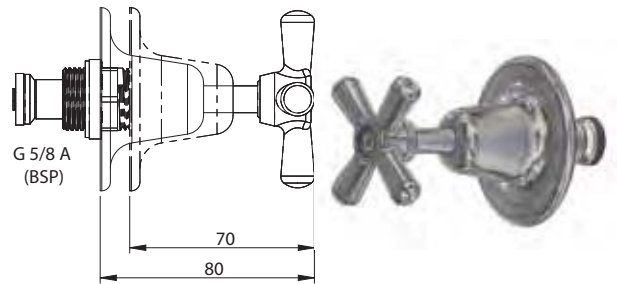

Traditional Recess Adaptor 20mm Fullway

IN348	Jumper Valve
-------	--------------

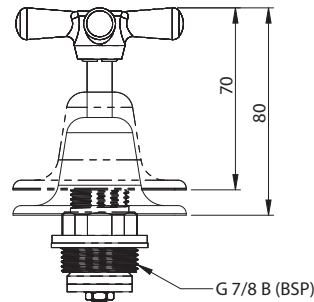

Traditional Forward Bowl Sink Set With SP010 Spout

IN307	Jumper Valve
INH307	1/2 Turn Ceramic Disc
INQ307	1/4 Turn Ceramic Disc
INS307	Jumper Valve — Non Removable Handle
INT307	3/4 Turn Ceramic Disc

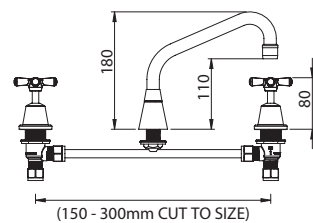

Traditional Recess Set With SP110 Swivel Spout

IN315	Jumper Valve
INH315	1/2 Turn Ceramic Disc
INQ315	1/4 Turn Ceramic Disc
INS315	Jumper Valve — Non Removable Handle
INT315	3/4 Turn Ceramic Disc

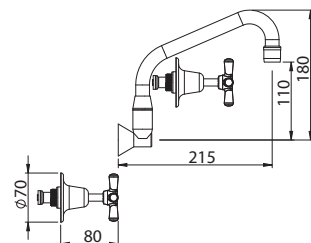

Traditional Dual Mixer With SP020 Spout

IN370	Jumper Valve
INH370	1/2 Turn Ceramic Disc
INQ370	1/4 Turn Ceramic Disc
INT370	3/4 Turn Ceramic Disc

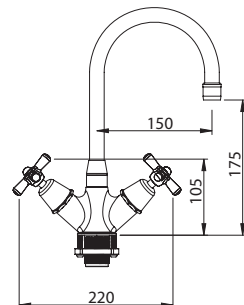

Traditional Basin Set With SP001 Spout

IN306	Jumper Valve
INH306	1/2 Turn Ceramic Disc
INQ306	1/4 Turn Ceramic Disc
INS306	Jumper Valve — Non Removable Handle
INT306	3/4 Turn Ceramic Disc

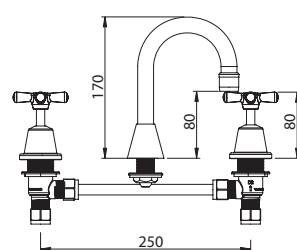

Traditional Pillar Tap 15mm

IN302	Jumper Valve
INH302	1/2 Turn Ceramic Disc
INQ302	1/4 Turn Ceramic Disc
INS302	Jumper Valve — Non Removable Handle
INT302	3/4 Turn Ceramic Disc

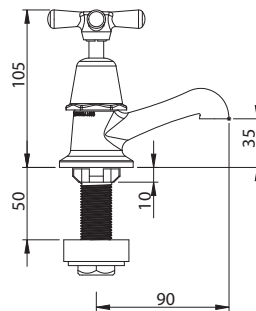

Traditional Pillar Tap

IN327	Aerated Outlet — Jumper Valve
INQ327	Aerated Outlet — 1/4 Turn Ceramic Disc

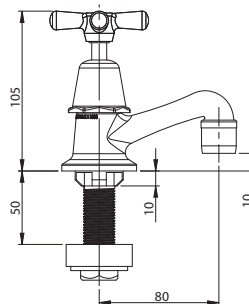

Traditional Bib Tap MI 15mm

IN312M	Ablution Outlet — Jumper Valve
INQ312M	Ablution Outlet — 1/4 Turn Ceramic Disc

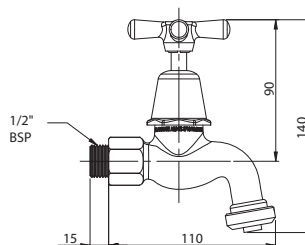

Traditional Bib Tap MI

IN325M	Jumper Valve
INQ325M	1/4 Turn Ceramic Disc

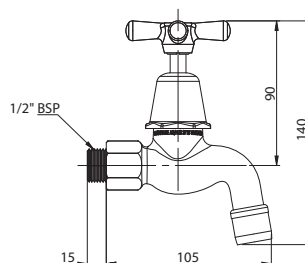

Traditional Bib Tap FI 15mm

IN301F	Jumper Valve
INH301F	1/2 Turn Ceramic Disc
INQ301F	1/4 Turn Ceramic Disc
INS301F	Jumper Valve — Non Removable Handle
INT301F	3/4 Turn Ceramic Disc

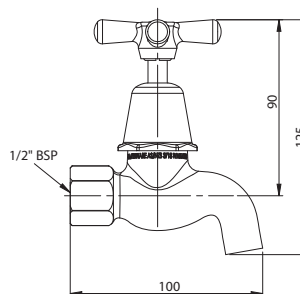

Traditional Bib Tap MI 15mm

IN301M	Jumper Valve
INH301M	1/2 Turn Ceramic Disc
INQ301M	1/4 Turn Ceramic Disc
INS301M	Jumper Valve — Non Removable Handle
INT301M	3/4 Turn Ceramic Disc

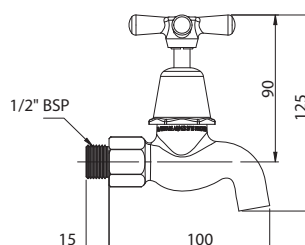

Traditional Bib Tap FI 50mm Extended

IN321F

Jumper Valve

INQ321F

1/4 Turn Ceramic Disc

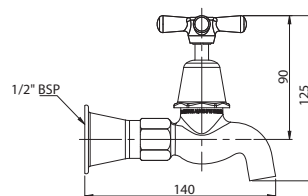

Traditional Bib Tap FI 50mm Extended

IN322F

Aerated Outlet — Jumper Valve

INQ322F

Aerated Outlet — 1/4 Turn Ceramic Disc

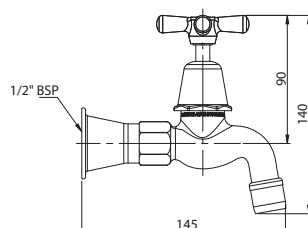

Traditional Bib Tap FI 50mm

IN333F

Ablution Outlet — Jumper Valve

INQ333F

Ablution Outlet — 1/4 Turn Ceramic Disc

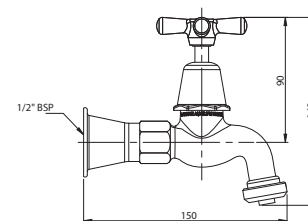

Traditional Bib Tap FI 15mm

IN312F

Ablution Outlet — Jumper Valve

INQ312F

Ablution Outlet — 1/4 Turn Ceramic Disc

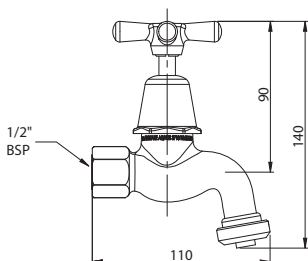

Traditional Bib Tap FI

IN325F

Aerated Outlet — Jumper Valve

INQ325F

Aerated Outlet — 1/4 Turn Ceramic Disc

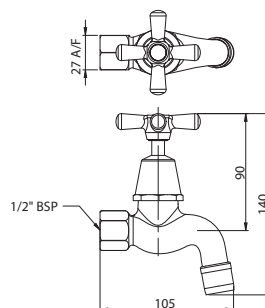

Traditional Shampoo Set Basin Mounted

IN346

Jumper Valve

INQ346

1/4 Turn Ceramic Disc

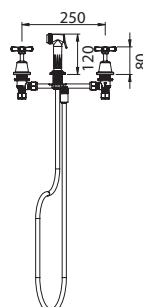

Traditional Recess Set With SP261 Shower

IN316	Jumper Valve
INH316	1/2 Turn Ceramic Disc
INQ316	1/4 Turn Ceramic Disc
INT316	3/4 Turn Ceramic Disc

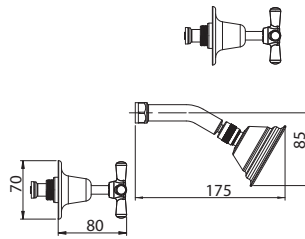

Traditional Recess Set With SP263 Shower

IN349	Jumper Valve
INH349	1/2 Turn Ceramic Disc
INQ349	1/4 Turn Ceramic Disc
INT349	3/4 Turn Ceramic Disc

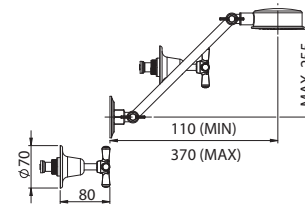

Traditional Shower Set With VP310 Shower

IN354	Jumper Valve
INH354	1/2 Turn Ceramic Disc
INQ354	1/4 Turn Ceramic Disc
INT354	3/4 Turn Ceramic Disc

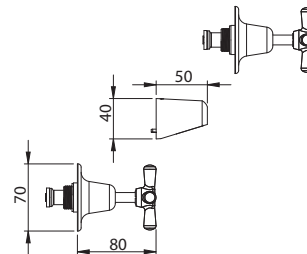

Traditional Recess Set With SP272 White Hand Held Shower and 1.5m Hose

IN361	Jumper Valve
INQ361	1/4 Turn Ceramic Disc

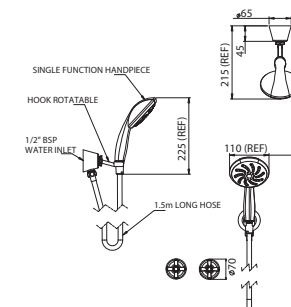

Traditional Recess Set With SP272C Chrome Hand Held Shower and 1.5m Hose

IN361C	Jumper Valve — Smooth Matte Chrome Hose
INQ361C	1/4 Turn Ceramic Disc — Smooth Matte Chrome Hose

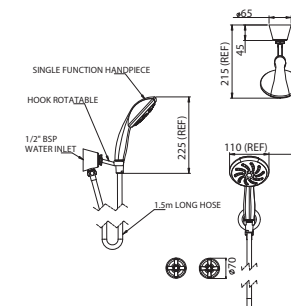

Traditional Recess Set With SP273 White Hand Held Shower and Heavy Duty 900mm Wall Bar

IN363	Jumper Valve
INQ363	1/4 Turn Ceramic Disc

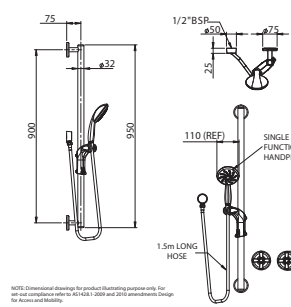

NOTE: Dimensional drawings for product identification purposes only. For full compliance refer to 457424 1 2009 and 2010 installation drawings for details and details.

Traditional Recess Set With SP273C Chrome Hand Held Shower and Heavy Duty 900mm Wall Bar

IN363C	Jumper Valve — Smooth Matte Chrome Hose
INQ363C	1/4 Turn Ceramic Disc — Smooth Matte Chrome Hose

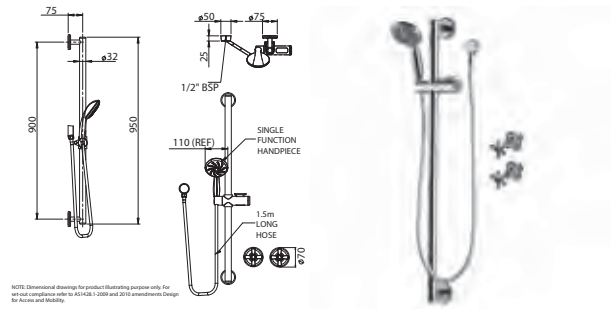

Traditional Recess Set With SGR023 White Hand Held Shower and 1.5m Hose with 900mm Stainless Steel Grab Rail

IN364	Jumper Valve
INQ364	1/4 Turn Ceramic Disc

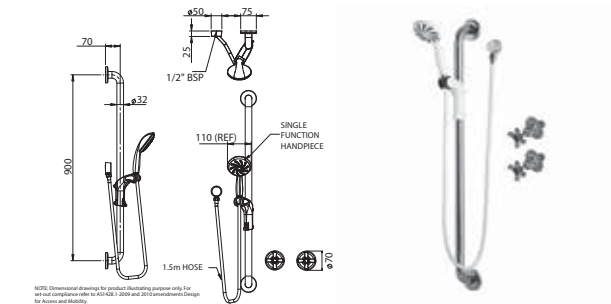

Traditional Recess Set With SGR023C Chrome Hand Held Shower and 1.5m Hose with 900mm Stainless Steel Grab Rail

IN364C	Jumper Valve — Smooth Matte Chrome Hose
INQ364C	1/4 Turn Ceramic Disc — Smooth Matte Chrome Hose

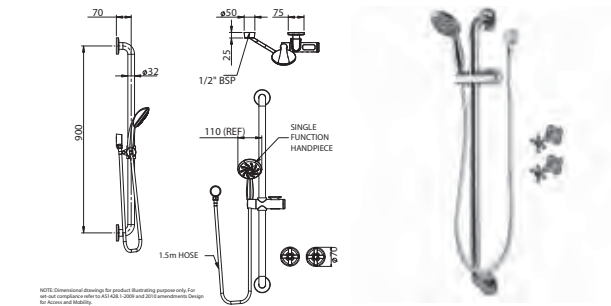

Traditional Recess Set With SP201 Fixed Spout

IN314	Jumper Valve
INH314	1/2 Turn Ceramic Disc
INQ314	1/4 Turn Ceramic Disc
INS314	Jumper Valve — Non Removable Handle
INT314	3/4 Turn Ceramic Disc

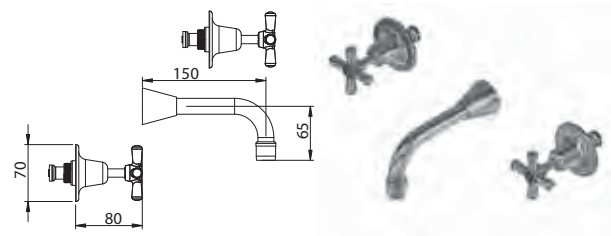

Traditional Recess Set With SP251 Laundry Arm

IN347	Jumper Valve
INQ347	1/4 Turn Ceramic Disc

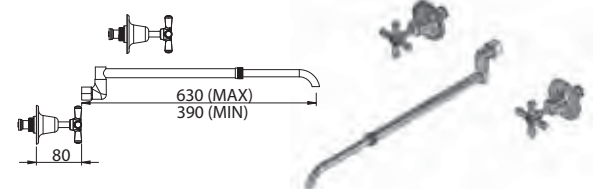

Traditional Washing Machine Tap

IN313	Jumper Valve
INH313	1/2 Turn Ceramic Disc
INQ313	1/4 Turn Ceramic Disc
INS313	Jumper Valve — Non Removable Handle
INT313	3/4 Turn Ceramic Disc

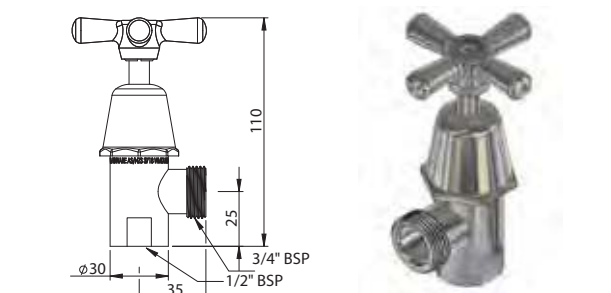

Traditional Cistern Tap Right Angle M&F 15mm

IN303	Jumper Valve
INQ303	1/4 Turn Ceramic Disc
INS303	Jumper Valve — Non Removable Handle

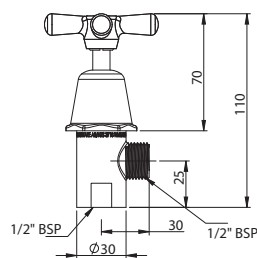

Traditional Stop Tap F&F 15mm

IN304	Jumper Valve
INQ304	1/4 Turn Ceramic Disc
INS304	Jumper Valve — Non Removable Handle

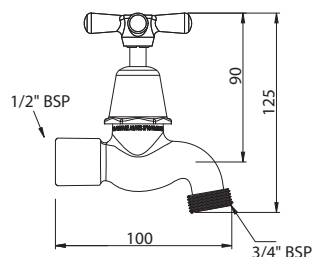

Traditional Hose Tap FI 15mm

IN305F	Jumper Valve
INQ305F	1/4 Turn Ceramic Disc
INS305F	Jumper Valve — Non Removable Handle

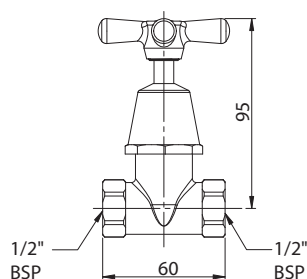

Traditional Stop Tap M&F 15mm

IN344	Jumper Valve
INQ344	1/4 Turn Ceramic Disc

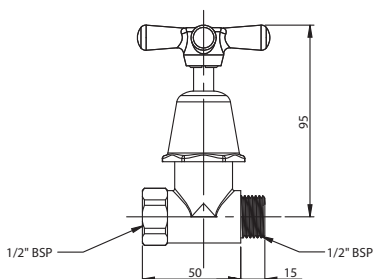

Traditional Hose Tap MI 15mm

IN305M	Jumper Valve
INQ305M	1/4 Turn Ceramic Disc
INS305M	Jumper Valve — Non Removable Handle

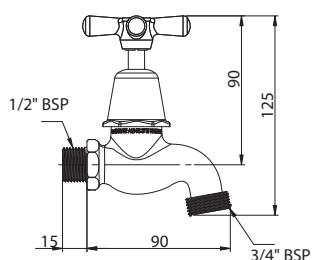

Traditional Hose Tap MI 20mm x 25mm

IN345M	Jumper Valve
--------	--------------

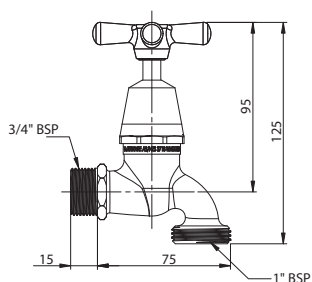

Traditional Recess Set With FS729 Spray

IN365

Jumper Valve

INQ365

1/4 Turn Ceramic Disc

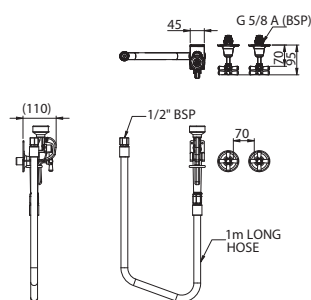

Traditional Handle

IN378

Chrome Plated

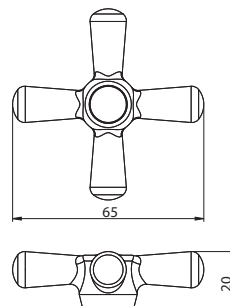

Traditional Pillar/Bib Stuffing Box Assembly

IN380

Jumper Valve

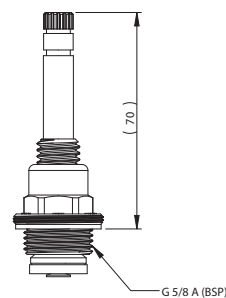

Traditional Pillar/Bib Stuffing Box Assembly

INQ380

1/4 Turn Ceramic Disc

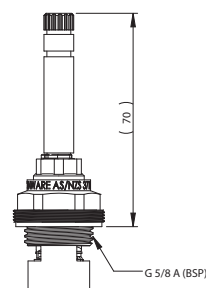

Traditional Basin/Sink Stuffing Box Assembly

IN381

Jumper Valve

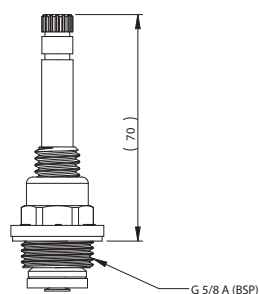

Traditional Basin/Sink Stuffing Box Assembly

INQ381

1/4 Turn Ceramic Disc

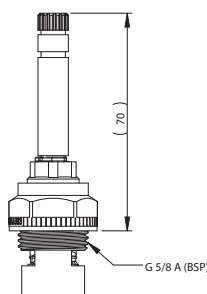

Traditional Recess Stuffing Box Assembly

IN382

Jumper Valve Standard

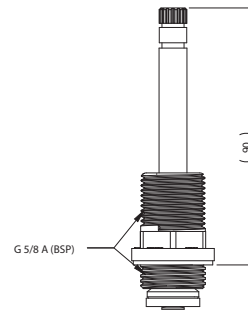

Traditional Recess Stuffing Box Assembly

INQ382

1/4 Turn Ceramic Disc Standard

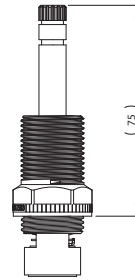

Traditional Recess Stuffing Box Assembly Extended

IN383

Jumper Valve 15mm Extended

IN384

Jumper Valve 20mm Extended

IN385

Jumper Valve 25mm Extended

IN386

Jumper Valve 30mm Extended

IN387

Jumper Valve 40mm Extended

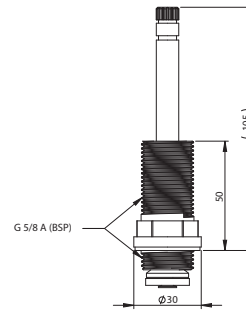

Traditional Recess Stuffing Box Assembly Extended

INQ383

1/4 Turn Ceramic Disc 15mm Extended

INQ384

1/4 Turn Ceramic Disc 20mm Extended

INQ385

1/4 Turn Ceramic Disc 25mm Extended

INQ386

1/4 Turn Ceramic Disc 30mm Extended

INQ387

1/4 Turn Ceramic Disc 40mm Extended

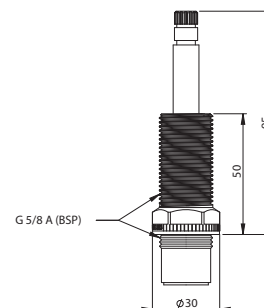

Traditional Pillar/Bib Top Assembly

IN390

Jumper Valve

INS390

Jumper Valve Non Removable Handle

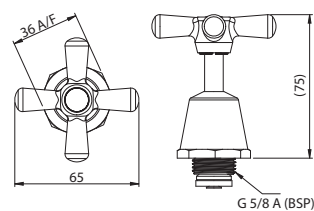

Traditional Pillar/Bib Top Assembly

INQ390

1/4 Turn Ceramic Disc

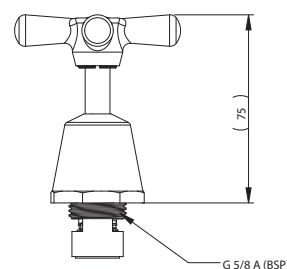

Traditional Basin/Sink Top Assembly

IN391	Jumper Valve
INS391	Jumper Valve — Non Removable Handle

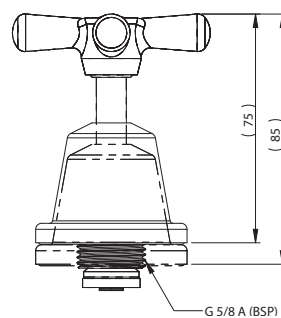

Traditional Basin/Sink Top Assembly

INQ391	1/4 Turn Ceramic Disc
--------	-----------------------

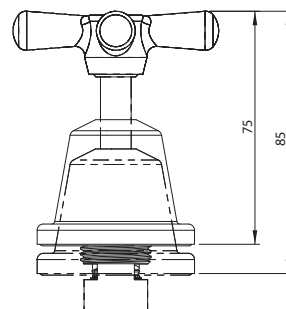

Traditional Recess Adaptor Extended

IN392	Jumper Valve 15mm Extended
IN393	Jumper Valve 20mm Extended
INS392	Jumper Valve — Non Removable Handle — 15mm Extended

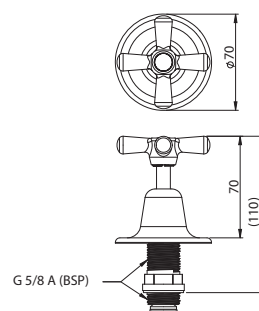

Traditional Recess Adaptor Extended

INQ392	1/4 Turn Ceramic Disc 15mm Extended
INQ393	1/4 Turn Ceramic Disc 20mm Extended



detention series

Tapware and shower systems built to provide the highest level of security with their use of vandal resistant and anti-ligature features.

The extensive range incorporates a smooth, clean finish with minimal horizontal surfaces and eliminates concealed spaces.

Enware can also customise products to meet the specific needs of your facility. Solutions to suit all applications are available, from high risk, high-security through to minimum security, day detention and mental health facilities.

SELECTING A SYSTEM FOR YOUR FACILITY:

Enware delivers three distinct ranges to meet your functional and risk assessment requirements:

- Manually operated tapware
- Enmatic electronic touch activated tapware
- Water Management System (WMS) – a total operational and control solution.



Enware Tapware is manufactured to the exacting WaterMark standard AS/NZS3718 and AS4020.

manually operated tapware

Anti-ligature design with quarter turn ceramic disc headworks. Identification buttons available in Cold, Warm or Hot to suit application.

wall depth adjustments

Enware's recess tapware have adjustments for installation flexibility – Standard spindle adjustment is shown here. Extended spindles are available in 15, 20, 25, 30 and 40mm.

CERAMIC DISC

From 5mm behind finished wall to 13mm behind finished wall.

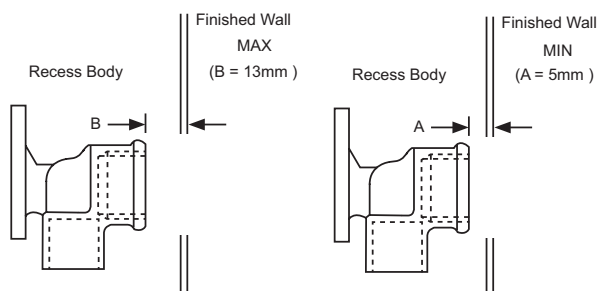

water efficiency



WELS 3 Star (8lpm) water efficiency rating supplied as standard. For 5 Star (6lpm) request when ordering.

technical information

	CERAMIC DISC
Minimum–Maximum Working Pressure (AS/NZS 3500)*	50–500kPa
Maximum Static Pressure	800kPa
Maximum Working Temperature**	85°C

*Enware products are to be installed in accordance with AS/NZS3500. **Heated Water Supply AS/NZS 3500.4: For all sanitary fixtures used primarily for personal hygiene purposes are to deliver heated water not exceeding: a) 45°C for early childhood centres, primary and secondary schools and nursing homes or similar facilities for young, aged care, sick people with disabilities b) 50°C in all other buildings.

automatic shut off tapware – spring action or time flow

SPRING ACTION

Utilises a proven self closing spring action assembly valve. Water flow ceases when the operating mechanism is released by the user.

TIME FLOW

Hydraulically controlled flow of water with approximately 3, 7 or 15 seconds delay depending on unit specified. Preferred for hand washing (dedicated or combination systems) and shower facilities.



water efficiency



Where applicable — WELS 4 Star (8lpm) water efficiency rating supplied as standard. Also available in 3 (9.5lpm) and 6 (6lpm) Star ratings.

technical information

	SPRING ACTION	TIME FLOW
Minimum–Maximum Working Pressure (AS/NZS 3500)*	30–500kPa*	50-500kPa (250–350kPa optimum)
Maximum Static Pressure	1200kPa*	500kPa
Maximum Working Temperature**	70°C	

*Must be installed in accordance with AS3500.1 3.3.4. Maximum pressure within buildings: Provision shall be made to ensure that the maximum static pressure at any outlet, other than a fire service outlet, within a building does not exceed 500kPa.

NOTE: Pressures above 500kPa can cause damage from water hammer, reduced life of appliances, taps and fittings, and cause excessive noise in the system. Minimum pressure 50kPa, refer to standard. For applications outside these parameters contact your Enware representative.

**Heated Water Supply AS/NZS 3500.4: For all sanitary fixtures used primarily for personal hygiene purposes are to deliver heated water not exceeding: a) 45°C for early childhood centres, primary and secondary schools and nursing homes or similar facilities for young, aged care, sick people with disabilities b) 50°C in all other buildings.

shower modules

Anti-ligature design with quarter turn ceramic disc headworks. Identification buttons available in Cold, Warm or Hot to suit application.

water efficiency



WELS 3 Star
(8lpm) water
efficiency rating
supplied as
standard.



technical information

CERAMIC DISC

Minimum–Maximum Working Pressure (AS/NZS 3500)*	50–500kPa
Maximum Static Pressure	800kPa
Maximum Working Temperature**	85°C

*Enware products are to be installed in accordance with AS/NZS3500. **Heated Water Supply AS/NZS 3500.4: For all sanitary fixtures used primarily for personal hygiene purposes are to deliver heated water not exceeding: **a) 45°C** for early childhood centres, primary and secondary schools and nursing homes or similar facilities for young, aged care, sick people with disabilities **b) 50°C** in all other buildings.

outlets and showers

BASIN OUTLETS

Anti-vandal, water efficient outlets for bench and wall mounting.

SHOWER ROSES

Anti-ligature, anti-vandal shower heads for wall or ceiling mounting.

water efficiency

TAPWARE



WELS 3 Star (8lpm) water
efficiency rating supplied as
standard. For 5 Star (6lpm)
request when ordering.



SHOWERS



WELS 3 Star
(8lpm) water
efficiency rating
supplied as standard.



technical information

	CERAMIC DISC
Minimum–Maximum Working Pressure (AS/NZS 3500)*	50–500kPa
Maximum Static Pressure	800kPa
Maximum Working Temperature**	85°C

*Enware products are to be installed in accordance with AS/NZS3500. **Heated Water Supply AS/NZS 3500.4: For all sanitary fixtures used primarily for personal hygiene purposes are to deliver heated water not exceeding: **a) 45°C** for early childhood centres, primary and secondary schools and nursing homes or similar facilities for young, aged care, sick people with disabilities **b) 50°C** in all other buildings.

electronic touch activated

Enware electronic touch activated tapware provides a controlled and reliable interface with a greater level of service authority.

This non-obtrusive robust product replaces protruding tapware with a compact, vandal resistant, low maintenance solution.

Touch activated Piezo technology eliminates moving parts.

The vandal resistant design is well suited to correctional facilities and is also used in clubs, pubs, aquatic centres, beach side esplanades, council amenities and police facilities.

These non-obtrusive products may also suit any self-harm installations such as mental health, detox clinics and similar high-risk environments.



ELECTRONIC TOUCH ACTIVATED FEATURES:

- Operating time frame from 3 seconds to 10 minutes with optional time-out periods and touch on – touch off capability
- The Piezo is fully programmable and adjustable after installation
- Flow times and user rules can be reprogrammed to suit your facility's changing needs
- IP68 waterproof rated Piezo control
- Can integrate with Water Management Systems
- Pressure compensating flow regulation on Enware outlets helps conserve water.

PIEZO PROGRAMMING OPTIONS:

- Run time 3 seconds to 10 minutes
- Time Out 6 seconds to 10 minutes
- 24hr hygiene flush
- Touch off option

ETCHINGS



water efficiency

DUAL FLUSH



WELS 3 Star
(6L full flush and
3L half flush) water
efficiency rating.

SINGLE FLUSH



WELS 1 Star
(5.5L flush) water
efficiency rating.

TAPWARE



WELS 3 Star (8lpm) water
efficiency rating supplied as
standard. For 5 Star (6lpm)
request when ordering.



SHOWERS



WELS 3 Star
(8lpm) water
efficiency rating
supplied as standard.

technical information

FLUSHING

Connection	Inlet — 1" BSP (25mm) Outlet — 1½" BSP (40mm)	
Minimum Water Supply Line Size	1" (25mm) copper pipe	
Mains Powered	24V AC Transformer	
Kv Factor	8.3m³/h	
	SINGLE FLUSH	DUAL FLUSH
Operational Water Supply Pressure to achieve WELS flush volume	250kPa	350kPa
Pan	5.5L Capacity (1 Star)	6/3L Capacity (3 Star) 4.5/3L Capacity (4 Star)

Flush Pipe: 700mm (+/- 100mm) of 1½" (40mm) flush pipe is required below the air break. (Note: use a maximum of 1x90° bend after underneath unit. Use 45° bends in preference) For installation outside of this parameter please contact your Enware representative.

TAPWARE AND SHOWERS

Minimum–Maximum Working Pressure (AS/NZS 3500)*	30–500kPa
Maximum Static Pressure	800kPa*
Maximum Temperature**	70°C
Power Supply	24V AC

*Enware products are to be installed in accordance with AS/NZS3500. **Heated Water Supply AS/NZS 3500.4: For all sanitary fixtures used primarily for personal hygiene purposes are to deliver heated water not exceeding: **a) 45°C** for early childhood centres, primary and secondary schools and nursing homes or similar facilities for young, aged care, sick people with disabilities **b) 50°C** in all other buildings.

water management systems (wms)

A

The Enware Water Management System provides a PC based operating and control solution.

This simple to operate system provides a reliable and controlled interface, offering a greater level of service authority from a secured computer.

ENWARE'S WATER MANAGEMENT SYSTEM WILL:

- Control the supply of water to any fitting in any cell
- Quickly isolate the delivery of water to any fixture within a cell if required
- Enable isolation of a cell, cellblock or a cellblock wing
- Operates on a 24 hour cycle
- Provide complete flexibility to change fixture timing either individually or in groups – including run time and lockout periods
- Provide definable access and lockout periods for all fixtures
- Can be supplied with WELS rated anti-ligature outlets for a complete system
- Provide full password protection
- Can be scaled to accommodate growth
- Output usable data, such as water usage.

These systems are bespoke to suit specific project requirements – please contact your Enware representative for more information.

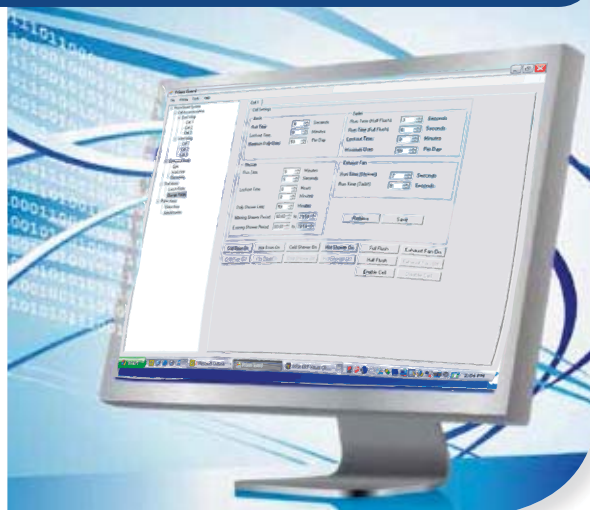

RELATED PRODUCTS

Aquablend Thermostatic Mixing Valves — Page 269

Twyford Rimless Toilet Pan — Page 349

Trouble Dome

DET005	5mm (To Suit DET608 Recess Adaptor)
DET015	10mm (To Suit DET608 Recess Adaptor)

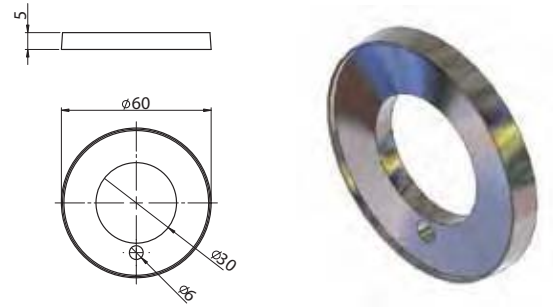

Detention Hot & Cold Basin Set with SP003 Fixed Spout — Standard Breach

DET306

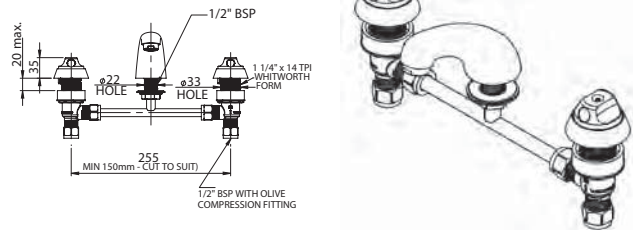

Detention Hot & Cold Basin Set — Flexible Breach

DET306T	With DET619 Outlet for High Flow over 4lpm for TMV Warm Water
DET306W	With DET617 Outlet for Low Flow up to 4lpm

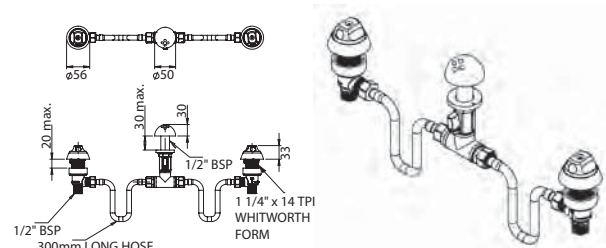

Detention Recess SBA

DET382	1/4 Turn Ceramic Disc
--------	-----------------------

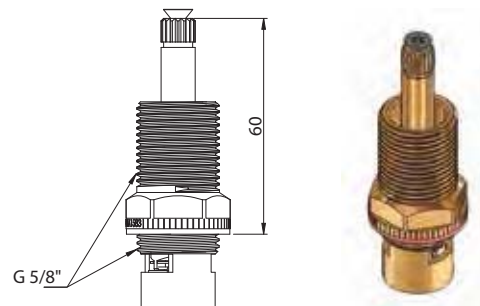

Detention Push Button Self-Closing Valve

DET601	Straight — Spring Action
DET601R	Right Angle — Spring Action
DET603	Straight — Timed Flow 15 Seconds
DET603R	Right Angle — Timed Flow 15 Seconds
DET603RC	Right Angle — Timed Flow 15 Seconds (Suit China Bowl)

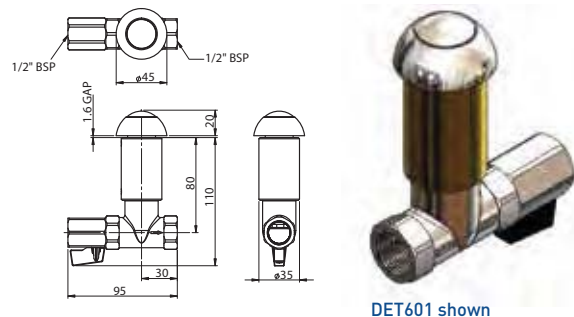

DET601 shown

Detention Recess Adaptor

DET608	Standard
DET608-15EXT	15mm Extended Spindle

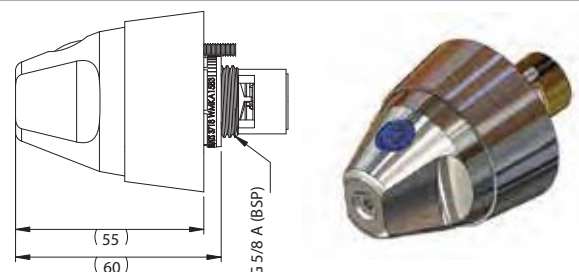

Detention Extended Basin/Bubbler Outlet

DET616

Suit Wall Thickness up to 280mm

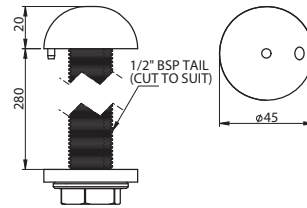

Detention Basin/Bubbler Outlet — Suits Flow Rates Below 4lpm

DET617

Contact Enware technical representative before ordering

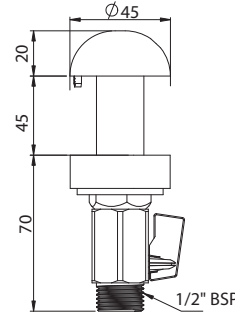

Detention Recess Assembly Extended

DET618

Suit Wall Thickness up to 200mm

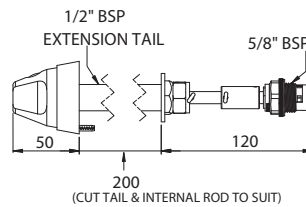

Detention Basin Outlet — 5lpm (Suits Flow Rates of 4 to 8lpm)

DET619

Contact Enware technical representative before ordering

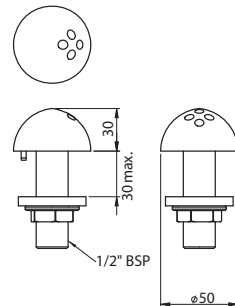

Detention Tools

DET629

Locking Screw Key Only — Suits DET608 Recess Adaptor

DET632

Installation Kit — Suits DET608 Recess Adaptor

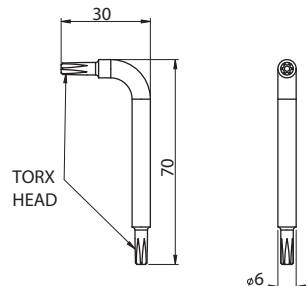

Detention Shower Unit

DET648

Warm Only Control

DET649

Hot & Cold Controls

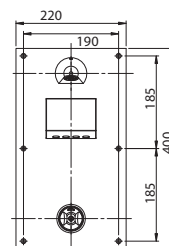

Detention Conical Shower Rose With Extended Tail

DET661

8lpm Suit Wall Thickness up to 200mm

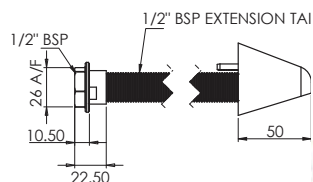

Detention Bath Spout Anti Vandal Aerator With Extended Tail

DET661B

Suits Wall Thickness up to 200mm

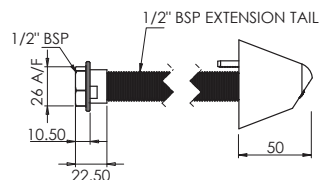

Cell Basin Push Button & Basin Assembly – Straight Through Inlet Design

DET685

Self Closing Spring Action

DET686

Timed Flow 15 Seconds

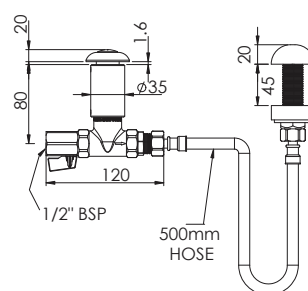

Compact Cell Push Button & Basin Assembly – Right Angle Inlet Design

DET687

Self Closing Spring Action

DET688

Timed Flow 10 Seconds

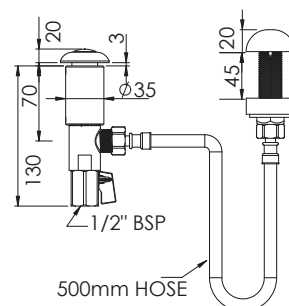

Gaol Cistern Push-Rod Assembly

DLB601

Suit Wall Thickness up to 280mm

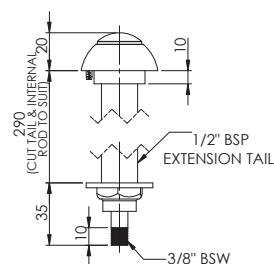

Security Extended Recess Assembly (School Pattern)

DLB618

Suit Wall Thickness up to 200mm

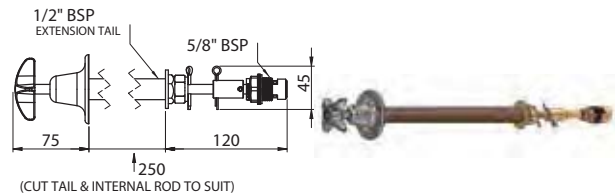

WC Flushing System with Touch Activation — Dual Flush Rear Access

EMF410M-3

Mains Powered — 3 Star WELS rating

EMF410M-4

Mains Powered — 4 Star WELS rating

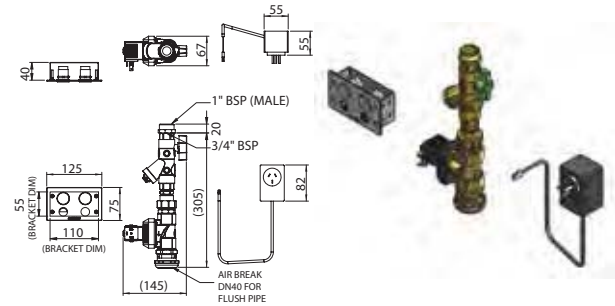

WC Dual Flush Duct With Extended Tail

EMF412M-3

3 Stars WELS Rating

EMF412M-4

4 Stars WELS Rating

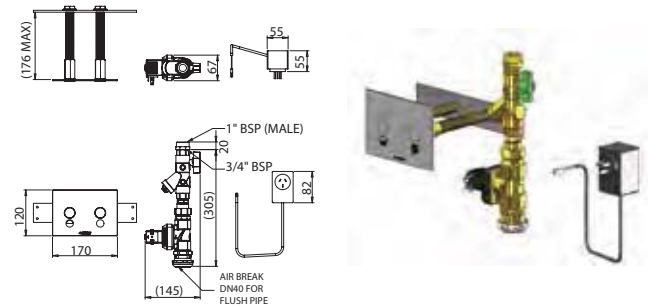

Detention Bath Spout Anti Vandal Aerator 5lpm

DET660B

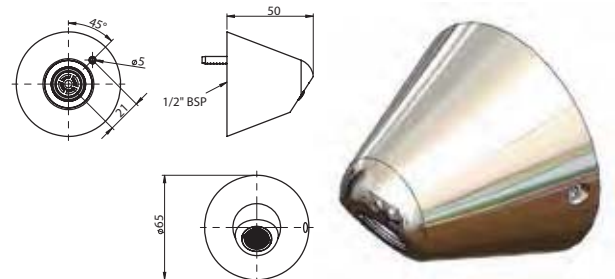

Detention Conical Shower Rose

DET660

8lpm

DET660E

8lpm with Extended Angle

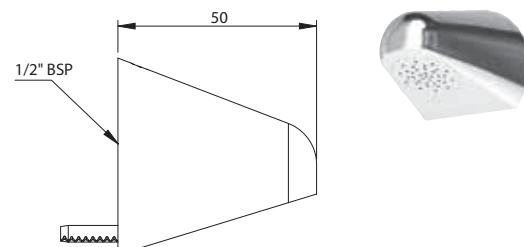

Detention Shower Ceiling Mounted

DET664

7lpm

DET665

7lpm Extended To Suit Wall Thickness
up to 200mm

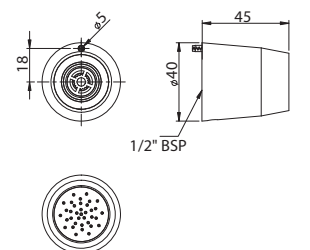

Enmatic Touch Activated Single Button Control Kit — Wall Mounted

EMD810	To suit Basin Install
EMD811	To suit Shower Install



Enmatic Touch Activated Dual Button Control Kit — Wall Mounted

EMD820	To suit Basin and Shower Installations
--------	--

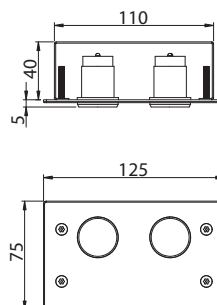

Spare Parts for EMD Touch Activated Control Kits

EMDS800	24V AC — 1 amp — Transformer with 1.8m Lead
EMDS801	2m Extension Lead for EMDS800

key operated and rough brass tapware

Provides control over water systems exposed to the public by using a removable key when isolating or adjusting the valve. The key operated vandal resistant range is made from dezincification resistant (DR) brass.

ENWARE'S KEY OP RANGE FEATURES:

- Removable key protects against unauthorised use and water wastage
- Recess models provide an easily accessible isolation point with a level of security
- Heavy duty construction in dezincification resistant brass
- Rough brass finish or heavy duty bright chrome on selected models
- Comprehensive 12-month manufacturer's warranty
- Jumper Valve SBA.

water efficiency

Tapware in this range does not fall under WELS labelling requirements – these products can be flow controlled to meet local authority requirements. Contact Enware for more information.

options

FINISHES:

- Brass – Supplied standard (unless otherwise stated in the product descriptions)
- Bright Chrome – Heavy-duty bright chrome plate is available

technical information

Minimum–Maximum Working Pressure (AS/NZS 3500)*	30–500kPa
Maximum Static Pressure	1200kPa Max*
Maximum Working Temperature**	Jumper Valve 95°C

*Enware products are to be installed in accordance with AS/NZS3500. **Heated Water Supply AS/NZS 3500.4: For all sanitary fixtures used primarily for personal hygiene purposes are to deliver heated water not exceeding: a) 45°C for early childhood centres, primary and secondary schools and nursing homes or similar facilities for young, aged care, sick people with disabilities b) 50°C in all other buildings.



Enware Tapware is manufactured to the exacting WaterMark standard AS/NZS3718 and AS4020.

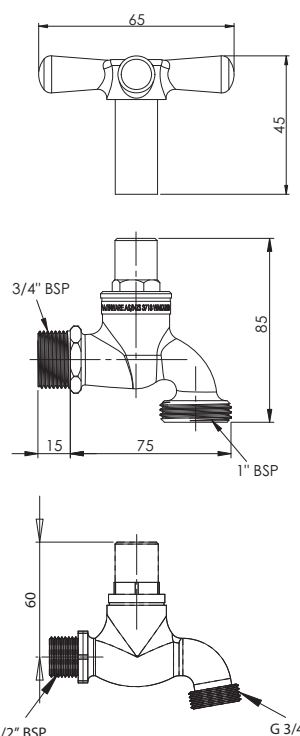

Mini Cistern Tap Screw Operated

RB302

Chrome Plated

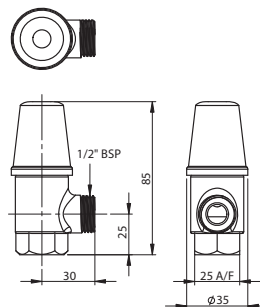

Rough Brass Key Operated Hose Tap 20mm

RB351

Key Handle Not Included

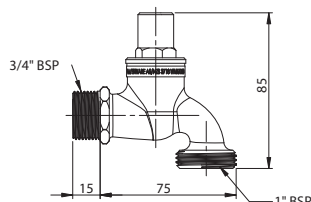

Rough Brass Key Operated Socket Spanner

RB356

Key Handle Only

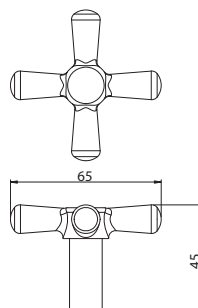

18mm Key Operated Bib/Pillar Stuffing Box Assembly

RP585

Brass

RP586

Chrome Plated

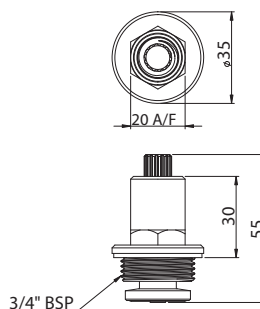

20mm Full Way Key Operated Recess Stuffing Box Assembly

RP589

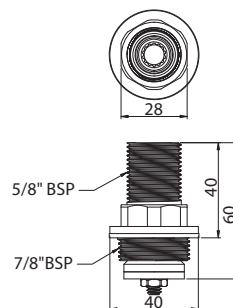

12mm Key Operated Bib/Pillar Stuffing Box Assembly

RP590

Brass

RP591

Chrome Plated

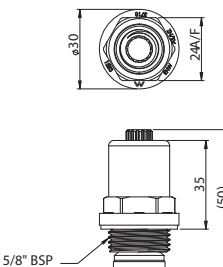

12mm Key Operated Recess Stuffing Box Assembly

RP593

12mm Brass

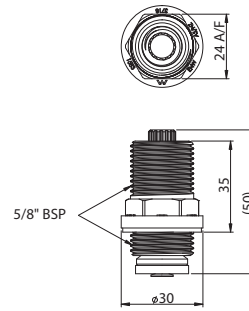

Recess Flange

RP594

No Hole — Chrome Plated

RP597

Hole for Key Handle — Chrome Plated

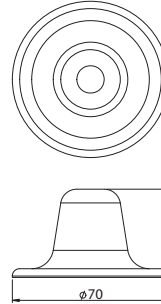

Key Operated Hose Tap 15mm

VP350F

Jumper Valve Female Inlet — Chrome Plated

VP350FDC

Jumper Valve Female Inlet — Chrome Plate with NR Stamped

VP350M

Jumper Valve Male Inlet — Chrome Plated

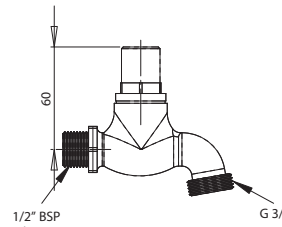

Key Operated Cistern Tap

VP352

Jumper Valve

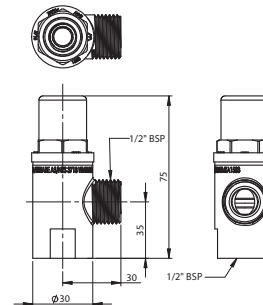

Key Operated Hose Tap 20mm Male Inlet

VP353

Jumper Valve — Chrome Plated

VP355

Jumper Valve — Brass

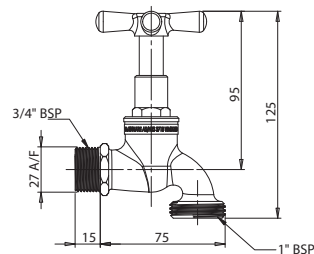

Key Operated Recess Adaptor 20mm Fullway — No Hole in Dome

VP356

Jumper Valve — Chrome Plated

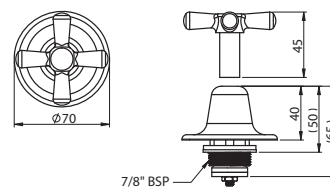

Key Operated Recess Adaptor 15mm — No Hole in Dome

VP357

Jumper Valve — Chrome Plated

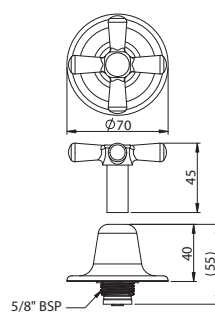

Key Operated 20mm Hose Tap & Key

VPK351

Jumper Valve — Brass

VPK351C

Jumper Valve — Chrome Plated

