

MILLI GLANCE

WALL BATH SET

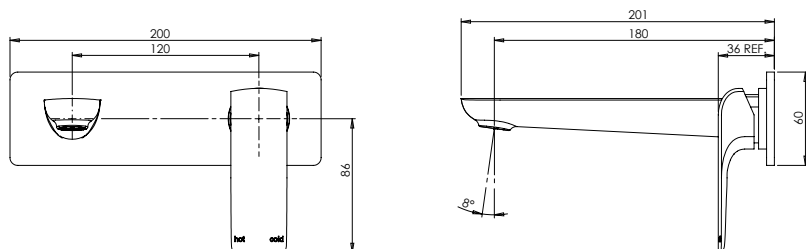

SPECIFICATIONS

Recommended use	Domestic, hotel and commercial
Colour availability	Chrome
Pressure rating	<p>Maximum continuous operating pressure 1000kPa</p> <p>Note: As per AS3500 pressure must be limited to 500kPa on any new home, extension or renovation.</p> <p>Note: For best performance and longer life we recommend 150 - 500kPa</p>
Temperature Rating	Maximum continuous working temperature 65°
Suitable Hot Water Units	<p>Storage Tank - Yes</p> <p>Continuous Flow - Yes</p> <p>Gravity Feed - Not Recommended</p>
Standards	AS / NZS 3718



To see the complete Milli range go to www.reece.com.au/bathrooms

CLEANING RECOMMENDATIONS

We recommend the use of soapy water or approved cleaners.

This product should not be cleaned with abrasive materials.

Damage caused by improper treatment is not covered by the product warranty - refer to warranty conditions.

MILLI GLANCE WALL BATH SET

INSTALLATION INSTRUCTIONS

MILLI GLANCE WALL MIXER SET Installation Instructions

WATER SUPPLY REQUIREMENTS

To ensure optimum performance and customer satisfaction please adhere to the following:

- Maximum hot water temperature 75°C.
- Recommended minimum working pressure 150kPa.
- Recommended maximum working pressure 500kPa.

If the water pressure exceeds or is likely to exceed 500kPa, an approved pressure limiting valve must be fitted.

- Flush out all pipe work prior to installation.
- If the water temperature exceeds 75°C an approved tempering valve must be fitted.
- Installation should comply with Australian standard AS3500.1 or relevant local authority requirements.

Failure to comply with the above may void all warranties.

Maintenance and Care

Chrome plated surfaces should be cleaned with mild liquid detergent or soap and water. Do not use cream cleaners, as they are abrasive. Use of unsuitable cleaning agents may damage the surface. Any damage caused in this way will not be covered by warranty.

Guarantee

This product is guaranteed against faulty workmanship and materials for 1 year from the date of purchase. Installation must be done by a licensed plumber or this guarantee will be void.

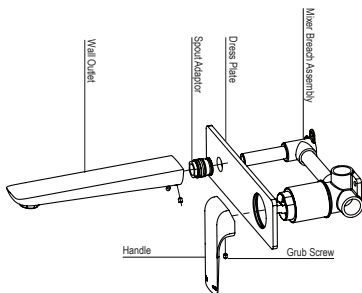

IN0128 revA

