

## Domaine Fixed Single Shower Bath Panel

PLEASE NOTE YOUR DOMAINE SHOWER BATH PANEL IS DESIGNED TO FIT INSET BATHS WITH A TILE BEAD.

**THIS PRODUCT MUST BE INSTALLED BY A QUALIFIED TRADESMAN**



- ❶ Unpack & check the item is correct & not damaged. If there are any visible defects do not proceed with the installation & contact the place of purchase immediately. **ANY CLAIMS FOR DAMAGE WILL NOT BE ACCEPTED AFTER INSTALLATION.**
- ❷ Ensure there is a gasket between glass & metal components.
- ❸ Leave the plastic protectors on the glass corners for as long as possible & handle with care.
- ❹ In cold climates, warming the gaskets & seals with hot water or a hairdryer will assist with the installation.
- ❺ A risk assessment should be completed prior to commencing the installation to ensure safe practices are followed for the manual handling of the fragile glass.

### SAFETY EQUIPMENT REQUIRED FOR INSTALLATION



☐ Protective Clothing



☐ Foot Protection



☐ Eye Protection



☐ Hand Protection

### TOOLS REQUIRED FOR INSTALLATION

**ENSURE YOU HAVE ALL TOOLS FOR THE COMPLETE INSTALLATION BEFORE COMMENCING.**

- |   |   |   |   |
|---|---|---|---|
| <input type="checkbox"/> Silicone Sealant | <input type="checkbox"/> Drill                | <input type="checkbox"/> Level                | <input type="checkbox"/> Rubber Mallet  |
| <input type="checkbox"/> Pencil           | <input type="checkbox"/> Phillips Screwdriver | <input type="checkbox"/> Tape Measure         | <input type="checkbox"/> Cutting Pliers |
| <input type="checkbox"/> Utility Knife    | <input type="checkbox"/> 6mm (1/4") Drill Bit | <input type="checkbox"/> 3mm (1/8") Drill Bit |   |

- Use the correct drill bit for the material being drilled. The 6mm drill bit is required for anchor fixing and the 3mm drill bit is required for screwing directly into the wall studs.
- As with all toughened safety glass, take care while handling and wear safety glasses and gloves for protection.

Note: Drawings are only indicative

Plumbers, please ensure a copy of the installation instructions is left with the end user for future reference

### Domaine Fixed Single Shower Bath Panel

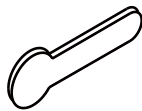
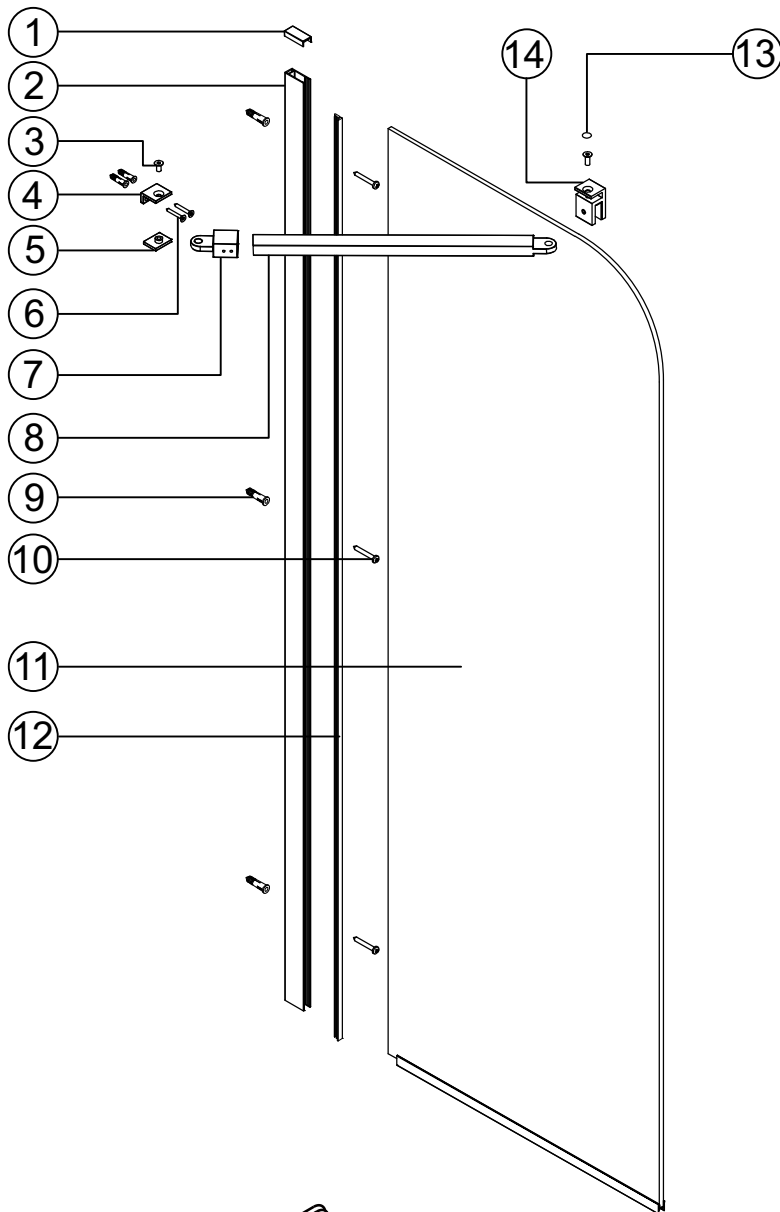

15

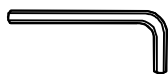

16

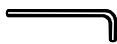

17

No.	Description	QTY
1	Channel Cap	1
2	Wall Channel	1
3	Countersunk Screw M6x12	2
4	Bracket Base	1
5	Bracket Clamp	1
6	Countersunk Head Screw (ST4x30)	2
7	Brace End	1
8	Brace Bar	1
9	Wall Anchor	5
10	Pan-head Screw (ST4x40)	3
11	Glass	1
12	Wall Channel Gasket	1
13	Screw Cap	2
14	Glass Clamp	1

### Domaine Fixed Single Shower Bath Panel

#### 1 Install the wall channel

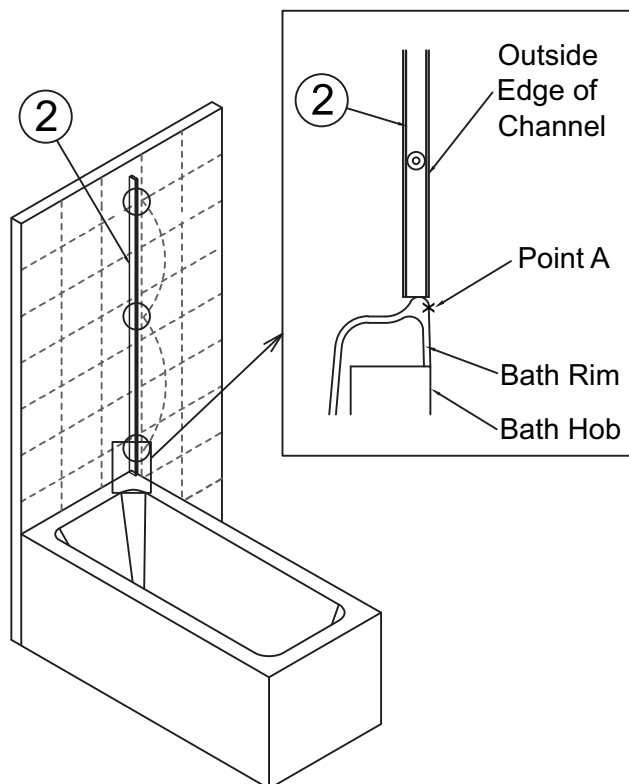

Install the wall channel so it is vertical, and the outside edge is vertically in line with 'Point A' (see drawing).

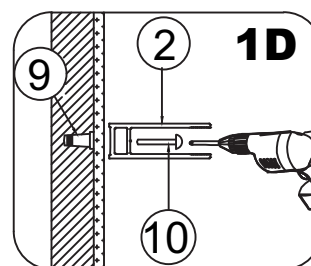
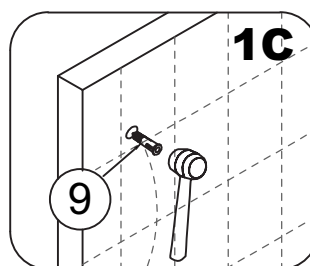
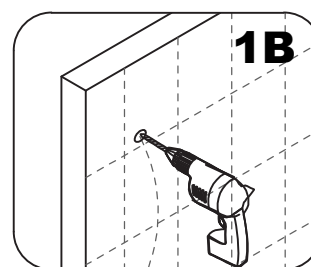
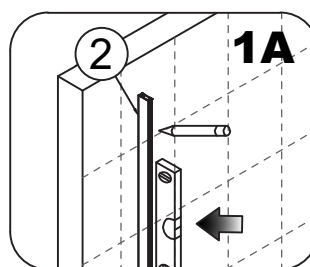

#### 2 Install the fixed panel

**Important:** leave the corner protectors on the panel until the last possible moment.

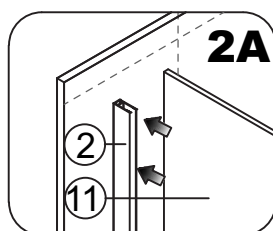
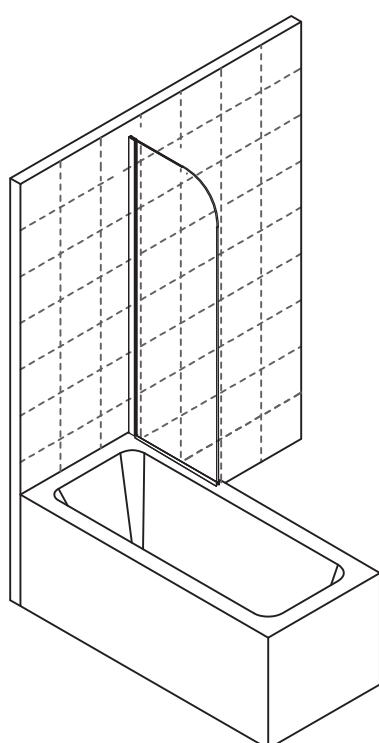

Carefully slide the glass in until the bottom 'H' extrusion on the glass reaches the wall channel extrusion.

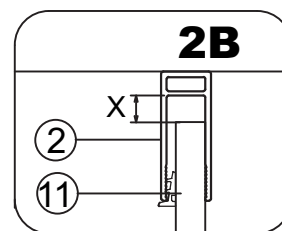

This dimension should be 8mm at the bottom and 0-16mm at the top, depending on how level the wall is.

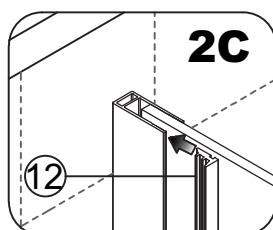

The seal goes on the bath (wet) side of the glass.

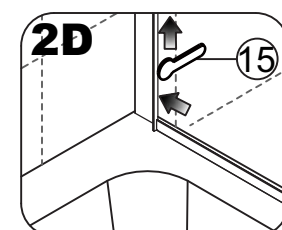

Press the seal all the way into the wall channel, starting at the bottom.

## Domaine Fixed Single Shower Bath Panel

### 3 Install the fixed panel brace

The brace may be installed on either side of the glass to suit the bathroom. It is installed at a 45 degree angle to the wall and glass.

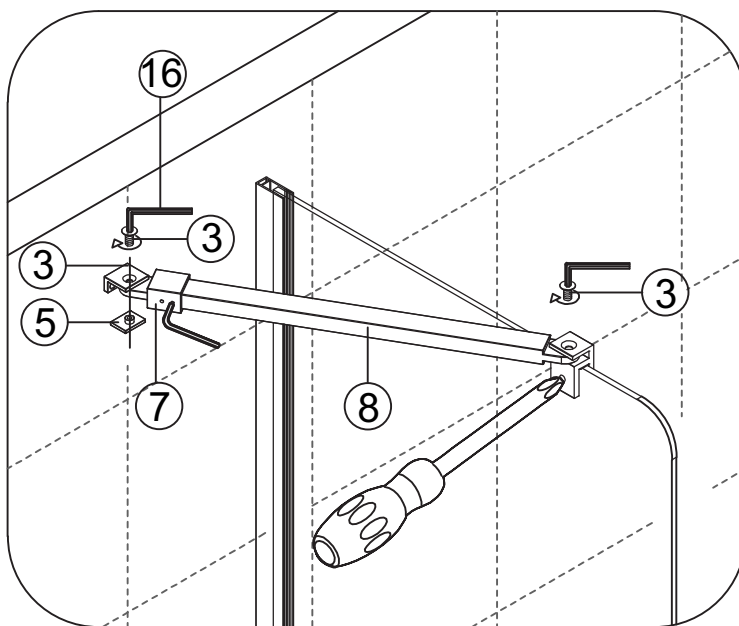
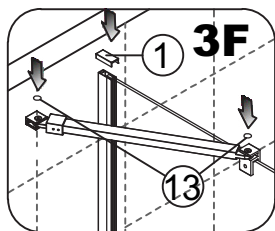
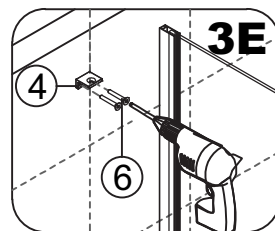
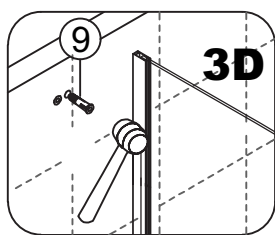
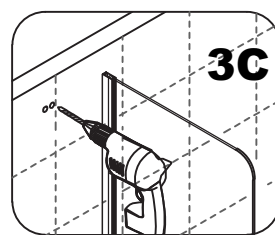
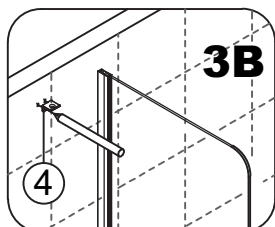
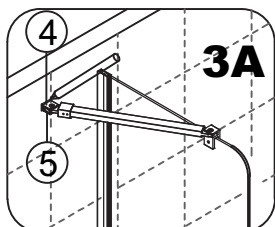

### 4 Apply silicone

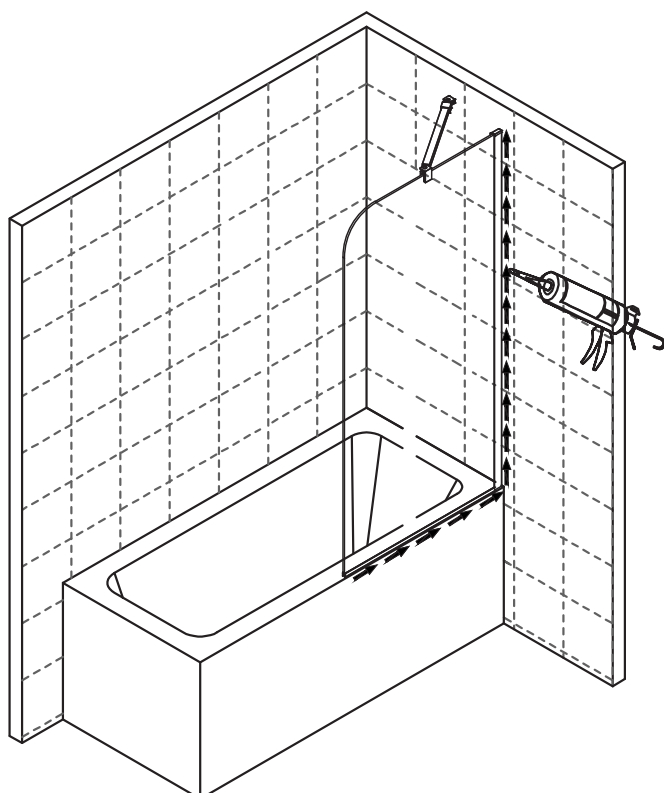

Silicone the inside and outside of the shower, and allow 24 hours before use.