

### Shower Mixer Tap Inwall Body

**1**

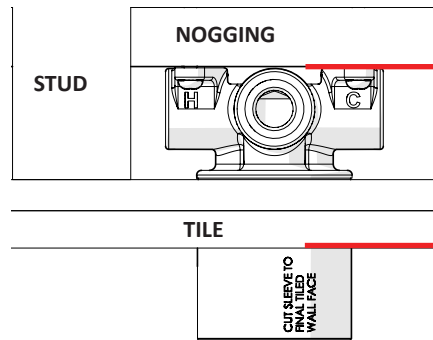
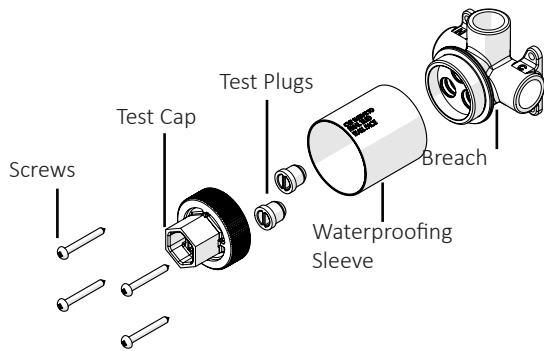

**53mm to 64mm  
ADJUSTMENT  
RANGE**

Product complies with the Lead-free requirements of the national construction code volume 3

**2**

Screw the Mixer Breach onto Nogging to dimensions shown in adjustment range.

Ensure that the mixer body is level.

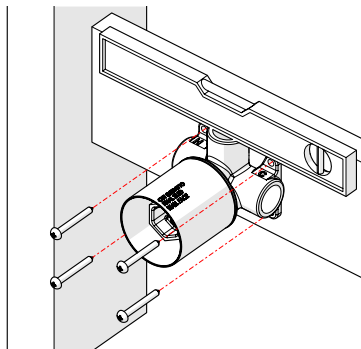

**3**

Plumb all connections to Mixer Body.

Ensure wall outlet fitting is capped. Perform **PRESSURE TEST** and check for leaks.

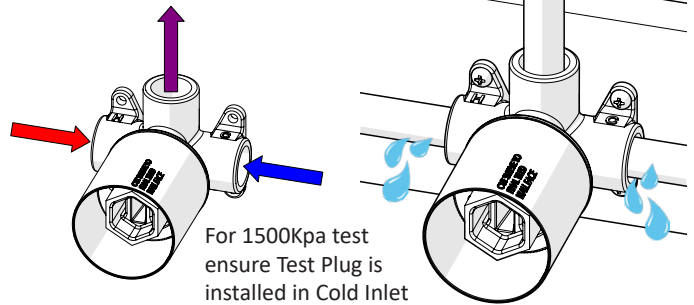

**4**

Create a 50mm diameter hole in the cement sheet or Plasterboard.

Apply waterproofing membrane up to Waterproofing Sleeve.



**5**

After Tiling use Knife to Trim Waterproofing Sleeve flush to Tile face.

Ready for fit off (Order Trim Kit separately).

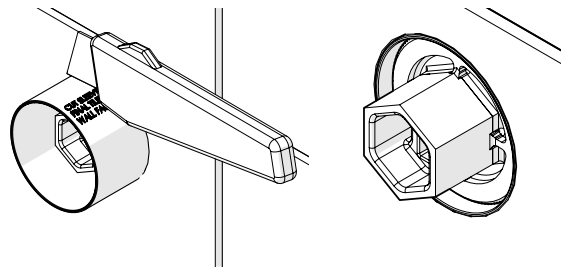

#### FOR STANDARD PRESSURE TESTING

Up To 500Kpa

Product comes pre-installed with a Test Plug in the Hot Inlet only As shown in step 1 and a Test Cap.

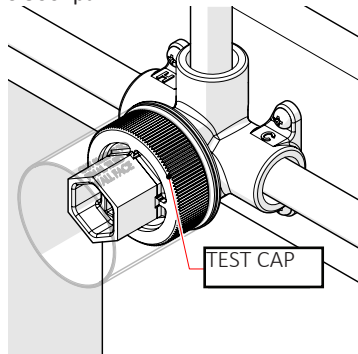

#### FOR HIGH PRESSURE TESTING

500-1500Kpa

For high pressure testing of pipes, remove Test Cap and add another Test Plug into the Cold Inlet. Re-attach Test Cap. **Hand Tighten + 120° OR 10 N m.**

Perform high pressure test for 30 minutes. As per AS3500.1

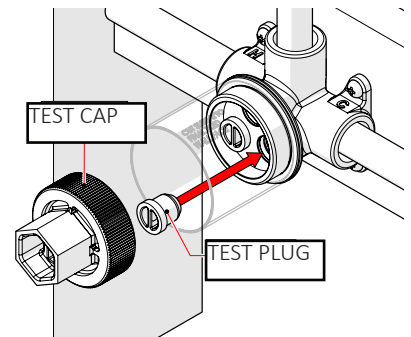

### Care Details

We recommend the use of soapy water or approved cleaners. This product should not be cleaned with abrasive materials. Damage caused by any improper treatment is not covered by the product warranty. Refer to Warranty Conditions

Installation should comply with Australian standard AS3500.1 or relevant local authority requirements. Showers may not be suitable for use within:

- Gravity-fed water systems
- Some instantaneous hot water systems

Any flow controller incorporated in the outlet to be tightened to prevent removal by hand. As Per AS3718

**Plumbers, please ensure a copy of the installation instruction is left with the end user for future reference.**

