

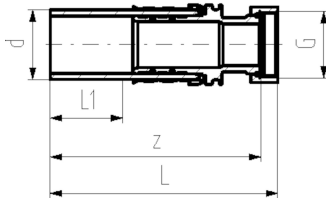

## COOL-FIT 4.0 Adaptor fitting PE/stainless steel with loose union nut G

### Model:

- Spigot fitting PE100 SDR11, metric with free end
- Stainless steel 1.4404 / 316L with female thread G
- Including flat seal EPDM
- Including insulation half shells



d	G	PN	Part No.	weight	D	L	L1	L2	z
(mm)	(mm)	(bar)		(kg)	(mm)	(mm)	(mm)	(mm)	(mm)
32	1/2"	16	<b>738 943 308</b>	0.250	104	133	36	101	126
32	3/4"	16	<b>738 943 318</b>	0.264	104	135	36	101	129
32	1"	16	<b>738 943 328</b>	0.296	104	135	36	101	129
40	1 1/4"	16	<b>738 943 309</b>	0.595	128	155	40	91	148
40	1 1/2"	16	<b>738 943 319</b>	0.655	128	157	40	91	148
50	1 1/2"	16	<b>738 943 310</b>	0.820	138	164	44	96	154
63	2"	16	<b>738 943 311</b>	1.307	149	186	48	103	170

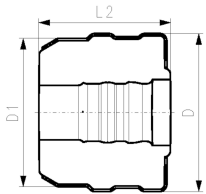

The technical data are not binding. They neither constitute expressly warranted characteristics nor guaranteed properties nor a guaranteed durability. They are subject to modification. Our General Terms of Sale apply.

Georg Fischer Piping Systems Ltd, Postfach, CH-8201 Schaffhausen/Switzerland

Phone +41 -(0)52-631 1111

e-mail: [info.ps@georgfischer.com](mailto:info.ps@georgfischer.com)

Internet: <http://www.gfps.com>