

Scala Nova Sink Hob Mixer Set Pull Out Spray

SUSSEX

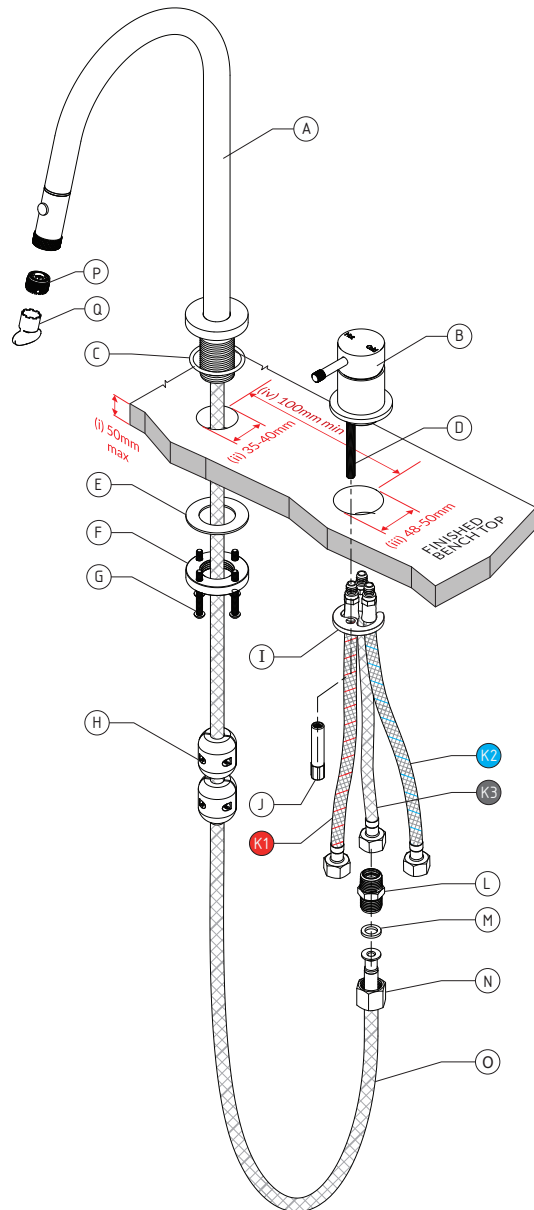

Product code

SNSHMSPOS.01

Install Preparation:

- The Mixer is supplied pre-assembled, the Clamping Ring (E), Clamps (F & I), Fixing Nut (J) and Weights (H) and need to be temporarily removed prior to installation.
- Maximum bench thickness is 50mm (i).
- Outlet Clearance Hole: 35 - 40mm (ii).
- Hob Mixer Clearance Hole: 48 - 50mm (iii).
- Minimum Distance between Outlet and Hob Mixer is 100mm (iv) centre to centre.
- Mounting Surface must be flat and level.
- Ensure adequate cupboard space has been provided to allow the Pull-out hose to move freely.

Product parts:

- (A) Outlet Assembly (Preassembled)
- (B) Hob Mixer Assembly (Pre-assembled)
- (C) O-Ring
- (D) Thread Bar
- (E) Outlet Clamping Ring
- (F) Clamp
- (G) Jacking Screws
- (H) Weights
- (I) Hob Mixer Clamp
- (J) Fixing Nut
- (K) Flexible hoses with 1/2" BSP Fittings with Conical Seals (K1= HOT, K2 = COLD and K3 = MIXED)
- (L) Dual Check Valve (DCV)
- (M) Swivel Hose Gasket
- (N) Swivel Nut
- (O) Pull-out Hose
- (P) Aerator
- (Q) Aerator Key

Plumbers note:

- Tapware is to be installed by a Licensed Plumber in accordance with AS/NZS 3500:2021
- Recommended working water pressure 300 - 500 Kpa. Maximum water temperature is 65°C
- After installation, ensure that tapware functions correctly without leaks.
- Please ensure a copy of the Installation Instructions are left with the end user for future reference.



While we aim to ensure the specifications shown are correct at time of printing, Sussex Taps reserves the right to make modifications without prior notice. Always use the physical product for accurate measurements. Dimensions are subject to change without notice. All measurements are shown in millimetres. This product complies with lead free requirements.



Step 1

For the Outlet (A), first remove the Clamping Ring (E), Clamp (F) and Weights (H) from the Pull-out Hose (O) then pass the Pull-out Hose and through the mounting surface. Working from underneath, fit the Clamping Ring and Clamp to the outlet's tail. Wind the clamp up as far as possible, then tighten the 4 Jacking Screws (G) to secure the Outlet. (tighten well).

For the Hob Mixer (B), remove Fixing Nut (J) and Clamp (I) then feed the preinstalled and labelled hoses (K1, K2 & K3) through the bench. Apply a small amount of Sealant to the under side of the Hob Mixer Flange to seal the Mounting Surface. Note: The "FRONT" label must be positioned to face the user. Working from underneath, fit the Clamp onto the Thread Bar (D) then tighten with Fixing Nut (J). (tighten well).

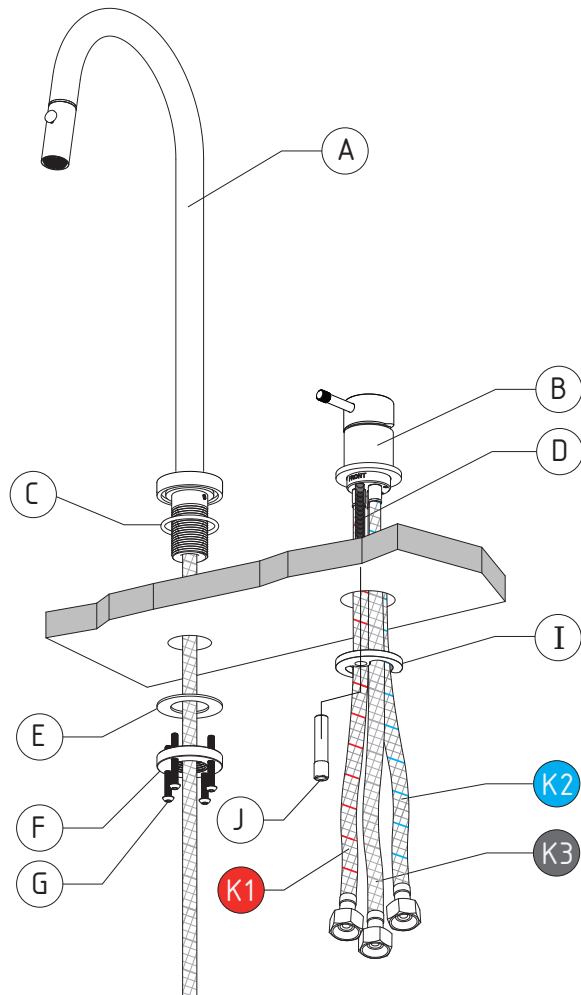

Step 2

Observe the Flow Direction Arrow on the DCV, attach the DCV Assembly (L) to the Mixed Water Hose (K3). Connect the Pull-out Hose (O) to the DCV (Ensure the Swivel Hose Gasket (M) is intact and seated inside the swivel nut (N)). Re-attach the Weights (H) to the Hose, adjust the height of the weights if necessary. The maximum recommended length of Nozzle pull-out is approximately 400mm.

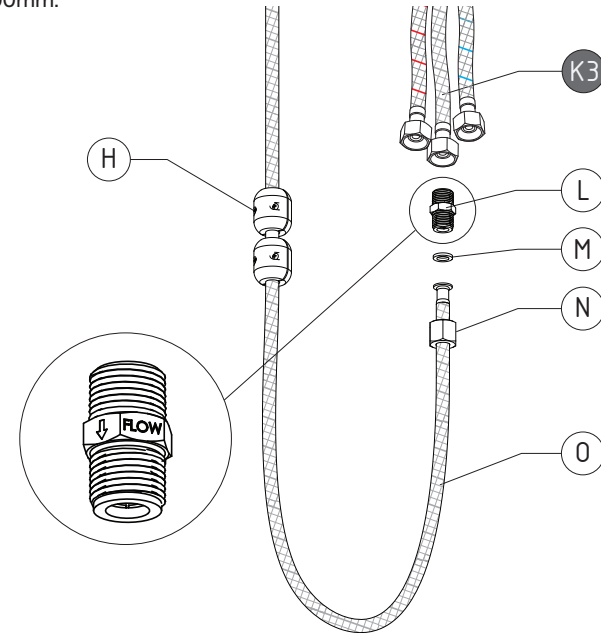

Step 3

Connect the Hot (E1) and Cold (E2) flexible hoses to 1/2" BSP pipework and tighten firmly with a spanner. Ensure hoses do not twist or kink during tightening. Sussex recommends using Stop Cocks/Mini Stops, however, these are not supplied.

Test Mixer and Outlet function, check for leaks.

