

Axa Wild Semi Inset Basin White

CLEANING RECOMMENDATIONS

We recommend the use of soapy water or approved cleaners.

This product should not be cleaned with abrasive materials.

Damage caused by any improper treatment is not covered by the product warranty - refer to Warranty Conditions

INSTALLATION INSTRUCTIONS

455x455mm basin and 605x405mm basin

Note:

If wall mounted tapware is to be used, consideration should be made to length of outlet and positioning of the basin on bench top.

If tapware is to be bench mounted allow suitable top width for fitting tapware.

1. Position supplied cut out template onto the bench and mark off the counter installation.
2. Cut hole in bench to template size.
3. Fit selected waste to basin. Ensure waste is sealed top and bottom.
4. Apply waterproof sealant (not supplied) to the rim of the basin and to the bench top.
5. Fit basin onto the bench top and press firmly all around to achieve good seal.
6. Remove surplus sealant.

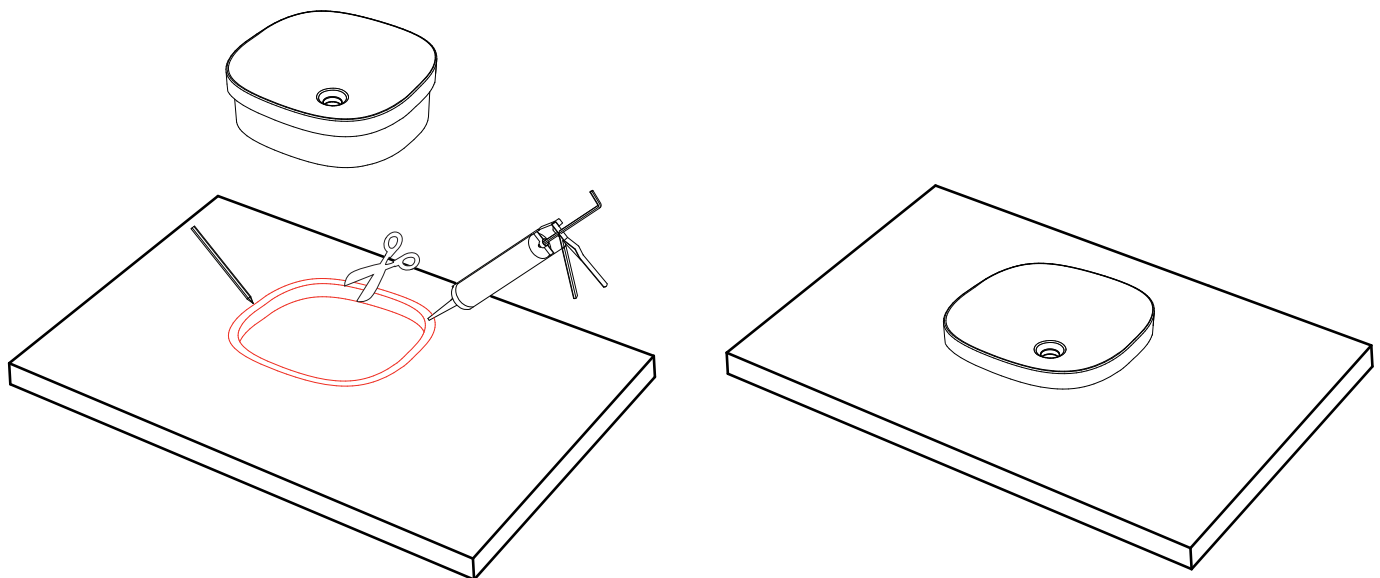

NOTE: The shape of the basin is purely indicative.