

# PERFORMA BOTTOM INLET VALVE

## SPECIFICATIONS

<b>Reece Product Code and Description</b>	9503379 Performa Inlet Valve
<b>Installation Height Range</b>	220 - 310mm
<b>Operating Pressure</b>	recommended 100-1000kPa
<b>Durability</b>	100,000 flushes
<b>Air Gap</b>	min 35mm

## INSTALLATION INSTRUCTIONS

1. Fit rubber washer to inlet valve thread.
2. Position the valve through the hole in the cistern.
3. Place the lock nut onto the thread and tighten the inlet valve to the cistern. (Fig 2)
4. Flush supply line to remove debris.
5. Connect water supply to valve.
6. Adjust height of valve until water level matches the marked water line in the cistern.
7. To adjust height, flick up the adjustment switch and raise or lower upper tube to required height. (Fig 1)
8. Flick down the adjustment switch once height is set. (Fig 3)

### Important Information:

If water pressure exceeds 1000kPa, fit a pressure reducing device.

Do not use sealants in the installation of the inlet valve.

It is recommended to install the inlet valve using a flexible supply connector.



Fig 2

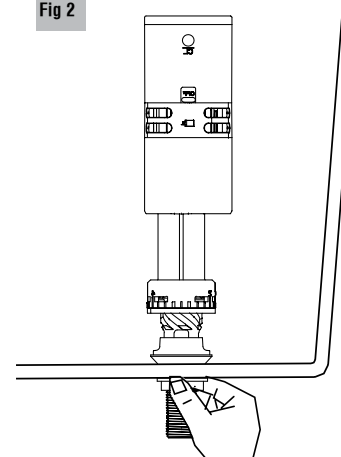

Fig 1

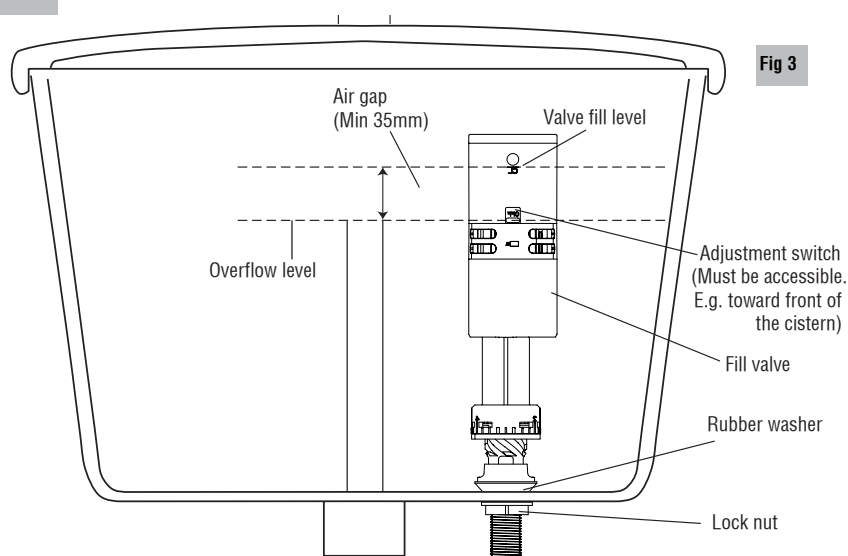
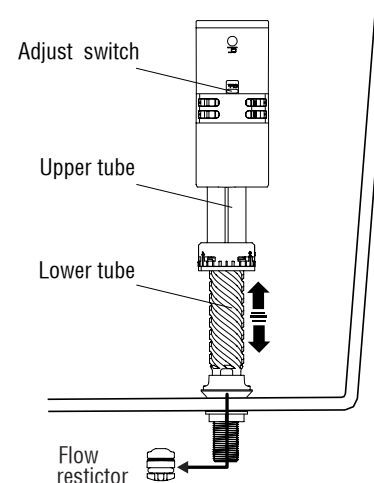

Fig 3



At all times ensure that a 35mm minimum air gap is set between the valve fill level and the overflow level.

# PERFORMA BOTTOM INLET VALVE

## REPLACING THE INLET VALVE SEAL ASSEMBLY

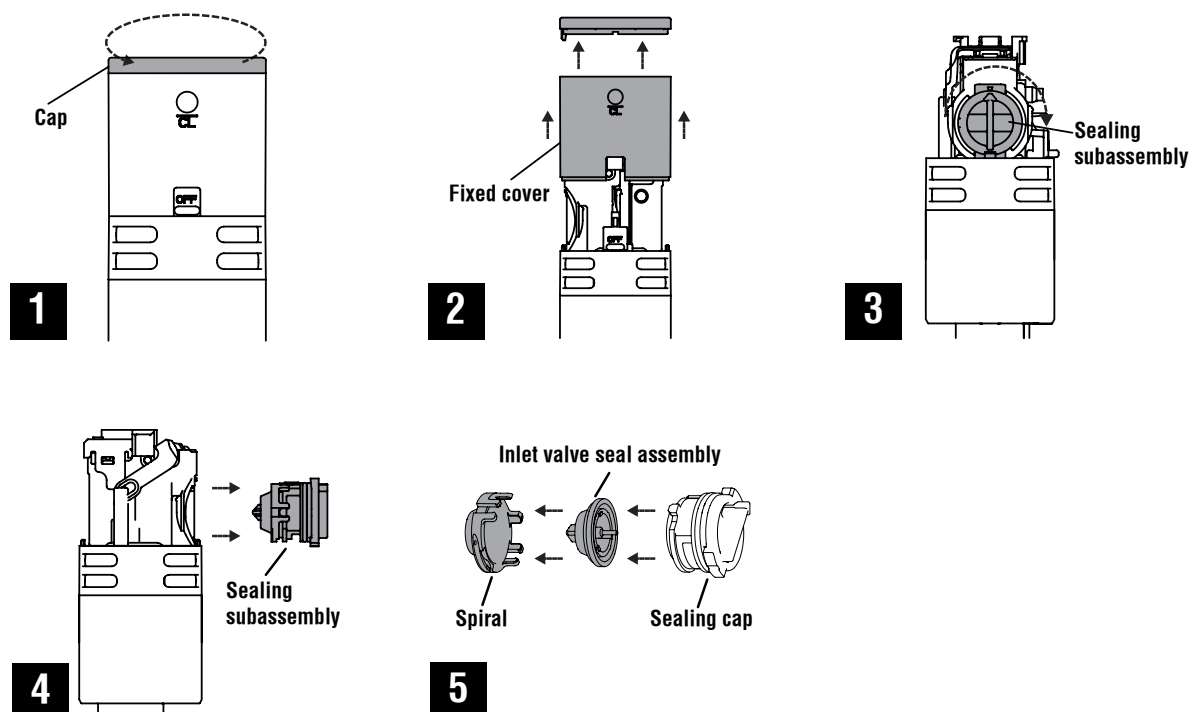

## REPLACEMENT INSTRUCTIONS

**The Inlet Valve Seal assembly may need replacement after a period of reasonable wear & tear, or from damage caused by debris in the supply line. Follow the below steps to replace the inlet valve assembly:**

1. Turn off water supply.
2. Unscrew the cap anticlockwise. (Fig 1)
3. Remove the fixed cover & cap. (Fig 2)
4. Unscrew the sealing subassembly clockwise. (Fig 3)
5. Remove the sealing subassembly. (Fig 4)
6. Remove the spiral & sealing cap. (Fig 5)
7. Replace the inlet valve seal assembly.
8. To reinstate, reverse the above steps.