

mizu

Drift Pull Out Gooseneck Sink Mixer Curve (5 Star)



Installation Instructions



Mixer must be installed to the requirements of AS/NZS 3500 by a qualified plumber. Your mixer comes to you already factory assembled and tested. We do not recommend the dismantling of any internal part of the mixer. The mixers are factory tested and sealed so as to give the best performance.

1. Flush out new pipe work prior to connecting the new mixer, fit with isolating stops on both hot and cold supply.
2. Attach flexible tails to the mixer, connecting the blue labelled hose to the cold 'C' inlet and red labelled hose to the hot 'H' inlet. Screw and tighten both Hoses (30 & 31) firmly onto Tail Extensions (37 & 38).
3. Place Dress Ring and Washer (21 & 22) at base of Mixer Body (12).
4. Position mixer over tap hole. Push through Flexible Tails (30 & 31) one at a time. Finally push through nylon pull hose (18) through tap hole.
5. Take Rubber Washer (25) and Metal Washer (26) from fixing kit.
6. From under bench, push flex hoses (30 & 31) then pull hose (18) through washers (25 & 26). Take Slotted Fixing Nut (27) from fixing kit then pass through Flex Hoses (30 & 31) and pull out Hose (18). If fitting onto stainless steel sink, fit Support Plate (28) first.
7. From above, align mixer into final position. From underneath, screw Slotted Nut (27) into Threaded Shank (23) till tight and mixer is pulled down. Once fully tightened, lock into position with the two screws on the nut.
8. From underneath, screw flexi tail nuts onto corresponding hot and cold isolation stops until watertight seal is achieved. Refer to below for precautions. Turn on water supply from isolation stops and check for leaks.
9. From underneath, push end of Pull Hose (18) into Quick Push Fit Connector Coupling (33) and click into position. (To release push the connector up at same time as pulling down on the Nylon Pull Hose (18)).
10. Take Hose Counterweight (29) and unclip. From underneath with pull hose in fully retracted position, clip weight around Nylon Pull Hose (18). Check Pull Hose by pulling in and out to ensure smooth operation. Minor adjustments can be made by repositioning weight.
11. Turn on mixer and check for and leaks on any connections, ensure mixer is operating correctly, check both normal and spray pattern mode.

**NOTE: Do not over tighten hose tail into the mixer. Do not stretch the flexi hoses.
Do not twist hose braiding to tighten hoses. Do not excessively bend hoses.
Do not use Teflon tape or thread locking compound on any of the threaded connections.**

mizu

Drift Pull Out Gooseneck Sink Mixer Curve (5 Star)

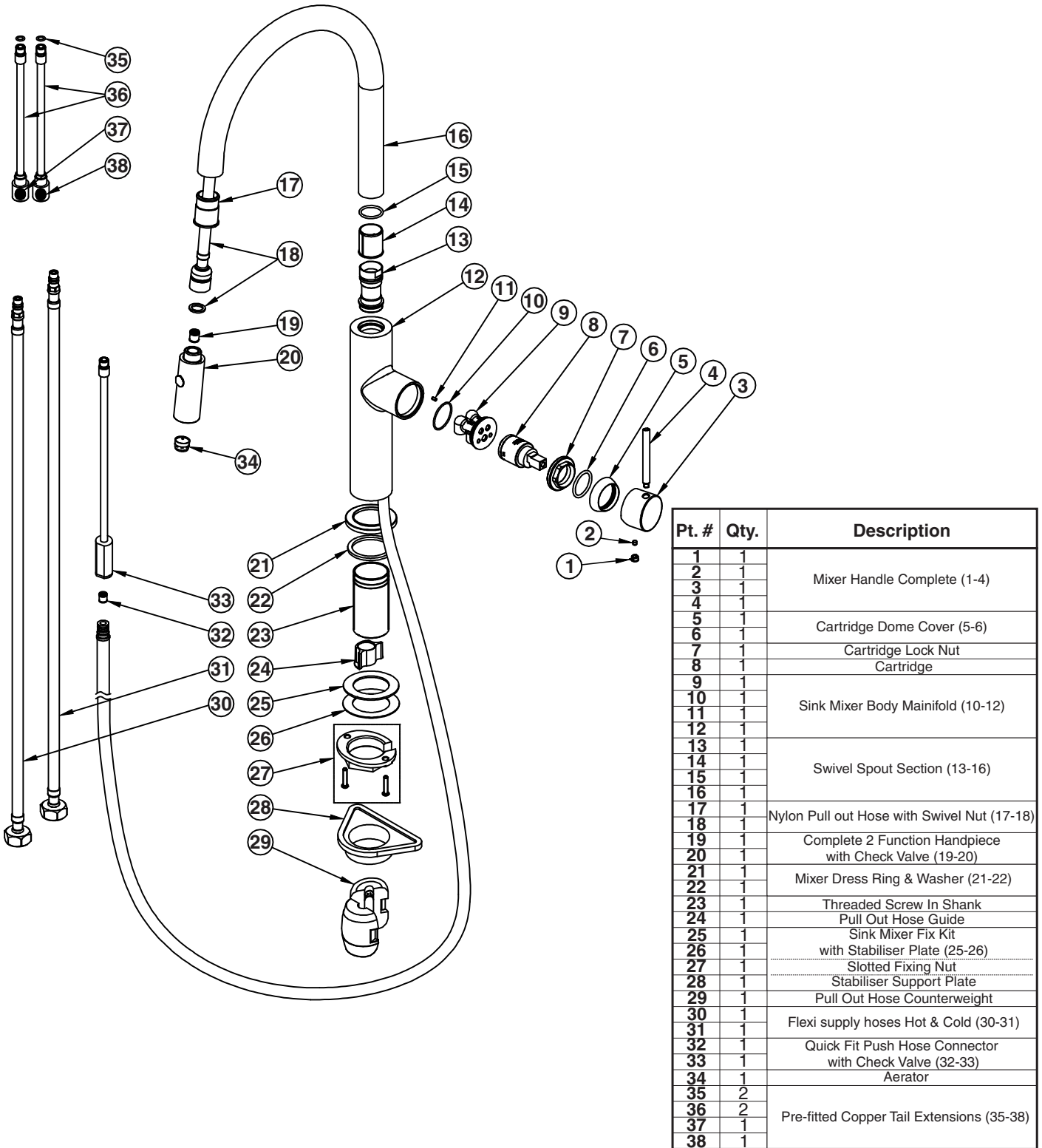

| Pt. # | Qty. | Description |
|-------|------|--|
| 1 | 1 | |
| 2 | 1 | |
| 3 | 1 | Mixer Handle Complete (1-4) |
| 4 | 1 | |
| 5 | 1 | |
| 6 | 1 | Cartridge Dome Cover (5-6) |
| 7 | 1 | Cartridge Lock Nut |
| 8 | 1 | Cartridge |
| 9 | 1 | |
| 10 | 1 | |
| 11 | 1 | Sink Mixer Body Mainifold (10-12) |
| 12 | 1 | |
| 13 | 1 | |
| 14 | 1 | |
| 15 | 1 | Swivel Spout Section (13-16) |
| 16 | 1 | |
| 17 | 1 | Nylon Pull out Hose with Swivel Nut (17-18) |
| 18 | 1 | |
| 19 | 1 | Complete 2 Function Handpiece with Check Valve (19-20) |
| 20 | 1 | |
| 21 | 1 | Mixer Dress Ring & Washer (21-22) |
| 22 | 1 | |
| 23 | 1 | Threaded Screw In Shank |
| 24 | 1 | Pull Out Hose Guide |
| 25 | 1 | Sink Mixer Fix Kit with Stabiliser Plate (25-26) |
| 26 | 1 | |
| 27 | 1 | Slotted Fixing Nut |
| 28 | 1 | Stabiliser Support Plate |
| 29 | 1 | Pull Out Hose Counterweight |
| 30 | 1 | |
| 31 | 1 | Flexi supply hoses Hot & Cold (30-31) |
| 32 | 1 | Quick Fit Push Hose Connector with Check Valve (32-33) |
| 33 | 1 | |
| 34 | 1 | Aerator |
| 35 | 2 | |
| 36 | 2 | Pre-fitted Copper Tail Extensions (35-38) |
| 37 | 1 | |
| 38 | 1 | |

Care Details

We recommend the use of soapy water or approved cleaners. This product should not be cleaned with abrasive materials. Damage caused by any improper treatment is not covered by the product warranty - refer to Warranty Conditions on the last page.

Plumbers, please ensure a copy of the installation instruction is left with the end user for future reference.

