

FRANKE

DESIGNER SEMI-INTEGRATED DISHWASHER 60CM

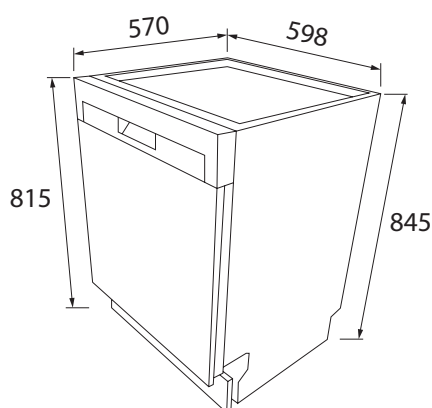

Dimensions are nominal measurements only.

SPECIFICATIONS

Recommended use	Domestic
Colour availability	Stainless Steel with silver kick plate
Net Weight	35.5kg
Dimensions	598 x 570 x 815mm
Capacity (place settings)	14
Noise level	49db
Delay start	1-24 hours
Third layer cutlery basket	Yes, multifunctional style
Height adjustable upper basket	Yes, with height adjustable system
Child lock	Yes
Auto wash	Yes
Zone wash	Yes
Programmes	7
Electronic controls	On/Off, Program, Alt, DELAY, Start/ Pause, Extra drying, Child lock
Type of inlet hose	Electronic aqua-stop
Power cord length	1400mm
Power requirements	220/240V - 50Hz
Water connection	Connect to cold water
Water inlet hose	1500mm
Outlet hose	1400mm
Heating element	Integrated 1800W

Door panel and kickplate not supplied



To see the complete FRANKE range go to www.reece.com.au/bathrooms

* Dishwasher comes standard with a cutlery drawer. Optional cutlery basket accessory available.

CLEANING RECOMMENDATIONS

We recommend the use of soapy water or approved cleaners.

This product should not be cleaned with abrasive materials.

Damage caused by any improper treatment is not covered by the product warranty. Refer to Warranty Conditions.



Disclaimer: Products in this specification manual must by regulation be installed by licensed and registered trade people. The manufacturer/distributor reserves the right to vary specifications or delete models from their range without prior notification. Dimensions are nominal measurements only. Dimensions and set-outs listed are correct at time of publication however the manufacturer/distributor takes no responsibility for printing errors.

Tech Page Version 1

FRANKE

reece

FRANKE

DESIGNER SEMI-INTEGRATED DISHWASHER 60CM**INSTALLATION INSTRUCTIONS**

Warning	
	Electrical Shock Hazard Disconnect electrical power before installing dishwasher.
	Failure to do so can result in death or electrical shock.

Attention:

The installation of the pipes and electrical equipment should be done by professionals.

Installation preparation

The installation position of dishwasher should be near the existing inlet and drain hoses and power cord. One side of the cabinet sink should be chosen to facilitate the connection of drain hoses of the dishwasher.

Note: please check the accompanying installation accessories (hook for aesthetic panel, screw)

Please carefully read the installation instructions

Illustrations of cabinet dimensions and installation position of the dishwasher. Preparations should be made before moving the dishwasher to the installation place.

1. Choose a place near the sink to facilitate the installation of inlet and drain hoses (see figure 1).
2. If dishwasher is installed at the corner of the cabinet, there should be some space (illustrated in figure 2) when the door is opened.

FIGURE 1

Cabinet dimensions less than 5 mm between the top of dishwasher and cabinet and the outer door aligned to cabinet.

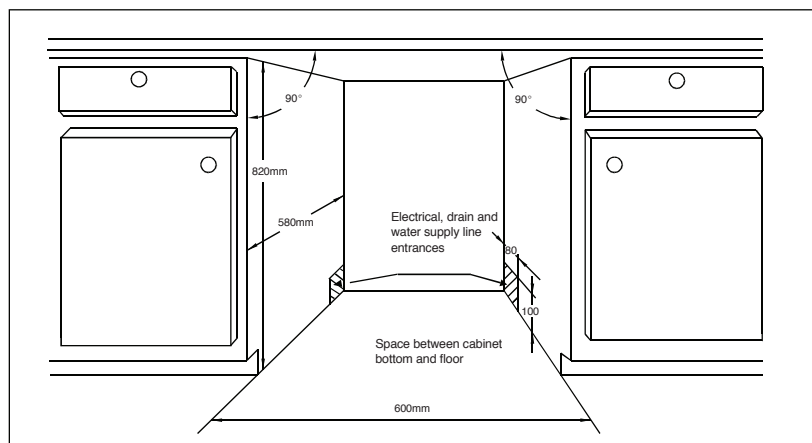
**FIGURE 2**

Minimum space when the door is opened.

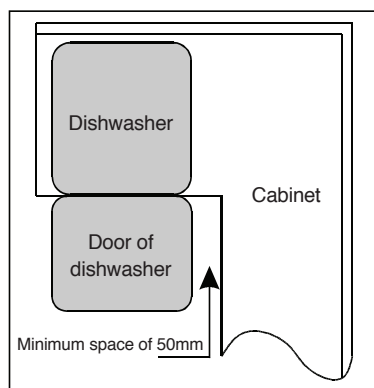

Plumbers, please ensure a copy of the installation instructions is left with the end user for future reference

FRANKE**reece**

FRANKE

DESIGNER SEMI-INTEGRATED DISHWASHER 60CM**INSTALLATION INSTRUCTIONS****Aesthetic panel's dimensions and installation**

The aesthetic wooden panel could be processed according to Figure 3.

FIGURE 3

The aesthetic panel should be processed in accordance with the illustrated dimensions

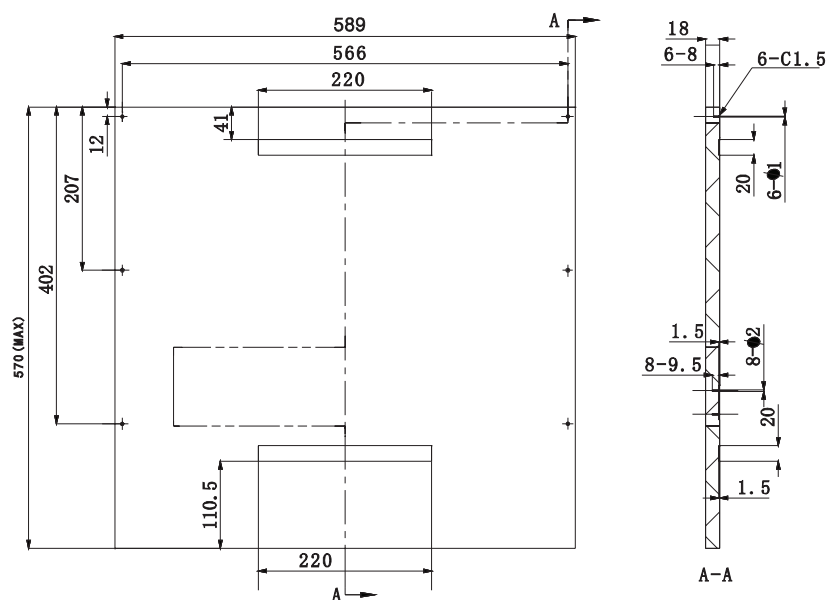

Utilising double sided adhesive on the aesthetic wooden panel and the outer door of the dishwasher (see figure 4a). After positioning of the panel, fix the panel onto the outer door by screws and bolts (see figure 4b).

FIGURE 4A

Installation of aesthetic panel

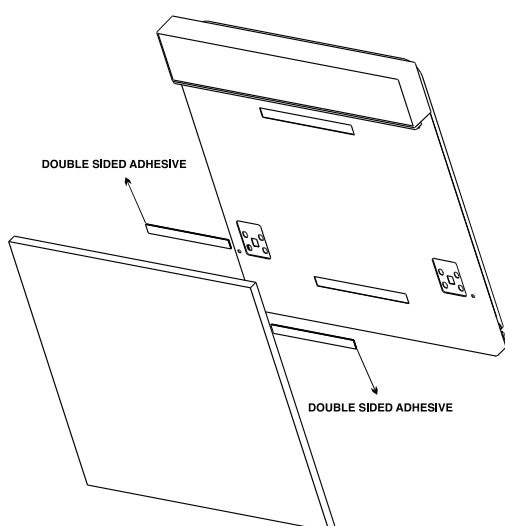
**FIGURE 4B**

Installation of aesthetic wooden panel

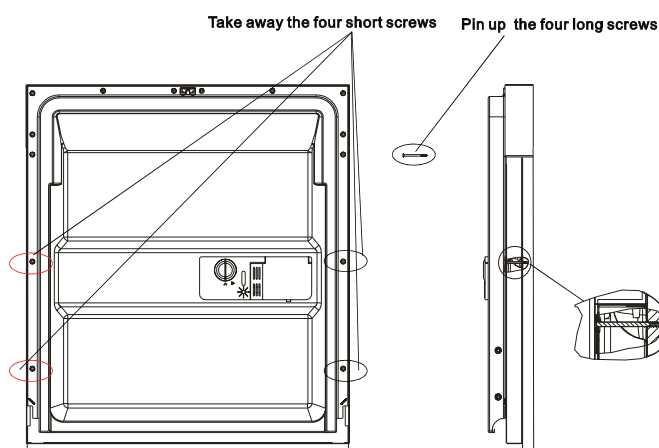

Plumbers, please ensure a copy of the installation instructions is left with the end user for future reference

FRANKE**reece**

FRANKE

DESIGNER SEMI-INTEGRATED DISHWASHER 60CM**INSTALLATION INSTRUCTIONS****Tension adjustment of the door spring**

The door springs are set at the factory to the proper tension for the outer door. If aesthetic wooden panel are installed, you will have to adjust the door spring tension. Rotate the adjusting screw to drive the adjustor to strain or relax the steel cable (see figure 5).

Door spring tension is correct when the door remains horizontal in the fully opened position yet rises to a close with the slight lift of a finger.

FIGURE 5

Tensions adjustment of the door spring

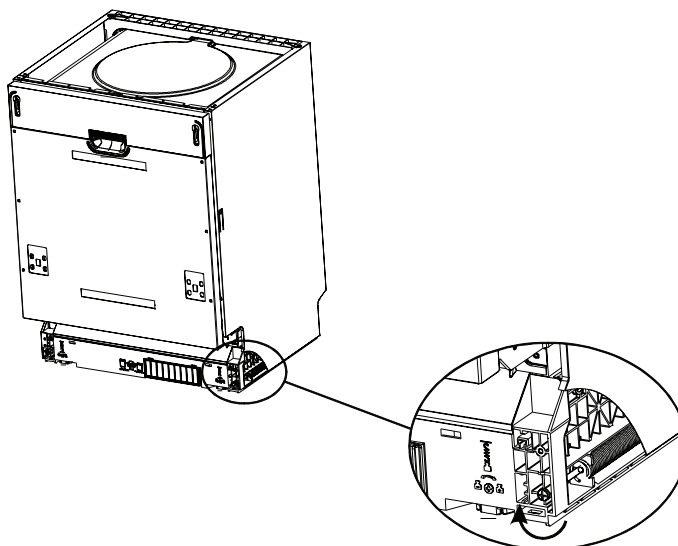
**Connection of drain hoses**

Insert the drain hose into a drain pipe with a minimum diameter of 40 mm, or let it run into the sink, making sure to avoid bending or crimping it. The top of the hose must be less than 1000 mm.

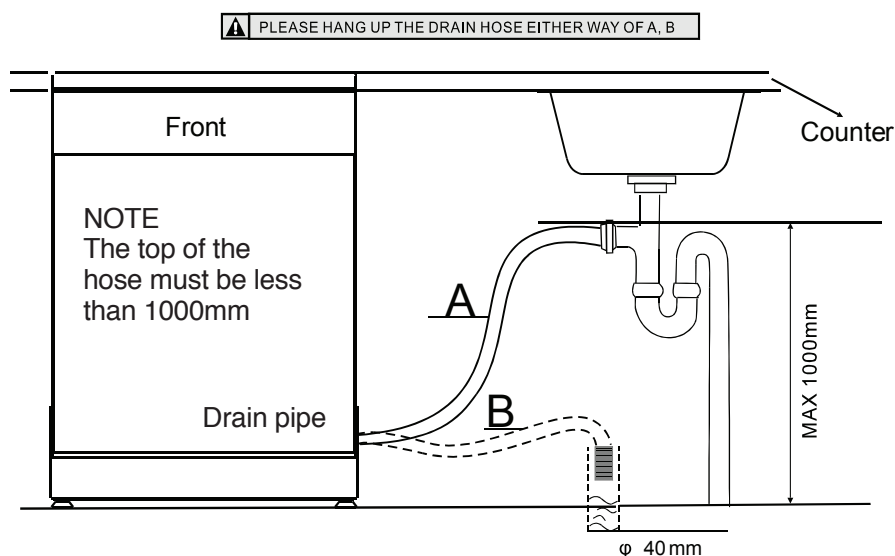

Plumbers, please ensure a copy of the installation instructions is left with the end user for future reference

FRANKE**reece**

FRANKE

DESIGNER SERIES SEMI-INTEGRATED DISHWASHER**INSTALLATION INSTRUCTIONS****Dishwasher installation steps**

1. Install the furniture door to the outer door of the dishwasher using the brackets provided. Refer to the template for positioning of the brackets.
2. Adjust the tension of the door springs by using an Allen key turning in a clockwise motion to tighten the left and right door springs. Failure to do this could cause damage to your dishwasher (Illustration 2)
3. Connect the inlet hose to the cold water supply
4. Connect the drain hose. Refer to diagram (Figure 6)
5. Connect the power cord
6. Affix the condensation strip under the work surface of cabinet. Please ensure the condensation strip is flush with edge of work surface.
7. Place the dishwasher into position. (Illustration 4)
8. Level the dishwasher. The rear foot can be adjusted from the front of the dishwasher by turning the Allen screw in the middle of the base of dishwasher use an Allen key (Illustration 5A). To adjust the front feet, use a flat screw driver and turn the front feet until the dishwasher is level (Illustration 5B).
9. The dishwasher must be secured in place. There are two ways to do this:
 - A. Normal work surface: Put the installation hook into the slot of the side plane and secure it to the work surface with the wood screws (Illustration 6).
 - B. Marble or granite work top: Fix the side with Screw. (Illustration 7).

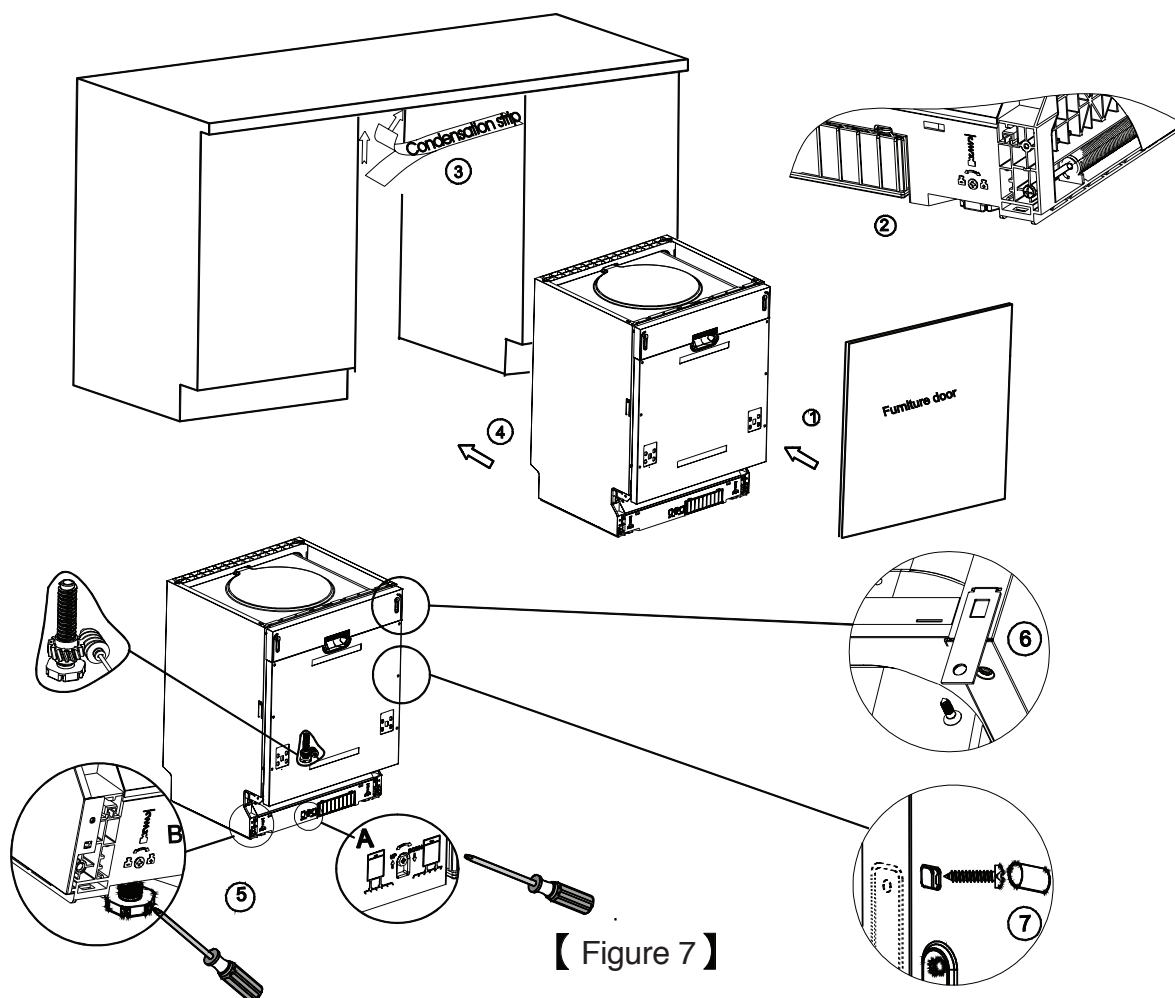

FRANKE

DESIGNER SERIES SEMI-INTEGRATED DISHWASHER

INSTALLATION INSTRUCTIONS

Dishwasher must be level for proper dish rack operation and wash performance.

1. Place a spirit level on door and rack track inside the tub as shown to check that the dishwasher is level.
2. Level the dishwasher by adjusting the three levelling legs individually.
3. When level the dishwasher, please pay attention not to let the dishwasher tip over.

FIGURE 8

Illustration of feet adjustment
Note: The maximum adjustment height of feet is 50 mm

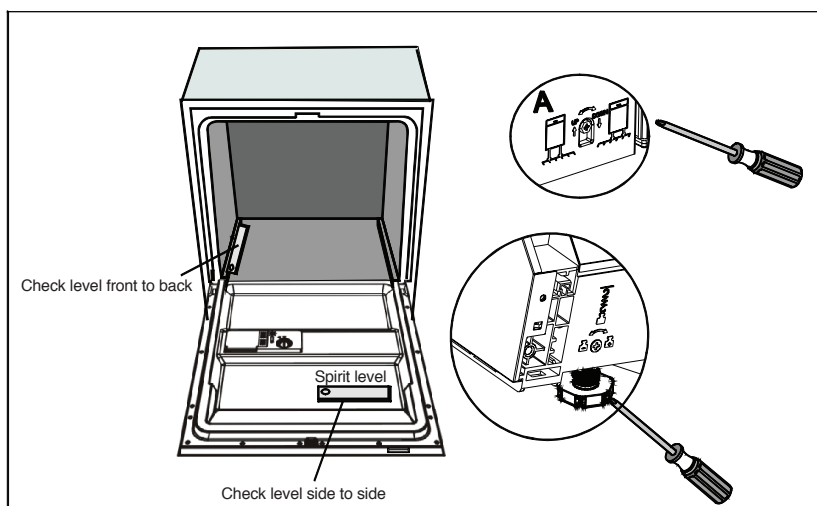

About electricity connecting

WARNING:

For personal safety - Do not use extension cord or an adapter plug with this appliance. Do not, under any circumstances, cut or remove the earthing connection from the power cord.

Electrical requirements

Please look at the rating label to know the rating voltage and connect the dishwasher to the appropriate power supply. Use the required fuse 10 amp, time delay fuse or circuit breaker recommended and provide separate circuit serving only this appliance.

Electrical connection

Ensure the voltage and frequency of the power being corresponds to those on the rating plate. Only insert the plug into an electrical socket which is earthed properly. If the electrical socket to which the appliance must be connected is not appropriate for the plug, replace the socket, rather than using a adaptors or the like as they could cause overheating and burns.

How to connect the safety supply hose

The appliance must be connected to the water mains using new hose-sets.

The old hose-sets should not be reused.

Water pressure must be between 0,04 MPa and 1 MPa. If the pressure is below the minimum consult our Service Department for advice.

1. Pull The safety supply hoses completely out from storage compartment located at rear of dishwasher.
2. Tighter the screws of the safety supply hose to the faucet with thread 3/4 inch.
3. Turn water fully on before starting the dishwasher.

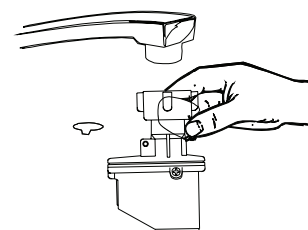

FRANKE

DESIGNER SERIES SEMI-INTEGRATED DISHWASHER

INSTALLATION INSTRUCTIONS

About the safety supply hose

The safety supply hose consists of the double walls. The hose's system guarantees its intervention by blocking the flow of water in case of the supply hose breaking and when the air space between the supply hose itself and the outer corrugated hose is full of water.

WARNING: A hose that attaches to a sink spray can burst if it is installed on the same water line as the dishwasher. If your sink has one, it is recommended that the hose be disconnected and the hole plugged.

How to disconnect the safety supply hose

1. Turn off the water
2. Release the water pressure by depressing the pressure release button. This relieves water pressure and protects you, and the room, from severe splashing.
3. Unscrew the safety supply hose from the faucet.

Cold water connection

Connect the cold water supply hose to a threaded 3/4(inch) connector and make sure that it is fastened tightly in place. If the water pipes are new or have not been used for an extended period of time, let the water run to make sure that the water is clear and free of impurities. If this precaution is not taken, there is a risk that the water inlet can get blocked and damage the appliance.

Positioning the appliance

Position the appliance in the desired location. The back should rest against the wall behind it, and the sides, along the adjacent cabinets or walls. The dishwasher is equipped with water supply and drain hoses that can be positioned either to the right or the left sides to facilitate proper installation.

How to drain excess water from hoses

If the sink is 1000 higher from the floor, the excess water in hoses cannot be drained directly into the sink. It will be necessary to drain excess water from hoses into a bowl or suitable container that is held outside and lower than the sink.

Water outlet

Connect the water drain hose. The drain hose must be correctly fitted to avoid water leaks. Ensure that the water inlet hose is not kinked or squashed.

Extension hose

If you need a drain hose extension, make sure to use a similar drain hose. It must be no longer than 4 metres; otherwise the cleaning effect of the dishwasher could be reduced.

Syphon connection

Insert the drain hose into a drain pipe with a minimum diameter of 40 mm, or let it run into the sink, making sure to avoid bending or crimping it. The top of the hose must be less than 1000 mm.

Start of dishwasher

The following things should be checked before starting the dishwasher.

4. The dishwasher is level and fixed properly.
5. The inlet valve is open.
6. There is a leakage at the connections of the conducts.
7. The wires are tightly connected.
8. The power is switch on.
9. The inlet and drain hoses are knotted.
10. All packing and print materials should be taken out of the dishwasher.