

# Alape<sup>®</sup>

## Alape White Wall Basin WT7 600mm with Fixing Set 1 Taphole White

**Note:** All measurements are taken from finished wall and floor. If basin is installed at a different height to that recommended in diagram a) all other measurements must be adjusted accordingly. If fixing to timber framed walls or partitioning, the walls must be reinforced with noggins to receive fixing bolts/screws.

1. Drill holes into wall at recommended height and fixing centres (see diagram a).
2. Fit selected tapware to basin. Fit the waste to basin ensuring it is sealed with silicone on top.
3. Insert wall plugs (1) and screws (2). Secure washstand to wall with nuts (6) and flat washers (3), but do not fully tighten (see diagram c).
4. Make minor adjustments at this stage and ensure basin is level and then fully tighten nuts. Do not over tighten!
5. If desired all visible external edges can be joint sealed using flexible sealant ensuring to wipe off any excess.

a)



b)



c)

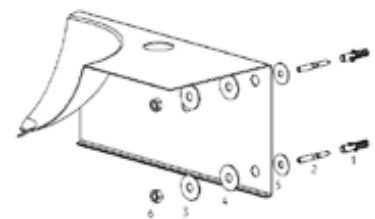

Plumbers, please ensure a copy of the installation instructions is left with the end user for future reference.