

COOL-FIT PE Plus T 90° PN10



Model:

- pre-insulated PE100 SDR 17 metric
- Insulation made from GF HE foam
- Outer jacket impact resistant. Color: black
- B: Spigot Fitting with free end (separate electrofusion fitting needed for joining)

d/D (mm)	PN (bar)	Code	Weight (kg)	L1 (mm)	z (mm)	z1 (mm)	closest inch (inch)	Type
250/355	10	738 203 121	12.000	123	500	500	10	B
280/400	10	738 203 122	22.300	126	500	500	10	B
315/450	10	738 203 123	21.480	133	500	500	12	B
355/500	10	738 203 124	30.600	148	650	700	14	B
400/560	10	738 203 175	42.000	150	650	700	16	B
450/630	10	738 203 176	67.200	165	700	750	18	B

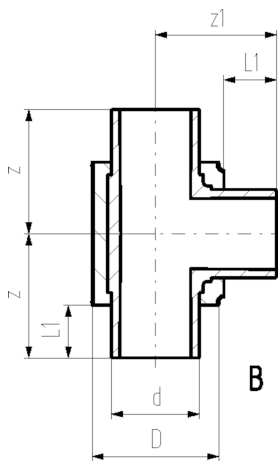

The technical data are not binding. They neither constitute expressly warranted characteristics nor guaranteed properties nor a guaranteed durability. They are subject to modification. Our General Terms of Sale apply.

Georg Fischer Piping Systems Ltd, Postfach, CH-8201 Schaffhausen/Switzerland

Phone +41 -(0)52-631 1111

e-mail: info.ps@georgfischer.com

Internet: <http://www.gfps.com>