

Dura

Lead Free Spring Check Valve

Specifications

Operating Pressure	1600kPa
Operating Temperature	-10≤C to 110≤C

Product Image



Components

Number	Name	Material
1	Body	Lead Free Brass
2	Spring	Stainless Steel 304
3	Core	ABS
4	Gasket	EPDM
5	Bonnet	Lead Free Brass

Pressure/Temperature Diagram

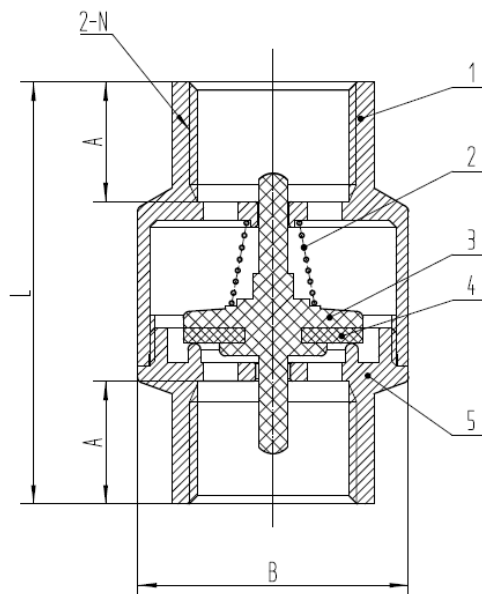
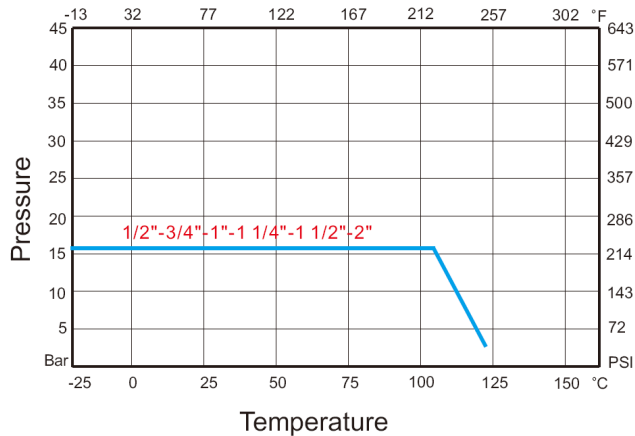

Dimensions

Codes	Product Description	Size	N	A	B	L
1009556	Dura LF Brass Spring Check Valve WM 15mm	DN15	Rp1/2	17.5	φ34	62
1009557	Dura LF Brass Spring Check Valve WM 20mm	DN20	Rp3/4	19	φ43	67
1009558	Dura LF Brass Spring Check Valve WM 25mm	DN25	Rp1	22	φ49	78.5
1009559	Dura LF Brass Spring Check Valve WM 32mm	DN32	Rp1.1/4	24	φ61	83.5
1009560	Dura LF Brass Spring Check Valve WM 40mm	DN40	Rp1.1/2	24	φ70	91
1009561	Dura LF Brass Spring Check Valve WM 50mm	DN50	Rp2	29	φ86	114.5