

# ALAPE

## WT Square Freestanding Basin with Round Bowl 325mm White

365mm x 325mm (wide) x 900mm (tall)

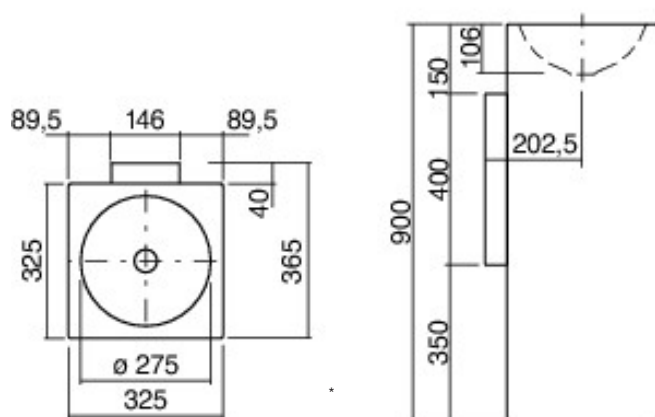

### FEATURES

<b>Recommended use</b>	Domestic, hotel, commercial
<b>Overflow</b>	No
<b>Tap hole availability</b>	No tap hole, taps to be wall mounted.
<b>Plug, waste and trap</b>	Suitable with 32 x 40mm non-overflow waste. Plastic spacer for waste supplied. Bottle trap not supplied.
<b>Material</b>	Steel Enamelling
<b>Fixing</b>	Wall mounted (bolts supplied)
<b>Colour</b>	White
<b>Capacity</b>	6.5 L

### CLEANING RECOMMENDATIONS

Any bathroom product should not be cleaned with abrasive materials eg. steel wool/scourers. Do not use any corrosive or abrasive cleaning agents containing acids or scouring agents. Bleaches can also discolour products and therefore should not be used. Damage caused by any improper treatment is not covered by the product warranty - refer to Warranty Conditions.



To see the complete Alape range go to [www.reece.com.au/bathrooms](http://www.reece.com.au/bathrooms)

**Disclaimer:** Products in this specification manual must by regulation be installed by licensed and registered trade people. The manufacturer/distributor reserves the right to vary specifications or delete models from their range without prior notification. Dimensions and set-outs listed are correct at time of publication however the manufacturer/distributor takes no responsibility for printing errors.

Tech Page Version 4

**Alape**

**reece**

# ALAPE

## WT Square Freestanding Basin with Round Bowl 325mm White

### INSTALLATION INSTRUCTIONS

Note: If fixing to timber framed walls or partitioning, the walls must be reinforced with noggins to receive fixing bolts/screws. Please allow sufficient height for installation of tapware on wall.

1. Drill four holes into the wall for the dowels at the required height and fixing centres. Insert dowels (1) and wood-to-metal dowels (2). Secure wall attachment element to wall with nuts (4) and metal flat washers (3).
2. Mount siphon (5) and adaptor (7) onto the wall attachment element.
3. Slide on the rubber edging trim all around the bottom lip of the basin. Depending on the basin model, the trim may have to be shortened. Lift washstand with its recess over the adaptor and position washstand relative to the wall.
4. To secure the washstand, tighten drain valve by using the installation wrench (6). If desired all visible external edges can be joint sealed using flexible sealant ensuring to wipe off any excess.

1.

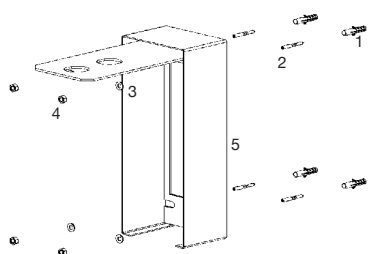

2.

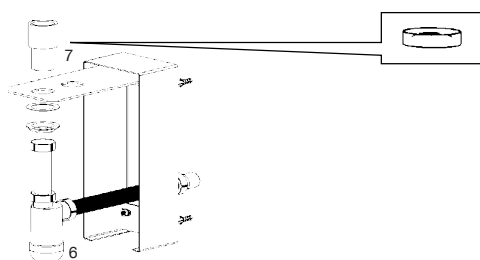

3.

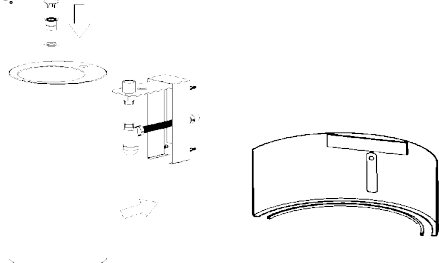

4.

